

© Copyright
Ayre Chamberlain Gaunt

NOTES:

All dimensions to be checked on site.
Drawing to be used in conjunction with all relevant Architectural, Interiors, Structural, M&E, Drainage, Public Health, Landscape and Civils drawings and specifications. Any amendments to these drawings must be approved by the Architect before any work commences.
The Contractor's attention is drawn to the Health & Safety matters identified in the notes on drawings and the Health & Safety file.
These items should not be considered as a full and final list.
The Work Package Contractor's normal health & safety obligations still apply when undertaking constructional operations both on and off site.
Ayre Chamberlain Gaunt take no responsibility for the location of legal boundaries indicated on this drawing and advise a separate drawing to be completed by specialist surveyors in order to establish exact boundaries. PDF record.
The copyright of this drawing is held by Ayre Chamberlain Gaunt Ltd. Not to be used for any purpose without consent.

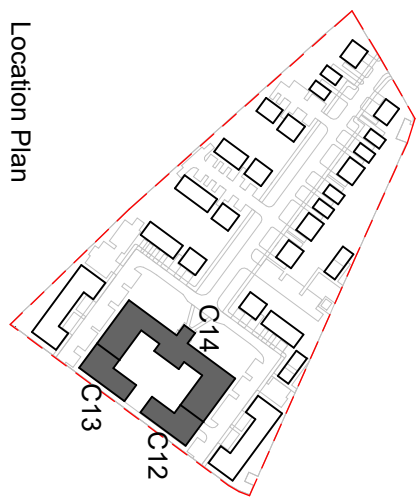

Location Plan

- Extent of Lovell Site Boundary
 - 3m Drainage Easement
 - 3m Path Edge within Site
 - Extent of Mase Site Boundary
 - 3m Network Rail Easement
 - Existing Trees
 - Proposed Trees
 - Existing Floor Level (Ground Floor Only)
 - Demons Below Ground
- NOTE** - Site boundaries are shown for planning purposes only. Measurements of topographical survey data are shown from the survey design proposals.

ACGARCHITECTS.CO.UK

Ayre Chamberlain Gaunt
Bayvedere House
Basing View
Basingstoke
Hampshire, RG21 4HG
+44 (0)20 3809 5750
mail@acgarchitects.co.uk

PROJECT

Former Novartis Site
Parsonage Road, Horsham

REV.

P1	12.02.25	Progress Issue
P2	14.02.25	Progress Issue
P3	28.02.25	Draft Planning Issue For Comment
P4	10.03.25	Issue For Planning
P5	15.09.25	For Coordination
P6	03.10.25	Issue For Planning

DESCRIPTION

DRWN

SH

CHKD BY

SH

APPD BY

MA

DRAWING NO.

project code - signature - volume - sheet type - title - number
HOR-ACG-ZZ-BF-DR-A-2000

STAGE

Final Stage

code

S3

SUITABILITY

Suitable for Review
& Comment