

A1

SCALE
1:200



@ Copyright
Ayre Chamberlain Gaunt

NOTES:

All dimensions to be checked on site.
Drawing to be read in conjunction with all relevant Architectural, Interiors, Structural, M&E, Drainage/ Public Health, Landscape and Civils drawings and specifications. Any discrepancies between consultant's drawings to be reported to the Architect before any work commences.
The Contractor's attention is drawn to the Health & Safety matters identified in the Health & Safety plan as being potentially hazardous.
These items should not be considered as a full and final list.

The Work Package Contractor's normal Health & Safety obligations still apply when undertaking constructional operations both on and off site.

Ayre Chamberlain Gaunt take no responsibility for the location of legal boundaries indicated on this drawing and advise a separate drawing to be completed by specialist surveyor in order to establish exact boundaries.
DWG files provided for information only. Refer to PDF record.

The copyright of this drawing is held by Ayre Chamberlain Gaunt Ltd. Not to be used for any purpose without consent.

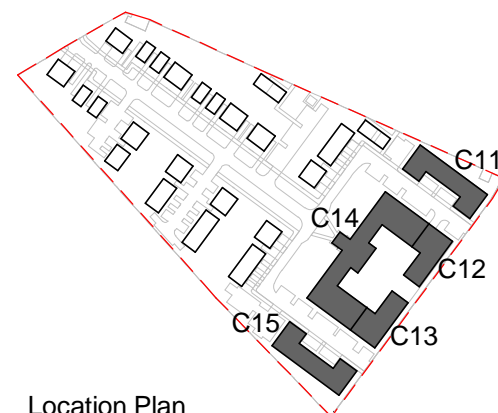

Location Plan
(info)

- Extent of Lovell Site Boundary
- 3m Drainage Easement
- S106 Path Edge within Site
- Extent of Muse Site Boundary
- 3m Network Rail Easement

NOTE - Site boundaries are shown for planning purposes only. Measured/Topographical survey information of the site should form the basis of design proposals

- Existing Trees
- Proposed Trees
- Existing Root Protection Zones (Ground Floor Only)

ACGARCHITECTS.CO.UK

Ayre Chamberlain Gaunt
Belvedere House
Basing View
Basingstoke
Hampshire, RG21 4HG

+44 (0)20 3909 5750
mail@acgarchitects.co.uk

**AYRE
CHAMBERLAIN
GAUNT**

PROJECT
Former Novartis Site
Parsonage Road, Horsham

DRAWING TITLE
Heritage building C14 and Apartment
Blocks C11 C12 C13 C15 - Roof Plan

REV.	DATE	DESCRIPTION
P1	12.02.25	Progress Issue
P2	14.02.25	Progress Issue
P3	28.02.25	Draft Planning Issue For Comment
P4	10.03.25	Issue For Planning

DRWN	CHKD BY	APPD BY
RC	SH	MA

DRAWING NO.

project code - originator - volume - level - type - role - number

HOR-ACG-ZZ-RF-DR-A-2006

STAGE	SUITABILITY
RIBA stage	code description
3	S3 Suitable for Review & Comment