

1 Existing First Floor Plan  
1 : 200

- Extent of Lovell Site Boundary
- 3m Drainage Easement
- S106 Path Edge within Site
- Extent of Muse Site Boundary
- 3m Network Rail Easement

NOTE - Site boundaries are shown for planning purposes only. Measured/Topographical survey information of the site should form the basis of design proposals

@ Copyright  
Ayre Chamberlain Gaunt  
SCALE  
1:200

A1

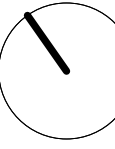

#### NOTES:

All dimensions to be checked on site.  
Drawing to be read in conjunction with all relevant Architectural, Interiors, Structural, M&E, Drainage/ Public Health, Landscape and Civils drawings and specifications. Any discrepancies between consultant's drawings to be reported to the Architect before any work commences. The Contractor's attention is drawn to the Health & Safety matters identified in the Health & Safety plan as being potentially hazardous. These items should not be considered as a full and final list.

The Work Package Contractor's normal Health & Safety obligations still apply when undertaking constructional operations both on and off site.

Ayre Chamberlain Gaunt take no responsibility for the location of legal boundaries indicated on this drawing and advise a separate drawing to be completed by specialist surveyor in order to establish exact boundaries. DWG files provided for information only. Refer to PDF record.

The copyright of this drawing is held by Ayre Chamberlain Gaunt Ltd. Not to be used for any purpose without consent.

Original Survey Drawn:

Encompass Surveys Ltd

Unit 2  
Talisman Business Centre  
Duncan Road  
Park Gate, Southampton  
Hampshire SO31 7GA

Tel: 023 80692002  
Email: info@encompass-surveys.co.uk

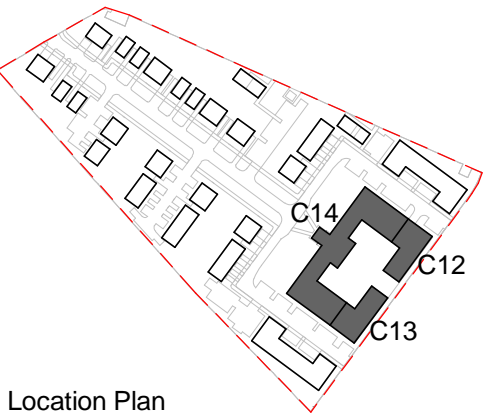

Location Plan  
(N75)

#### ACGARCHITECTS.CO.UK

Ayre Chamberlain Gaunt  
Belvedere House  
Basing View  
Basingstoke  
Hampshire, RG21 4HG

+44 (0)20 3909 5750  
mail@acgarchitects.co.uk

**AYRE  
CHAMBERLAIN  
GAUNT**

#### PROJECT

Former Novartis Site  
Parsonage Road, Horsham

#### DRAWING TITLE

Existing Heritage Building & Office  
Block - First Floor Plan

REV.	DATE	DESCRIPTION
P1	28.02.25	Draft Planning Issue For Comment
P2	10.03.25	Issue For Planning

DRWN BY	CHKD BY	APPD BY
JL	MA	MA

#### DRAWING NO.

project code - originator - volume - level - type - role - number

HOR-ACG-ZZ-01-DR-A-0003

STAGE	SUITABILITY
RIBA stage	code description
3	S3 Suitable for Review & Comment