

Job Name: Land North of East Street Rusper West Sussex
Date: 11th November 2025
Prepared By: Matt Pendry BSc (Hons) MCIEEM (Principal Ecologist)
Subject: Technical Response – Planning ref: DC/25/0523

Following submission of ecology and BNG documents in relation to the above site the Ecology Officer at Horsham District Council issued a response which included a holding objection in relation to the removal of more trees than accounted for in the original BNG assessment, and the need for further compensation due to potential impacts on a roosting feature for bats. Further information was supplied by the Ecology Partnership on 23rd October, and has addressed most of the points raised by the ecology officer, however, further information has been requested on trees, as outlined below:

Ecology

"The ecologist confirms that trees T25-T33 have been removed, with the loss of trees T31-T33 previously accounted for. As T26 and T27 are medium sized trees, these have been added separately to the baseline. The ecologist also states that T25 and T28 are hawthorns, which are considered a scrub species, and T29 and T30 are small, and therefore the loss of these trees does not require accounting for separately. Whilst this method is agreed, the tree schedule submitted to HDC does not contain any information on trees T26-T33 and appear to be omitted given the date of the Arboricultural Method Statement is November 2024 (prior to vegetation clearance works). As such, we request the tree schedule information for T26-T33. A total of 5x trees (4x medium and 1x large as per the metric entries) are accounted for in the ecologist's explanation, however at least 10x trees with an approximate DBH of medium or higher were identified during the site visit undertaken by me and the HDC Arboricultural Officer. Therefore, this tree schedule information is essential to ascertain the correct number.

The ecologist also confirms that all other Category U trees on site are to be retained. If any works are required to these trees in the future, crown reduction and monolithic works should be pursued over complete removal, with such details being incorporated into the HMMP. Please can this be added to the HMMP prior to signing of a legal agreement."

The trees which were cleared are highlighted in red below, which was cross-referenced with the tree schedule below. Trees are typically wider at ground level and taper to a thinner diameter at breast height. This may account for the discrepancy with the tree sizes recorded by the arboriculturist at breast height and the planning officer at ground level. It is possible many of the stumps may also relate the

scrub species such as hawthorn and blackthorn not recorded by the arboriculturist but instead forming part of the underlying scrub as opposed to individual trees.

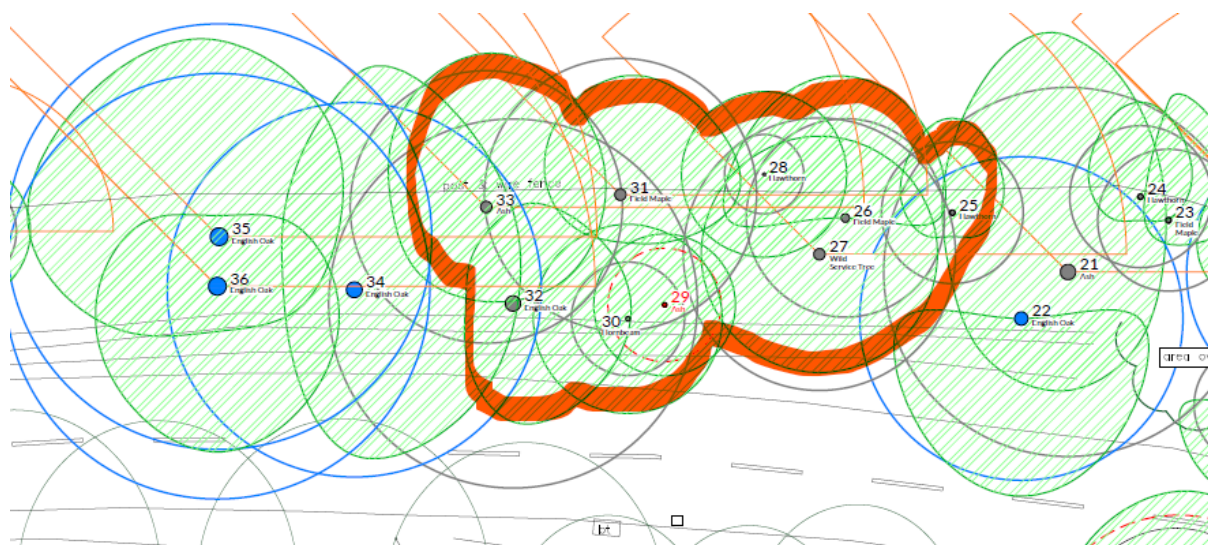

No.	Species	Height	Trunk Dia.	Radial Crown Spread	Crown Clearance	Height to 1st Branch	Life Stage	Physiology	Structure	Landscape Value	Est. Years	Comments	Category
25	Hawthorn	9m	250mm est	N4m E2m S1m W2m	4m	3m	Semi-mature	Average	Average	Low	20-40	Suppressed crown as overtopped by adjacent specimens.	C
26	Field Maple	8m	350mm est	N6m E4m S0m W5m	4m	3m	Semi-mature	Average	Average	Low	10-20	Bi-furcates at 3m; crown off-set from trunk with preference to N.	C
27	Wild Service Tree	13m	480mm	5m	7m	5m	Mature	Average	Average	Moderate	10-20	Drawn-up and mutually suppressed.	C
28	Hawthorn	5m	4 stems @ 70mm	3.5m	2.5m	0.1m	Semi-mature	Average	Below average	Low	10-20	Multi-stemmed from base; suppressed crown as overtopped by adjacent specimens.	C
29	Ash	10m	200mm est	3m	5m	5m	Semi-mature	Poor	Average	Low	<10	Bi-furcates at base; tight compression fork with evidence of included bark; very sparsely foliated, approx. 25-0% of the crown remains; in significant, immediate & irreversible overall decline.	U
30	Hornbeam	6m	200mm est	4m	4m	4m	Semi-mature	Average	Below average	Low	10-20	Suppressed crown as overtopped by adjacent specimens; poor crown conformation; of limited potential.	C
31	Field Maple	13m	480mm ivy	N5m E5m S2m W3m	5m	5m	Semi-mature	Average	Average	Low	10-20	Crown off-set from trunk with preference to N.	C

32	English Oak	14m	650mm	N4m E5m S5m W2m	6m	5m	Mature	Average	Below average	Moderate	10-20	Overtopped by dominant neighbouring Oak tree; bi-furcates at 4.5m; structural branch to NW is dead; senescent fungal fruiting bodies at base of trunk to W, thought to be type <i>Pseudoinonotus dryadeus</i> ; major deadwood in crown. Recommend 'detailed inspection' is carried out to assess lower trunk structure and evaluate risk.	C
33	Ash	16m	480mm	N6.5m E5m S4m W4m	N5m E1m S8m W8m	5m	Mature	Average	Average	Moderate	10-20	Ivy on trunk.	C

Hopefully these comments help to address the concerns of the ecology officer. It should be noted that the recommended 1FS Large Colony Box has since been secured to the retained mature ash tree, as recommended (See picture below).

Kind regards

Matt Pendry BSc (Hons) MCIEEM

Recommended bat box



1FS Schwegler Large Colony Bat Box attached to retained ash tree.