

LEGEND

- PROPOSED SITE BOUNDARY
- OTHER LAND WITHIN APPROVED OUTLINE APPLICATION

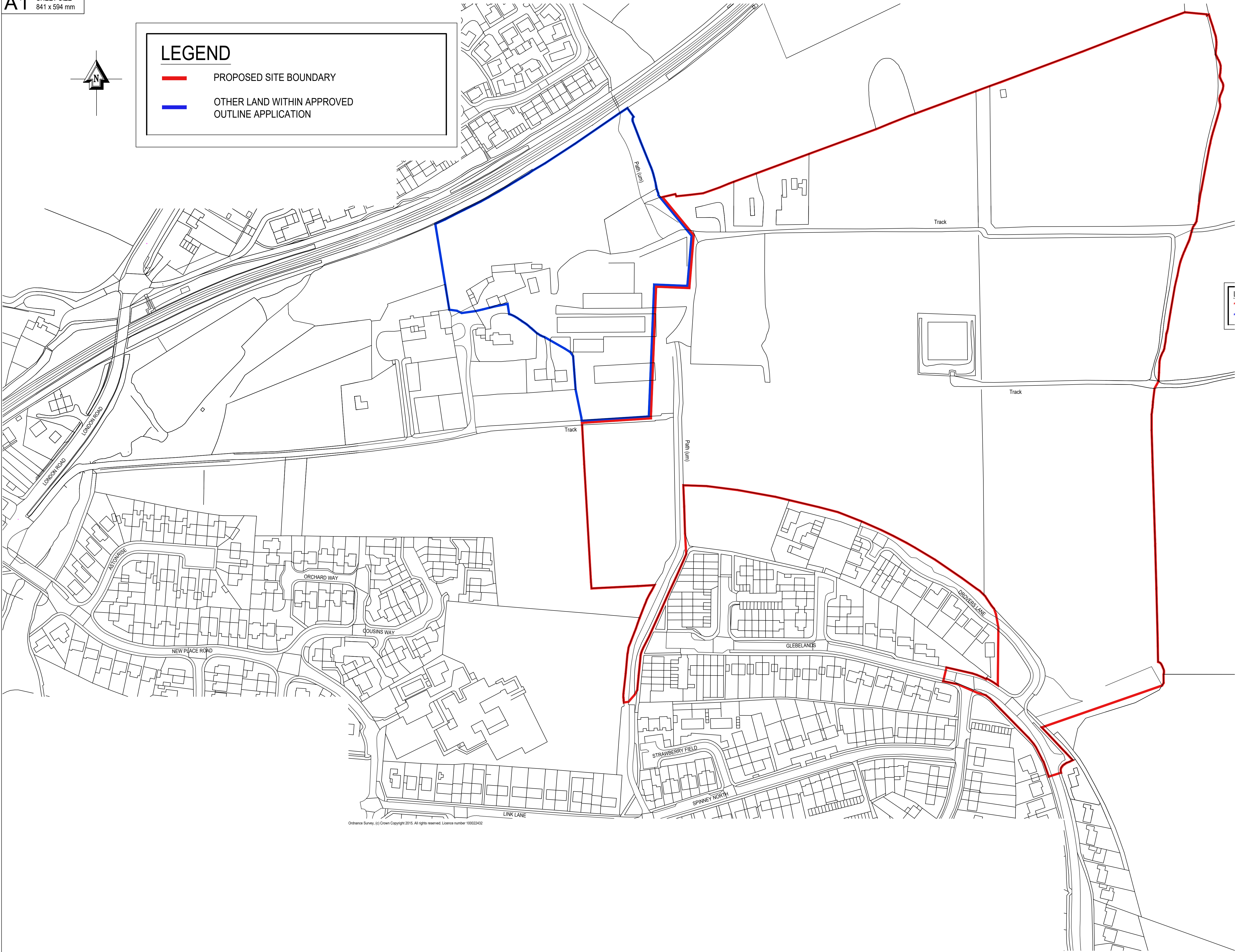

Ordnance Survey, (c) Crown Copyright 2015. All rights reserved. Licence number 100022432

The Contractor is to check and verify all building and site dimensions, levels and sewer invert levels at connection points before work starts. The Contractor is to comply in all respects with current Building Legislation, British Standard Specifications, Building Regulations, Construction (Design & Management) Regulations, Party Wall Act, etc. whether or not specifically stated on this drawing. This drawing must be read with and checked against any structural, geotechnical or other specialist documentation provided. This drawing is not intended to show details of foundations, ground conditions or ground contaminants. Each area of ground relied upon to support any structure depicted (including drainage) must be investigated by the Contractor. A suitable method of foundation should be provided allowing for existing ground conditions. Any suspect or bad ground, contaminants on or within the ground, should be further investigated by a suitable expert. Any earthwork constructions shown indicate typical slopes for guidance only & should be further investigated by a suitable expert. Where existing trees are to be retained they should be subject to a full Arboricultural inspection for safety. All trees are to be planted so as to ensure they are a minimum of 5 metres from buildings and 3 metres from drainage and services. A suitable method of foundation is to be provided to accommodate the proposed tree planting. Geoff Perry Associates Limited do not accept any responsibility for any losses (financial or otherwise) to any Client or third party arising out of the Clients (be it Developer or Contractor but not limited thereto) non-compliance with above mentioned provisions. c. This drawing is the property of Geoff Perry Associates Limited and may not be copied or used for any purpose other than that for which it is supplied without the express written authority of Geoff Perry Associates Limited.

XXX	XXX	XXX	XXX/XX/2021
Rev:	Description:	Initials:	Date:



**Geoff Perry Associates Limited**

The Shrubbery,  
28 Erdington Road,  
Aldridge,  
Walsall,  
WS9 8UH

t: 01922 744 990  
e: enquiries@geoffperryassoc.co.uk

**Client:**  
BDW Southern Counties

**Project:**  
New Place Farm, Pulborough

<b>Title:</b> Location Plan	<b>Job No.</b> A 1192
--------------------------------	--------------------------

**Date:** June 2025      **Scale:** 1:1250 @ A1  
**Drawn by:** IMH      **Checked by:** BC

**Drg Code.**  
H9376-GPA-XX-XX-DR-UD-201001-C01-Site Location Plan

