

Utility apparatus

Underground utility apparatus
Mechanical inspection for the installation of underground apparatus and drainage sewers any roots present and can change the local hydrology in a way that adversely affects the health of the tree. For this reason, the use of mechanical inspection is not recommended as a means of all underground apparatus. Wherever possible, apparatus should be kept outside of RPA's. Where this is not possible, it is preferable to keep apparatus together in common ducts, all inspection chambers should be kept outside of RPA's. Where underground apparatus is to pass within the RPA's, detailed plans showing the proposed route should be drawn up in conjunction with the project arboriculturist. In such cases trenchless insertion can be used to install the apparatus. Wherever possible, the apparatus should be installed outside of the RPA's. If this option is not feasible and providing roots can be retained and protected excavations should be undertaken using hand held tools (air-spade, forks, shovels) or a combination of these methods. Any design and installation should be undertaken in accordance with the National Joint Utilities Guidelines (N.JUG).

Above-ground utility apparatus
The installation of above-ground utility apparatus (e.g. CCTV cameras and lighting) should be undertaken in accordance with the project arboriculturist's recommendations. Tree branches can be pruned back with care to provide space, though care should be taken not to remove more than 25% of the crown. The current and future crown size of the tree should be assessed. The design solution unless this is a suitable management outcome for the tree. Any pruning should be undertaken in accordance with BS5968:2010

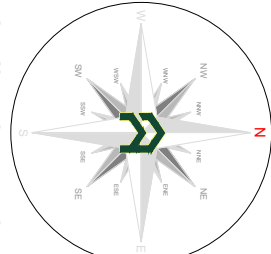

Indicative only

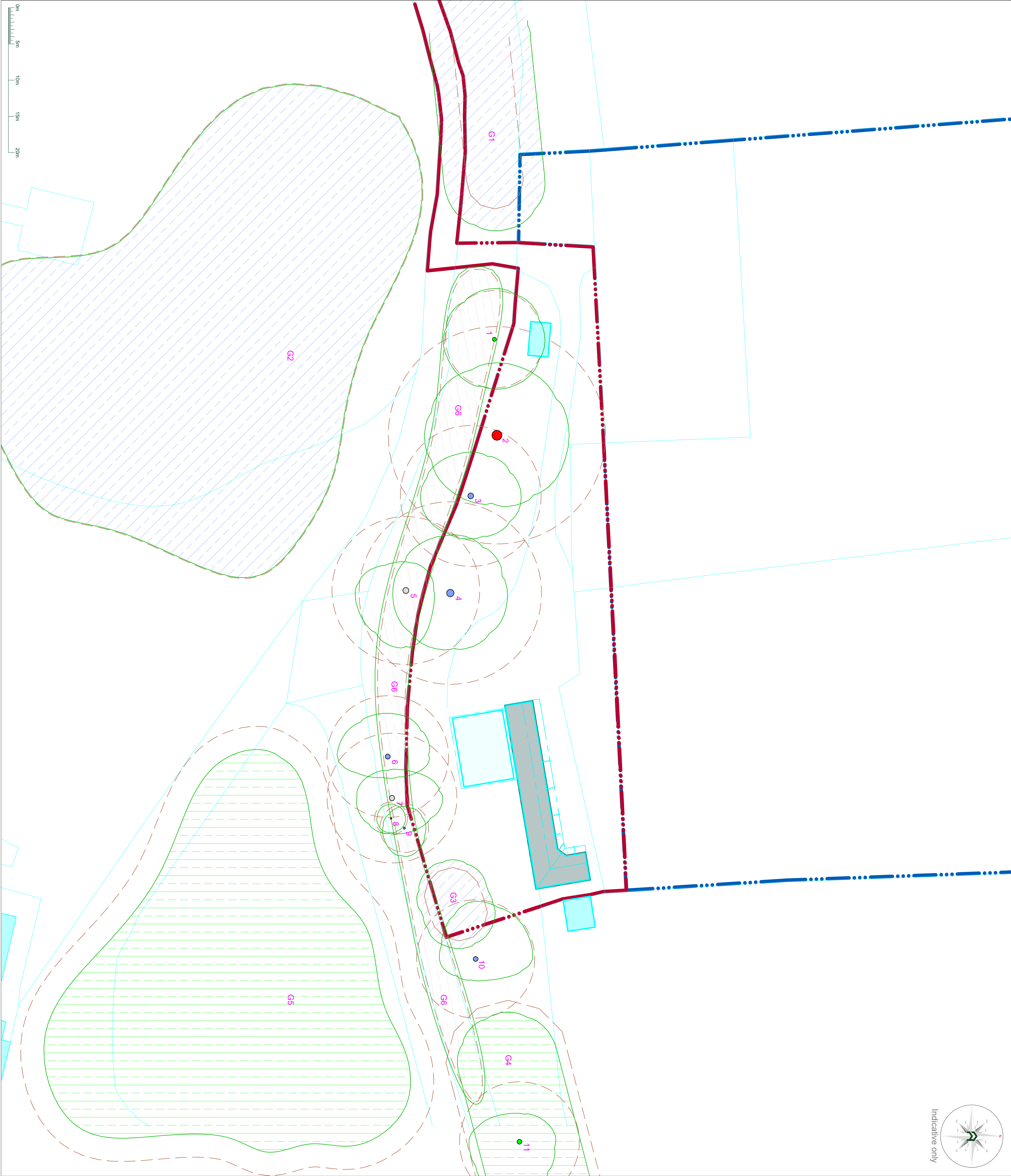

Arboricultural Impact Summary

Impacts	Nos. of trees
Trees to be removed	0
Category 1 (subject to be removed (partial removal of canopy))	0 (0)
Trees with proposed removal into RPA's	0
Category 1 (subject to be removed (partial removal of canopy))	0
Trees that will require pruning	2
Category 1 (subject to be removed (partial removal of canopy))	0
Trees to be transplanted	0
Category 1 (subject to be removed (partial removal of canopy))	0

Tree Work Schedule

No.	Species	Works	Category
2	Beech	• Crown clean, remove all dead, diseased, or any hanging limbs. • Crown lift to canopy to be above 10m	U
4	Beech	• Crown lift to canopy to be above 10m	B

All tree work is to be undertaken in accordance with British Standard BS 5968:2010 Tree work - Recommendations.
Care is to be taken of the ground around retained trees to make sure that it does not become compacted as a result of tree surgery operations. No equipment or vehicles such as timber towers, tractors, any retained trees, to prevent subsequent compaction and root death.

Arboricultural Method Statement

All tree work is to be undertaken in accordance with British Standard BS 5968:2010 Tree work - Recommendations.
Care is to be taken of the ground around retained trees to make sure that it does not become compacted as a result of tree surgery operations. No equipment or vehicles such as timber towers, tractors, any retained trees, to prevent subsequent compaction and root death.



Unit 3, Well House Barns, Chester, CH4 0DH
<https://arbtech.co.uk> 01244 561170

Project:

Oaklands Stud,
Forest Grange,
Horsham,
West Sussex,
RH13 6HX.

Client:

Ms Andrea Starns

Drawing:

Arboricultural Impact Assessment

Based on:
2405TA_000 & 2405TA_200

Drawing No:

Arbtech AIA 01

Date:

Oct 2025

Scale:

1:250 @ A1

Drawn:

MGM

Rev:

Key:

Tree Nos.:	Tree Category	Trunks
1	Category 'A' trees	Category 'A' trees
2	Category 'B' trees	Category 'B' trees
3	Category 'C' trees	Category 'C' trees

All tree work is to be undertaken in accordance with British Standard BS 5968:2010 Tree work - Recommendations.
Care is to be taken of the ground around retained trees to make sure that it does not become compacted as a result of tree surgery operations. No equipment or vehicles such as timber towers, tractors, any retained trees, to prevent subsequent compaction and root death.