

© Crown copyright and Landmark Information Group Limited 2018. All Rights Reserved.



**Geo-Environmental  
Sussex**

**Published 1898 - 1899**

**Source map scale - 1:10,560**

The historical maps shown were reproduced from maps predominantly held at the scale adopted for England, Wales and Scotland in the 1840's. In 1854 the 1:2,500 scale was adopted for mapping urban areas; these maps were used to update the 1:10,560 maps. The published date given therefore is often some years later than the surveyed date. Before 1938, all OS maps were based on the Cassini Projection, with independent surveys of a single county or group of counties, giving rise to significant inaccuracies in outlying areas. In the late 1940's, a Provisional Edition was produced, which updated the 1:10,560 mapping from a number of sources. The maps appear unfinished - with all military camps and other strategic sites removed. These maps were initially overprinted with the National Grid. In 1970, the first 1:10,000 maps were produced using the Transverse Mercator Projection. The revision process continued until recently, with new editions appearing every 10 years or so for urban areas.

### Map Name(s) and Date(s)

002SE 1899 1:10,560	003SW 1899 1:10,560
013NE 1898 1:10,560	014NW 1899 1:10,560

### Historical Map - Slice A

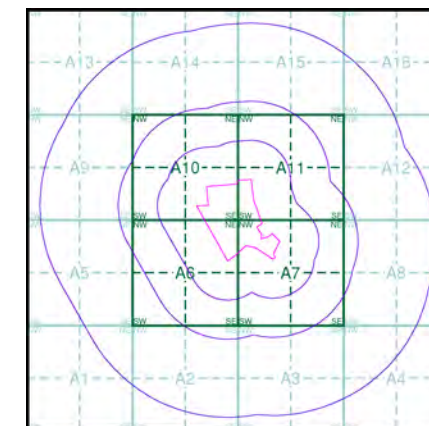

### Order Details

Order Number: 186643744\_1\_1  
Customer Ref: GE17826  
National Grid Reference: 517380, 133790  
Slice: A  
Site Area (Ha): 14.86  
Search Buffer (m): 1000

### Site Details

2 Graylands Farm Cottages, Langhurstwood Road,  
HORSHAM, RH12 4QD

**Landmark**  
INFORMATION GROUP

Tel: 0844 844 9952  
Fax: 0844 844 9951  
Web: [www.envirocheck.co.uk](http://www.envirocheck.co.uk)



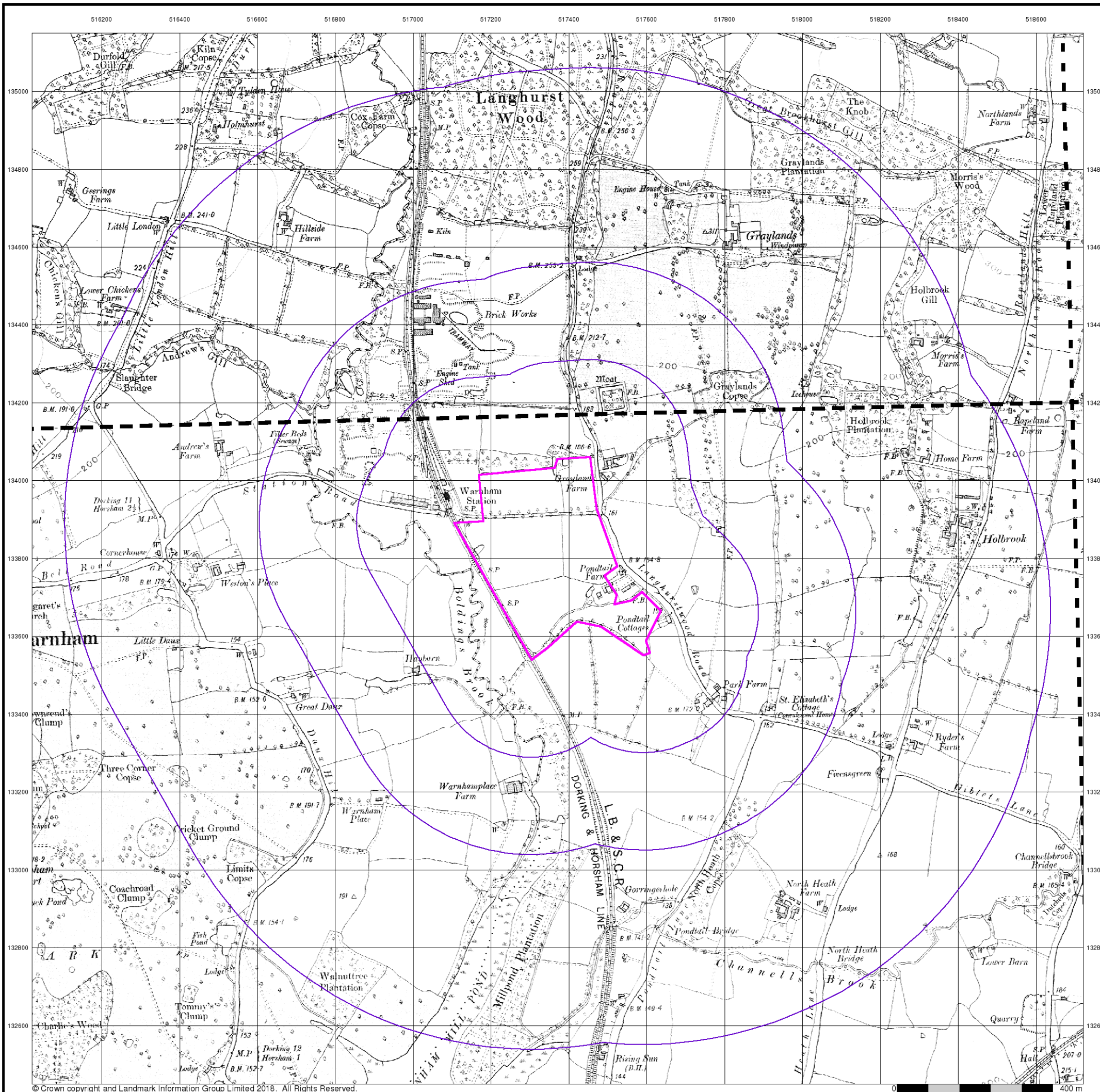

© Crown copyright and Landmark Information Group Limited 2018. All Rights Reserved.



## Geo-Environmental Sussex

Published 1913 - 1914

Source map scale - 1:10,560

The historical maps shown were reproduced from maps predominantly held at the scale adopted for England, Wales and Scotland in the 1840's. In 1854 the 1:2,500 scale was adopted for mapping urban areas; these maps were used to update the 1:10,560 maps. The published date given therefore is often some years later than the surveyed date. Before 1938, all OS maps were based on the Cassini Projection, with independent surveys of a single county or group of counties, giving rise to significant inaccuracies in outlying areas. In the late 1940's, a Provisional Edition was produced, which updated the 1:10,560 mapping from a number of sources. The maps appear unfinished - with all military camps and other strategic sites removed. These maps were initially overprinted with the National Grid. In 1970, the first 1:10,000 maps were produced using the Transverse Mercator Projection. The revision process continued until recently, with new editions appearing every 10 years or so for urban areas.

### Map Name(s) and Date(s)

002SE 1914 1:10,560	003SW 1913 1:10,560
013NE 1913 1:10,560	014NW 1913 1:10,560

### Historical Map - Slice A

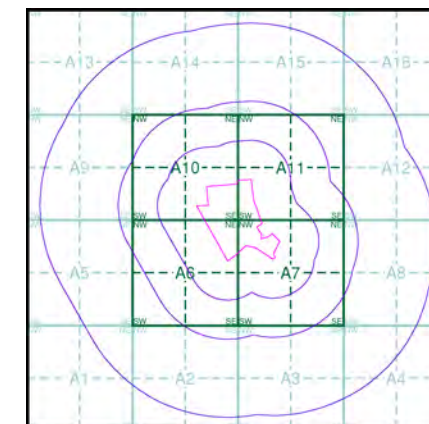

### Order Details

Order Number: 186643744\_1\_1  
Customer Ref: GE17826  
National Grid Reference: 517380, 133790  
Slice: A  
Site Area (Ha): 14.86  
Search Buffer (m): 1000

### Site Details

2 Graylands Farm Cottages, Langhurstwood Road,  
HORSHAM, RH12 4QD

**Landmark**  
INFORMATION GROUP

Tel: 0844 844 9952  
Fax: 0844 844 9951  
Web: [www.envirocheck.co.uk](http://www.envirocheck.co.uk)



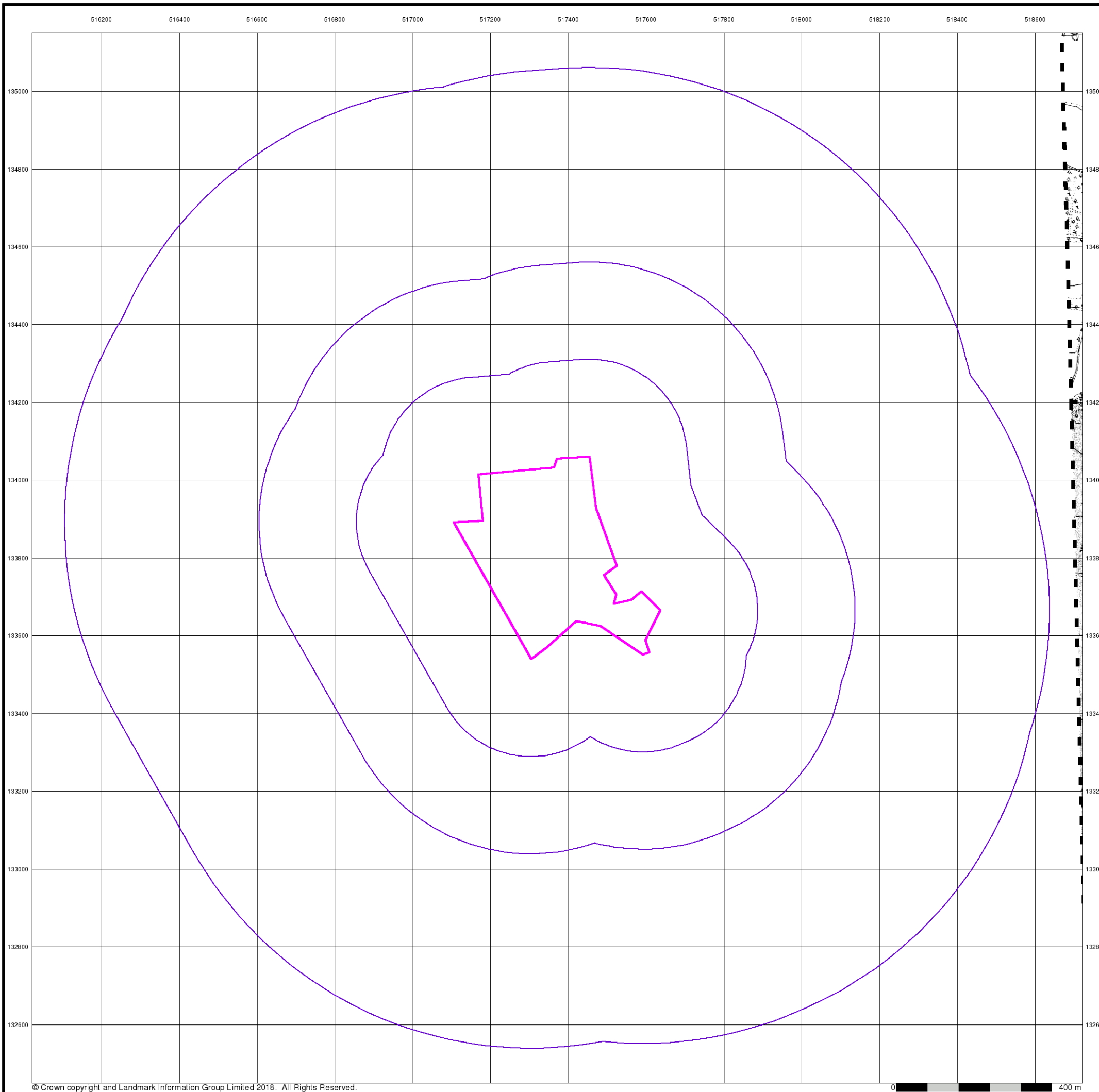

© Crown copyright and Landmark Information Group Limited 2018. All Rights Reserved.



**Geo-Environmental  
Sussex**

**Published 1913**

**Source map scale - 1:10,560**

The historical maps shown were reproduced from maps predominantly held at the scale adopted for England, Wales and Scotland in the 1840's. In 1854 the 1:2,500 scale was adopted for mapping urban areas; these maps were used to update the 1:10,560 maps. The published date given therefore is often some years later than the surveyed date. Before 1938, all OS maps were based on the Cassini Projection, with independent surveys of a single county or group of counties, giving rise to significant inaccuracies in outlying areas. In the late 1940's, a Provisional Edition was produced, which updated the 1:10,560 mapping from a number of sources. The maps appear unfinished - with all military camps and other strategic sites removed. These maps were initially overprinted with the National Grid. In 1970, the first 1:10,000 maps were produced using the Transverse Mercator Projection. The revision process continued until recently, with new editions appearing every 10 years or so for urban areas.

### Map Name(s) and Date(s)

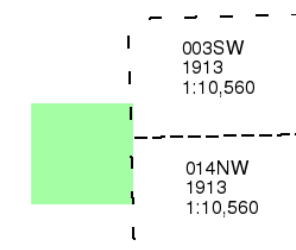

### Historical Map - Slice A

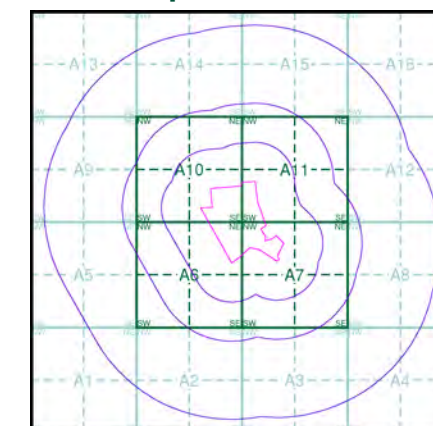

### Order Details

Order Number: 186643744\_1\_1  
Customer Ref: GE17826  
National Grid Reference: 517380, 133790  
Slice: A  
Site Area (Ha): 14.86  
Search Buffer (m): 1000

### Site Details

2 Graylands Farm Cottages, Langhurstwood Road,  
HORSHAM, RH12 4QD

**Landmark**  
INFORMATION GROUP

Tel: 0844 844 9952  
Fax: 0844 844 9951  
Web: [www.envirocheck.co.uk](http://www.envirocheck.co.uk)

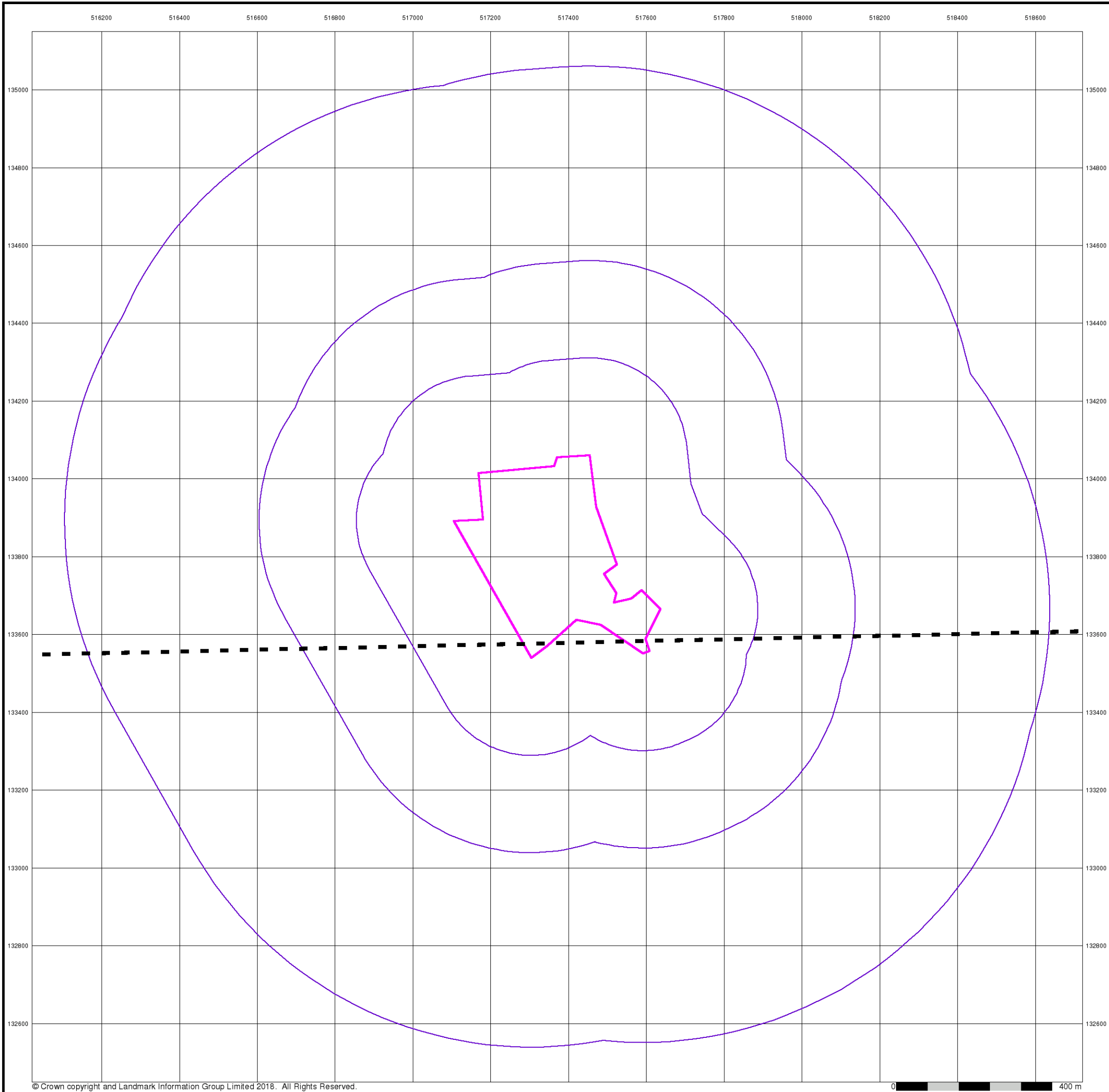

© Crown copyright and Landmark Information Group Limited 2018. All Rights Reserved.

0 400 m



**Geo-Environmental  
Surrey**

**Published 1919**

**Source map scale - 1:10,560**

The historical maps shown were reproduced from maps predominantly held at the scale adopted for England, Wales and Scotland in the 1840's. In 1854 the 1:2,500 scale was adopted for mapping urban areas; these maps were used to update the 1:10,560 maps. The published date given therefore is often some years later than the surveyed date. Before 1938, all OS maps were based on the Cassini Projection, with independent surveys of a single county or group of counties, giving rise to significant inaccuracies in outlying areas. In the late 1940's, a Provisional Edition was produced, which updated the 1:10,560 mapping from a number of sources. The maps appear unfinished - with all military camps and other strategic sites removed. These maps were initially overprinted with the National Grid. In 1970, the first 1:10,000 maps were produced using the Transverse Mercator Projection. The revision process continued until recently, with new editions appearing every 10 years or so for urban areas.

**Map Name(s) and Date(s)**

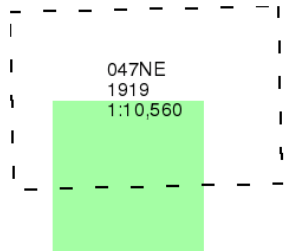

**Historical Map - Slice A**

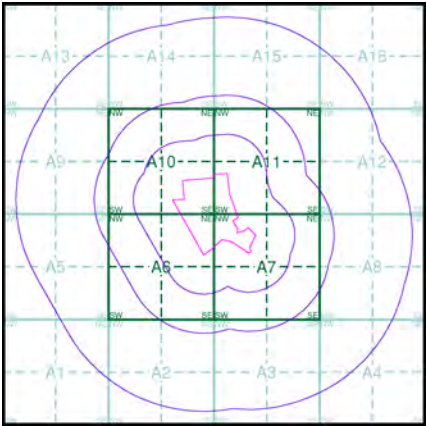

**Order Details**

Order Number: 186643744\_1\_1  
Customer Ref: GE17826  
National Grid Reference: 517380, 133790  
Slice: A  
Site Area (Ha): 14.86  
Search Buffer (m): 1000

**Site Details**

2 Graylands Farm Cottages, Langhurstwood Road,  
HORSHAM, RH12 4QD



Tel: 0844 844 9952  
Fax: 0844 844 9951  
Web: [www.envirocheck.co.uk](http://www.envirocheck.co.uk)



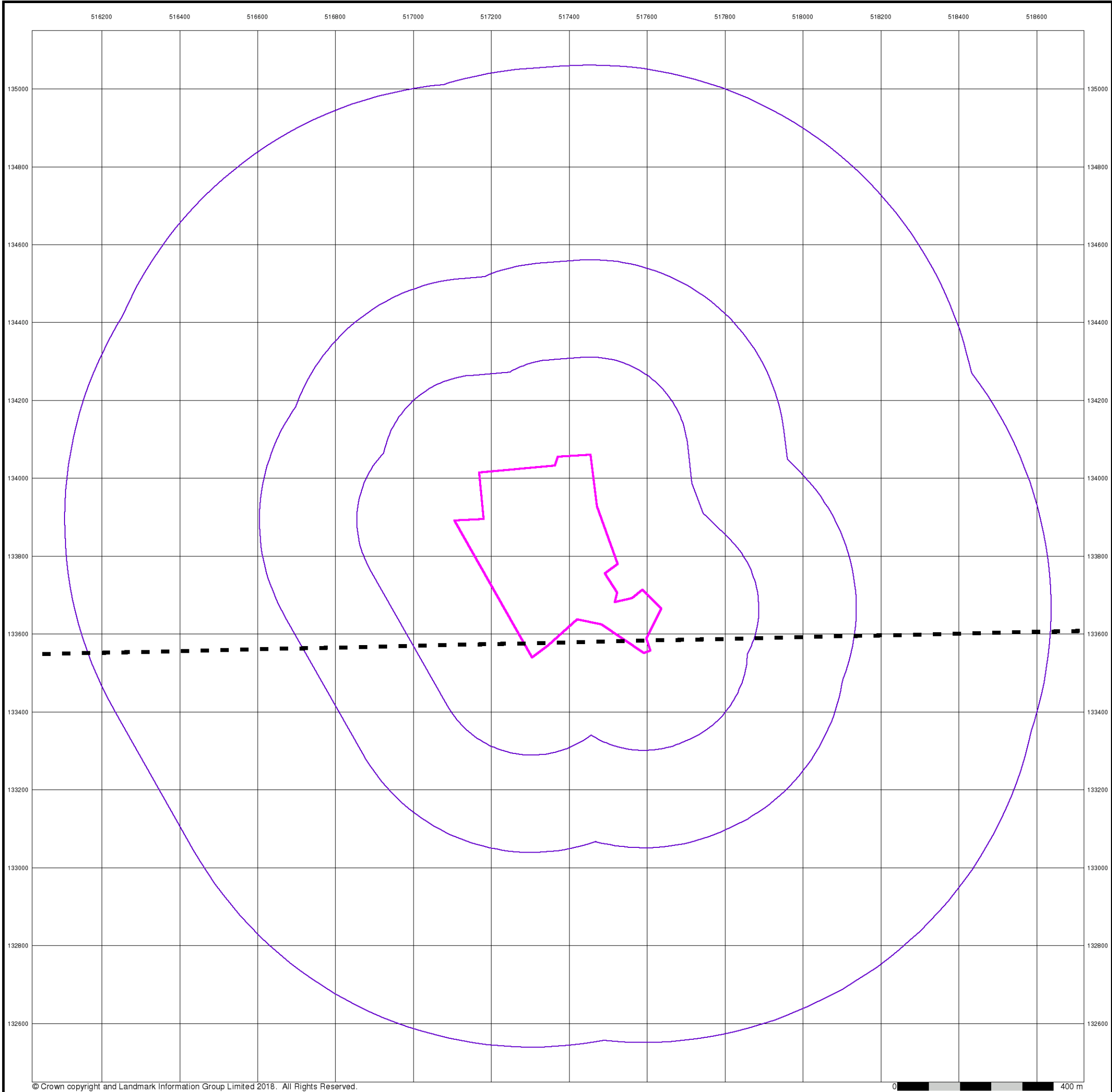

© Crown copyright and Landmark Information Group Limited 2018. All Rights Reserved.

0 400 m



**Geo-Environmental  
Surrey**

**Published 1920**

**Source map scale - 1:10,560**

The historical maps shown were reproduced from maps predominantly held at the scale adopted for England, Wales and Scotland in the 1840's. In 1854 the 1:2,500 scale was adopted for mapping urban areas; these maps were used to update the 1:10,560 maps. The published date given therefore is often some years later than the surveyed date. Before 1938, all OS maps were based on the Cassini Projection, with independent surveys of a single county or group of counties, giving rise to significant inaccuracies in outlying areas. In the late 1940's, a Provisional Edition was produced, which updated the 1:10,560 mapping from a number of sources. The maps appear unfinished - with all military camps and other strategic sites removed. These maps were initially overprinted with the National Grid. In 1970, the first 1:10,000 maps were produced using the Transverse Mercator Projection. The revision process continued until recently, with new editions appearing every 10 years or so for urban areas.

**Map Name(s) and Date(s)**

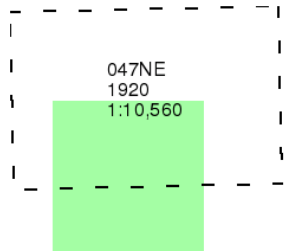

**Historical Map - Slice A**

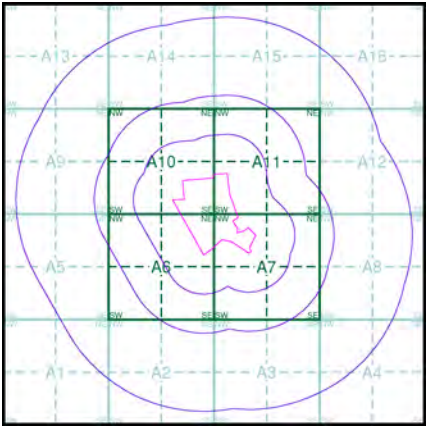

**Order Details**

Order Number: 186643744\_1\_1  
Customer Ref: GE17826  
National Grid Reference: 517380, 133790  
Slice: A  
Site Area (Ha): 14.86  
Search Buffer (m): 1000

**Site Details**

2 Graylands Farm Cottages, Langhurstwood Road,  
HORSHAM, RH12 4QD



Tel: 0844 844 9952  
Fax: 0844 844 9951  
Web: [www.envirocheck.co.uk](http://www.envirocheck.co.uk)



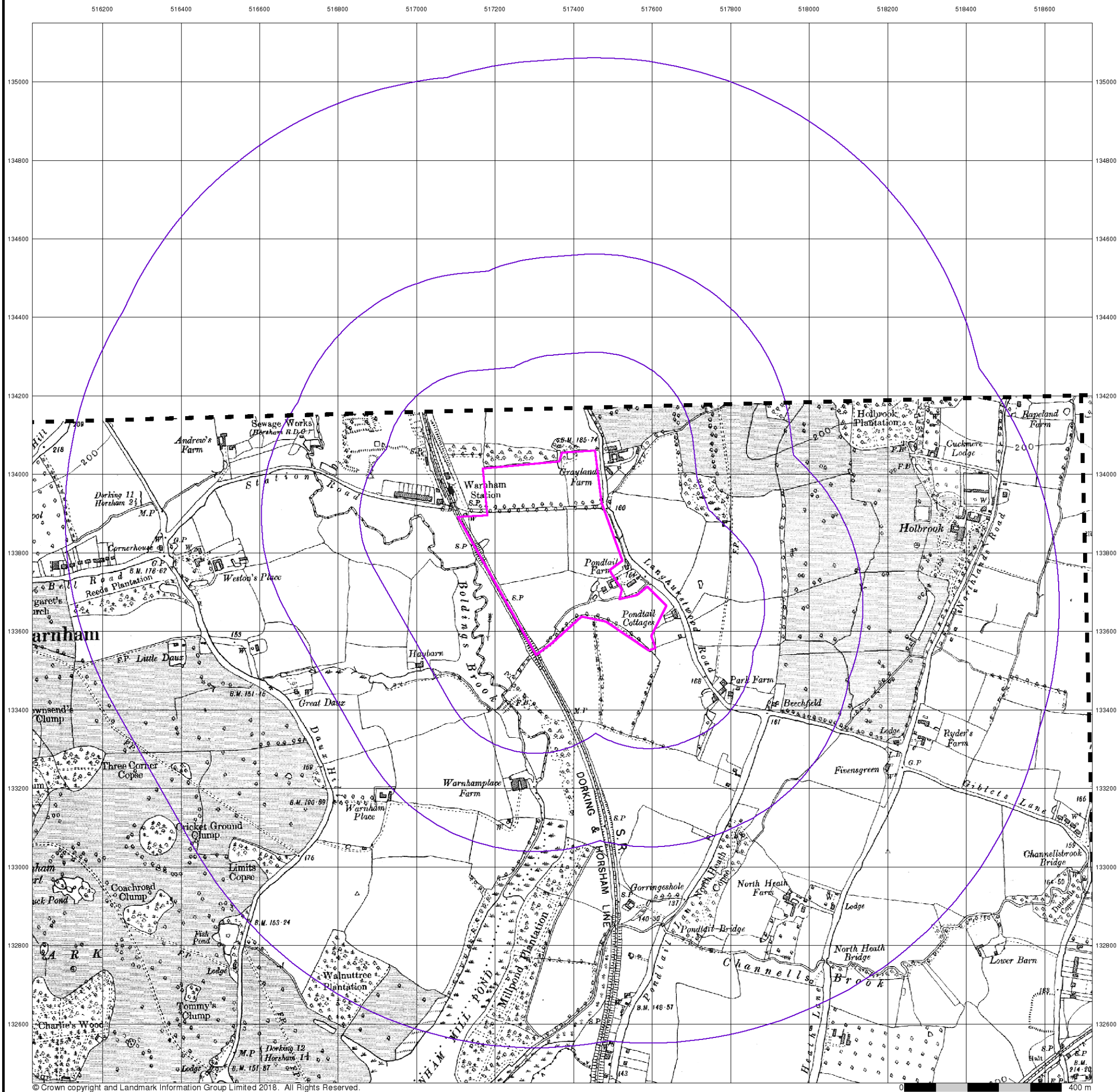

© Crown copyright and Landmark Information Group Limited 2018. All Rights Reserved.



# Geo-Environmental Sussex

Published 1932

Source map scale - 1:10,560

The historical maps shown were reproduced from maps predominantly held at the scale adopted for England, Wales and Scotland in the 1840's. In 1854 the 1:2,500 scale was adopted for mapping urban areas; these maps were used to update the 1:10,560 maps. The published date given therefore is often some years later than the surveyed date. Before 1938, all OS maps were based on the Cassini Projection, with independent surveys of a single county or group of counties, giving rise to significant inaccuracies in outlying areas. In the late 1940's, a Provisional Edition was produced, which updated the 1:10,560 mapping from a number of sources. The maps appear unfinished - with all military camps and other strategic sites removed. These maps were initially overprinted with the National Grid. In 1970, the first 1:10,000 maps were produced using the Transverse Mercator Projection. The revision process continued until recently, with new editions appearing every 10 years or so for urban areas.

## Map Name(s) and Date(s)

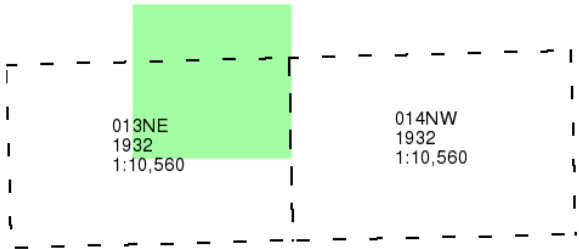

## Historical Map - Slice A

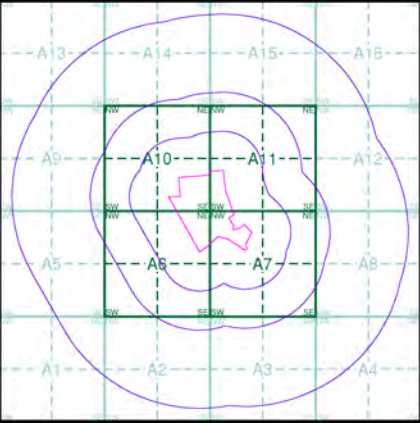

## Order Details

Order Number: 186643744\_1\_1  
Customer Ref: GE17826  
National Grid Reference: 517380, 133790  
Slice: A  
Site Area (Ha): 14.86  
Search Buffer (m): 1000

## Site Details

2 Graylands Farm Cottages, Langhurstwood Road,  
HORSHAM, RH12 4QD



Tel: 0844 844 9952  
Fax: 0844 844 9951  
Web: [www.envirocheck.co.uk](http://www.envirocheck.co.uk)







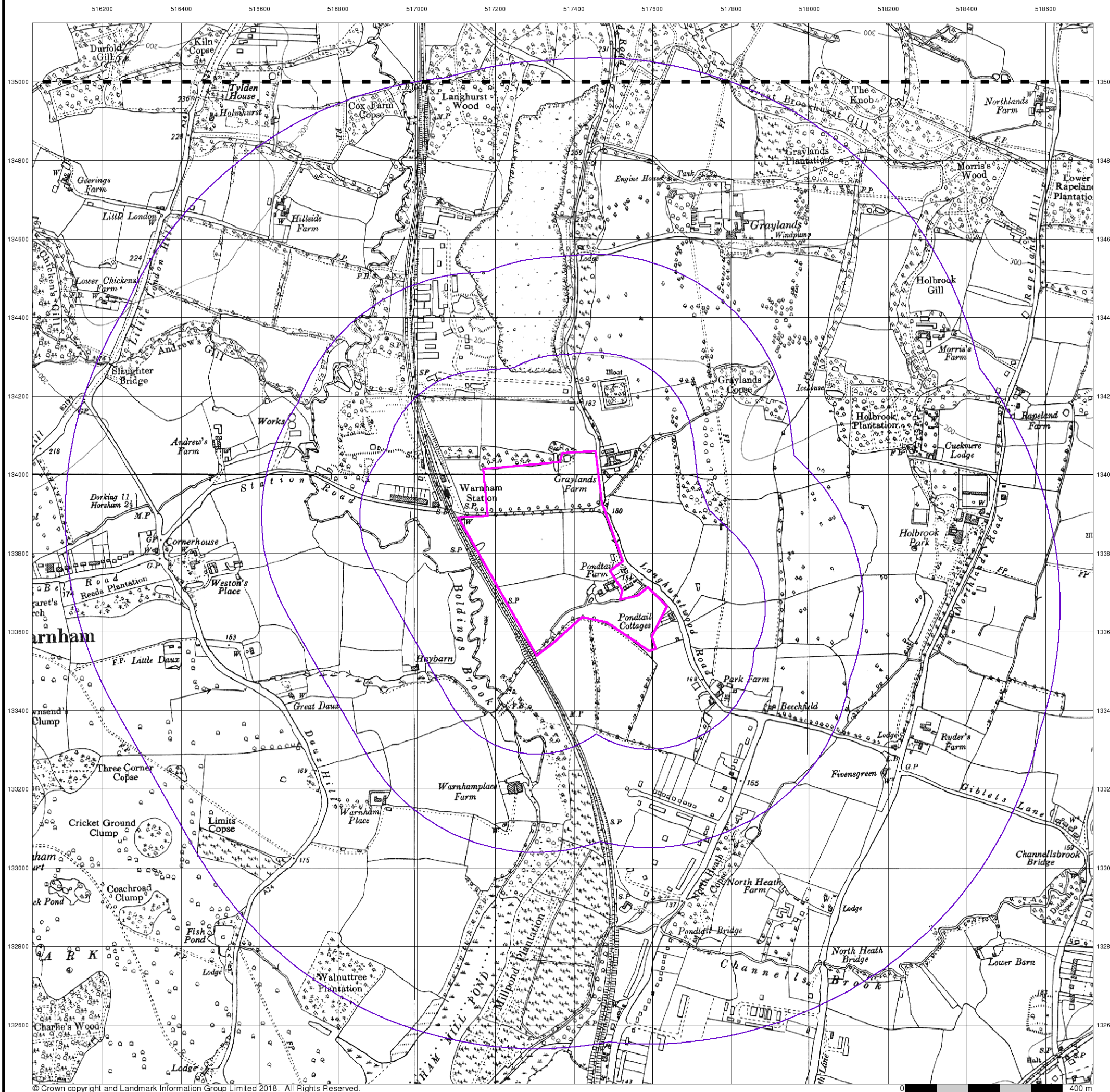

© Crown copyright and Landmark Information Group Limited 2018. All Rights Reserved.



## Geo-Environmental Ordnance Survey Plan

Published 1961 - 1962

Source map scale - 1:10,000

The historical maps shown were reproduced from maps predominantly held at the scale adopted for England, Wales and Scotland in the 1840's. In 1854 the 1:2,500 scale was adopted for mapping urban areas; these maps were used to update the 1:10,560 maps. The published date given therefore is often some years later than the surveyed date. Before 1938, all OS maps were based on the Cassini Projection, with independent surveys of a single county or group of counties, giving rise to significant inaccuracies in outlying areas. In the late 1940's, a Provisional Edition was produced, which updated the 1:10,560 mapping from a number of sources. The maps appear unfinished - with all military camps and other strategic sites removed. These maps were initially overprinted with the National Grid. In 1970, the first 1:10,000 maps were produced using the Transverse Mercator Projection. The revision process continued until recently, with new editions appearing every 10 years or so for urban areas.

### Map Name(s) and Date(s)

TQ13NE	1962	1:10,560
TQ13SE	1961	1:10,560

### Historical Map - Slice A

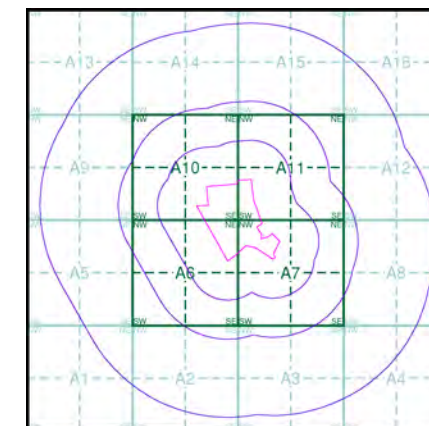

### Order Details

Order Number: 186643744\_1\_1  
Customer Ref: GE17826  
National Grid Reference: 517380, 133790  
Slice: A  
Site Area (Ha): 14.86  
Search Buffer (m): 1000

### Site Details

2 Graylands Farm Cottages, Langhurstwood Road,  
HORSHAM, RH12 4QD

**Landmark**  
INFORMATION GROUP

Tel: 0844 844 9952  
Fax: 0844 844 9951  
Web: [www.envirocheck.co.uk](http://www.envirocheck.co.uk)



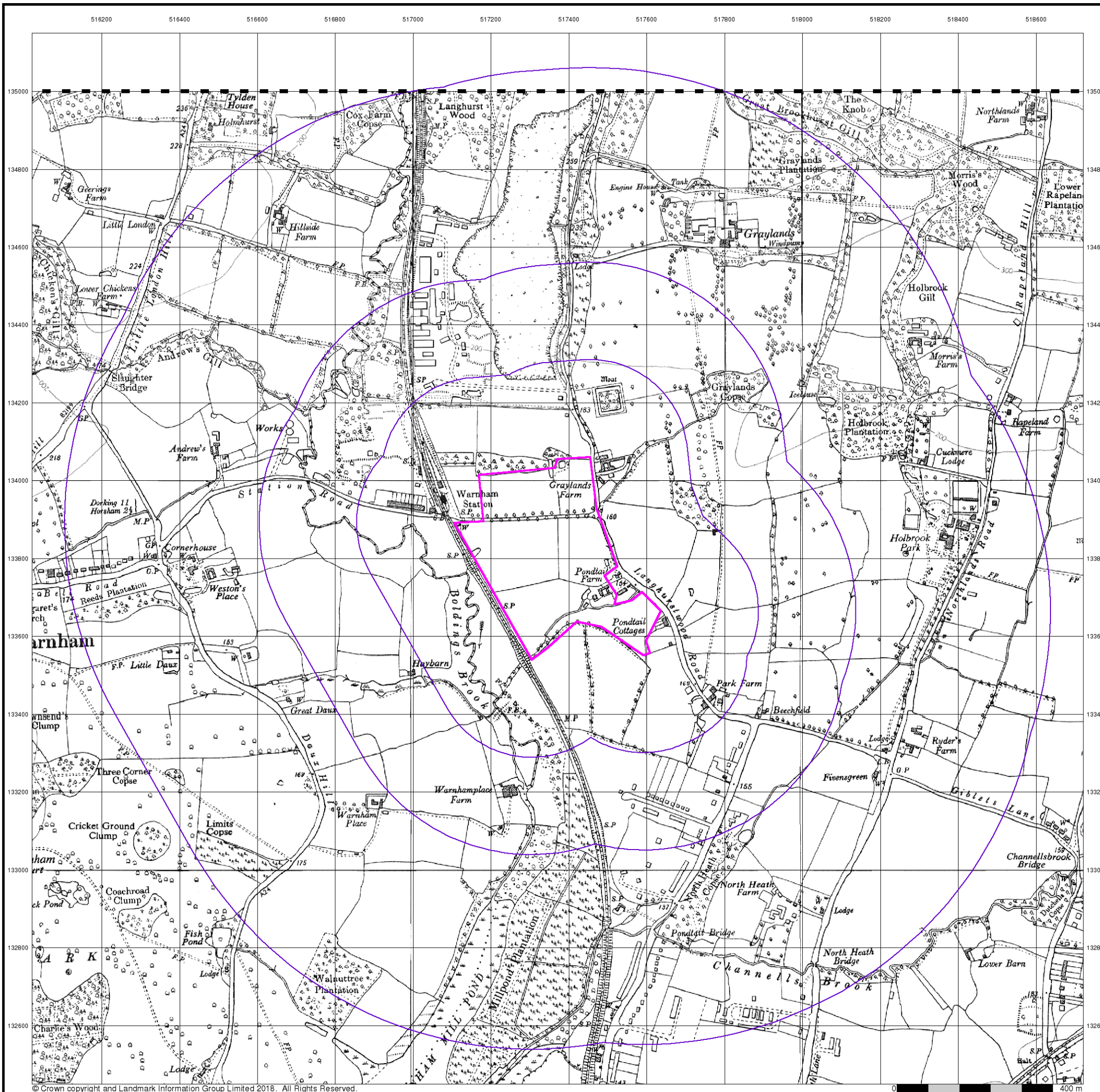

© Crown copyright and Landmark Information Group Limited 2018. All Rights Reserved.



## Geo-Environmental Ordnance Survey Plan

Published 1966

Source map scale - 1:10,000

The historical maps shown were reproduced from maps predominantly held at the scale adopted for England, Wales and Scotland in the 1840's. In 1854 the 1:2,500 scale was adopted for mapping urban areas; these maps were used to update the 1:10,560 maps. The published date given therefore is often some years later than the surveyed date. Before 1938, all OS maps were based on the Cassini Projection, with independent surveys of a single county or group of counties, giving rise to significant inaccuracies in outlying areas. In the late 1940's, a Provisional Edition was produced, which updated the 1:10,560 mapping from a number of sources. The maps appear unfinished - with all military camps and other strategic sites removed. These maps were initially overprinted with the National Grid. In 1970, the first 1:10,000 maps were produced using the Transverse Mercator Projection. The revision process continued until recently, with new editions appearing every 10 years or so for urban areas.

### Map Name(s) and Date(s)

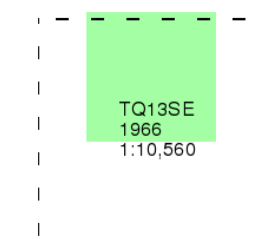

### Historical Map - Slice A

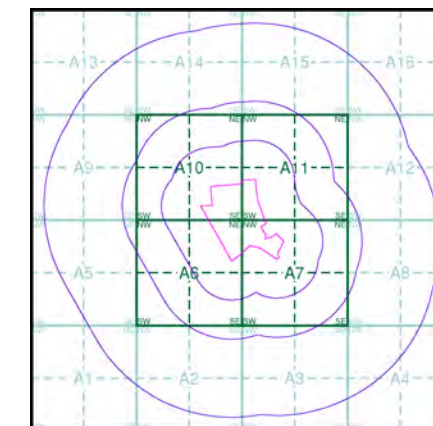

### Order Details

Order Number: 186643744\_1\_1  
Customer Ref: GE17826  
National Grid Reference: 517380, 133790  
Slice: A  
Site Area (Ha): 14.86  
Search Buffer (m): 1000

### Site Details

2 Graylands Farm Cottages, Langhurstwood Road,  
HORSHAM, RH12 4QD

**Landmark**  
INFORMATION GROUP

Tel: 0844 844 9952  
Fax: 0844 844 9951  
Web: [www.envirocheck.co.uk](http://www.envirocheck.co.uk)



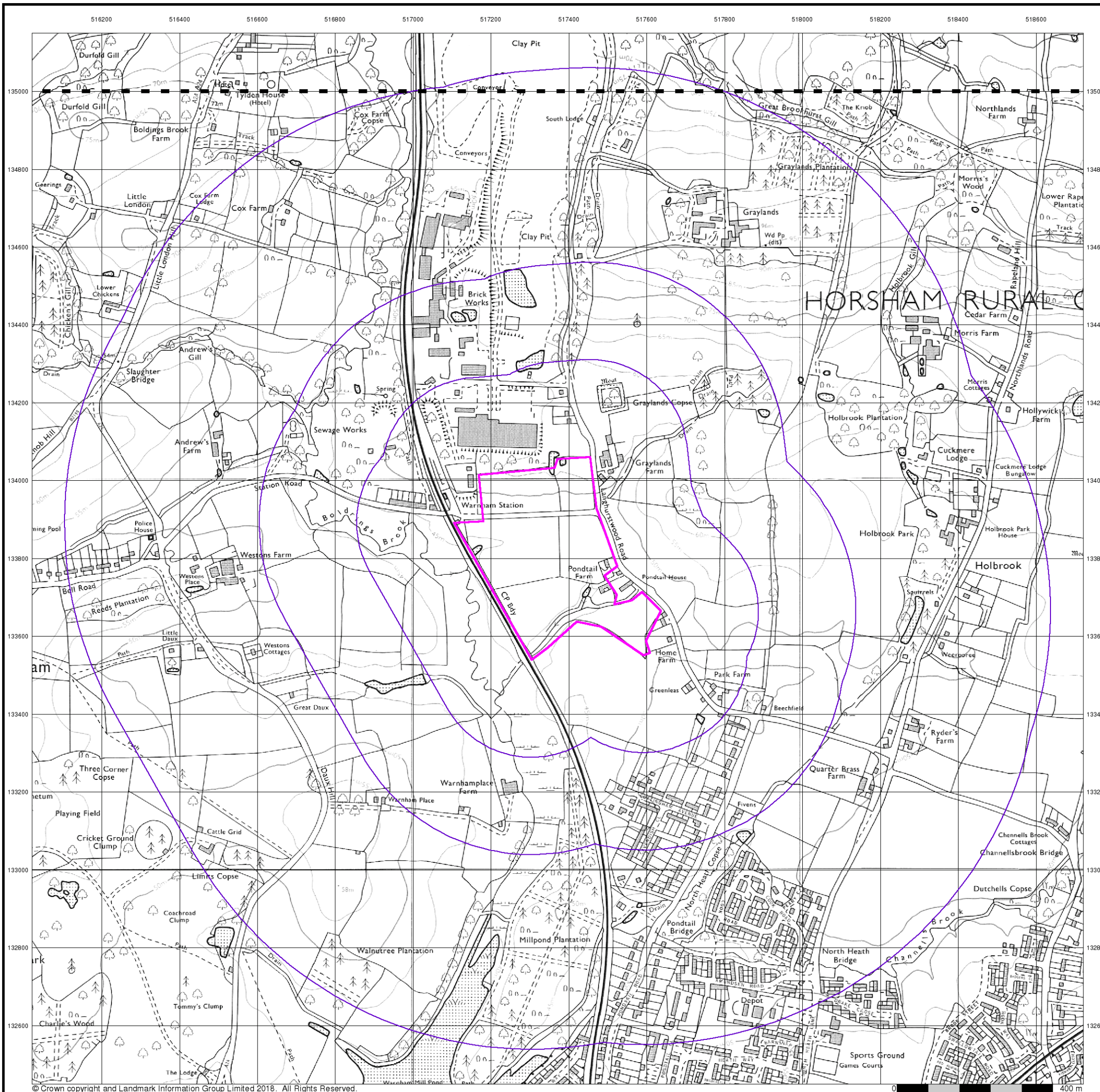

© Crown copyright and Landmark Information Group Limited 2018. All Rights Reserved.



## Geo-Environmental Ordnance Survey Plan

Published 1980 - 1982

Source map scale - 1:10,000

The historical maps shown were reproduced from maps predominantly held at the scale adopted for England, Wales and Scotland in the 1840's. In 1854 the 1:2,500 scale was adopted for mapping urban areas; these maps were used to update the 1:10,560 maps. The published date given therefore is often some years later than the surveyed date. Before 1938, all OS maps were based on the Cassini Projection, with independent surveys of a single county or group of counties, giving rise to significant inaccuracies in outlying areas. In the late 1940's, a Provisional Edition was produced, which updated the 1:10,560 mapping from a number of sources. The maps appear unfinished - with all military camps and other strategic sites removed. These maps were initially overprinted with the National Grid. In 1970, the first 1:10,000 maps were produced using the Transverse Mercator Projection. The revision process continued until recently, with new editions appearing every 10 years or so for urban areas.

### Map Name(s) and Date(s)

TQ13NE	1980	1:10,000
TQ13SE	1982	1:10,000

### Historical Map - Slice A

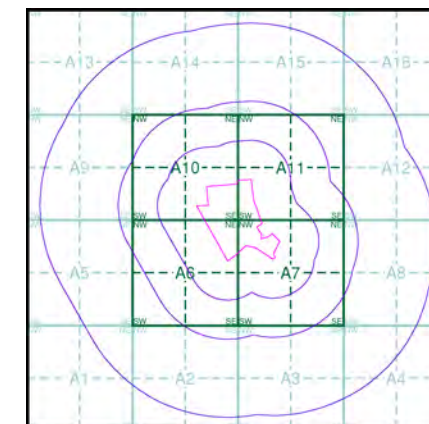

### Order Details

Order Number: 186643744\_1\_1  
Customer Ref: GE17826  
National Grid Reference: 517380, 133790  
Slice: A  
Site Area (Ha): 14.86  
Search Buffer (m): 1000

### Site Details

2 Graylands Farm Cottages, Langhurstwood Road,  
HORSHAM, RH12 4QD

**Landmark**  
INFORMATION GROUP

Tel: 0844 844 9952  
Fax: 0844 844 9951  
Web: [www.envirocheck.co.uk](http://www.envirocheck.co.uk)



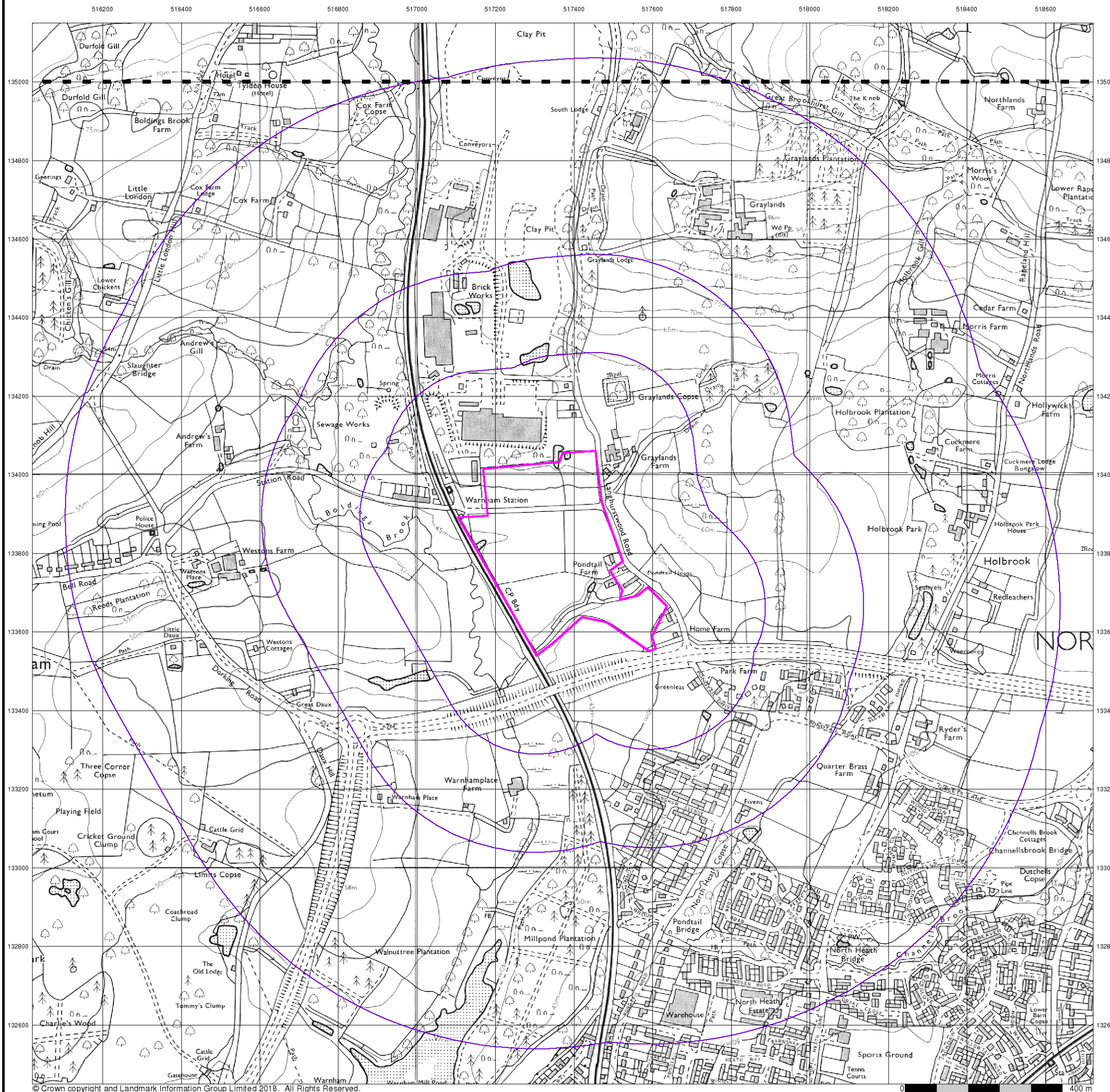

© Crown copyright and Landmark Information Group Limited 2018. All Rights Reserved.



## Geo-Environmental Ordnance Survey Plan

Published 1991 - 1993

Source map scale - 1:10,000

The historical maps shown were reproduced from maps predominantly held at the scale adopted for England, Wales and Scotland in the 1840's. In 1854 the 1:2,500 scale was adopted for mapping urban areas; these maps were used to update the 1:10,560 maps. The published date given therefore is often some years later than the surveyed date. Before 1938, all OS maps were based on the Cassini Projection, with independent surveys of a single county or group of counties, giving rise to significant inaccuracies in outlying areas. In the late 1940's, a Provisional Edition was produced, which updated the 1:10,560 mapping from a number of sources. The maps appear unfinished - with all military camps and other strategic sites removed. These maps were initially overprinted with the National Grid. In 1970, the first 1:10,000 maps were produced using the Transverse Mercator Projection. The revision process continued until recently, with new editions appearing every 10 years or so for urban areas.

### Map Name(s) and Date(s)

TQ13NE	1991	1:10,000
TQ13SE	1993	1:10,000

### Historical Map - Slice A

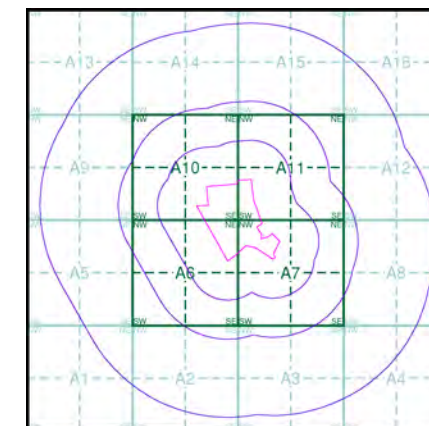

### Order Details

Order Number: 186643744\_1\_1  
Customer Ref: GE17826  
National Grid Reference: 517380, 133790  
Slice: A  
Site Area (Ha): 14.86  
Search Buffer (m): 1000

### Site Details

2 Graylands Farm Cottages, Langhurstwood Road,  
HORSHAM, RH12 4QD

**Landmark**  
INFORMATION GROUP

Tel: 0844 844 9952  
Fax: 0844 844 9951  
Web: [www.envirocheck.co.uk](http://www.envirocheck.co.uk)



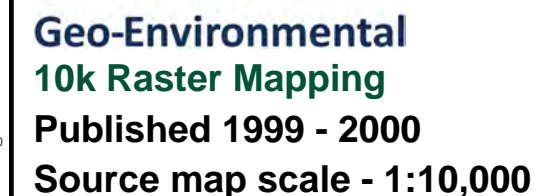

The historical maps shown were produced from the Ordnance Survey's 1:10,000 colour raster mapping. These maps are derived from Landplan which replaced the old 1:10,000 maps originally published in 1970. The data is highly detailed showing buildings, fences and field boundaries as well as all roads, tracks and paths. Road names are also included together with the relevant road number and classification. Boundary information depiction includes county, unitary authority, district, civil parish and constituency.

## Map Name(s) and Date(s)

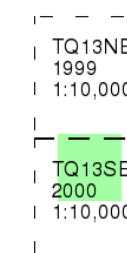

## Historical Map - Slice A

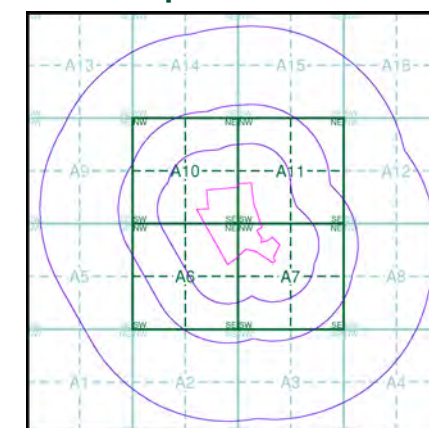

## Order Details

Order Number: 186643744\_1\_1  
Customer Ref: GE17826  
National Grid Reference: 517380, 133790  
Slice: A  
Site Area (Ha): 14.86  
Search Buffer (m): 1000

## Site Details

2 Graylands Farm Cottages, Langhurstwood Road,  
HORSHAM, RH12 4QD

**Landmark**  
INFORMATION GROUP

Tel: 0844 844 9952  
Fax: 0844 844 9951  
Web: [www.envirocheck.co.uk](http://www.envirocheck.co.uk)







The historical maps shown were produced from the Ordnance Survey's 1:10,000 colour raster mapping. These maps are derived from Landplan which replaced the old 1:10,000 maps originally published in 1970. The data is highly detailed showing buildings, fences and field boundaries as well as all roads, tracks and paths. Road names are also included together with the relevant road number and classification. Boundary information depiction includes county, unitary authority, district, civil parish and constituency.

## Map Name(s) and Date(s)

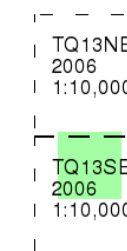

## Historical Map - Slice A

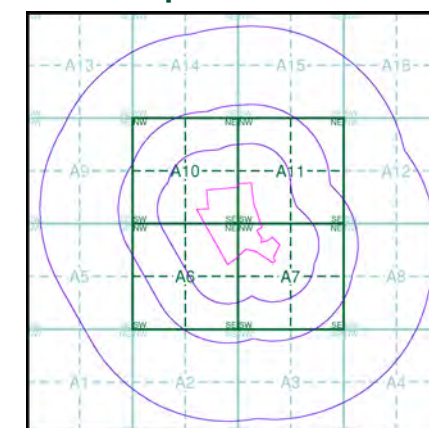

## Order Details

Order Number: 186643744\_1\_1  
Customer Ref: GE17826  
National Grid Reference: 517380, 133790  
Slice: A  
Site Area (Ha): 14.86  
Search Buffer (m): 1000

## Site Details

2 Graylands Farm Cottages, Langhurstwood Road,  
HORSHAM, RH12 4QD

**Landmark**  
INFORMATION GROUP

Tel: 0844 844 9952  
Fax: 0844 844 9951  
Web: [www.envirocheck.co.uk](http://www.envirocheck.co.uk)



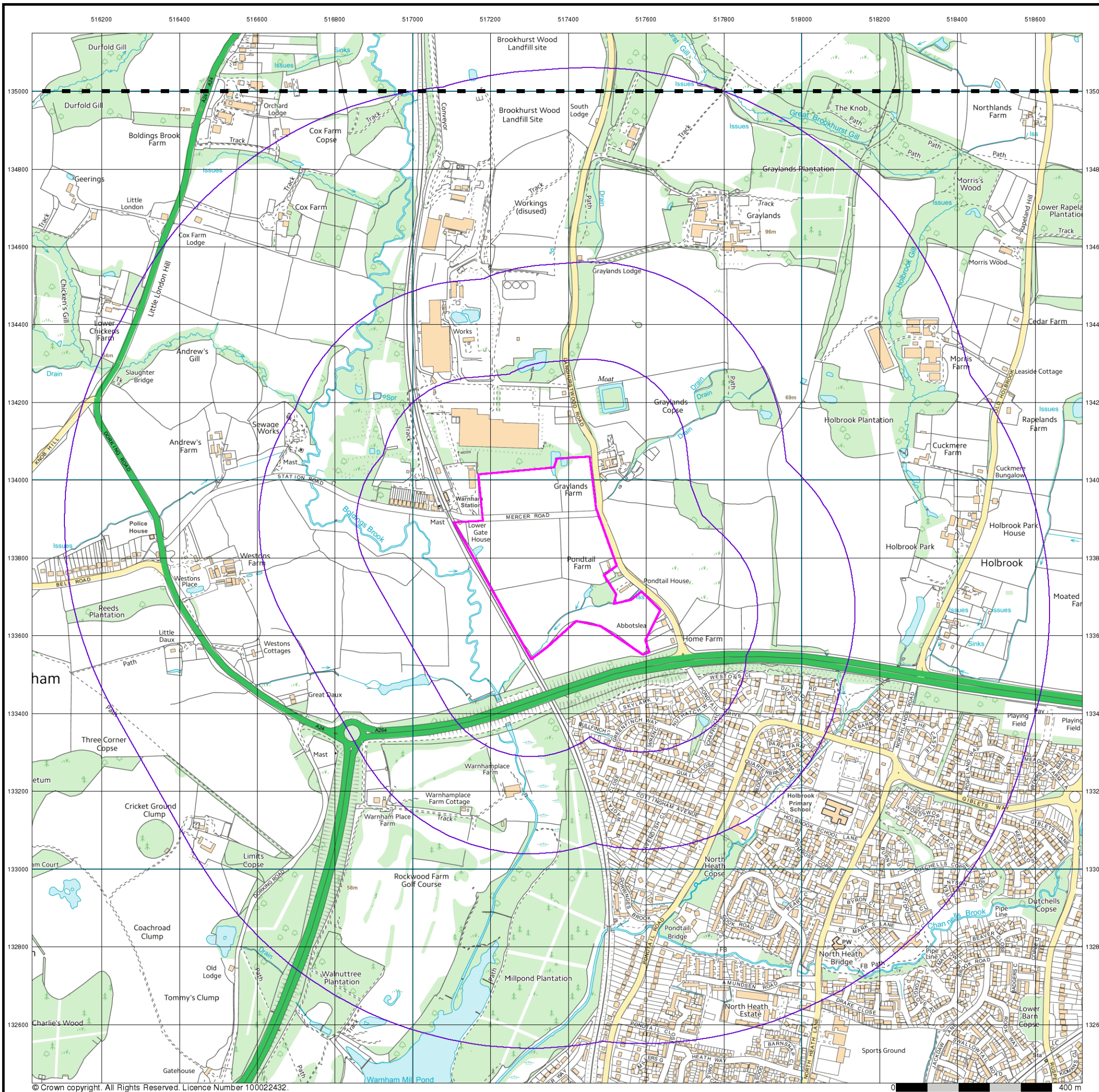

© Crown copyright. All Rights Reserved. Licence Number 100022432.



## Geo-Environmental VectorMap Local

Published 2018

Source map scale - 1:10,000

VectorMap Local (Raster) is Ordnance Survey's highest detailed 'backdrop' mapping product. These maps are produced from OS's VectorMap Local, a simple vector dataset at a nominal scale of 1:10,000, covering the whole of Great Britain, that has been designed for creating graphical mapping. OS VectorMap Local is derived from large-scale information surveyed at 1:1250 scale (covering major towns and cities), 1:2500 scale (smaller towns, villages and developed rural areas), and 1:10 000 scale (mountain, moorland and river estuary areas).

### Map Name(s) and Date(s)

TQ13NE  
2018  
Variable  
TQ13SE  
2018  
Variable

### Historical Map - Slice A

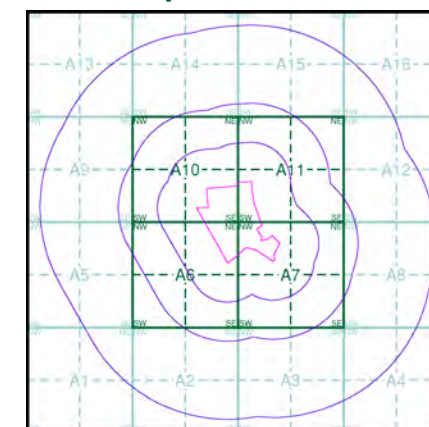

### Order Details

Order Number: 186643744\_1\_1  
Customer Ref: GE17826  
National Grid Reference: 517380, 133790  
Slice: A  
Site Area (Ha): 14.86  
Search Buffer (m): 1000

### Site Details

2 Graylands Farm Cottages, Langhurstwood Road,  
HORSHAM, RH12 4QD

**Landmark**  
INFORMATION GROUP

Tel: 0844 844 9952  
Fax: 0844 844 9951  
Web: [www.envirocheck.co.uk](http://www.envirocheck.co.uk)



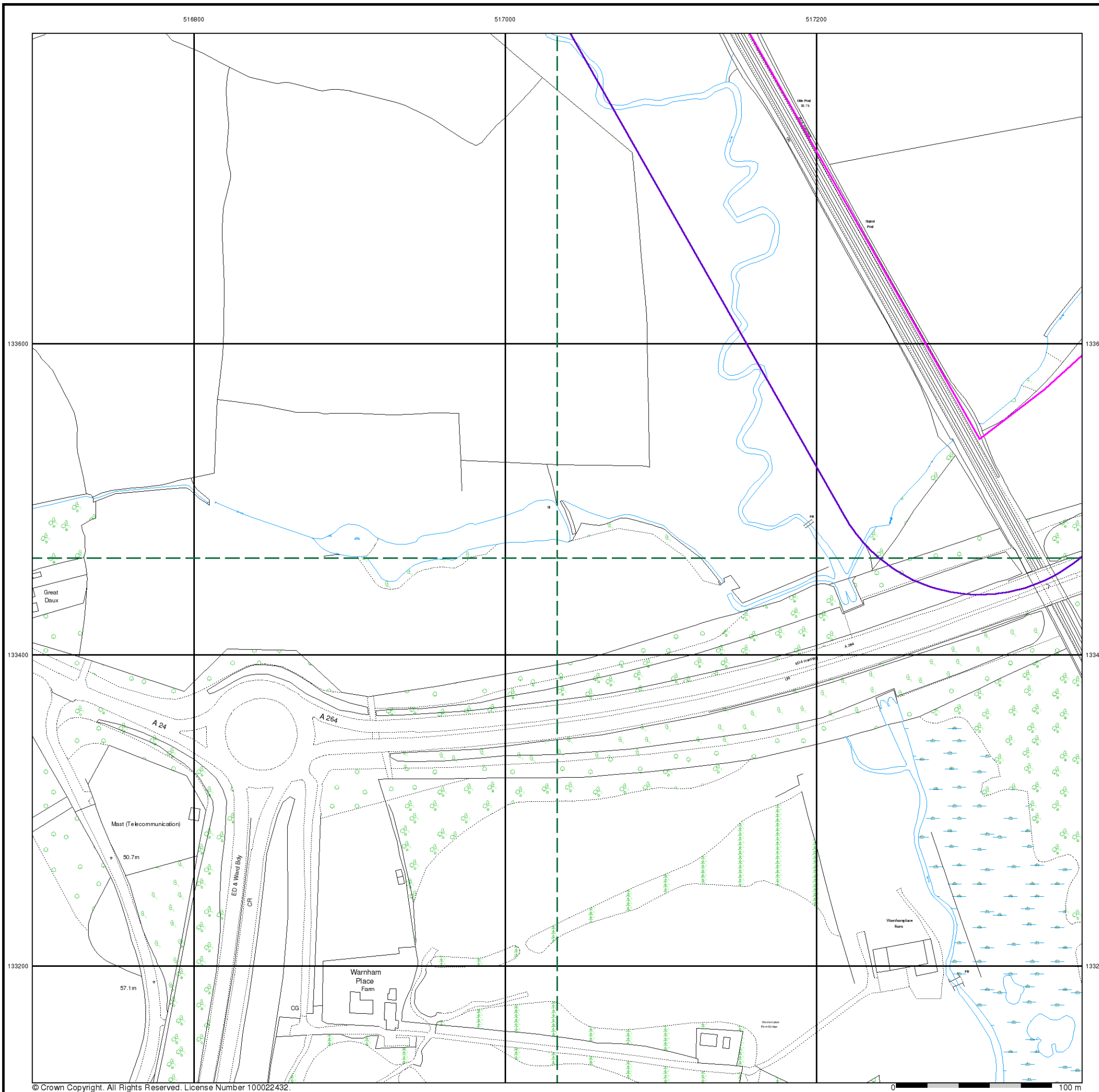

© Crown Copyright. All Rights Reserved. License Number 100022432.



## Geo-Environmental

### General

- Specified Site
- Specified Buffer(s)
- Bearing Reference Point
- Map ID
- Several of Types at Location
- Pylon
- Overhead Transmission Line

### Agency and Hydrological

- Contaminated Land Register Entry or Notice (Location)
- Contaminated Land Register Entry or Notice
- Discharge Consent
- Enforcement or Prohibition Notice
- Integrated Pollution Control
- Integrated Pollution Prevention Control
- Local Authority Integrated Pollution Prevention and Control
- Local Authority Pollution Prevention and Control
- Local Authority Pollution Prevention and Control Enforcement
- Pollution Incident to Controlled Waters
- Prosecution Relating to Authorised Processes
- Prosecution Relating to Controlled Waters
- Registered Radioactive Substance
- River Network or Water Feature
- River Quality Sampling Point
- Substantiated Pollution Incident Register
- Water Abstraction
- Water Industry Act Referral

### Hazardous Substances

- COMAH Site
- Explosive Site
- NIHHS Site
- Planning Hazardous Substance Consent
- Planning Hazardous Substance Enforcement
- BGS Recorded Mineral Site
- BGS Recorded Landfill Site (Location)
- BGS Recorded Landfill Site
- EA Historic Landfill (Buffered Point)
- EA Historic Landfill (Polygon)
- Integrated Pollution Control Registered Waste Site
- Licensed Waste Management Facility (Landfill Boundary)
- Licensed Waste Management Facility (Location)
- Local Authority Recorded Landfill Site (Location)
- Local Authority Recorded Landfill Site
- Potentially Infilled Land (Non-water)
- Potentially Infilled Land (Non-water)
- Potentially Infilled Land (Water)
- Potentially Infilled Land (Water)
- Potentially Infilled Land (Water)
- Registered Landfill Site
- Registered Landfill Site (Location)
- Registered Landfill Site (Point Buffered to 100m)
- Registered Landfill Site (Point Buffered to 250m)
- Registered Waste Transfer Site (Location)
- Registered Waste Transfer Site
- Registered Waste Treatment or Disposal Site (Location)
- Registered Waste Treatment or Disposal Site

### Geological

## Site Sensitivity Map - Segment A6

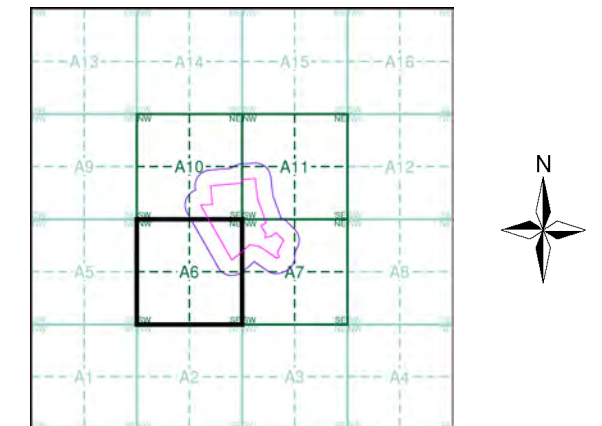

### Order Details

Order Number: 186643744\_1\_1  
Customer Ref: GE17826  
National Grid Reference: 517380, 133790  
Slice: A  
Site Area (Ha): 14.86  
Plot Buffer (m): 100

### Site Details

2 Graylands Farm Cottages, Langhurstwood Road,  
HORSHAM, RH12 4QD

**Landmark**  
INFORMATION GROUP

Tel: 0844 844 9952  
Fax: 0844 844 9951  
Web: [www.envirocheck.co.uk](http://www.envirocheck.co.uk)



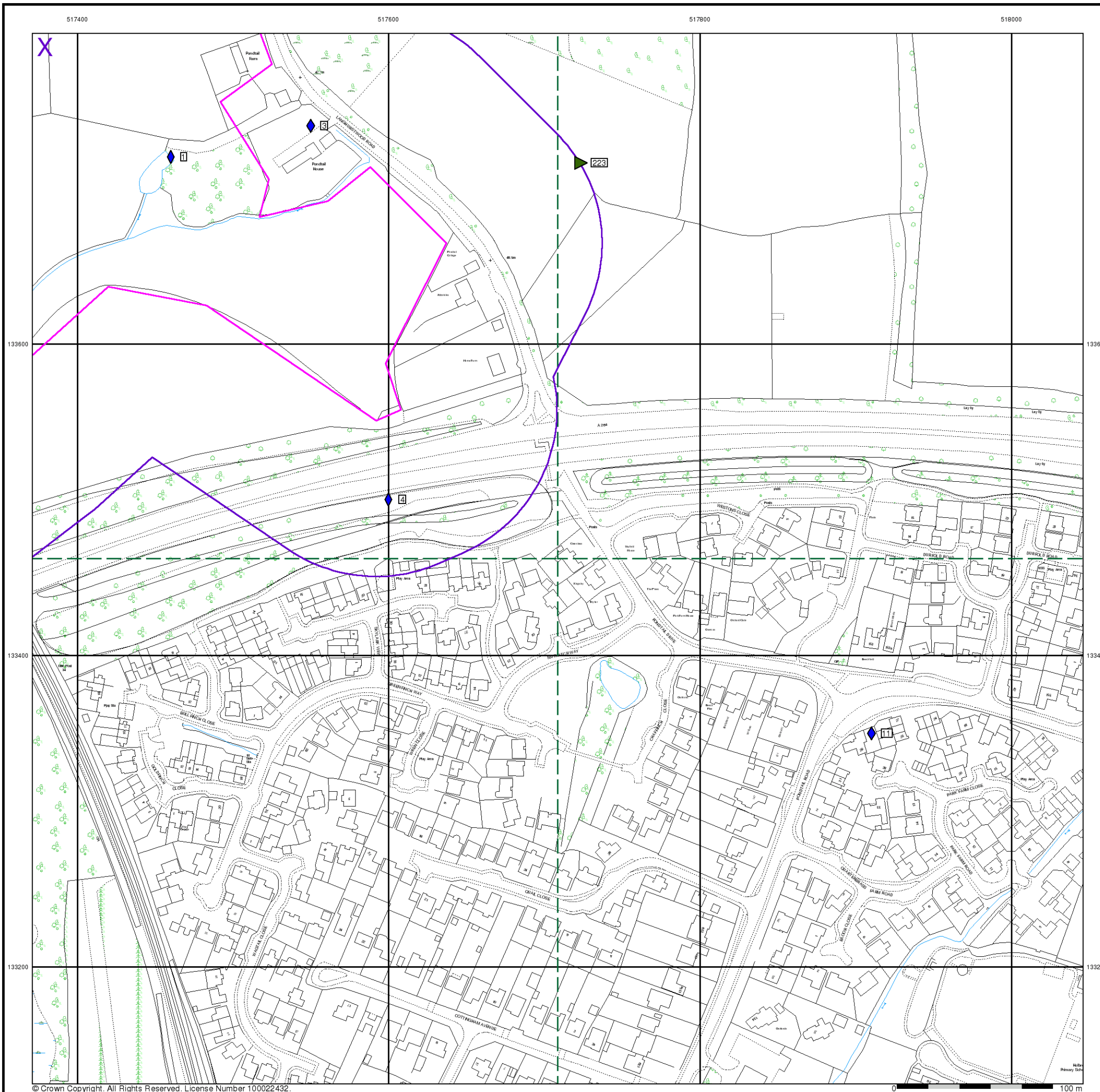

## Geo-Environmental

### General

- Specified Site
- Specified Buffer(s)
- Bearing Reference Point
- Map ID

### Agency and Hydrological

- Contaminated Land Register Entry or Notice (Location)
- Contaminated Land Register Entry or Notice
- Discharge Consent
- Enforcement or Prohibition Notice
- Integrated Pollution Control
- Integrated Pollution Prevention Control
- Local Authority Integrated Pollution Prevention and Control
- Local Authority Pollution Prevention and Control
- Local Authority Pollution Prevention and Control Enforcement
- Pollution Incident to Controlled Waters
- Prosecution Relating to Authorised Processes
- Prosecution Relating to Controlled Waters
- Registered Radioactive Substance
- River Network or Water Feature
- River Quality Sampling Point
- Substantiated Pollution Incident Register
- Water Abstraction
- Water Industry Act Referral

### Hazardous Substances

- COMAH Site
- Explosive Site
- NIHHS Site
- Planning Hazardous Substance Consent
- Planning Hazardous Substance Enforcement

### Geological

- BGS Recorded Mineral Site

### Waste

- BGS Recorded Landfill Site (Location)
- BGS Recorded Landfill Site
- EA Historic Landfill (Buffered Point)
- EA Historic Landfill (Polygon)
- Integrated Pollution Control Registered Waste Site
- Licensed Waste Management Facility (Landfill Boundary)
- Licensed Waste Management Facility (Location)
- Local Authority Recorded Landfill Site (Location)
- Local Authority Recorded Landfill Site
- Potentially Infilled Land (Non-water)
- Potentially Infilled Land (Non-water)
- Potentially Infilled Land (Water)
- Potentially Infilled Land (Water)
- Potentially Infilled Land (Water)
- Registered Landfill Site
- Registered Landfill Site (Location)
- Registered Landfill Site (Point Buffered to 100m)
- Registered Landfill Site (Point Buffered to 250m)
- Registered Waste Transfer Site (Location)
- Registered Waste Transfer Site
- Registered Waste Treatment or Disposal Site (Location)
- Registered Waste Treatment or Disposal Site

## Site Sensitivity Map - Segment A7

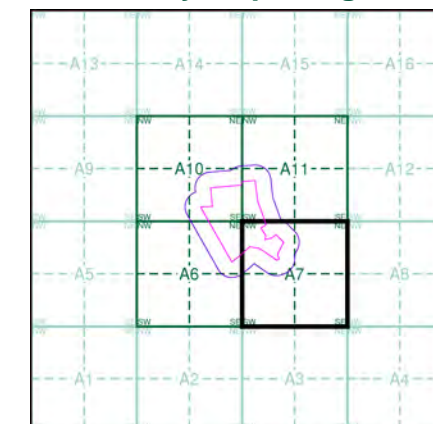

### Order Details

Order Number: 186643744\_1\_1  
Customer Ref: GE17826  
National Grid Reference: 517380, 133790  
Slice: A  
Site Area (Ha): 14.86  
Plot Buffer (m): 100

### Site Details

2 Graylands Farm Cottages, Langhurstwood Road,  
HORSHAM, RH12 4QD

**Landmark**  
INFORMATION GROUP

Tel: 0844 844 9952  
Fax: 0844 844 9951  
Web: [www.envirocheck.co.uk](http://www.envirocheck.co.uk)



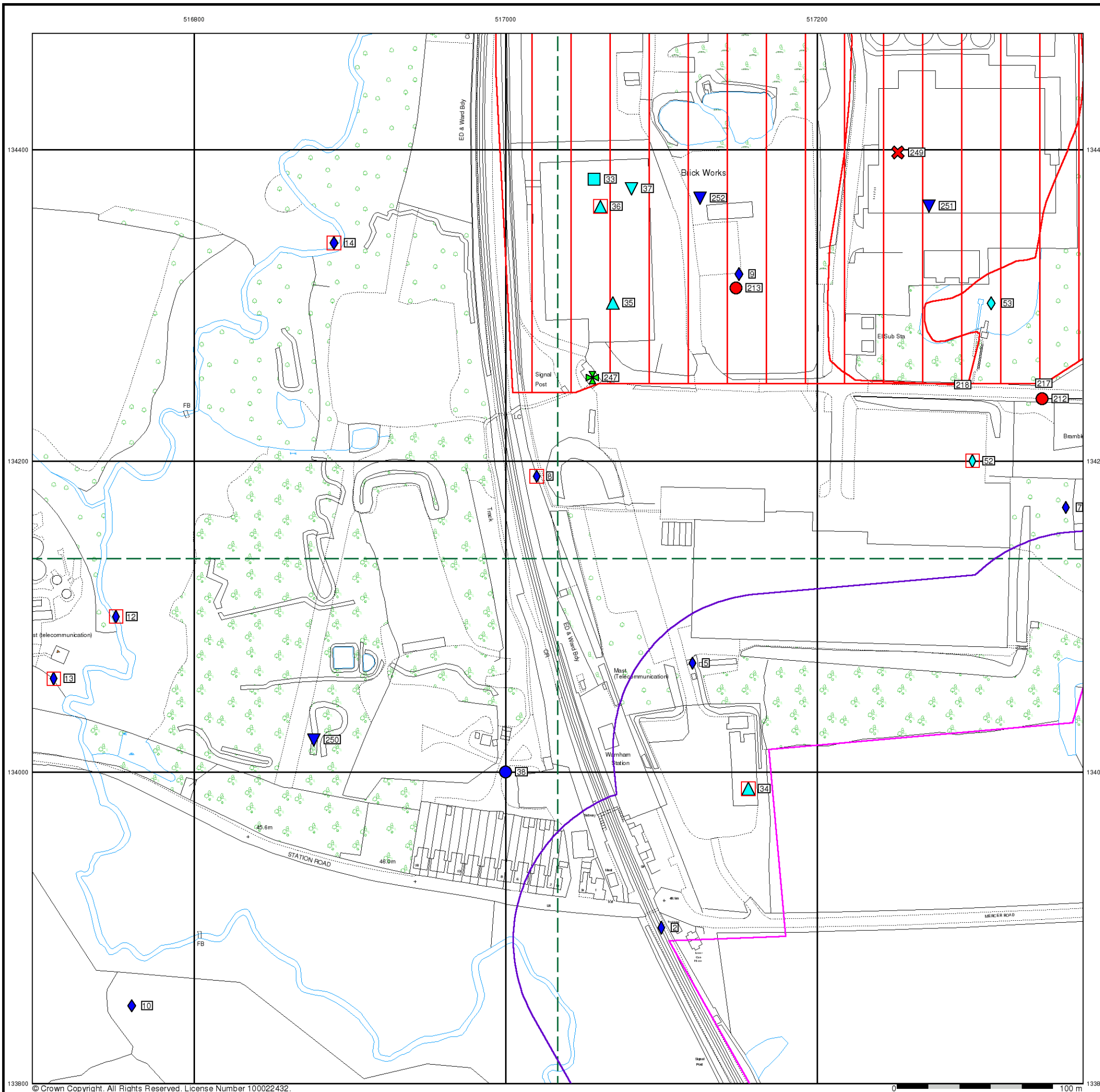

### General

- Specified Site
  - Specified Buffer(s)
  - Bearing Reference Point
  - Map ID
  - Several of Type at Location
  - Pylon
  - Overhead Transmission Line
- ### Agency and Hydrological
- Contaminated Land Register Entry or Notice (Location)
  - Contaminated Land Register Entry or Notice
  - Discharge Consent
  - Enforcement or Prohibition Notice
  - Integrated Pollution Control
  - Integrated Pollution Prevention Control
  - Local Authority Integrated Pollution Prevention and Control
  - Local Authority Pollution Prevention and Control
  - Local Authority Pollution Prevention and Control Enforcement
  - Pollution Incident to Controlled Waters
  - Prosecution Relating to Authorised Processes
  - Prosecution Relating to Controlled Waters
  - Registered Radioactive Substance
  - River Network or Water Feature
  - River Quality Sampling Point
  - Substantiated Pollution Incident Register
  - Water Abstraction
  - Water Industry Act Referral
- ### Hazardous Substances
- COMAH Site
  - Explosive Site
  - NIHHS Site
  - Planning Hazardous Substance Consent
  - Planning Hazardous Substance Enforcement
  - BGS Recorded Mineral Site
- ### Waste
- BGS Recorded Landfill Site (Location)
  - BGS Recorded Landfill Site
  - EA Historic Landfill (Buffered Point)
  - EA Historic Landfill (Polygon)
  - Integrated Pollution Control Registered Waste Site
  - Licensed Waste Management Facility (Landfill Boundary)
  - Licensed Waste Management Facility (Location)
  - Local Authority Recorded Landfill Site (Location)
  - Local Authority Recorded Landfill Site
  - Potentially Infilled Land (Non-water)
  - Potentially Infilled Land (Non-water)
  - Potentially Infilled Land (Water)
  - Potentially Infilled Land (Water)
  - Potentially Infilled Land (Water)
  - Registered Landfill Site
  - Registered Landfill Site (Location)
  - Registered Landfill Site (Point Buffered to 100m)
  - Registered Landfill Site (Point Buffered to 250m)
  - Registered Waste Transfer Site (Location)
  - Registered Waste Transfer Site
  - Registered Waste Treatment or Disposal Site (Location)
  - Registered Waste Treatment or Disposal Site

### Site Sensitivity Map - Segment A10

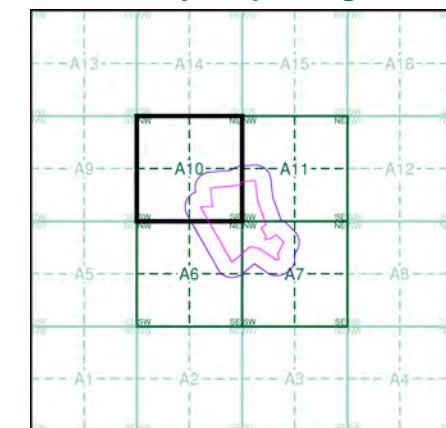

### Order Details

Order Number: 186643744\_1\_1  
Customer Ref: GE17826  
National Grid Reference: 517380, 133790  
Slice: A  
Site Area (Ha): 14.86  
Plot Buffer (m): 100

### Site Details

2 Graylands Farm Cottages, Langhurstwood Road,  
HORSHAM, RH12 4QD



Tel: 0844 844 9952  
Fax: 0844 844 9951  
Web: www.envirocheck.co.uk





### General

- Specified Site
- Specified Buffer(s)
- Bearing Reference Point
- Map ID
- Several of Types at Location
- Pylon
- Overhead Transmission Line

### Agency and Hydrological

- Contaminated Land Register Entry or Notice (Location)
- Contaminated Land Register Entry or Notice
- Discharge Consent
- Enforcement or Prohibition Notice
- Integrated Pollution Control
- Integrated Pollution Prevention Control
- Local Authority Integrated Pollution Prevention and Control
- Local Authority Pollution Prevention and Control Enforcement
- Pollution Incident to Controlled Waters
- Prosecution Relating to Authorised Processes
- Prosecution Relating to Controlled Waters
- Registered Radioactive Substance
- River Network or Water Feature
- River Quality Sampling Point
- Substantiated Pollution Incident Register
- Water Abstraction
- Water Industry Act Referral

### Waste

- BGS Recorded Landfill Site (Location)
- BGS Recorded Landfill Site
- EA Historic Landfill (Buffered Point)
- EA Historic Landfill (Polygon)
- Integrated Pollution Control Registered Waste Site
- Licensed Waste Management Facility (Landfill Boundary)
- Licensed Waste Management Facility (Location)
- Local Authority Recorded Landfill Site (Location)
- Local Authority Recorded Landfill Site
- Potentially Infilled Land (Non-water)
- Potentially Infilled Land (Non-water)
- Potentially Infilled Land (Water)
- Potentially Infilled Land (Water)
- Potentially Infilled Land (Water)
- Registered Landfill Site
- Registered Landfill Site (Point Buffered to 100m)
- Registered Landfill Site (Point Buffered to 250m)
- Registered Waste Transfer Site (Location)
- Registered Waste Transfer Site
- Registered Waste Treatment or Disposal Site (Location)
- Registered Waste Treatment or Disposal Site

### Hazardous Substances

- COMAH Site
- Explosive Site
- NIHHS Site
- Planning Hazardous Substance Consent
- Planning Hazardous Substance Enforcement
- BGS Recorded Mineral Site

### Geological

- BGS Recorded Mineral Site

### Site Sensitivity Map - Segment A11

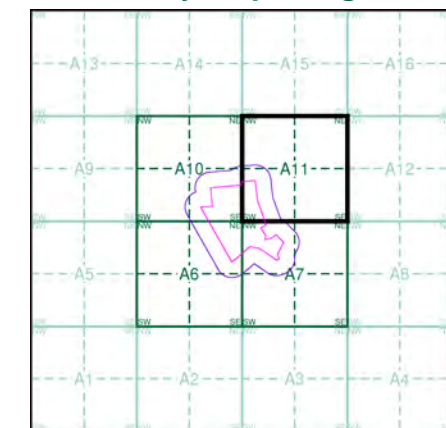

### Order Details

Order Number: 186643744\_1\_1  
Customer Ref: GE17826  
National Grid Reference: 517380, 133790  
Slice: A  
Site Area (Ha): 14.86  
Plot Buffer (m): 100

### Site Details

2 Graylands Farm Cottages, Langhurstwood Road,  
HORSHAM, RH12 4QD



Tel: 0844 844 9952  
Fax: 0844 844 9951  
Web: www.envirocheck.co.uk







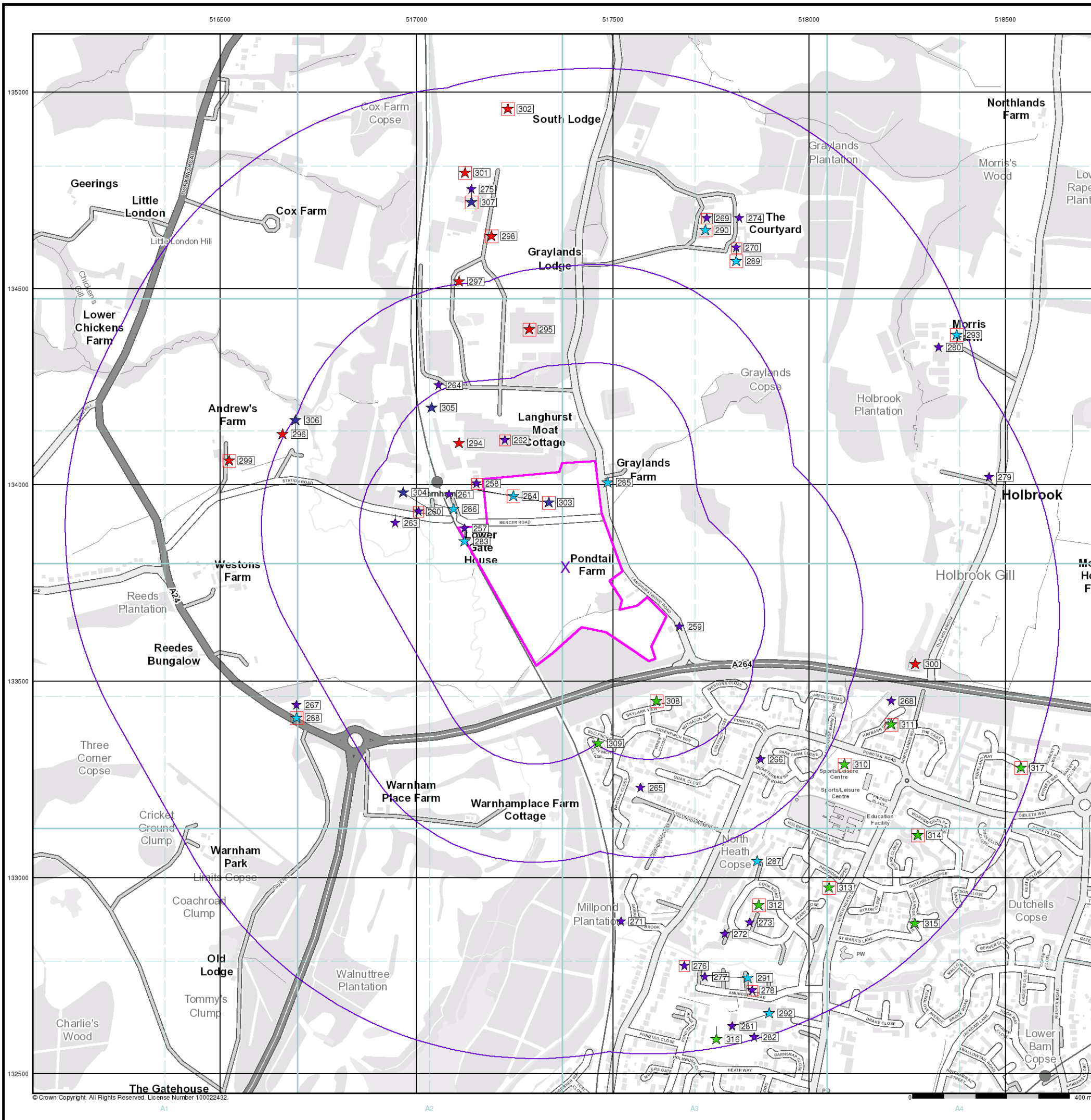

© Crown Copyright. All Rights Reserved. License Number 100022432.



# Geo-Environmental Industrial Land Use Map

## General

- Specified Site
- Specified Buffer(s)
- Bearing Reference Point
- Slice
- Map ID

## Industrial Land Use

- Contemporary Trade Directory Entry
- Fuel Station Entry
- Gas Pipeline
- Points of Interest - Commercial Services
- Points of Interest - Education and Health
- Points of Interest - Manufacturing and Production
- Points of Interest - Public Infrastructure
- Points of Interest - Recreational and Environmental
- Underground Electrical Cables

## Industrial Land Use Map - Slice A

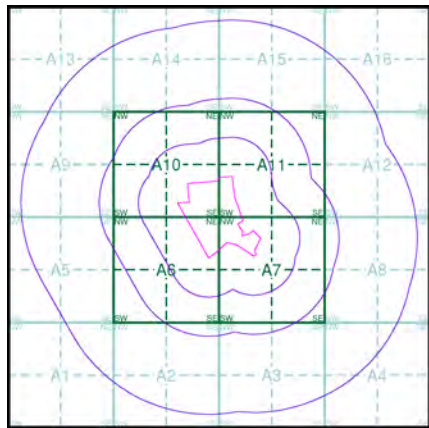

## Order Details

Order Number: 186643744\_1\_1  
 Customer Ref: GE17826  
 National Grid Reference: 517380, 133790  
 Slice: A  
 Site Area (Ha): 14.86  
 Search Buffer (m): 1000

## Site Details

2 Graylands Farm Cottages, Langhurstwood Road,  
 HORSHAM, RH12 4QD

**Landmark**  
 INFORMATION GROUP

Tel: 0844 844 9952  
 Fax: 0844 844 9951  
 Web: [www.envirocheck.co.uk](http://www.envirocheck.co.uk)