

Gross external foot print of proposed ground floor 167m² (1800 sq. ft.)
Total proposed (gross external) area over two floors 312m² (3360 sq. ft.)

- Existing Hedge to North-East boundary to be retained as existing
- Proposed Hedge to North-East & South-East Boundary to comprise an even mix of: -
Blackthorn (Crataegus monogyna)
Dog Rose (Rosa canina)
Field Maple (Acer campestre)
Hazel (Corylus avellana)

TREE SCHEDULE

- 1 No. T1 Silver Birch (Betula pendula)
- 2 No. T2 Rowan (Sorbus aucuparia)
- 3 No. T3 Star Magnolia (Magnolia stellata)

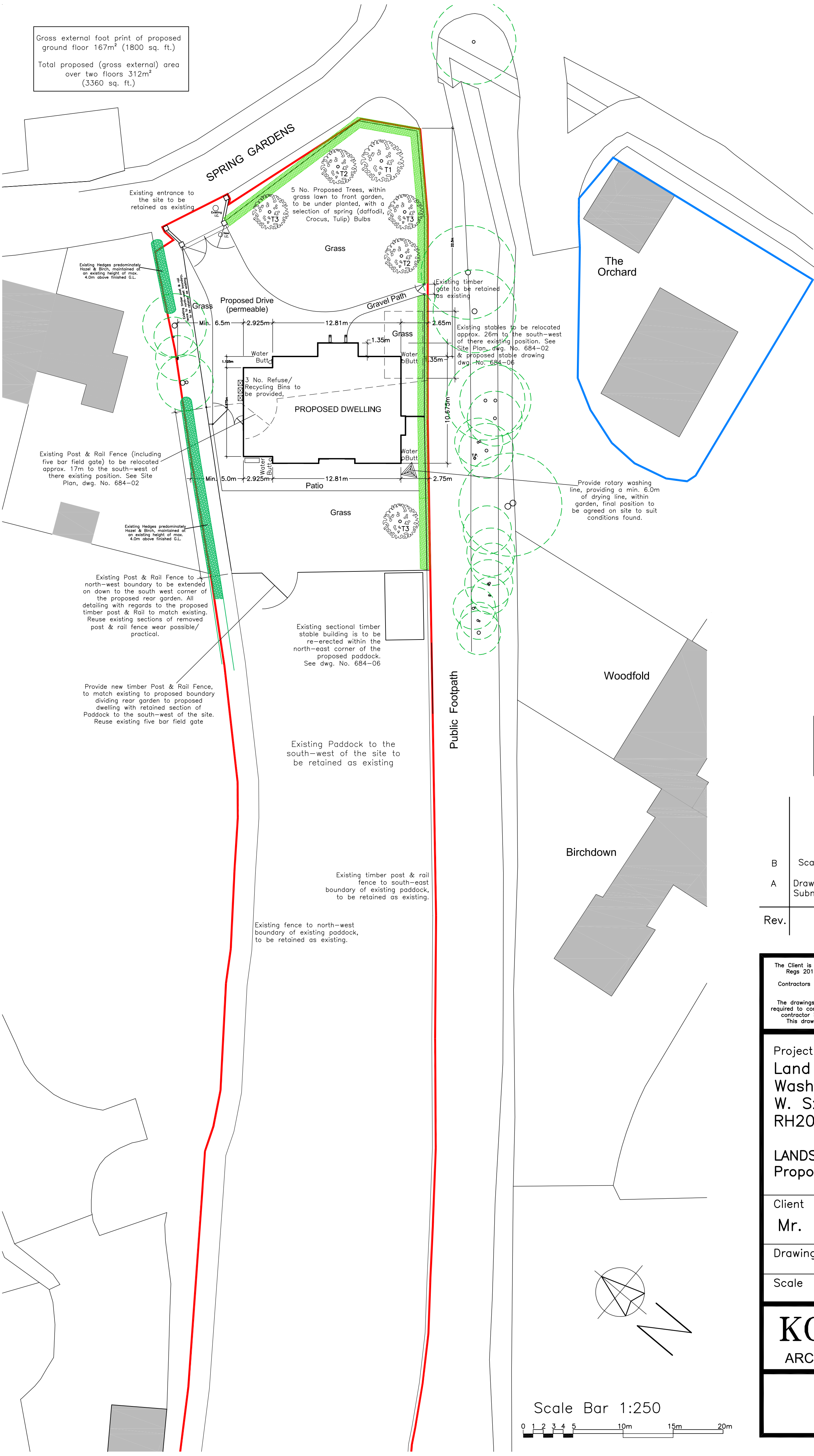

This Drawing is to be read in conjunction with dwg. No. 684-01 to 10 Inclusive At all times

B	Scale Bar added	14/01/26
A	Drawing completed for Planning Submission	09/01/26
Rev.	Description	Date

The Client is advised to ascertain and comply with his duties under the C.D.M. Regs 2015 and his obligations under the Party Wall etc. Act 1996 and Equality Act 2010 where applicable. Contractors must verify all dimensions on site before commencing any work. The copyright of this drawing is reserved. The drawing must not be disclosed without authority. The drawings and drawing notes do not purport to cover each and every item required to complete the project, the notes are not a specification of works, the contractor is advised to verify the full extent of the works with the client. This drawing to be read in conjunction with Designers Risk Assessment

Project Land East of Spring Gardens Washington, W. Sx. RH20 3BP		
LANDSCAPE PLAN AS PROPOSED Proposed Dwelling		
Client Mr. & Mrs Ripley		
Drawing no.	684-08 (A2)	B
Scale	1 : 250	Date Nov. 2025

KG DESIGNS

ARCHITECTURAL CONSULTANT

Longacre, Bentons Lane, Dial Post,
Horsham, West Sussex RH13 8NW
Tel : 01403 711666
E-MAIL : kgd@kgdesigns.com

