

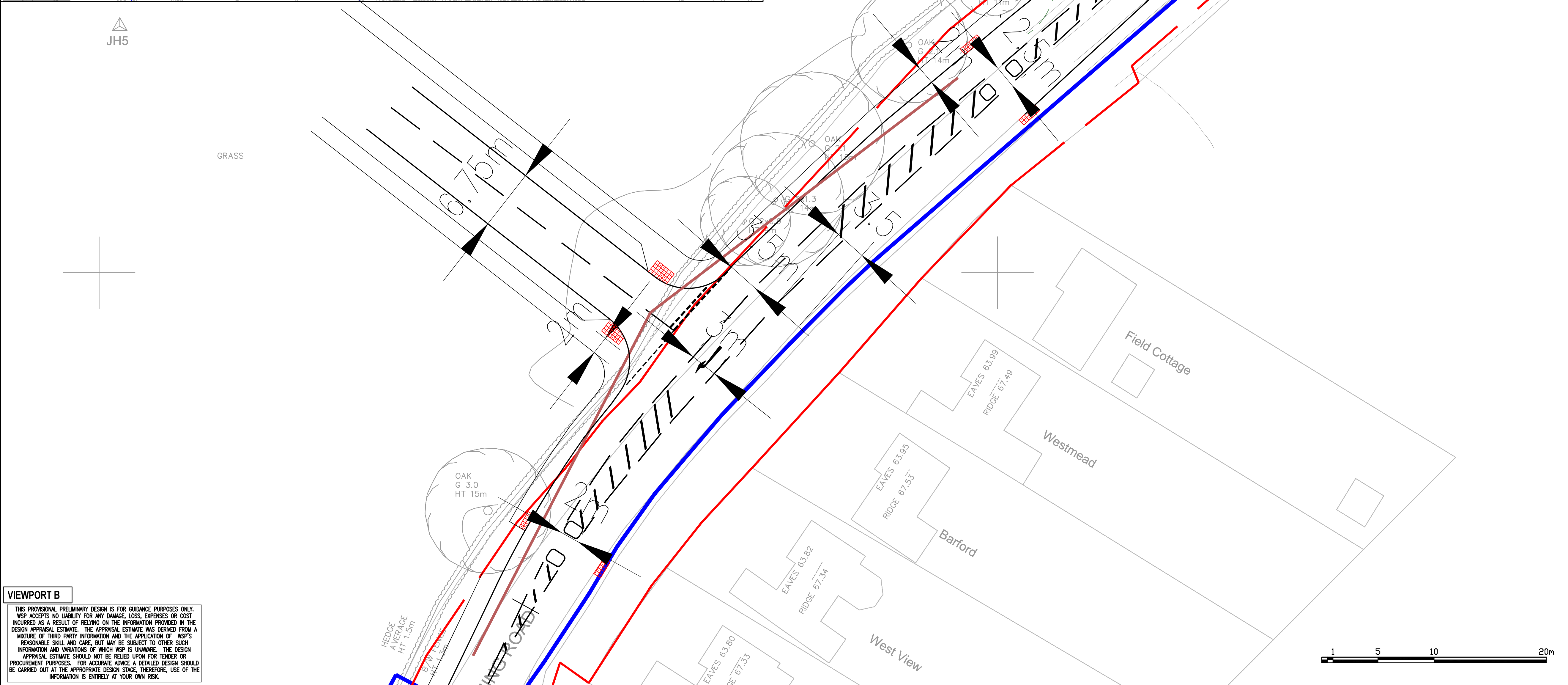



VIEWPORT A



VIEWPORT B

THIS PROVISIONAL PRELIMINARY DESIGN IS FOR GUIDANCE PURPOSES ONLY. WSP ACCEPTS NO LIABILITY FOR ANY DAMAGE, LOSS, EXPENSES OR COST INCURRED AS A RESULT OF RELYING ON THE INFORMATION PROVIDED IN THE DESIGN APPRAISAL ESTIMATE. THE APPRAISAL ESTIMATE WAS DERIVED FROM A MIXTURE OF THIRD PARTY INFORMATION AND THE APPLICATION OF WSP'S REASONABLE SKILL AND CARE, BUT MAY BE SUBJECT TO OTHER SUCH INFORMATION AND VARIATIONS OF WHICH WSP IS UNAWARE. THE DESIGN APPRAISAL ESTIMATE SHOULD NOT BE RELIED UPON FOR TENDER OR PROCUREMENT PURPOSES. FOR ACCURATE ADVISE A DETAILED DESIGN SHOULD BE CARRIED OUT AT THE APPROPRIATE DESIGN STAGE, THEREFORE, USE OF THE INFORMATION IS ENTIRELY AT YOUR OWN RISK.

NOTES:
1. THE HIGHWAY BOUNDARY IS BASED ON A OS MAPPING WHILST THIS PLAN IS USING A TOPO BACKGROUND HENCE THE DISCREPANCIES BETWEEN BACKGROUND.

KEY:
 PROPOSED ROAD MARKING
 SITE BOUNDARY
 HIGHWAY BOUNDARY

P02	13/02/2026	PM	SECOND ISSUE	PP	PP
P01	05/11/2025	AM	FIRST ISSUE	PM	PP
REV	DATE	BY	DESCRIPTION	CHK	APP

DRAWING STATUS: S0 - WORK IN PROGRESS



Grosvenor House, 2 Grosvenor Square, Southampton, SO15 2BE, UK
T+ 44 (0) 2380 101 700
wsp.com

CLIENT: BERKELEY STRATEGIC LAND LIMITED

ARCHITECT: -

SITE/PROJECT: LAND NORTH WEST OF SOUTHWATER

TITLE: WORTHING ROAD/ SITE ACCESS PRIORITY JUNCTION ACCESS ARRANGEMENTS

SCALE @ A1:	1:200	CHECKED:	PM	APPROVED:	DD
PROJECT NO:	UK0043490.9681	DESIGNED:	AVI	DATE:	JAN 26
DRAWN:	AVI	DATE:	JAN 26	REV:	P01

DRAWING NO: UK0043490.9681-WSP-XX-XX-DR-TP-0101

© WSP UK Ltd

File name: \\UK\WSP\GROU\COM\CENTRAL\DATA\PROJECTS\10709\1000709\09\467 - NORTH SOUTHWATER PHASE 203\WIP\TP\TRANSPORT PLANNING\03 DRAWINGS\TP-0101-01.DWG, printed on 03 March 2025 14:49:33, by Mark Pile