

VIEWPORT A

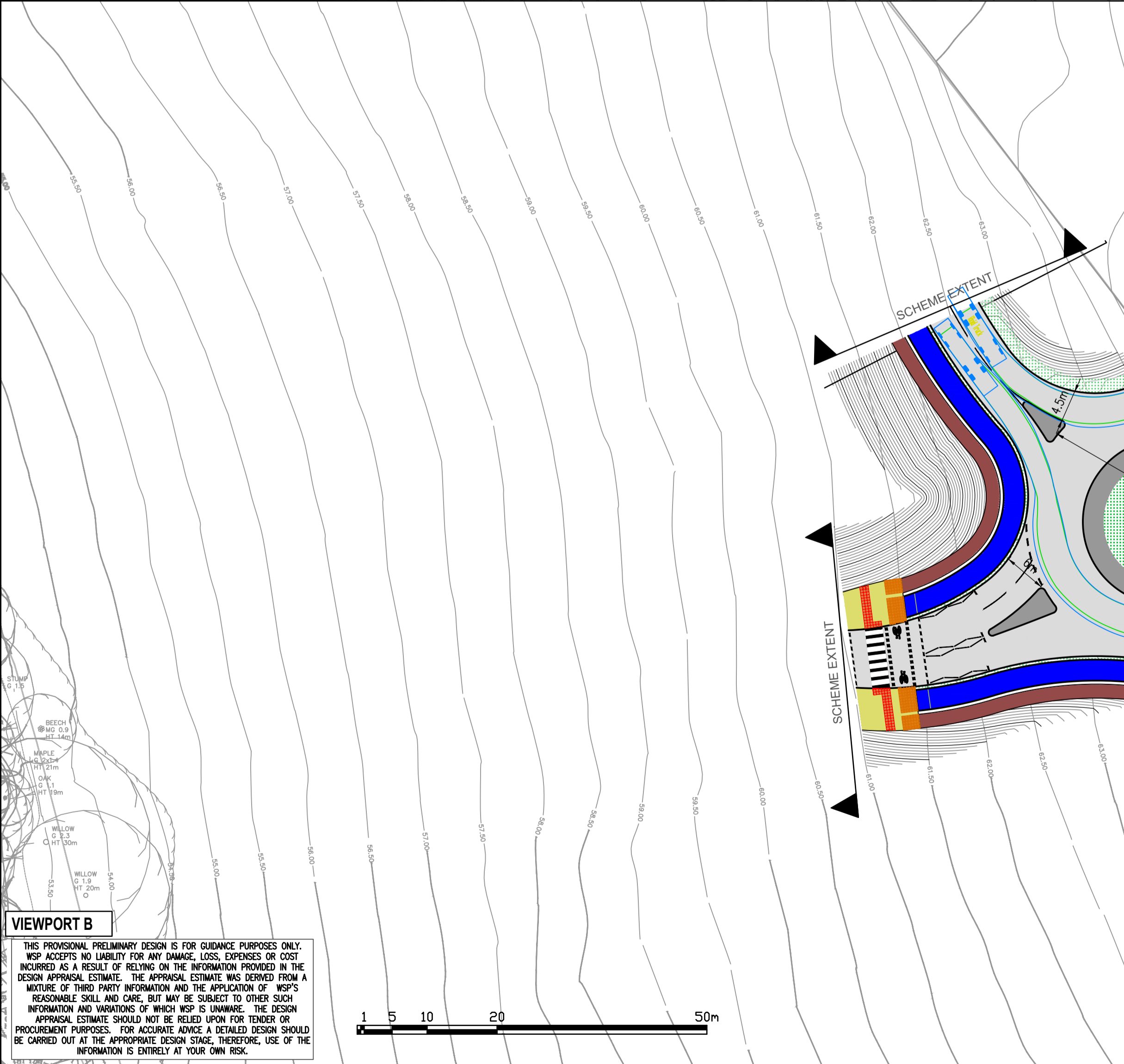

VIEWPORT B

THIS PROVISIONAL PRELIMINARY DESIGN IS FOR GUIDANCE PURPOSES ONLY. WSP ACCEPTS NO LIABILITY FOR ANY DAMAGE, LOSS, EXPENSES OR COST INCURRED AS A RESULT OF RELYING ON THE INFORMATION PROVIDED IN THE DESIGN APPRAISAL ESTIMATE. THE APPRAISAL ESTIMATE WAS DERIVED FROM A MIXTURE OF THIRD PARTY INFORMATION AND THE APPLICATION OF WSP'S REASONABLE SKILL AND CARE, BUT MAY BE SUBJECT TO OTHER SUCH INFORMATION AND VARIATIONS OF WHICH WSP IS UNAWARE. THE DESIGN APPRAISAL ESTIMATE SHOULD NOT BE RELIED UPON FOR TENDER OR PROCUREMENT PURPOSES. FOR ACCURATE ADVICE A DETAILED DESIGN SHOULD BE CARRIED OUT AT THE APPROPRIATE DESIGN STAGE. THEREFORE, USE OF THE INFORMATION IS ENTIRELY AT YOUR OWN RISK.

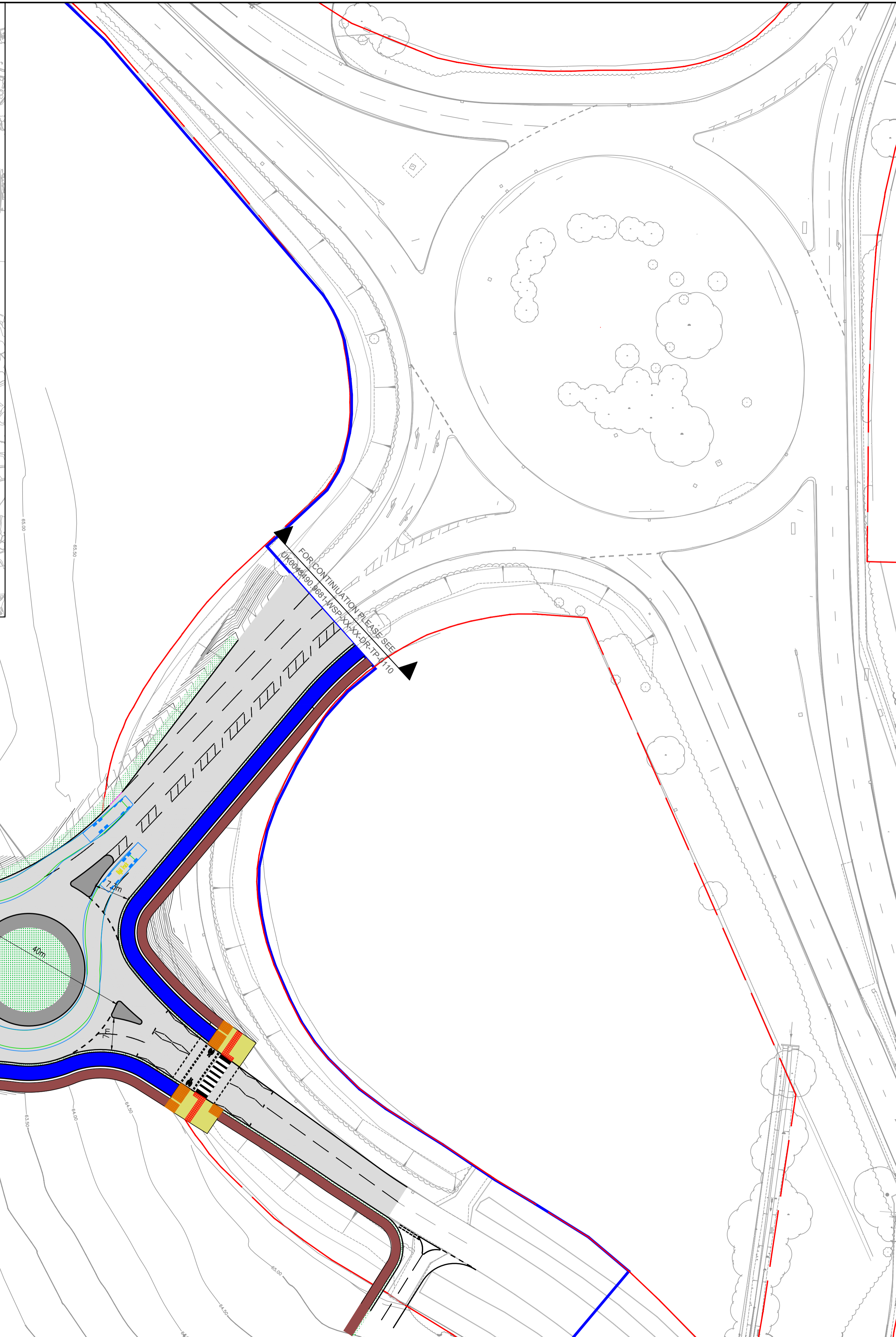

- KEY:**
- PROPOSED TACTILE - CONTROLLED
  - PROPOSED CYCLE TRACK
  - PROPOSED FOOTWAY
  - PROPOSED CORDUROY PAVING
  - HIGHWAY BOUNDARY
  - PLANNING APPLICATION BOUNDARY

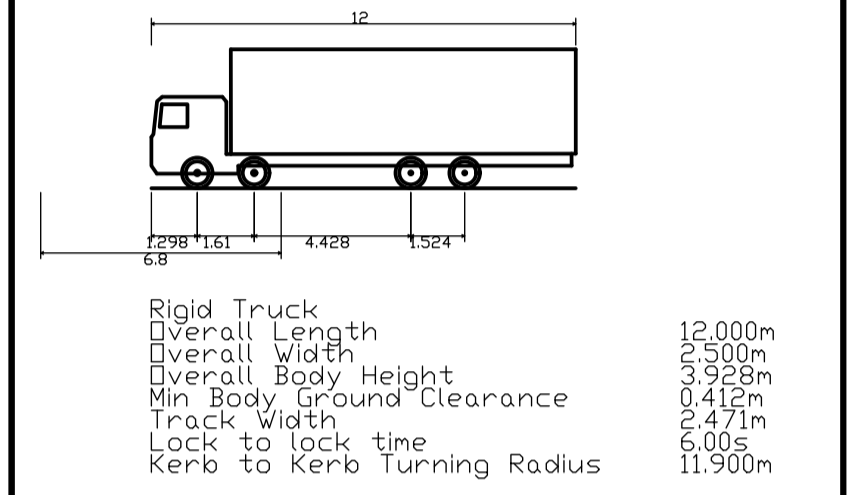

REV	DATE	BY	DESCRIPTION	CHK	APP
P02	13/02/2026	PM	SECOND ISSUE	PP	PP
P01	06/01/2026	AVI	FIRST ISSUE	PM	PP

DRAWING STATUS: **S0 - WORK IN PROGRESS**

Grosvenor House, 2 Grosvenor Square, Southampton, SO15 2BE, UK  
T+ 44 (0) 2380 101 700  
wsp.com

CLIENT: **BERKELEY STRATEGIC LAND LIMITED**

ARCHITECT:

SITE/PROJECT: **LAND NORTH WEST OF SOUTHWATER**

TITLE: **PROPOSED NORTH ACCESS ROUNDABOUT ONTO WORTHING ROAD**

SCALE @ A1:	CHECKED:	APPROVED:
1:500	PM	DD

PROJECT NO:	DESIGNED:	DRAWN:	DATE:
UK0043490.9681	AVI	AVI	JANUARY 26

DRAWING NO:	REV:
UK0043490.9681-WSP-XX-XX-DR-TP-0103	P02

© WSP UK Ltd

File name: \\UK-WSP-0001\DATA\PROJECTS\0100\0000009497 - NORTH SOUTHWATER PHASE 2\03 WPTP TRANSPORT PLANNING\03 DRAWINGS\AUTOCAD\UK0043490.9681-TP-0103-DRP.dwg, printed on 03 March 2026 15:25:46, by Miss. Phil