

Dig Sites Area: Line: The quality and accuracy of any print will depend on your printer, your computer and its print settings. Measurements scaled from this plan may not match measurements between the same points on the ground.

This plan must be used with the attached 'Symbols' document.

1. The position of the apparatus shown on this drawing is believed to be correct but the original landmarks may have been altered since the apparatus was installed.
2. The exact position of the apparatus should be verified - use approved cable avoidance tools prior to excavation using suitable hand tools.
3. It is essential that trial holes are carefully made avoiding the use of mechanical tools or picks until the exact location of all the cables have been determined.
4. It must be assumed that there is a service cable into each property, lamp column and street sign, etc.
5. All cables must be treated as being live unless proved otherwise by UK Power Networks.
6. The information provided must be given to all people working near UK Power Networks plant and equipment. Do not use plans more than 3 months after the issue date for excavation purposes.
7. Please be aware that electric cables/lines belonging to other owners of licensed electricity distribution systems may be present and it is your responsibility to identify their location.

Scale: 1:4613 (When plotted at A3)



IF IN DOUBT - ASK!
PHONE 0800 056 5866
EMERGENCY - If you damage a cable or line
Phone 0800 783 8838
(24hrs) URGENTLY!

ALWAYS LOOK UP
BEFORE
YOU START WORK
Refer to HSE
Guidance note G56

Maps produced at 1:2500 scale are Geo5 schematics which show LV main cables and associated equipment. Locations are shown as points and are not intended to refer to the 1:500 records to determine the location of all known underground plant and equipment.

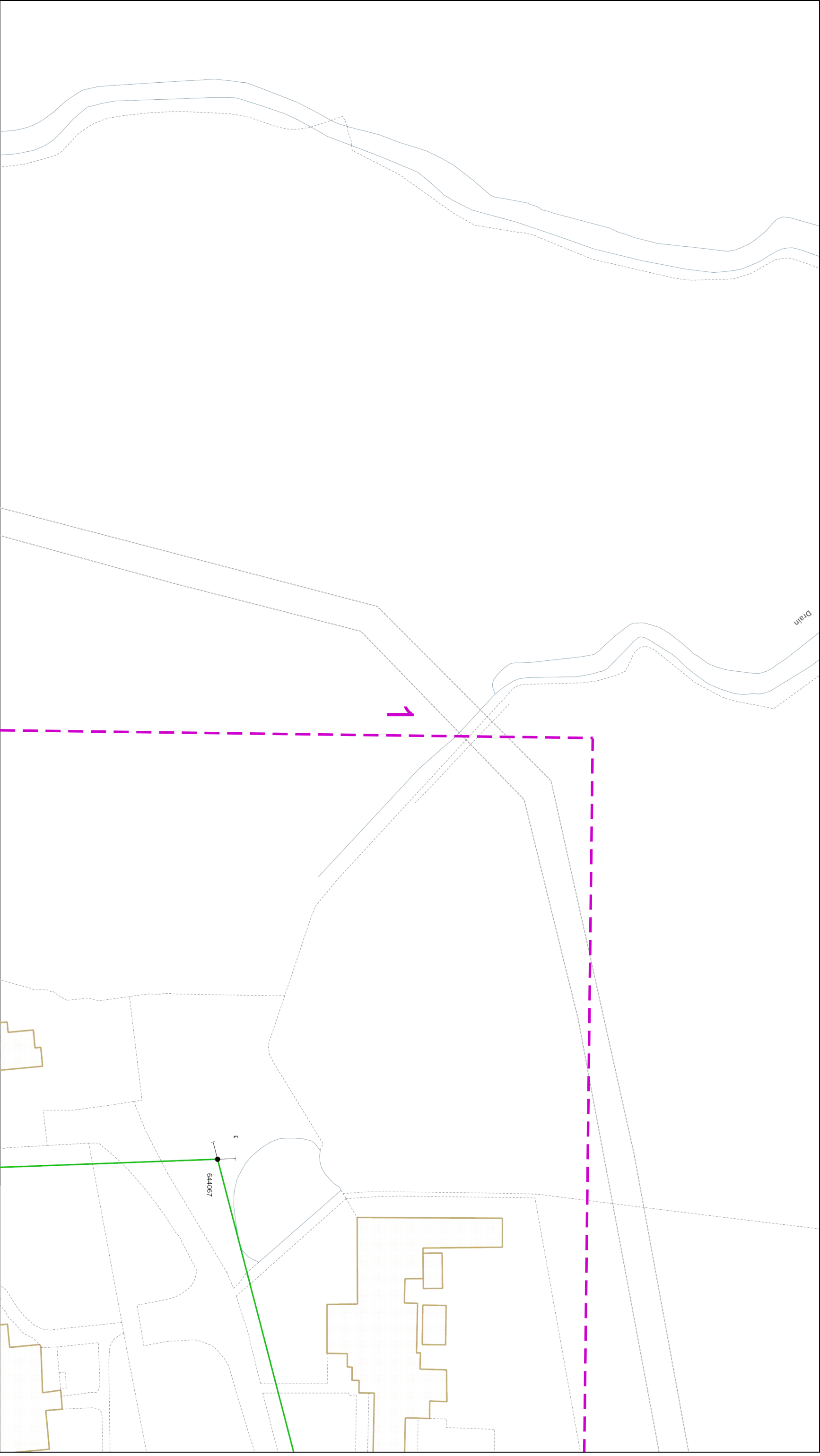

The quality and accuracy of any print will depend on your printer, your computer and its print settings. Measurements scaled from this plan may not match measurements between the same points on the ground.

Dig Sites

Area:

Line:

This plan must be used with the attached 'Symbols' document.

Date Requested: 12/12/2018
Job Reference: 14403313
Site Location: 524155 136455
Requested by:
Mr Gareth Adam
Your Scheme/Reference: West of field - 9 of 13

Scale: 1:500 (When plotted at A3)

1. The position of the apparatus shown on this drawing is believed to be correct but the original landmarks may have been altered since the apparatus was installed.
2. The exact position of the apparatus should be verified - use approved cable avoidance tools prior to excavation using suitable hand tools.
3. It is essential that trial holes are carefully made avoiding the use of mechanical tools or picks until the exact location of all the cables have been determined.
4. It must be assumed that there is a service cable into each property, lamp column and street sign, etc.
5. All cables must be treated as being live unless proved otherwise by UK Power Networks.
6. The information provided must be given to all people working near UK Power Networks plant and equipment. Do not use plans more than 3 months after the issue date for excavation purposes.
7. Please be aware that electric cables/lines belonging to other owners of licensed electricity distribution systems may be present and it is your responsibility to identify their location.

1. UK Power Networks does not warrant that the information provided to you is correct. You rely upon it at your own risk.
2. UK Power Networks does not exclude or limit its liability if it causes the death of any persons or causes personal injury to a person.
3. Subject to paragraph 2 UK Power Networks has no liability to you in contract, in tort (including negligence), for breach of statutory duty or otherwise for any loss, damage, cost, claims, demands, or expenses that you or any third party may suffer or incur as a result of using the information provided whether for physical damage to property or for any economic loss (including without limitation loss of profit, loss of opportunity, loss of savings, loss of goodwill, loss of business, loss of use) or any special or consequential loss or damage whatsoever.
4. This plan has been provided to you on the basis of the terms of use set out in the covering letter that accompanies this plan. If you do not accept and/or do not understand the terms of use set out in the covering letter you must not use the plan and must return it to the sender of the letter.
5. You are responsible for the security of the information provided to you. It must not be given, sold or made available upon payment of a fee to a third party.



IF IN DOUBT - ASK!
PHONE 0800 056 5866
EMERGENCY - If you damage a cable or line
Phone 0800 783 8838
(24hrs) URGENTLY

ALWAYS LOOK UP
BEFORE
YOU START WORK
Refer to HSE
Guidance note G56

Maps produced at 1:2500 scale are Geo Schematics which show LV mains cables and underground plant. Maps produced at 1:500 scale are Geo Schematics which show LV mains cables and underground plant. Maps produced at 1:500 scale are Geo Schematics which show LV mains cables and underground plant. Maps produced at 1:500 scale are Geo Schematics which show LV mains cables and underground plant.

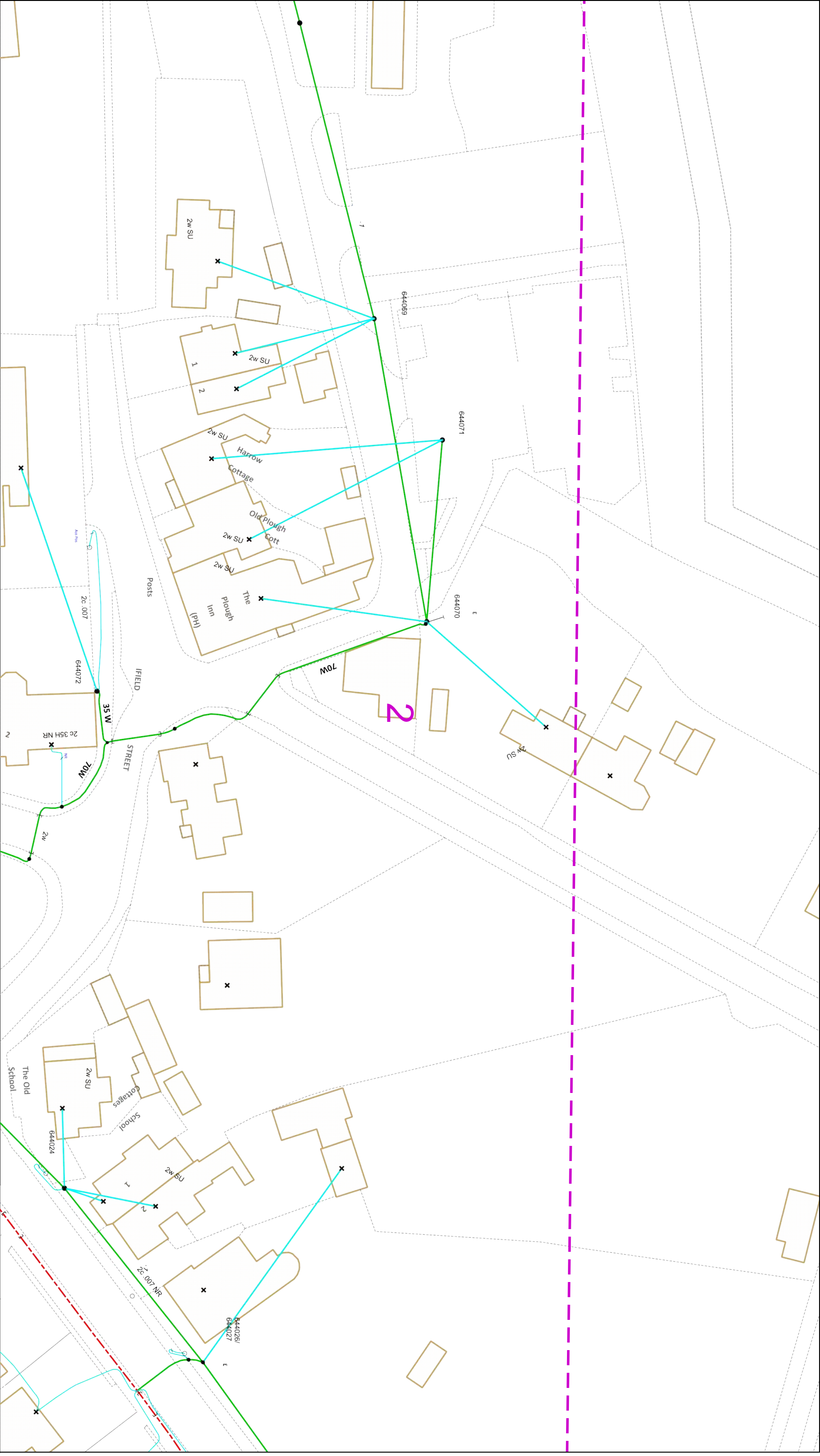

0 25 50

metres

Dig Sites Area: 1:500 (When plotted at A3) Line: 1:500 (When plotted at A3)

The quality and accuracy of any print will depend on your printer, your computer and its print settings. Measurements scaled from this plan may not match measurements between the same points on the ground.

This plan must be used with the attached 'Symbols' document.

1. The position of the apparatus shown on this drawing is believed to be correct but the original landmarks may have been altered since the apparatus was installed.

2. The exact position of the apparatus should be verified - use approved cable avoidance tools prior to excavation using suitable hand tools.

3. It is essential that trial holes are carefully made avoiding the use of mechanical tools or picks until the exact location of all the cables have been determined.

4. It must be assumed that there is a service cable into each property, lamp column and street sign, etc.

5. All cables must be treated as being live unless proved otherwise by UK Power Networks.

6. The information provided must be given to all people working near UK Power Networks plant and equipment. Do not use plans more than 3 months after the issue date for excavation purposes.

7. Please be aware that electric cables/lines belonging to other owners of licensed electricity distribution systems may be present and it is your responsibility to identify their location.

Date Requested: 12/12/2018

Job Reference: 14403313

Site Location: 524155 136455

Requested by: Mr Gareth Adam

Your Scheme/Reference: West of field - 9 of 13

Scale: 1:500 (When plotted at A3)

1. UK Power Networks does not warrant that the information provided to you is correct. You rely upon it at your own risk.

2. UK Power Networks does not exclude or limit its liability if it causes the death of any persons or causes personal injury to a person.

3. Subject to paragraph 2 UK Power Networks has no liability to you in contract, in tort (including negligence), for breach of statutory duty or otherwise for any loss, damage, cost, claims, demands, or expenses that you or any third party may suffer or incur as a result of using the information provided whether for physical damage to property or for any economic loss (including without limitation loss of profit, loss of opportunity, loss of savings, loss of goodwill, loss of business, loss of use) or any special or consequential loss or damage whatsoever.

4. This plan has been provided to you on the basis of the terms of use set out in the covering letter that accompanies this plan. If you do not accept and/or do not understand the terms of use set out in the covering letter you must not use the plan and must return it to the sender of the letter.

5. You are responsible for the security of the information provided to you. It must not be given, sold or made available upon payment of a fee to a third party.



IF IN DOUBT - ASK!
PHONE 0800 056 5866
EMERGENCY - If you damage a cable or the phone 0800 783 8838
(24hrs) URGENTLY

ALWAYS LOOK UP
BEFORE YOU START WORK
Refer to HSE
Guidance note G56

Maps produced at 1:2500 scale are Geo Schematics which show LV mains cables and refer to the 1:500 records to determine the location of all known underground plant and equipment.

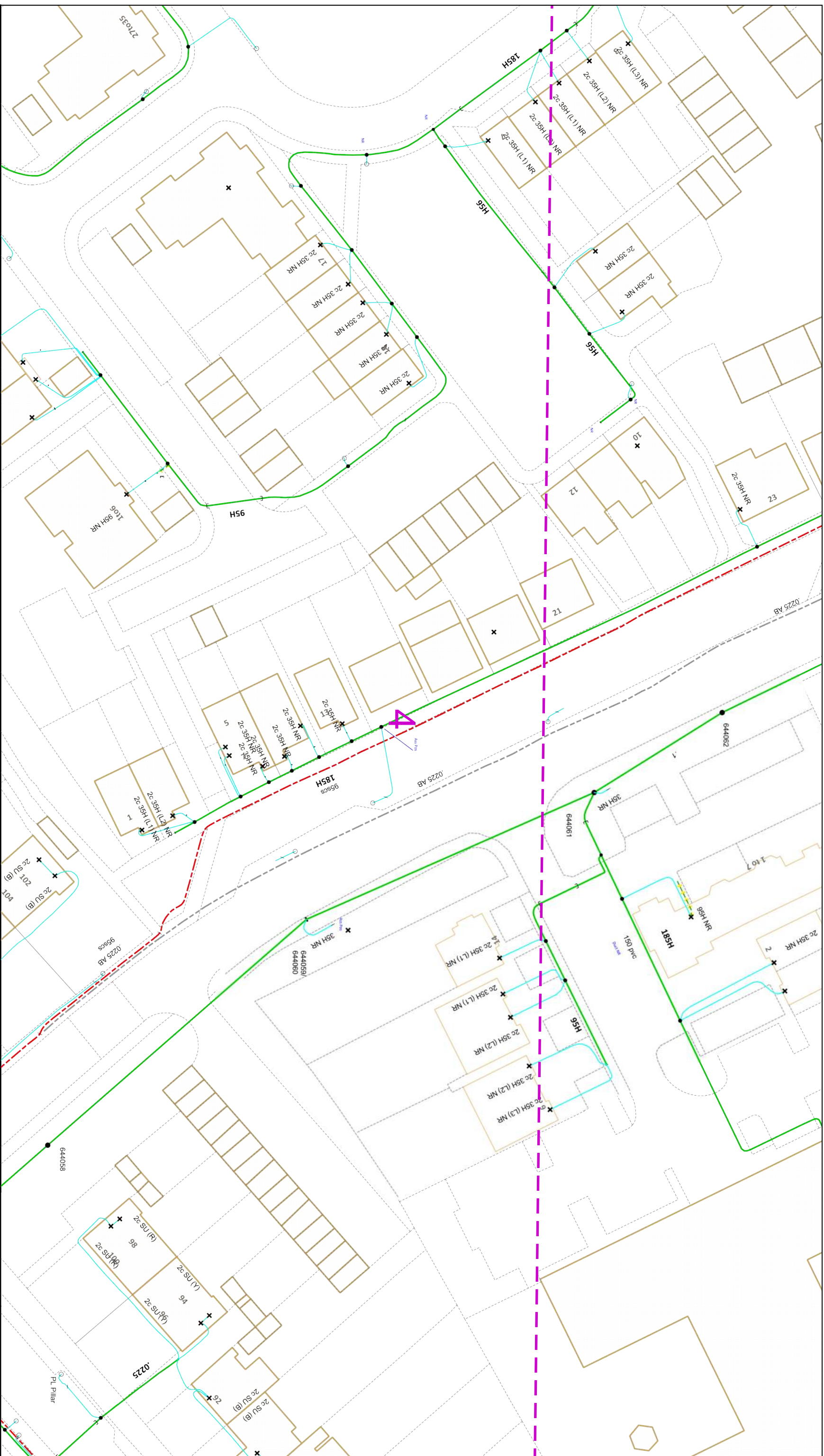

This plan must be used with the attached 'Symbols' document.

Date Requested: 12/12/2018
Job Reference: 14403313
Site Location: 524155 136455
Requested by:
Mr Gareth Adam
Your Scheme/Reference: West of
Ifield - 9 of 13

1. The position of the apparatus shown on this drawing is believed to be correct, but the original landmarks may have been altered since the apparatus was installed.
2. The exact position of the apparatus should be verified - use approved cable avoidance tools prior to excavation using suitable hand tools.
3. It is essential that trial holes are carefully made avoiding the use of mechanical tools or picks until the exact location of all the cables have been determined.
4. It must be assumed that there is a service cable into each property, lamp column and street sign, etc.
5. All cables must be treated as being live unless proved otherwise by UK Power Networks.
6. The information provided must be given to all people working near UK Power Networks plant and equipment. Do not use plans more than 12 months after the issue date for excavation purposes.
7. Please be aware that electric cables/lines belonging to other owners of licensed electricity distribution systems may be present, and it is your responsibility to identify their location.

Dig Sites

Area:

Line: - - - -

The quality and accuracy of any print will depend on your printer, your computer and its print settings. Measurements scaled from this plan may not match measurements between the same points on the ground.

1. UK Power Networks does not warrant that the information provided to you is correct. You rely upon it at your own risk.
2. UK Power Networks does not exclude or limit its liability if it causes the death of any persons or causes personal injury to a person.
3. Subject to paragraph 2 UK Power Networks has no liability to you in contract, in tort (including negligence), in breach of statutory duty or otherwise for any loss, damage, cost, claims, demands, or expenses that you or any third party may suffer or incur as a result of using any of the information provided whether for physical damage to property or for any economic loss (including without limitation loss of profit, loss of opportunity, loss of savings, loss of goodwill, loss of business, loss of use) or any special or consequential loss or damage whatsoever.
4. This plan has been provided to you on the basis of the terms of use set out in the covering letter that accompanies this plan. If you do not accept and/or do not understand the terms of use set out in the covering letter you must not use the plan and must return it to the sender of the letter.
5. You are responsible for the security of the information provided to you. It must not be given, sold or made available upon payment of fee to a third party.



IF IN DOUBT - ASK!
PHONE 0800 056 5866
EMERGENCY - If you
damage a cable or lin
Phone 0800 783 8838
(24hrs) **URGENTLY**

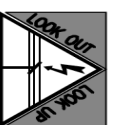

**ALWAYS LOOK UP
BEFORE
YOU START WORK**
Refer to HSE
Guidance note GS6



Maps produced at 1:2500 scale are Geo-Schematics which show LV mains cables and overhead lines (in some cases all voltages). Prior to carrying out excavations you must refer to the 1:500 records to determine the location of all known underground plant and equipment.

Reproduced by permission of Ordnance Survey on behalf of HMSO. © Crown copyright and database rights 2018. All rights reserved. Ordnance Survey Licence numbers 100019626, 100019826 and 100019450. Data has been added to the Ordnance Survey base map; all proprietary rights in such additional data are and shall remain the exclusive property of © London Power Networks plc or Eastern Power Networks plc each being a distribution licensee under section 6(1)(c) of the Electricity Act 1989 for the relevant distribution services area as that term is defined in such licensee's distribution licence. All rights in such data reserved.

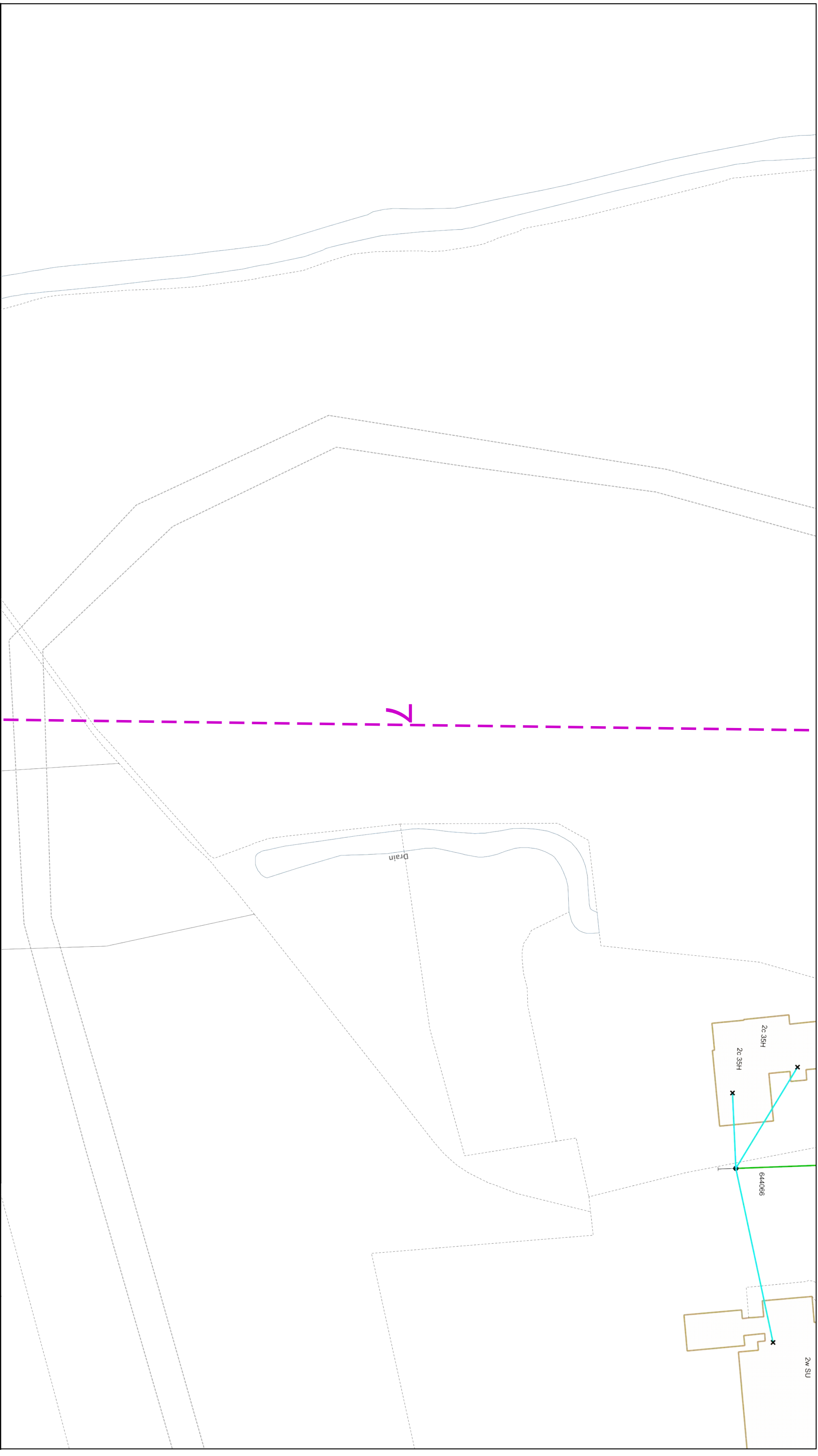
Plans generated by DigsAFE Pro™ software provided by LinesearchbeforeUdig



A vertical scale bar with markings at 0, 25, and 50 metres. The bar is divided into segments by horizontal lines. The word 'metres' is written vertically to the right of the bar.

Dig Sites **Area:**  **Line:**  The quality and accuracy of any print will depend on your printer, your computer and its print settings. Measurements scaled from this plan may not match measurements between the same points on the ground.

1. The position of the apparatus shown on this drawing is believed to be correct but the original landmarks may have been altered since the apparatus was installed.
2. The exact position of the apparatus should be verified - use approved cable avoidance tools prior to excavation using suitable hand tools.

5. It is essential that contractors make avoiding the use of mechanical tools or picks until the exact location of all the cables have been determined.

6. It must be assumed that there is a service cable in each property, lamp column and street sign, etc.

5. All cables must be treated as being live unless proved otherwise by UK Power Networks.

6. The information provided must be given to all people working near UK Power Networks plant and equipment. Do not use plans more than 3 months after the issue date for excavation purposes.

7. Please be aware that electric cables/lines belonging to other owners of licensed electricity distribution systems may be present and it is your responsibility to identify their location.

Mr Garath Adam
Your Scheme/Reference: West of
Weid - 9 of 13

1. UK Power Networks does not warrant that the information provided to you is correct. You rely upon it at your own risk.
2. UK Power Networks does not exclude or limit its liability if it causes the death of any persons or causes personal injury to a person.
3. Subject to paragraph 2 UK Power Networks has no liability to you in contract, in tort (including negligence), for breach of statutory duty or otherwise for any loss, damage, cost, claims, demands, or expenses that you or any third party may suffer or incur as a result of using the information provided whether for physical damage to property or for any economic loss (including without limitation loss of profit, loss of opportunity, loss of savings, loss of goodwill, loss of business, loss of use) or any special or consequential loss or damage whatsoever.
4. This plan has been provided to you on the basis of the terms of use set out in the covering letter that accompanies this plan. If you do not accept and/or do not understand the terms of use set out in the covering letter you must not use the plan and must return it to the sender of the letter.
5. You are responsible for the security of the information provided to you. It must not be given, sold or made available upon payment of a fee to a third party.

<p>IF IN DOUBT - ASK! PHONE 0800 056 5866 EMERGENCY - if you damage a cable or line Phone 0800 783 8638 (24hrs) URGENTLY</p>		<p>ALWAYS LOOK UP BEFORE YOU START WORK Refer to HSE Guidance note G56</p>
---	---	--



**ALWAYS LOOK UP
BEFORE
YOU START WORK**
Refer to HSE
Guidance note G56

Maps produced at 1:2500 scale are Geo-Schematics which show LV mains cables and overhead lines (in some cases all voltages). Prior to carrying out excavations you must refer to the 1:500 records to determine the location of all known underground plant and equipment.



Reproduced by permission of Ordnance Survey on behalf of HMSO. © Crown copyright and database rights 2018. All rights reserved. Ordnance Survey Licence numbers 100019626, 100019826 and 100019450. Data has been added to the Ordnance Survey base map; all proprietary rights in such additional data are and shall remain the exclusive property of © London Power Networks plc or Eastern Power Networks plc each being a distribution licensee under section 6(1)(c) of the Electricity Act 1989 for the relevant distribution services area as that term is defined in such licensee's distribution licence. All rights in such data reserved.

Plans generated by DigSAFE Pro™ software provided by Linesearchforending.

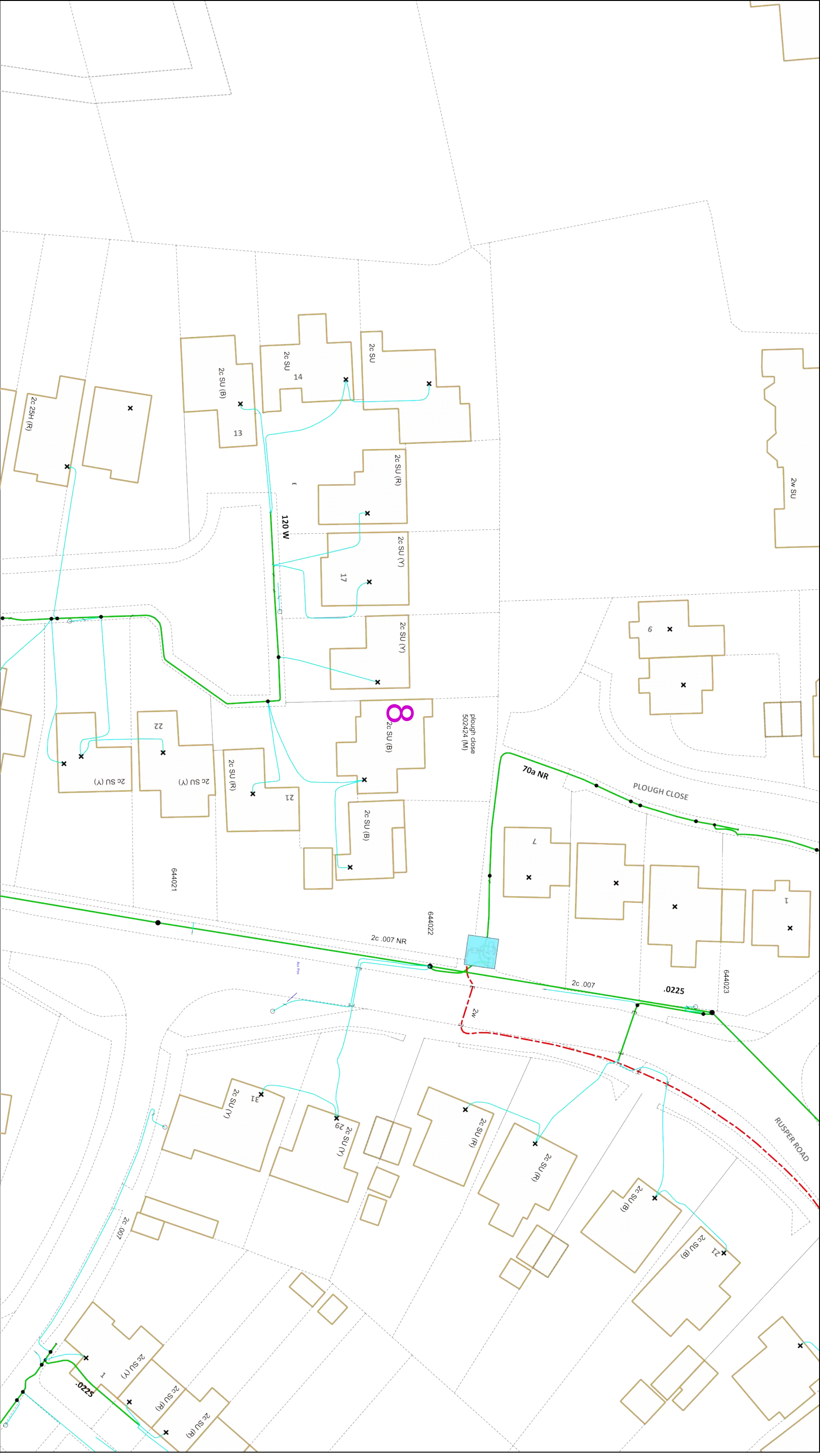

0 25 50

metres

Dig Sites Area: Line:

The quality and accuracy of any print will depend on your printer, your computer and its print settings. Measurements scaled from this plan may not match measurements between the same points on the ground.

This plan must be used with the attached 'Symbols' document.

1. The position of the apparatus shown on this drawing is believed to be correct but the original landmarks may have been altered since the apparatus was installed.

2. The exact position of the apparatus should be verified - use approved cable avoidance tools prior to excavation using suitable hand tools.

3. It is essential that trial holes are carefully made avoiding the use of mechanical tools or picks until the exact location of all the cables have been determined.

4. It must be assumed that there is a service cable into each property, lamp column and street sign, etc.

5. All cables must be treated as being live unless proved otherwise by UK Power Networks.

6. The information provided must be given to all people working near UK Power Networks plant and equipment. Do not use plans more than 3 months after the issue date for excavation purposes.

7. Please be aware that electric cables/lines belonging to other owners of licensed electricity distribution systems may be present and it is your responsibility to identify their location.

Date Requested: 12/12/2018

Job Reference: 14403313

Site Location: 524155 136455

Requested by:

Mr Gareth Adam

Your Scheme/Reference: West of field - 9 of 13

Scale: 1:500 (When plotted at A3)

1. UK Power Networks does not warrant that the information provided to you is correct. You rely upon it at your own risk.

2. UK Power Networks does not exclude or limit its liability if it causes the death of any persons or causes personal injury to a person.

3. Subject to paragraph 2 UK Power Networks has no liability to you in contract, in tort (including negligence), for breach of statutory duty or otherwise for any loss, damage, cost, claims, demands, or expenses that you or any third party may suffer or incur as a result of using the information provided whether for physical damage to property or for any economic loss (including without limitation loss of profit, loss of opportunity, loss of savings, loss of goodwill, loss of business, loss of use) or any special or consequential loss or damage whatsoever.

4. This plan has been provided to you on the basis of the terms of use set out in the covering letter that accompanies this plan. If you do not accept and/or do not understand the terms of use set out in the covering letter you must not use the plan and must return it to the sender of the letter.

5. You are responsible for the security of the information provided to you. It must not be given, sold or made available upon payment of a fee to a third party.



IF IN DOUBT - ASK!
PHONE 0800 056 5866
EMERGENCY - If you damage a cable or line
Phone 0800 783 8838
(24hrs) URGENTLY

ALWAYS LOOK UP
BEFORE
YOU START WORK
Refer to HSE
Guidance note G56

Maps produced at 1:2500 scale are Geo Schematics which show LV mains cables and refer to the 1:500 records to determine the location of all known underground plant and equipment.

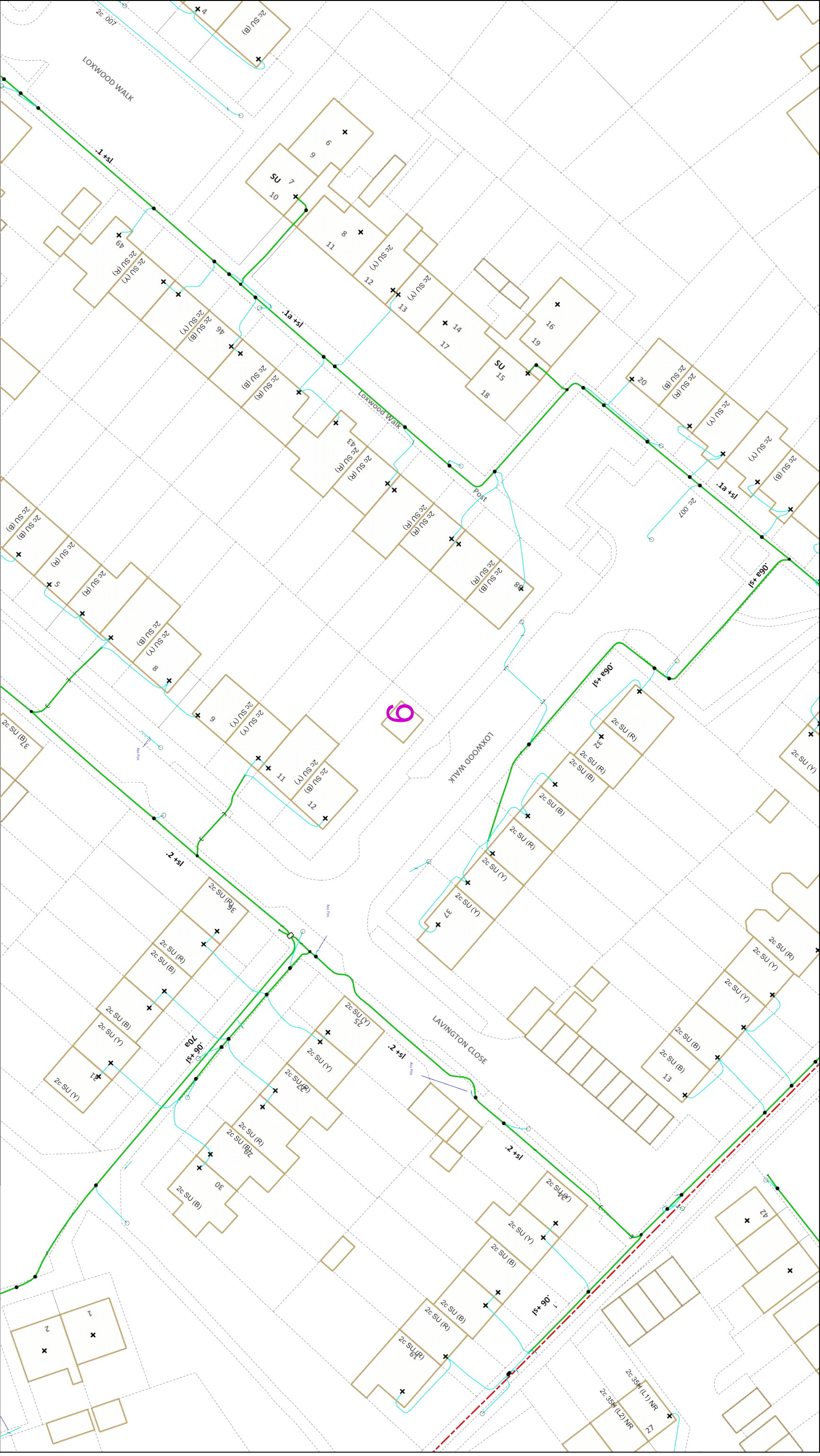

0 25 50
metres

Dig Sites Area: Line:

The quality and accuracy of any print will depend on your printer, your computer and its print settings. Measurements scaled from this plan may not match measurements between the same points on the ground.

This plan must be used with the attached 'Symbols' document.

1. The position of the apparatus shown on this drawing is believed to be correct but the original landmarks may have been altered since the apparatus was installed.
2. The exact position of the apparatus should be verified - use approved cable avoidance tools prior to excavation using suitable hand tools.
3. It is essential that trial holes are carefully made avoiding the use of mechanical tools or picks until the exact location of all the cables have been determined.
4. It must be assumed that there is a service cable into each property, lamp column and street sign, etc.
5. All cables must be treated as being live unless proved otherwise by UK Power Networks.
6. The information provided must be given to all people working near UK Power Networks plant and equipment. Do not use plans more than 3 months after the issue date for excavation purposes.
7. Please be aware that electric cables/lines belonging to other owners of licensed electricity distribution systems may be present and it is your responsibility to identify their location.

Date Requested: 12/12/2018
Job Reference: 14403313
Site Location: 524155 136455
Requested by: Mr Gareth Adam
Your Scheme/Reference: West of field - 9 of 13

Scale: 1:500 (When plotted at A3)

1. UK Power Networks does not warrant that the information provided to you is correct. You rely upon it at your own risk.
2. UK Power Networks does not exclude or limit its liability if it causes the death of any persons or causes personal injury to a person.
3. Subject to paragraph 2 UK Power Networks has no liability to you in contract, in tort (including negligence), for breach of statutory duty or otherwise for any loss, damage, cost, claims, demands, or expenses that you or any third party may suffer or incur as a result of using the information provided whether for physical damage to property or for any economic loss (including without limitation loss of profit, loss of opportunity, loss of savings, loss of goodwill, loss of business, loss of use) or any special or consequential loss or damage whatsoever.
4. This plan has been provided to you on the basis of the terms of use set out in the covering letter that accompanies this plan. If you do not accept and/or do not understand the terms of use set out in the covering letter you must not use the plan and must return it to the sender of the letter.
5. You are responsible for the security of the information provided to you. It must not be given, sold or made available upon payment of a fee to a third party.

Reproduced by permission of Ordnance Survey on behalf of HMSO. © Crown copyright and database rights 2018. All rights reserved. Ordnance Survey Licence numbers 100019626, 100019826 and 100019450. Data has been added to the Ordnance Survey base map: all proprietary rights in such additional data are and shall remain the exclusive property of © London Power Networks plc or Eastern Power Networks plc or South Eastern Power Networks plc each being a distribution licensee under section 6(1)(c) of the Electricity Act 1989 for the relevant distribution services area as that term is defined in such licensee's distribution licence. All rights in such data reserved.
Plans generated by DigsAFE Pro™ software provided by LinesearchbeforeUdig.