

Geo-Environmental Sussex

Published 1899

Source map scale - 1:10,560

The historical maps shown were reproduced from maps predominantly held at the scale adopted for England, Wales and Scotland in the 1840's. In 1854 the 1:2,500 scale was adopted for mapping urban areas; these maps were used to update the 1:10,560 maps. The published date given therefore is often some years later than the surveyed date. Before 1938, all OS maps were based on the Cassini Projection, with independent surveys of a single county or group of counties, giving rise to significant inaccuracies in outlying areas. In the late 1940's, a Provisional Edition was produced, which updated the 1:10,560 mapping from a number of sources. The maps appear unfinished - with all military camps and other strategic sites removed. These maps were initially overprinted with the National Grid. In 1970, the first 1:10,000 maps were produced using the Transverse Mercator Projection. The revision process continued until recently, with new editions appearing every 10 years or so for urban areas.

Map Name(s) and Date(s)

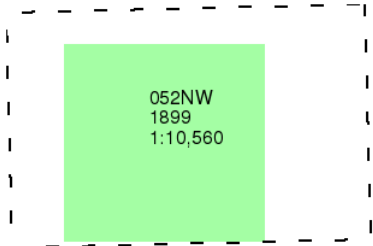

Historical Map - Slice A

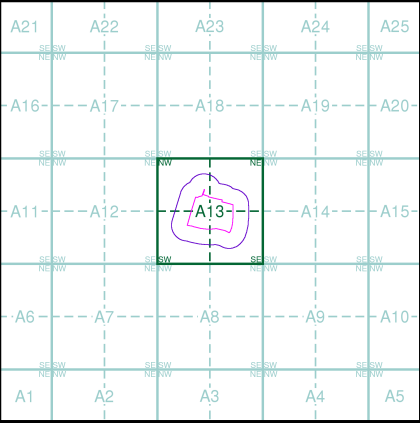

Order Details

Order Number: 321564727_1_1
Customer Ref: GE22017
National Grid Reference: 521320, 113120
Slice: A
Site Area (Ha): 5.13
Search Buffer (m): 1000

Site Details

Land off, Shoreham Road, Small Dole, West Sussex

Landmark
INFORMATION GROUP

Tel: 0844 844 9952
Fax: 0844 844 9951
Web: www.envirocheck.co.uk

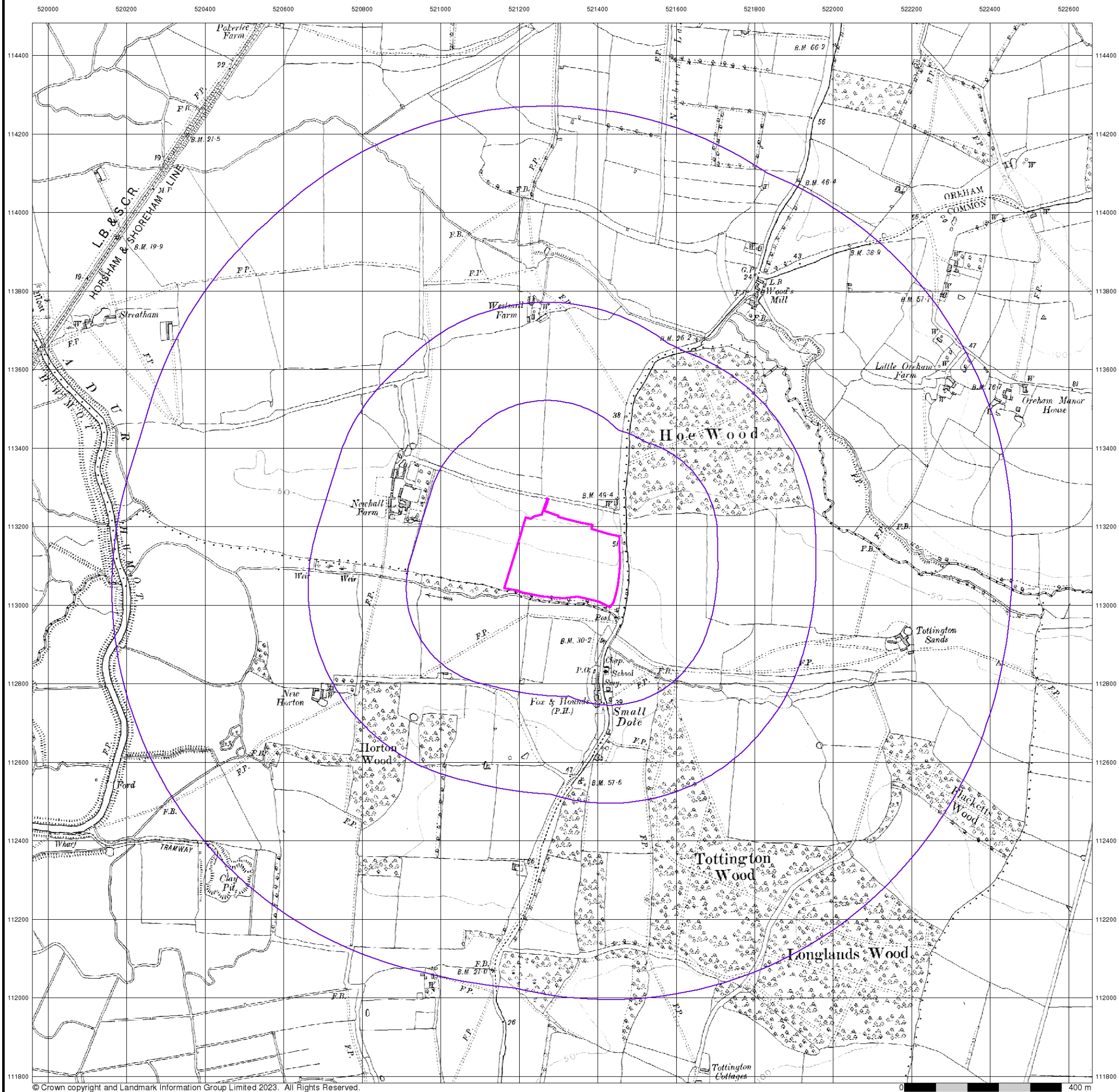

© Crown copyright and Landmark Information Group Limited 2023. All Rights Reserved.



Geo-Environmental Sussex

Published 1912

Source map scale - 1:10,560

The historical maps shown were reproduced from maps predominantly held at the scale adopted for England, Wales and Scotland in the 1840's. In 1854 the 1:2,500 scale was adopted for mapping urban areas; these maps were used to update the 1:10,560 maps. The published date given therefore is often some years later than the surveyed date. Before 1938, all OS maps were based on the Cassini Projection, with independent surveys of a single county or group of counties, giving rise to significant inaccuracies in outlying areas. In the late 1940's, a Provisional Edition was produced, which updated the 1:10,560 mapping from a number of sources. The maps appear unfinished - with all military camps and other strategic sites removed. These maps were initially overprinted with the National Grid. In 1970, the first 1:10,000 maps were produced using the Transverse Mercator Projection. The revision process continued until recently, with new editions appearing every 10 years or so for urban areas.

Map Name(s) and Date(s)

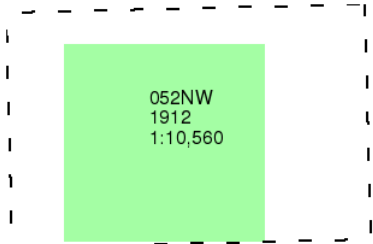

Historical Map - Slice A

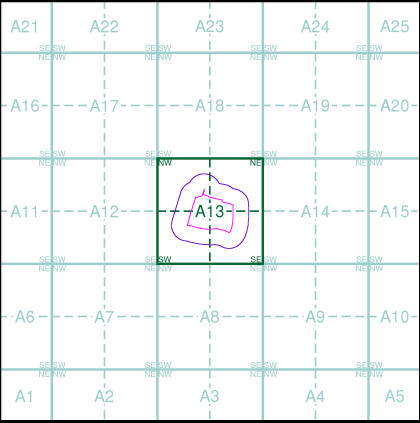

Order Details

Order Number: 321564727_1_1
Customer Ref: GE22017
National Grid Reference: 521320, 113120
Slice: A
Site Area (Ha): 5.13
Search Buffer (m): 1000

Site Details

Land off, Shoreham Road, Small Dole, West Sussex



Tel: 0844 844 9952
Fax: 0844 844 9951
Web: www.envirocheck.co.uk

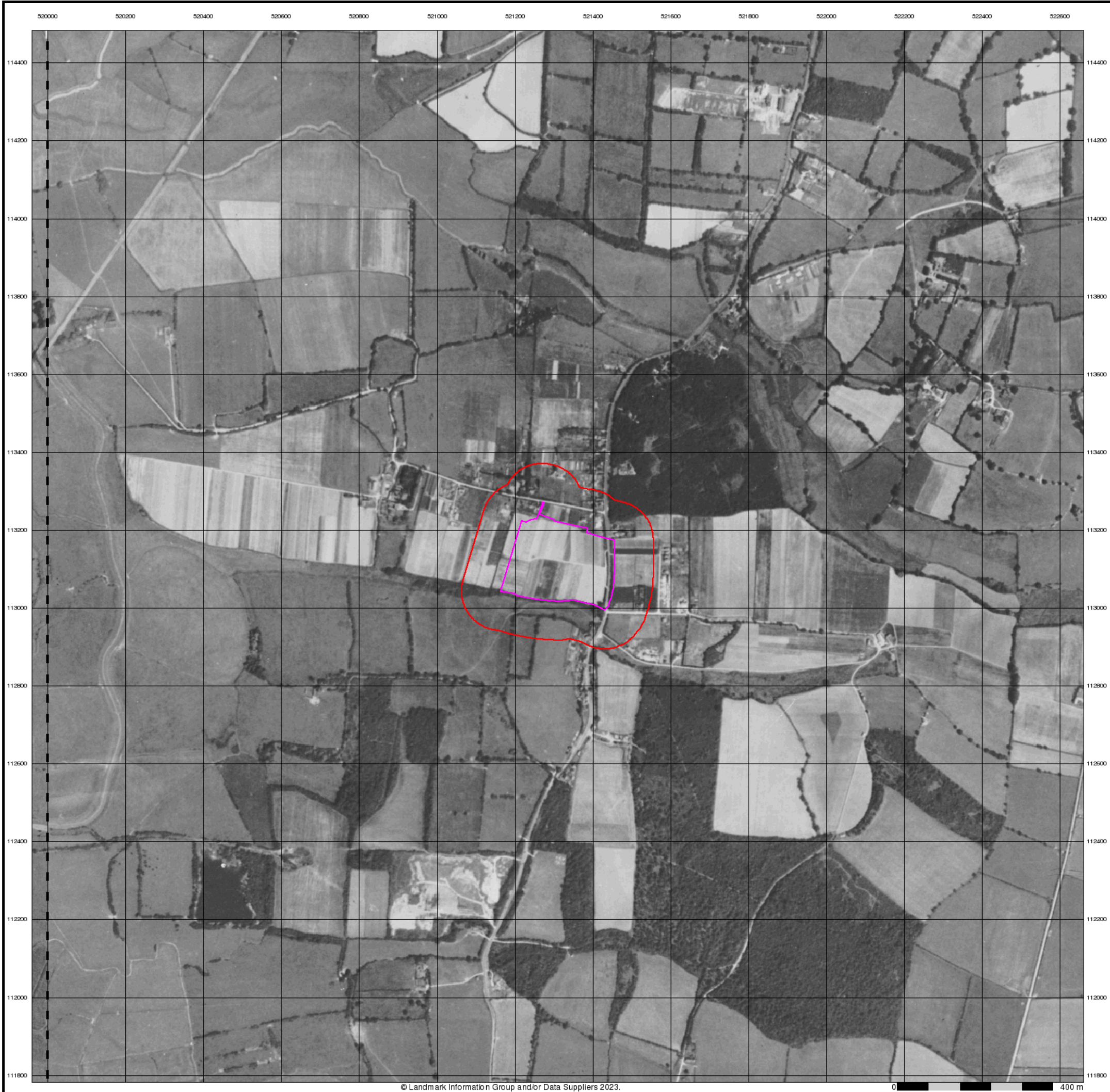

© Landmark Information Group and/or Data Suppliers 2023.



Geo-Environmental Historical Aerial Photography

Published 1947 - 1951

Source map scale - 1:10,560

The Historical Aerial Photos were produced by the Ordnance Survey at a scale of 1:1,250 and 1:10,560 from Air Force photography. They were produced between 1944 and 1951 as an interim measure, pending preparation of conventional mapping, due to post war resource shortages. New security measures in the 1950's meant that every photograph was re-checked for potentially unsafe information with security sites replaced by fake fields or clouds. The original editions were withdrawn and only later made available after a period of fifty years although due to the accuracy of the editing, without viewing both revisions it is not easy to spot the edits. Where available Landmark have included both revisions.

© Landmark Information Group and/or Data Suppliers 2010.

Map Name(s) and Date(s)

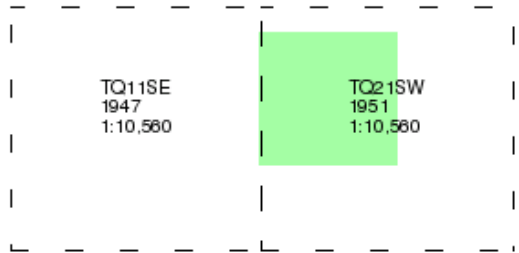

Historical Aerial Photography - Slice A

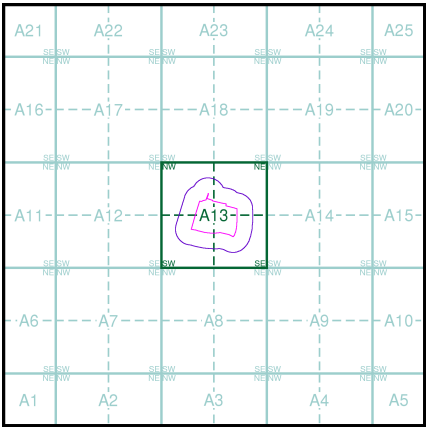

LIBRARY
HS111RB

Order Details

Order Number: 321564727_1_1
Customer Ref: GE22017
National Grid Reference: 521320, 113120
Slice: A
Site Area (Ha): 5.13
Search Buffer (m): 1000

Site Details

Land off, Shoreham Road, Small Dole, West Sussex

Landmark
INFORMATION GROUP

Tel: 0844 844 9952
Fax: 0844 844 9951
Web: www.envirocheck.co.uk



© Landmark Information Group and/or Data Suppliers 2023.



Geo-Environmental Historical Aerial Photography

Published 1947

Source map scale - 1:10,560

The Historical Aerial Photos were produced by the Ordnance Survey at a scale of 1:1,250 and 1:10,560 from Air Force photography. They were produced between 1944 and 1951 as an interim measure, pending preparation of conventional mapping, due to post war resource shortages. New security measures in the 1950's meant that every photograph was re-checked for potentially unsafe information with security sites replaced by fake fields or clouds. The original editions were withdrawn and only later made available after a period of fifty years although due to the accuracy of the editing, without viewing both revisions it is not easy to spot the edits. Where available Landmark have included both revisions.

© Landmark Information Group and/or Data Suppliers 2010.

Map Name(s) and Date(s)

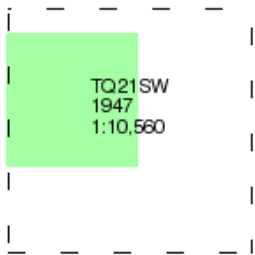

Historical Aerial Photography - Slice A

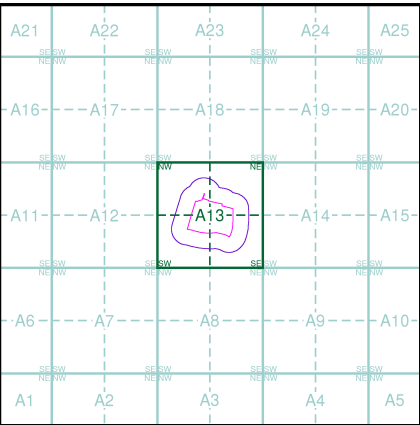

LIBRARY
HSILIRB

Order Details

Order Number: 321564727_1_1
Customer Ref: GE22017
National Grid Reference: 521320, 113120
Slice: A
Site Area (Ha): 5.13
Search Buffer (m): 1000

Site Details

Land off, Shoreham Road, Small Dole, West Sussex

Landmark
INFORMATION GROUP

Tel: 0844 844 9952
Fax: 0844 844 9951
Web: www.envirocheck.co.uk

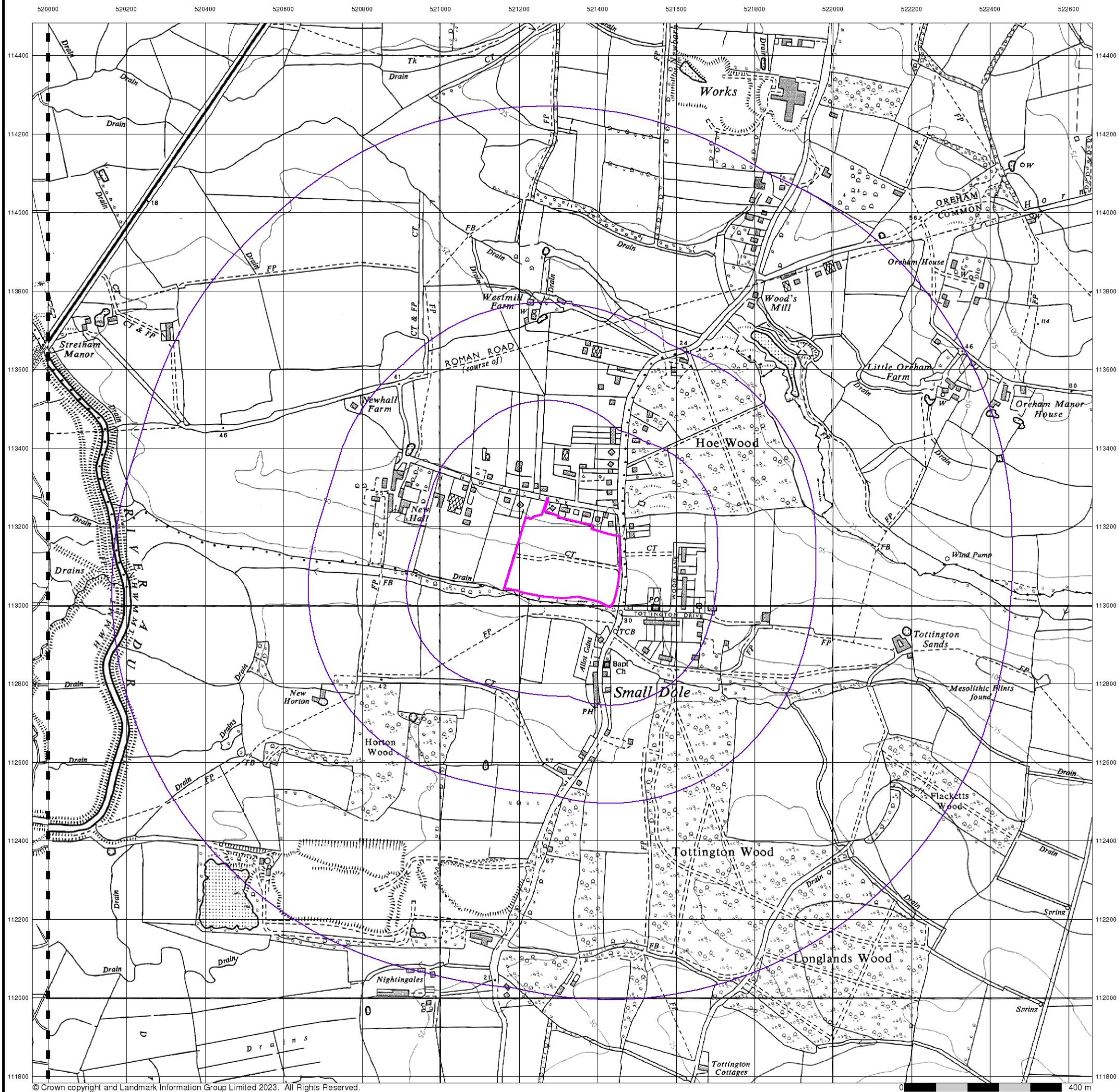

© Crown copyright and Landmark Information Group Limited 2023. All Rights Reserved.



Geo-Environmental Ordnance Survey Plan

Published 1961 - 1962

Source map scale - 1:10,000

The historical maps shown were reproduced from maps predominantly held at the scale adopted for England, Wales and Scotland in the 1840's. In 1854 the 1:2,500 scale was adopted for mapping urban areas; these maps were used to update the 1:10,560 maps. The published date given therefore is often some years later than the surveyed date. Before 1938, all OS maps were based on the Cassini Projection, with independent surveys of a single county or group of counties, giving rise to significant inaccuracies in outlying areas. In the late 1940's, a Provisional Edition was produced, which updated the 1:10,560 mapping from a number of sources. The maps appear unfinished - with all military camps and other strategic sites removed. These maps were initially overprinted with the National Grid. In 1970, the first 1:10,000 maps were produced using the Transverse Mercator Projection. The revision process continued until recently, with new editions appearing every 10 years or so for urban areas.

Map Name(s) and Date(s)

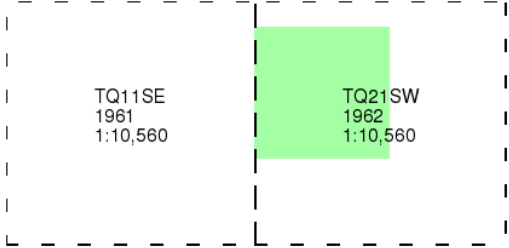

Historical Map - Slice A

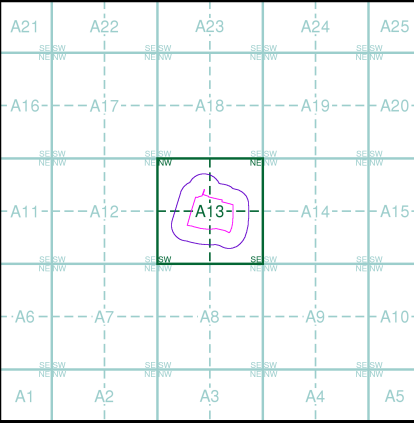

Order Details

Order Number: 321564727_1_1
Customer Ref: GE22017
National Grid Reference: 521320, 113120
Slice: A
Site Area (Ha): 5.13
Search Buffer (m): 1000

Site Details

Land off, Shoreham Road, Small Dole, West Sussex



Tel: 0844 844 9952
Fax: 0844 844 9951
Web: www.envirocheck.co.uk

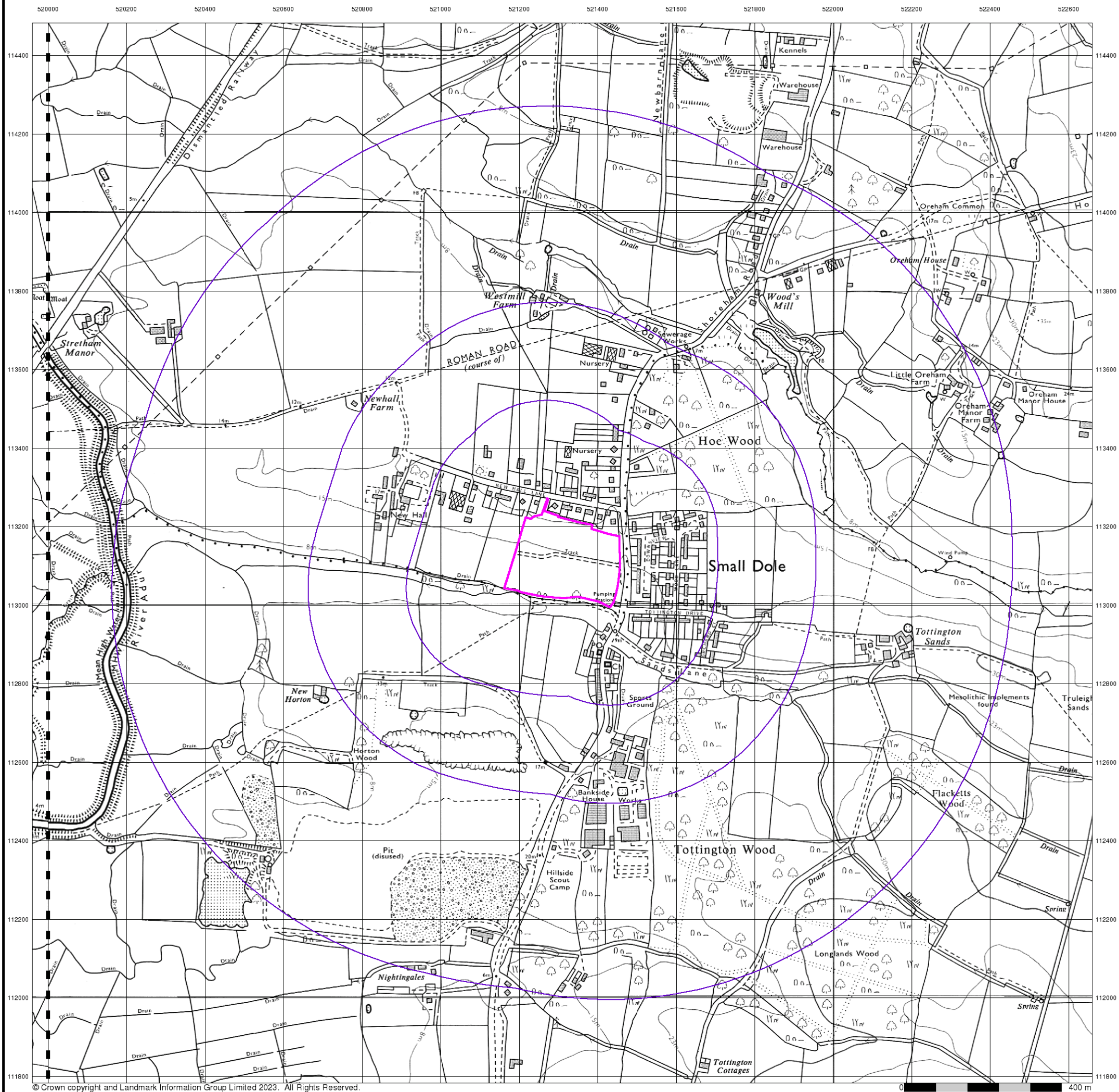

© Crown copyright and Landmark Information Group Limited 2023. All Rights Reserved.



Geo-Environmental Ordnance Survey Plan

Published 1976 - 1977

Source map scale - 1:10,000

The historical maps shown were reproduced from maps predominantly held at the scale adopted for England, Wales and Scotland in the 1840's. In 1854 the 1:2,500 scale was adopted for mapping urban areas; these maps were used to update the 1:10,560 maps. The published date given therefore is often some years later than the surveyed date. Before 1938, all OS maps were based on the Cassini Projection, with independent surveys of a single county or group of counties, giving rise to significant inaccuracies in outlying areas. In the late 1940's, a Provisional Edition was produced, which updated the 1:10,560 mapping from a number of sources. The maps appear unfinished - with all military camps and other strategic sites removed. These maps were initially overprinted with the National Grid. In 1970, the first 1:10,000 maps were produced using the Transverse Mercator Projection. The revision process continued until recently, with new editions appearing every 10 years or so for urban areas.

Map Name(s) and Date(s)

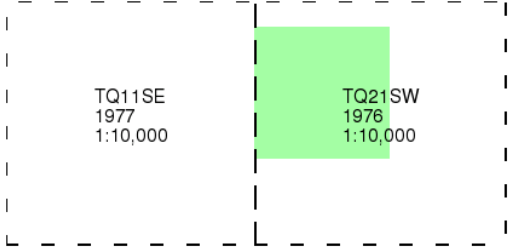

Historical Map - Slice A

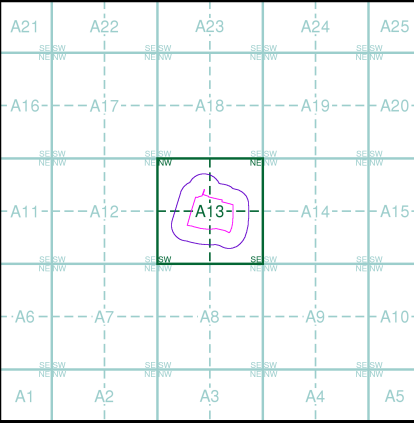

Order Details

Order Number: 321564727_1_1
Customer Ref: GE22017
National Grid Reference: 521320, 113120
Slice: A
Site Area (Ha): 5.13
Search Buffer (m): 1000

Site Details

Land off, Shoreham Road, Small Dole, West Sussex



Tel: 0844 844 9952
Fax: 0844 844 9951
Web: www.envirocheck.co.uk

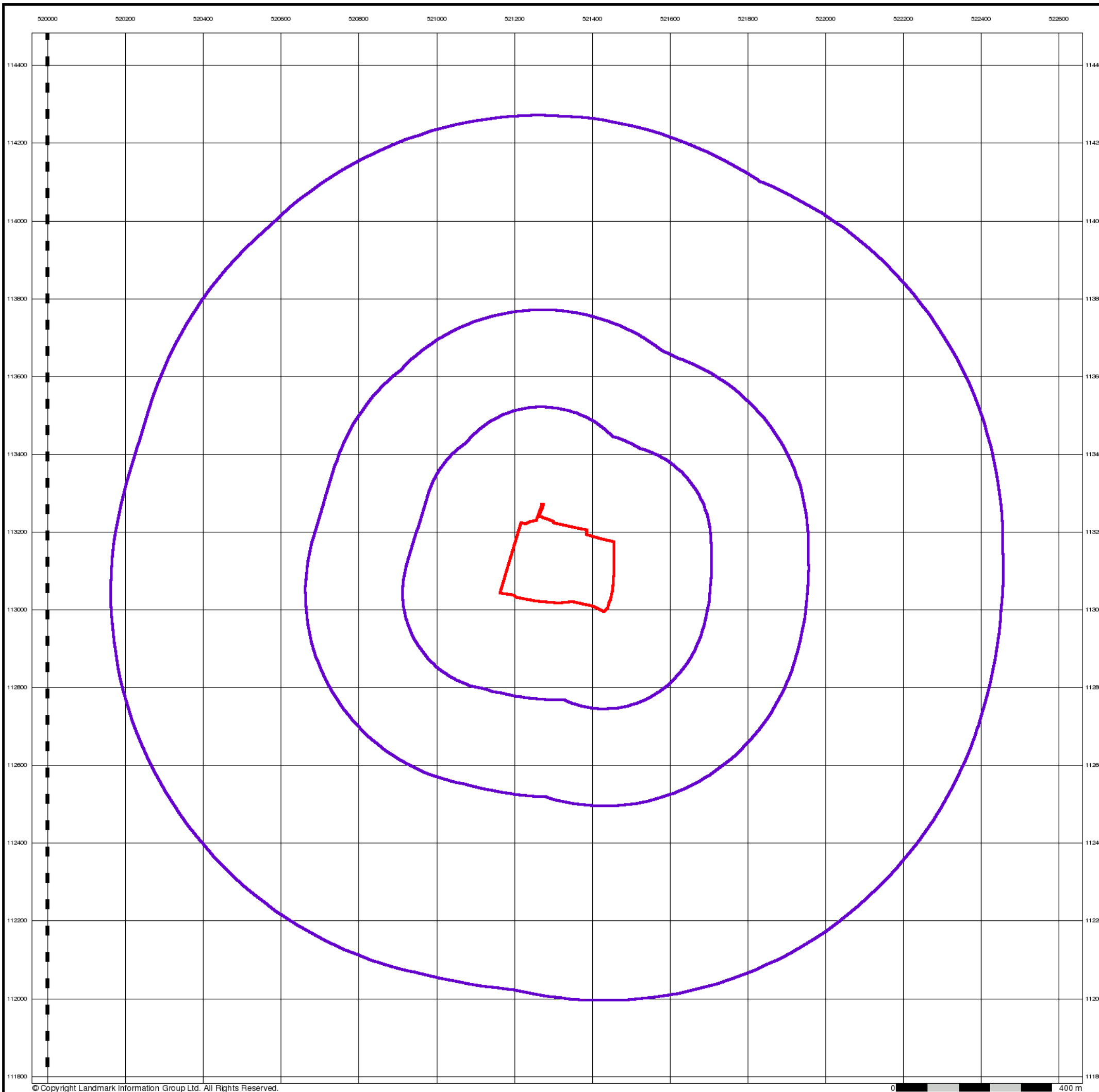

© Copyright Landmark Information Group Ltd. All Rights Reserved.



Geo-Environmental Brighton

Published 1990

Source map scale - 1:10,000

These maps were produced by the Russian military during the Cold War between 1950 and 1997, and cover 103 towns and cities throughout the U.K. The maps are produced at 1:25,000, 1:10,000 and 1:5,000 scale, and show detailed land use, with colour-coded areas for development, green areas, and non-developed areas. Buildings are coloured black and important building uses (such as hospitals, post offices, factories etc.) are numbered, with a numbered key describing their use.

They were produced by the Russians for the benefit of navigation, as well as strategic military sites and transport hubs, for use if they were to have invaded the U.K. The detailed information provided indicates that the areas were surveyed using land-based personnel, on the ground, in the cities that are mapped.

Map Name(s) and Date(s)

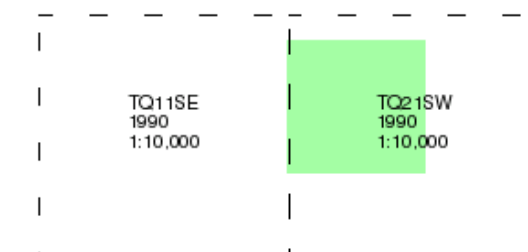

Russian Map - Slice A

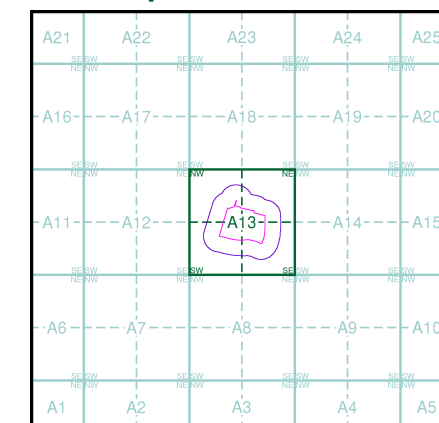

Order Details

Order Number: 321564727_1_1
Customer Ref: GE22017
National Grid Reference: 521320, 113120
Slice: A
Site Area (Ha): 5.13
Search Buffer (m): 1000

Site Details

Land off, Shoreham Road, Small Dole, West Sussex

Landmark
INFORMATION GROUP

Tel: 0844 844 9952
Fax: 0844 844 9951
Web: www.envirocheck.co.uk

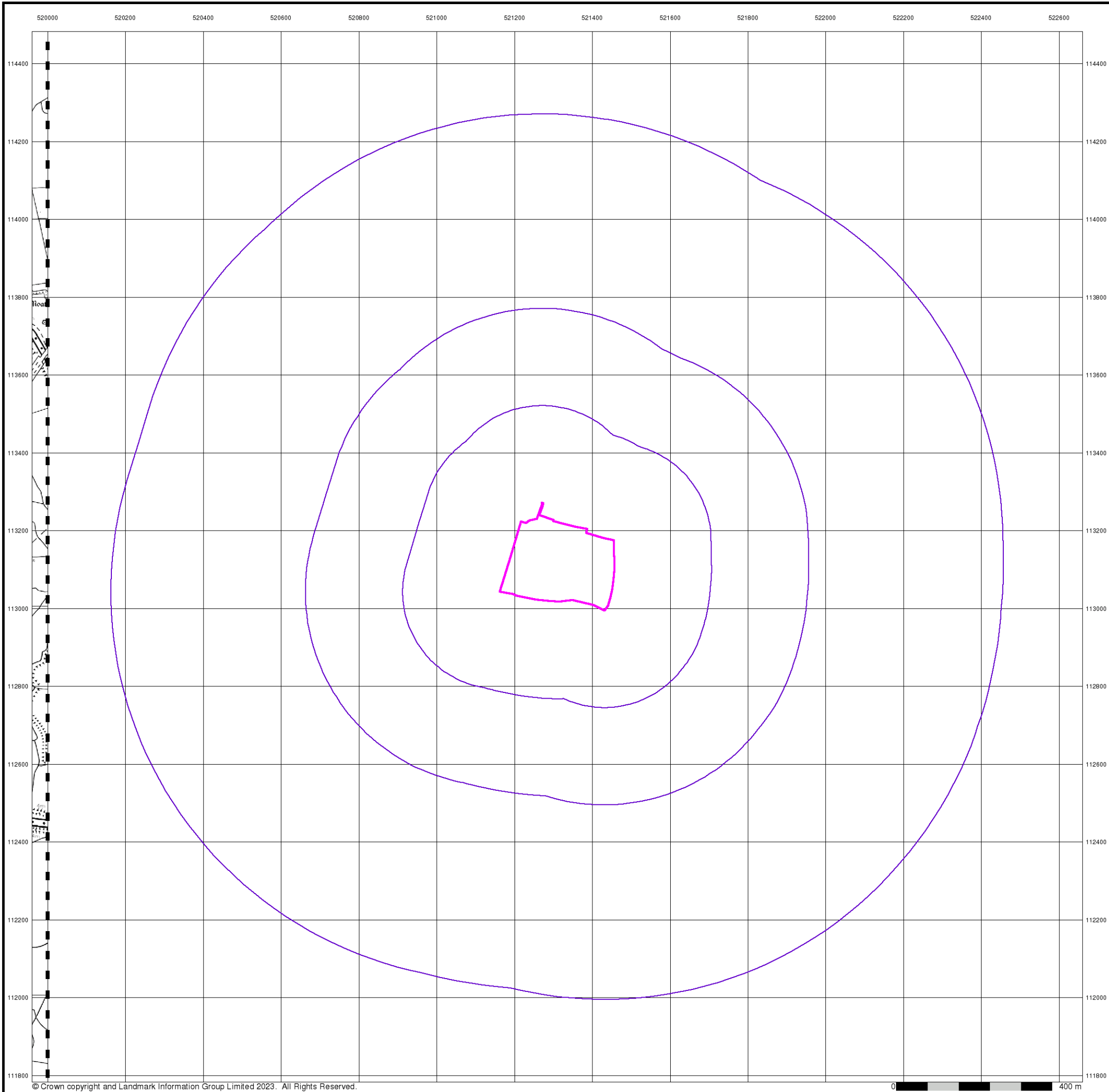

© Crown copyright and Landmark Information Group Limited 2023. All Rights Reserved.



**Geo-Environmental
Ordnance Survey Plan**

Published 1993

Source map scale - 1:10,000

The historical maps shown were reproduced from maps predominantly held at the scale adopted for England, Wales and Scotland in the 1840's. In 1854 the 1:2,500 scale was adopted for mapping urban areas; these maps were used to update the 1:10,560 maps. The published date given therefore is often some years later than the surveyed date. Before 1938, all OS maps were based on the Cassini Projection, with independent surveys of a single county or group of counties, giving rise to significant inaccuracies in outlying areas. In the late 1940's, a Provisional Edition was produced, which updated the 1:10,560 mapping from a number of sources. The maps appear unfinished - with all military camps and other strategic sites removed. These maps were initially overprinted with the National Grid. In 1970, the first 1:10,000 maps were produced using the Transverse Mercator Projection. The revision process continued until recently, with new editions appearing every 10 years or so for urban areas.

Map Name(s) and Date(s)

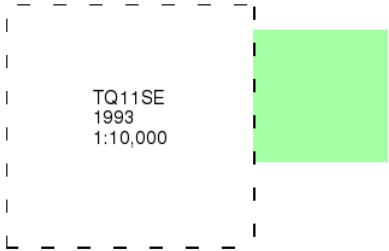

Historical Map - Slice A

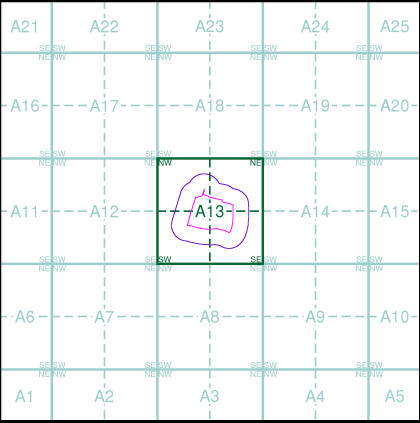

Order Details

Order Number: 321564727_1_1
Customer Ref: GE22017
National Grid Reference: 521320, 113120
Slice: A
Site Area (Ha): 5.13
Search Buffer (m): 1000

Site Details

Land off, Shoreham Road, Small Dole, West Sussex



Tel: 0844 844 9952
Fax: 0844 844 9951
Web: www.envirocheck.co.uk

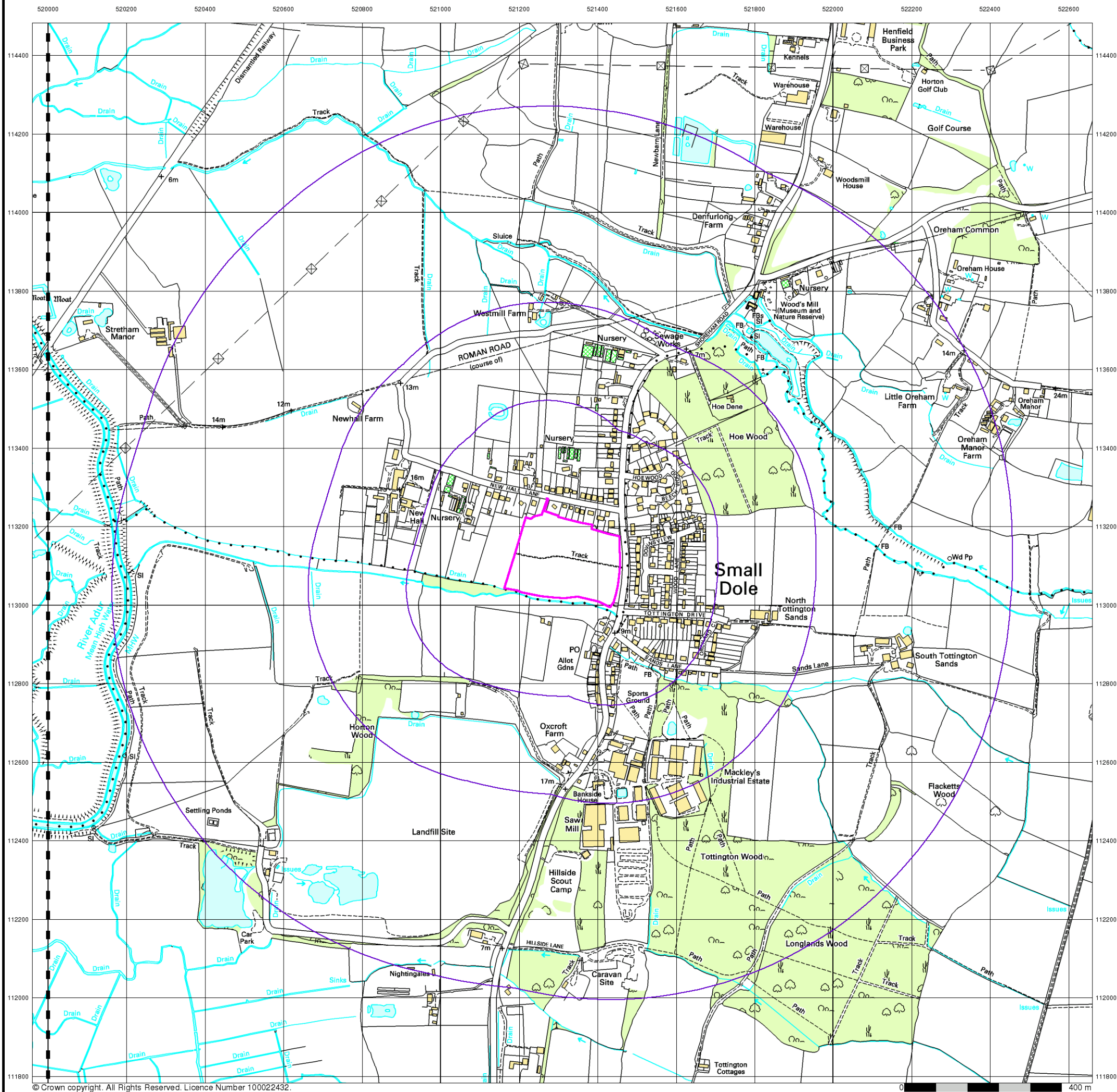

© Crown copyright. All Rights Reserved. Licence Number 100022432.



Geo-Environmental 10k Raster Mapping

Published 2000

Source map scale - 1:10,000

The historical maps shown were produced from the Ordnance Survey's 1:10,000 colour raster mapping. These maps are derived from Landplan which replaced the old 1:10,000 maps originally published in 1970. The data is highly detailed showing buildings, fences and field boundaries as well as all roads, tracks and paths. Road names are also included together with the relevant road number and classification. Boundary information depiction includes county, unitary authority, district, civil parish and constituency.

Map Name(s) and Date(s)

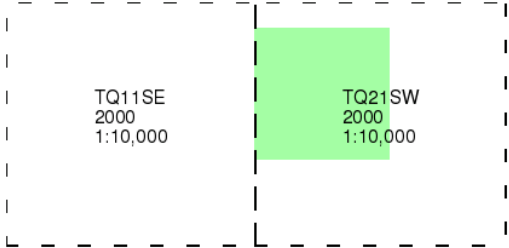

Historical Map - Slice A

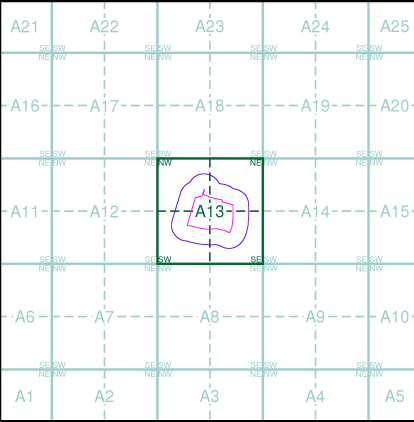

Order Details

Order Number: 321564727_1_1
Customer Ref: GE22017
National Grid Reference: 521320, 113120
Slice: A
Site Area (Ha): 5.13
Search Buffer (m): 1000

Site Details

Land off, Shoreham Road, Small Dole, West Sussex

Landmark
INFORMATION GROUP

Tel: 0844 844 9952
Fax: 0844 844 9951
Web: www.envirocheck.co.uk

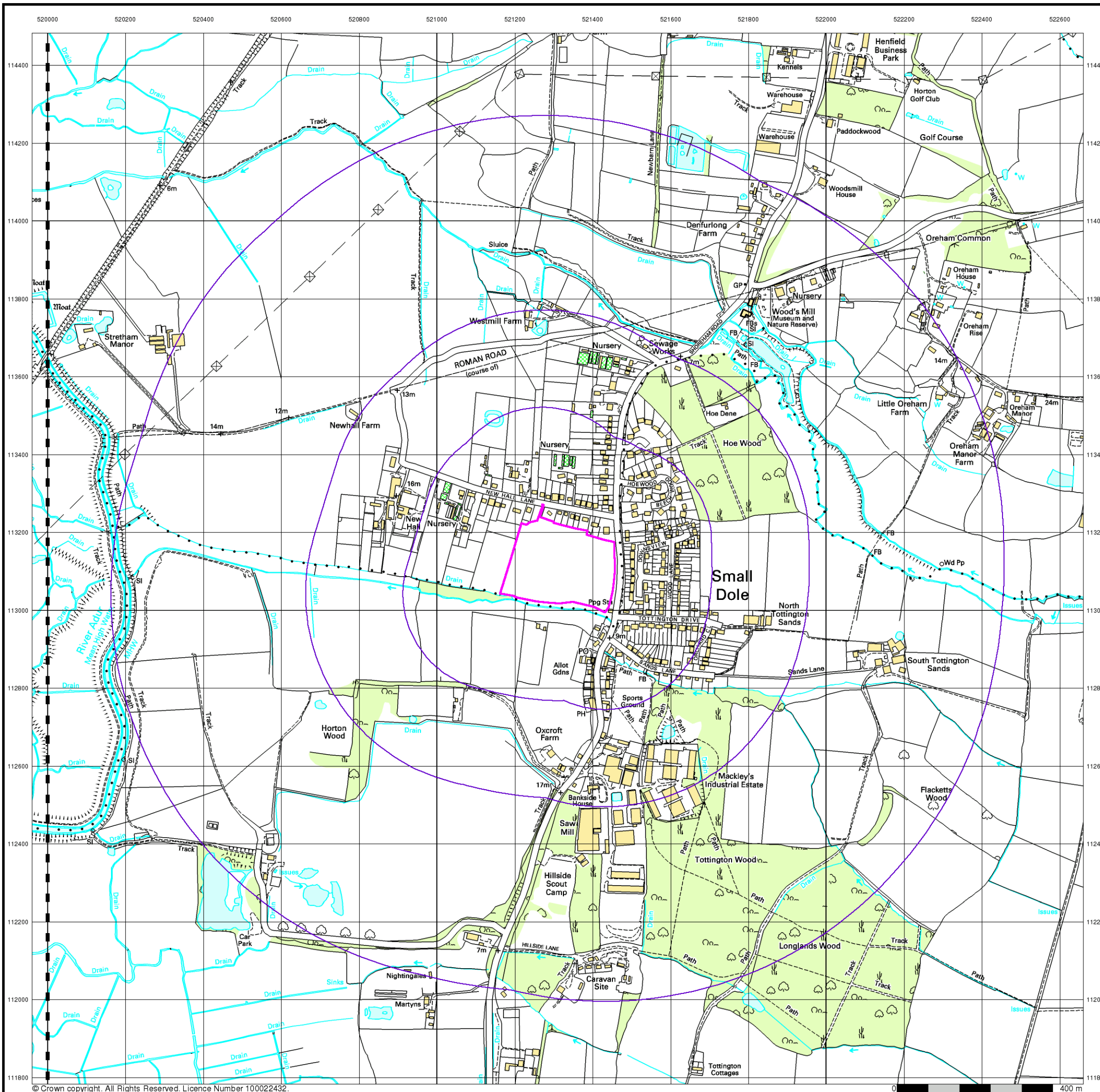

Geo-Environmental 10k Raster Mapping

Published 2006

Source map scale - 1:10,000

The historical maps shown were produced from the Ordnance Survey's 1:10,000 colour raster mapping. These maps are derived from Landplan which replaced the old 1:10,000 maps originally published in 1970. The data is highly detailed showing buildings, fences and field boundaries as well as all roads, tracks and paths. Road names are also included together with the relevant road number and classification. Boundary information depiction includes county, unitary authority, district, civil parish and constituency.

Map Name(s) and Date(s)

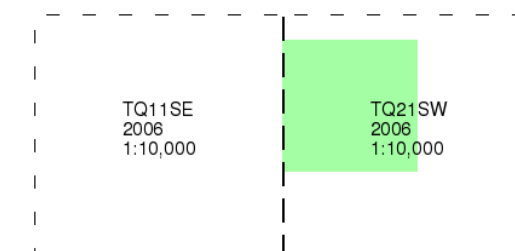

Historical Map - Slice A

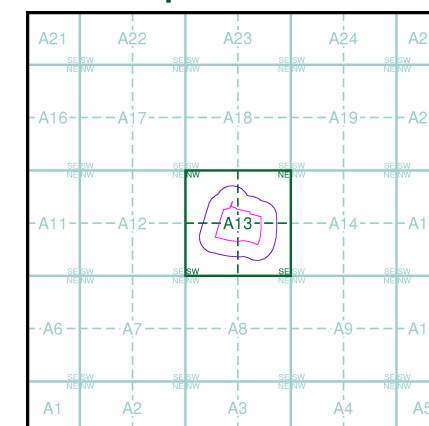

Order Details

Order Number: 321564727_1_1
Customer Ref: GE22017
National Grid Reference: 521320, 113120
Slice: A
Site Area (Ha): 5.13
Search Buffer (m): 1000

Site Details

Land off, Shoreham Road, Small Dole, West Sussex

Landmark
INFORMATION GROUP

Tel: 0844 844 9952
Fax: 0844 844 9951
Web: www.envirocheck.co.uk



VectorMap Local (Raster) is Ordnance Survey's highest detailed 'backdrop' mapping product. These maps are produced from OS's VectorMap Local, a simple vector dataset at a nominal scale of 1:10,000, covering the whole of Great Britain, that has been designed for creating graphical mapping. OS VectorMap Local is derived from large-scale information surveyed at 1:1250 scale (covering major towns and cities), 1:2500 scale (smaller towns, villages and developed rural areas), and 1:10 000 scale (mountain, moorland and river estuary areas).

Map Name(s) and Date(s)

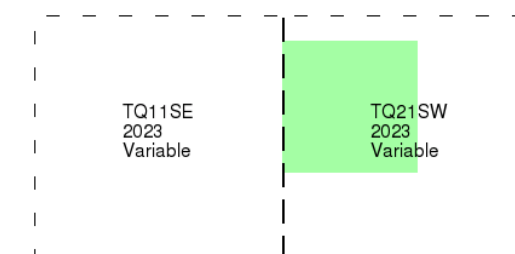

Historical Map - Slice A

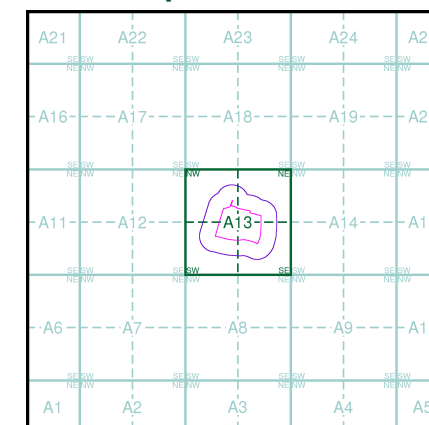

Order Details

Order Number: 321564727_1_1
Customer Ref: GE22017
National Grid Reference: 521320, 113120
Slice: A
Site Area (Ha): 5.13
Search Buffer (m): 1000

Site Details

Land off, Shoreham Road, Small Dole, West Sussex

Landmark
INFORMATION GROUP

Tel: 0844 844 9952
Fax: 0844 844 9951
Web: www.envirocheck.co.uk

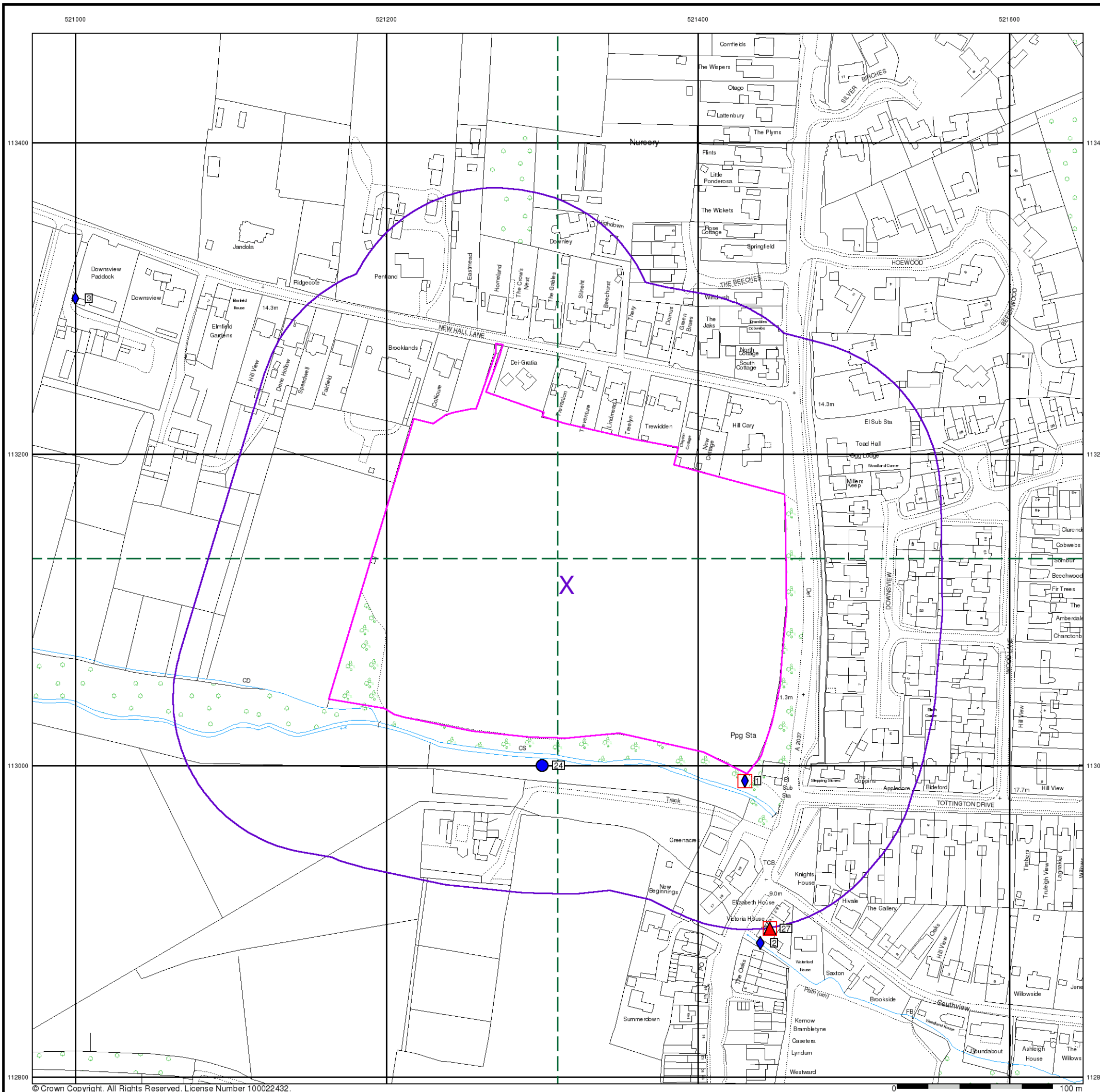

© Crown Copyright. All Rights Reserved. License Number 100022432.



Geo-Environmental

General

- Specified Site
- Specified Buffer(s)
- Bearing Reference Point
- Map ID
- Several of Type at Location
- Pylon
- Overhead Transmission Line

Agency and Hydrological

- Contaminated Land Register Entry or Notice (Location)
- Contaminated Land Register Entry or Notice
- Discharge Consent
- Enforcement or Prohibition Notice
- Integrated Pollution Control
- Integrated Pollution Prevention Control
- Local Authority Integrated Pollution Prevention and Control
- Local Authority Pollution Prevention and Control Enforcement
- Pollution Incident to Controlled Waters
- Prosecution Relating to Authorised Processes
- Prosecution Relating to Controlled Waters
- Registered Radioactive Substance
- River Network or Water Feature
- River Quality Sampling Point
- Substantiated Pollution Incident Register
- Water Abstraction
- Water Industry Act Referral

Hazardous Substances

- COMAH Site
- Explosive Site
- NIHHS Site
- Planning Hazardous Substance Consent
- Planning Hazardous Substance Enforcement
- BGS Recorded Mineral Site
- BGS Recorded Landfill Site (Location)
- BGS Recorded Landfill Site
- EA Historic Landfill (Buffered Point)
- EA Historic Landfill (Polygon)
- Integrated Pollution Control Registered Waste Site
- Licensed Waste Management Facility (Landfill Boundary)
- Licensed Waste Management Facility (Location)
- Local Authority Recorded Landfill Site (Location)
- Local Authority Recorded Landfill Site
- Potentially Infilled Land (Non-water)
- Potentially Infilled Land (Non-water)
- Potentially Infilled Land (Water)
- Potentially Infilled Land (Water)
- Potentially Infilled Land (Water)
- Registered Landfill Site
- Registered Landfill Site (Location)
- Registered Landfill Site (Point Buffered to 100m)
- Registered Landfill Site (Point Buffered to 250m)
- Registered Waste Transfer Site (Location)
- Registered Waste Transfer Site
- Registered Waste Treatment or Disposal Site (Location)
- Registered Waste Treatment or Disposal Site

Geological

- BGS Recorded Mineral Site

Site Sensitivity Map - Segment A13

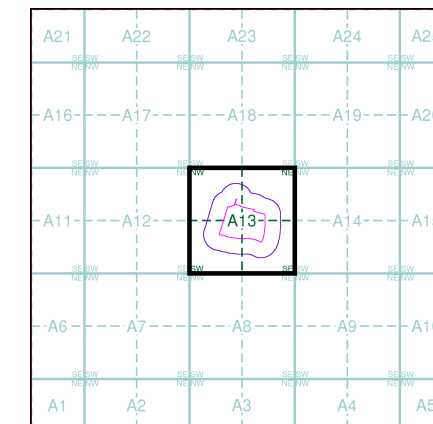

Order Details

Order Number: 321564727_1_1
Customer Ref: GE22017
National Grid Reference: 521320, 113120
Slice: A
Site Area (Ha): 5.13
Plot Buffer (m): 100

Site Details

Land off, Shoreham Road, Small Dole, West Sussex

Landmark
INFORMATION GROUP

Tel: 0844 844 9952
Fax: 0844 844 9951
Web: www.envirocheck.co.uk

Historical Mapping Legends

Ordnance Survey County Series and Ordnance Survey Plan 1:2,500

	Quarry		Gravel Pit		Sand Pit
	Clay Pit		Shingle		Refuse Heap
	Sloping Masonry		Flat Rock		
	Marsh		Reeds		Osiers
	Rough Pasture		Furze		Wood
	Mixed Wood		Brushwood		Orchard
	Fir		Ford		Stepping Stones
	Ferry		Waterfall		Lock
	Trig. Station		Altitude at Trig. Station		
	B.M. 325.9		Bench Mark		Surface Level
	Arrow denotes flow of water		Antiquities (site of)		
	Cutting		Embankment		
	Railway crossing Road		Level Crossing		Road crossing Railway
	Railway crossing River or Canal		Road over single stream		Road over River or Canal
	County Boundary (Geographical)		County & Civil Parish Boundary		Administrative County & Civil Parish Boundary
	County Borough Boundary (England)		County Burgh Boundary (Scotland)		
	Boundary Post or Stone		Police Call Box		
	Bridle Road		Pump		
	Electricity Pylon		Signal Post		
	Foot Bridge		Sluice		
	Foot Path		Spring		
	Guide Post or Board		Telephone Call Box		
	Mile Stone		Trough		
	Mooring Post or Ring		Well		

Ordnance Survey Plan, Additional SIMs and Supply of Unpublished Survey Information 1:2,500 and 1:1,250

	Inactive Quarry, Chalk Pit or Clay Pit		Active Quarry, Chalk Pit or Clay Pit
	Rock		Boulders
	Cliff		Slopes
	Roofed Building		Glazed Roof Building
	Sloping Masonry		Archway
	Non-Coniferous Tree (surveyed)		Coniferous Tree (surveyed)
	Non-Coniferous Trees (not surveyed)		Coniferous Trees (not surveyed)
	Orchard Tree		Scrub
	Coppice, Osier		Reeds
	Rough Grassland		Heath
	Direction of water flow		Bench Mark
	Cave Entrance		Triangulation Station
	Electricity Transmission Line		Antiquity (site of)
	County Boundary (Geographical)		County & Civil Parish Boundary
	County & Civil Parish Boundary		Civil Parish Boundary
	Admin. County or County Bor. Boundary		London Borough Boundary
	Symbol marking point where boundary mereing changes		
	Beer House		Pillar, Pole or Post
	Boundary Post or Stone		Post Office
	Capstan, Crane		Public Convenience
	Chimney		Public House
	Drinking Fountain		Pump
	Electricity Pillar or Post		Signal Box or Bridge
	Fire Alarm Pillar		Signal Post or Light
	Foot Bridge		Spring
	Guide Post		Tank or Track
	Hydrant or Hydraulic		Telephone Call Box
	Level Crossing		Telephone Call Post
	Manhole		Trough
	Mile Post or Mooring Post		Water Point, Water Tap
	Mile Stone		Well
	Normal Tidal Limit		Wind Pump

Large-Scale National Grid Data 1:2,500 and 1:1,250

	Cliff		Slopes
	Rock		Rock (scattered)
	Boulders		Boulders (scattered)
	Positioned Boulder		Scree
	Non-Coniferous Tree (surveyed)		Coniferous Tree (surveyed)
	Non-Coniferous Trees (not surveyed)		Coniferous Trees (not surveyed)
	Orchard Tree		Scrub
	Coppice, Osier		Reeds
	Rough Grassland		Heath
	Direction of water flow		Triangulation Station
	Electricity Transmission Line		Antiquity (site of)
	Bench Mark		Buildings with Building Seed
	Roofed Building		Glazed Roof Building
	Civil parish/community boundary		
	District boundary		
	County boundary		
	Boundary post/stone		
	Boundary mereing symbol (note: these always appear in opposed pairs or groups of three)		
	Barracks		Pillar, Pole or Post
	Battery		Post Office
	Cemetery		Public Convenience
	Chimney		Pump
	Cistern		Pumping Station
	Dismantled Railway		Place of Worship
	Electricity Generating Station		Sewage Pumping Station
	Electricity Pole, Pillar		Signal Box or Bridge
	Electricity Sub Station		Signal Post or Light
	Filter Bed		Spring
	Fountain / Drinking Ftn.		Tank or Track
	Gas Valve Compound		Trough
	Gas Governor		Wind Pump
	Guide Post		Water Point, Water Tap
	Manhole		Works (building or area)
	Mile Post or Mile Stone		Well



Geo-Environmental Historical Mapping & Photography included:

Mapping Type	Scale	Date	Pg
Sussex	1:2,500	1874 - 1878	2
Sussex	1:2,500	1897 - 1898	3
Sussex	1:2,500	1910 - 1912	4
Ordnance Survey Plan	1:2,500	1957 - 1958	5
Ordnance Survey Plan	1:2,500	1970 - 1978	6
Supply of Unpublished Survey Information	1:2,500	1975	7
Supply of Unpublished Survey Information	1:2,500	1976	8
Ordnance Survey Plan	1:2,500	1978 - 1985	9
Ordnance Survey Plan	1:2,500	1985	10
Additional SIMs	1:2,500	1985 - 1990	11
Large-Scale National Grid Data	1:2,500	1994	12
Historical Aerial Photography	1:2,500	1999	13

Historical Map - Segment A13

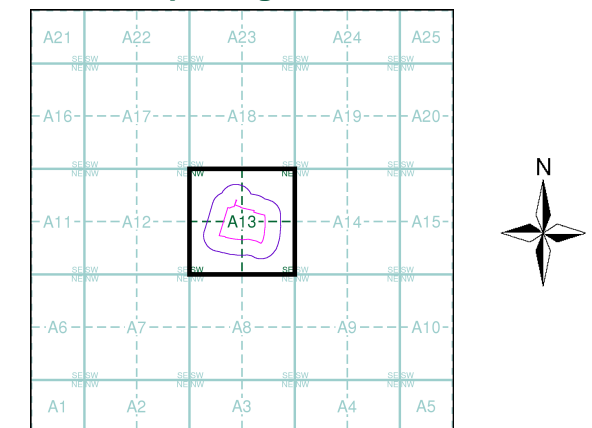

Order Details

Order Number: 321564727_1_1
Customer Ref: GE22017
National Grid Reference: 521320, 113120
Slice: A
Site Area (Ha): 5.13
Search Buffer (m): 100

Site Details

Land off, Shoreham Road, Small Dole, West Sussex

Landmark
INFORMATION GROUP

Tel: 0844 844 9952
Fax: 0844 844 9951
Web: www.envirocheck.co.uk

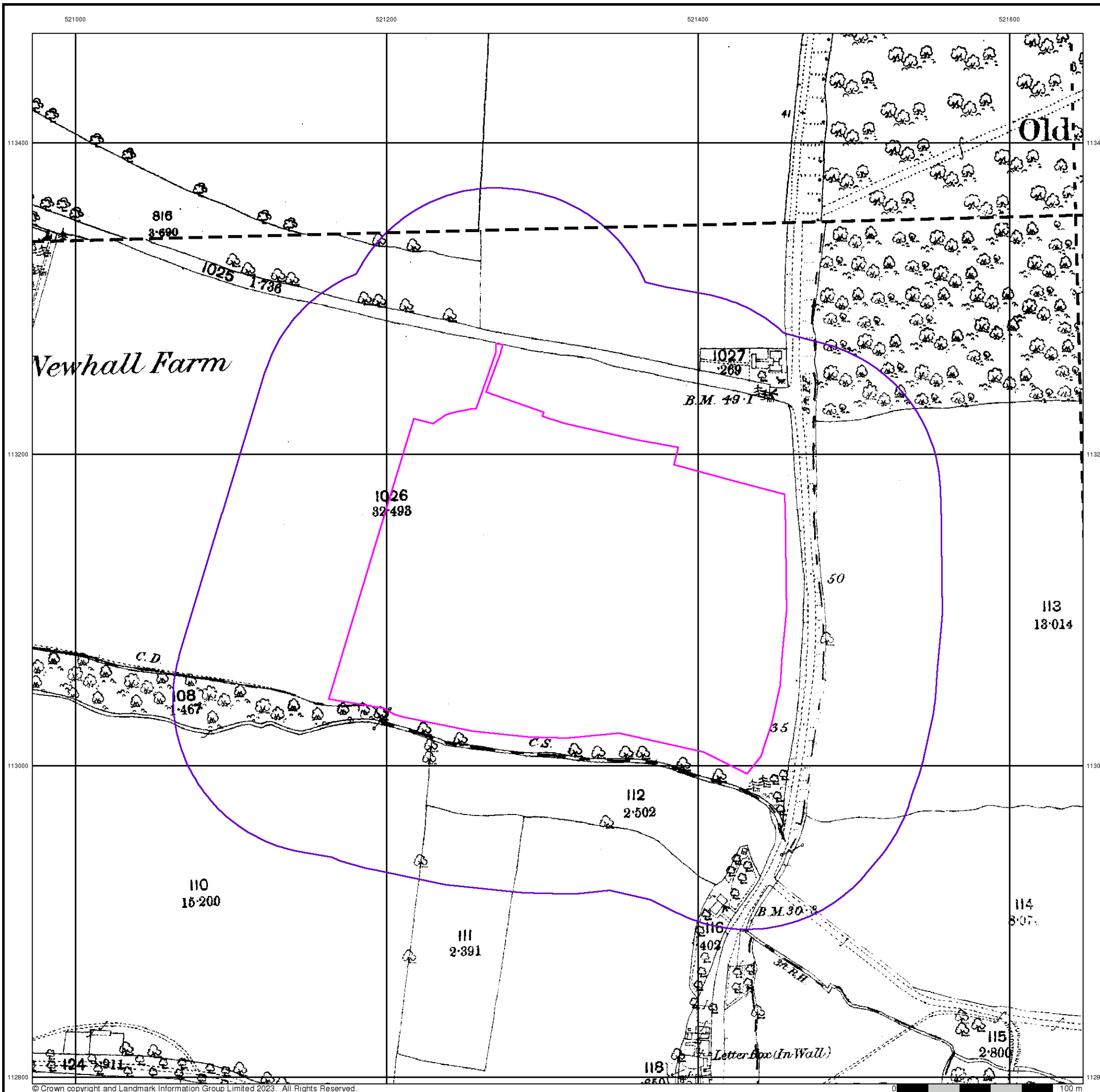

Geo-Environmental Sussex

Published 1874 - 1878

Source map scale - 1:2,500

The historical maps shown were reproduced from maps predominantly held at the scale adopted for England, Wales and Scotland in the 1840's. In 1854 the 1:2,500 scale was adopted for mapping urban areas and by 1896 it covered the whole of what were considered to be the cultivated parts of Great Britain. The published date given below is often some years later than the surveyed date. Before 1938, all OS maps were based on the Cassini Projection, with independent surveys of a single county or group of counties, giving rise to significant inaccuracies in outlying areas.

Map Name(s) and Date(s)

052_01 1878 1:2,500	052_02 1875 1:2,500
052_05 1875 1:2,500	052_06 1874 1:2,500

Historical Map - Segment A13

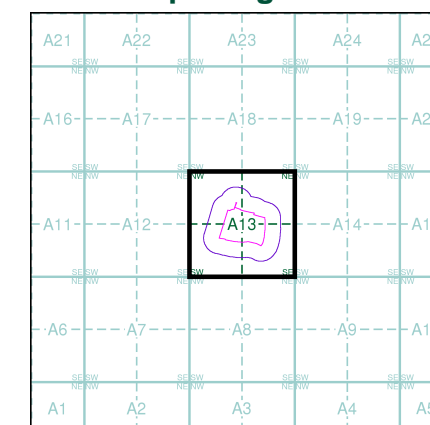

Order Details

Order Number: 321564727_1_1
Customer Ref: GE22017
National Grid Reference: 521320, 113120
Slice: A
Site Area (Ha): 5.13
Search Buffer (m): 100

Site Details

Land off, Shoreham Road, Small Dole, West Sussex

Landmark
INFORMATION GROUP

Tel: 0844 844 9952
Fax: 0844 844 9951
Web: www.envirocheck.co.uk

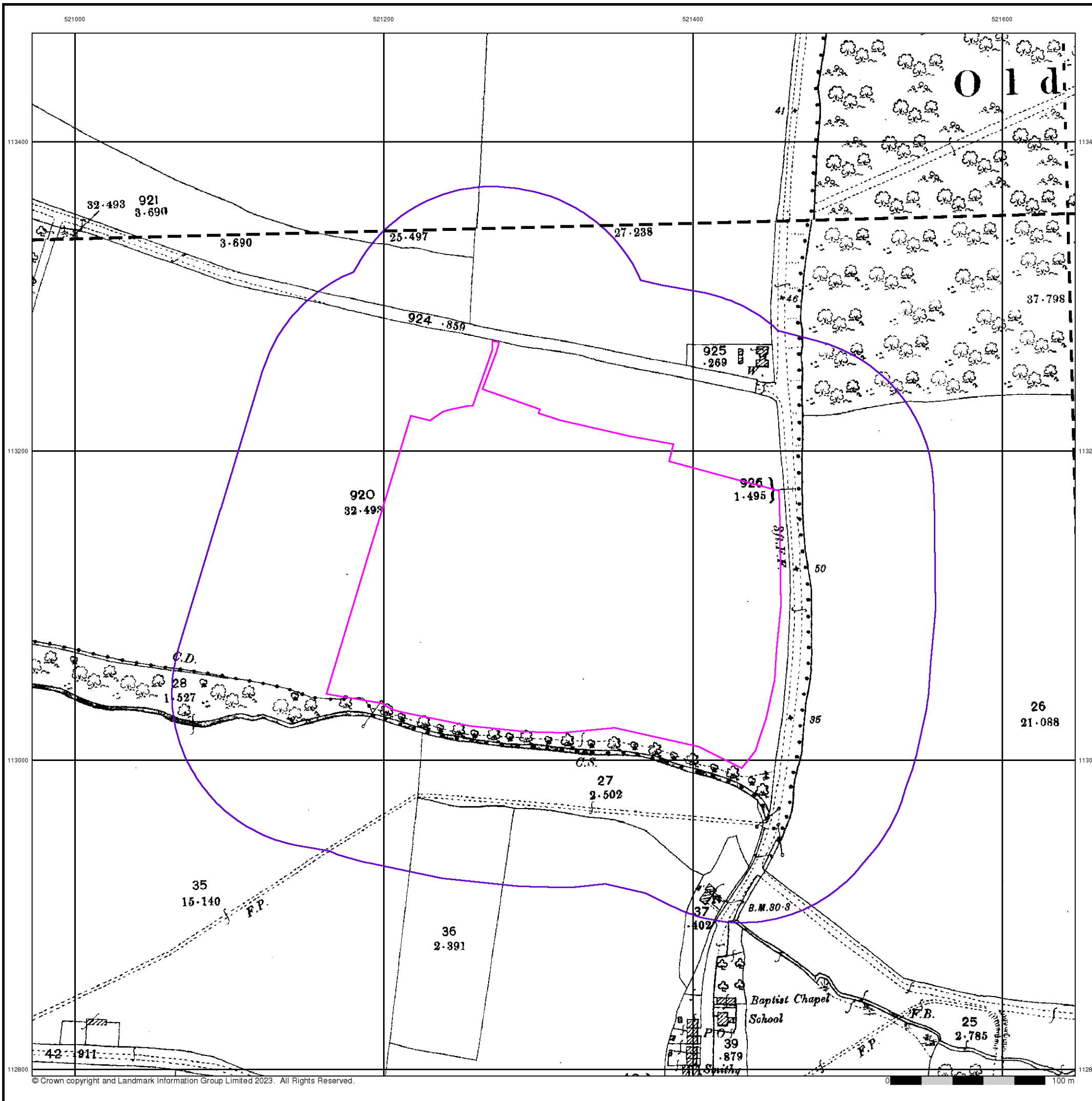

Geo-Environmental Sussex

Published 1897 - 1898

Source map scale - 1:2,500

The historical maps shown were reproduced from maps predominantly held at the scale adopted for England, Wales and Scotland in the 1840's. In 1854 the 1:2,500 scale was adopted for mapping urban areas and by 1896 it covered the whole of what were considered to be the cultivated parts of Great Britain. The published date given below is often some years later than the surveyed date. Before 1938, all OS maps were based on the Cassini Projection, with independent surveys of a single county or group of counties, giving rise to significant inaccuracies in outlying areas.

Map Name(s) and Date(s)

052_01 1898 1:2,500	052_02 1897 1:2,500
052_05 1898 1:2,500	052_06 1898 1:2,500

Historical Map - Segment A13

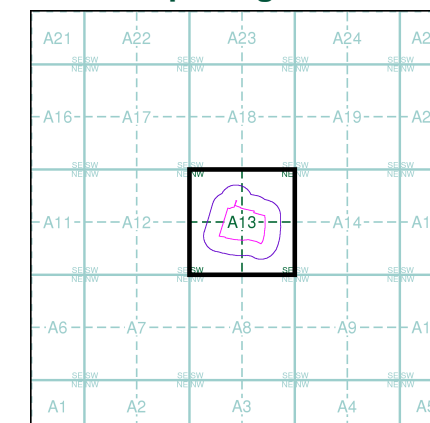

Order Details

Order Number: 321564727_1_1
Customer Ref: GE22017
National Grid Reference: 521320, 113120
Slice: A
Site Area (Ha): 5.13
Search Buffer (m): 100

Site Details

Land off, Shoreham Road, Small Dole, West Sussex

Landmark
INFORMATION GROUP

Tel: 0844 844 9952
Fax: 0844 844 9951
Web: www.envirocheck.co.uk

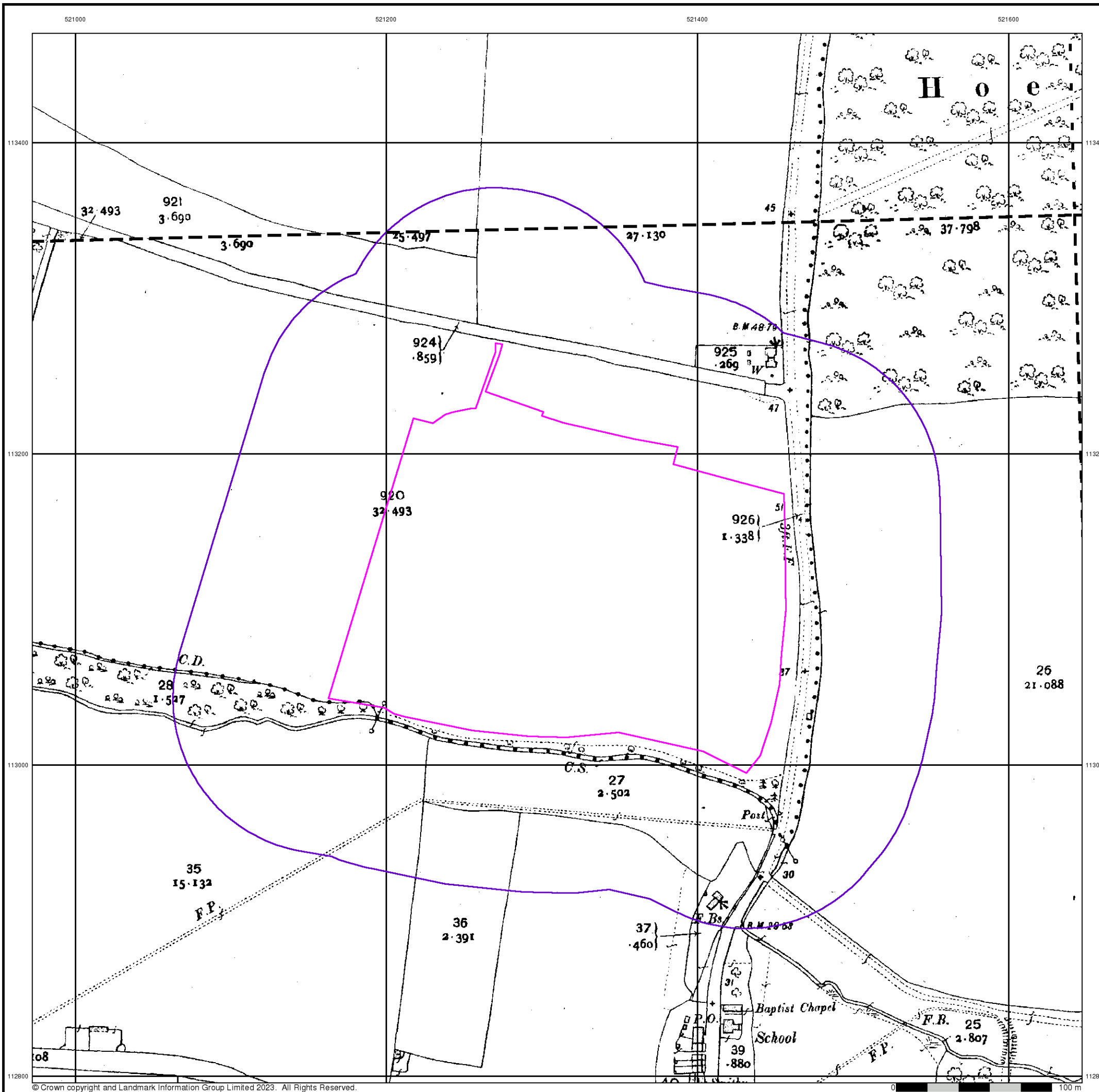

**Geo-Environmental
Sussex**

Published 1910 - 1912

Source map scale - 1:2,500

The historical maps shown were reproduced from maps predominantly held at the scale adopted for England, Wales and Scotland in the 1840's. In 1854 the 1:2,500 scale was adopted for mapping urban areas and by 1896 it covered the whole of what were considered to be the cultivated parts of Great Britain. The published date given below is often some years later than the surveyed date. Before 1938, all OS maps were based on the Cassini Projection, with independent surveys of a single county or group of counties, giving rise to significant inaccuracies in outlying areas.

Map Name(s) and Date(s)

052_01 1912 1:2,500	052_02 1911 1:2,500
052_05 1911 1:2,500	052_06 1910 1:2,500

Historical Map - Segment A13

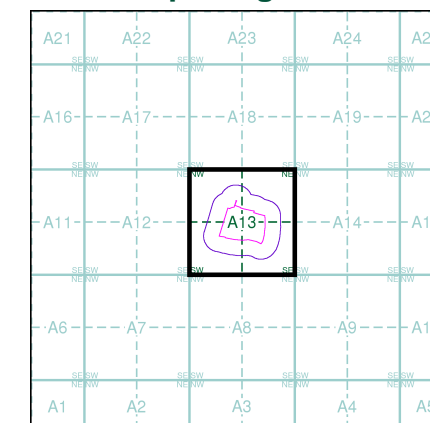

Order Details

Order Number: 321564727_1_1
Customer Ref: GE22017
National Grid Reference: 521320, 113120
Slice: A
Site Area (Ha): 5.13
Search Buffer (m): 100

Site Details

Land off, Shoreham Road, Small Dole, West Sussex

Landmark
INFORMATION GROUP

Tel: 0844 844 9952
Fax: 0844 844 9951
Web: www.envirocheck.co.uk

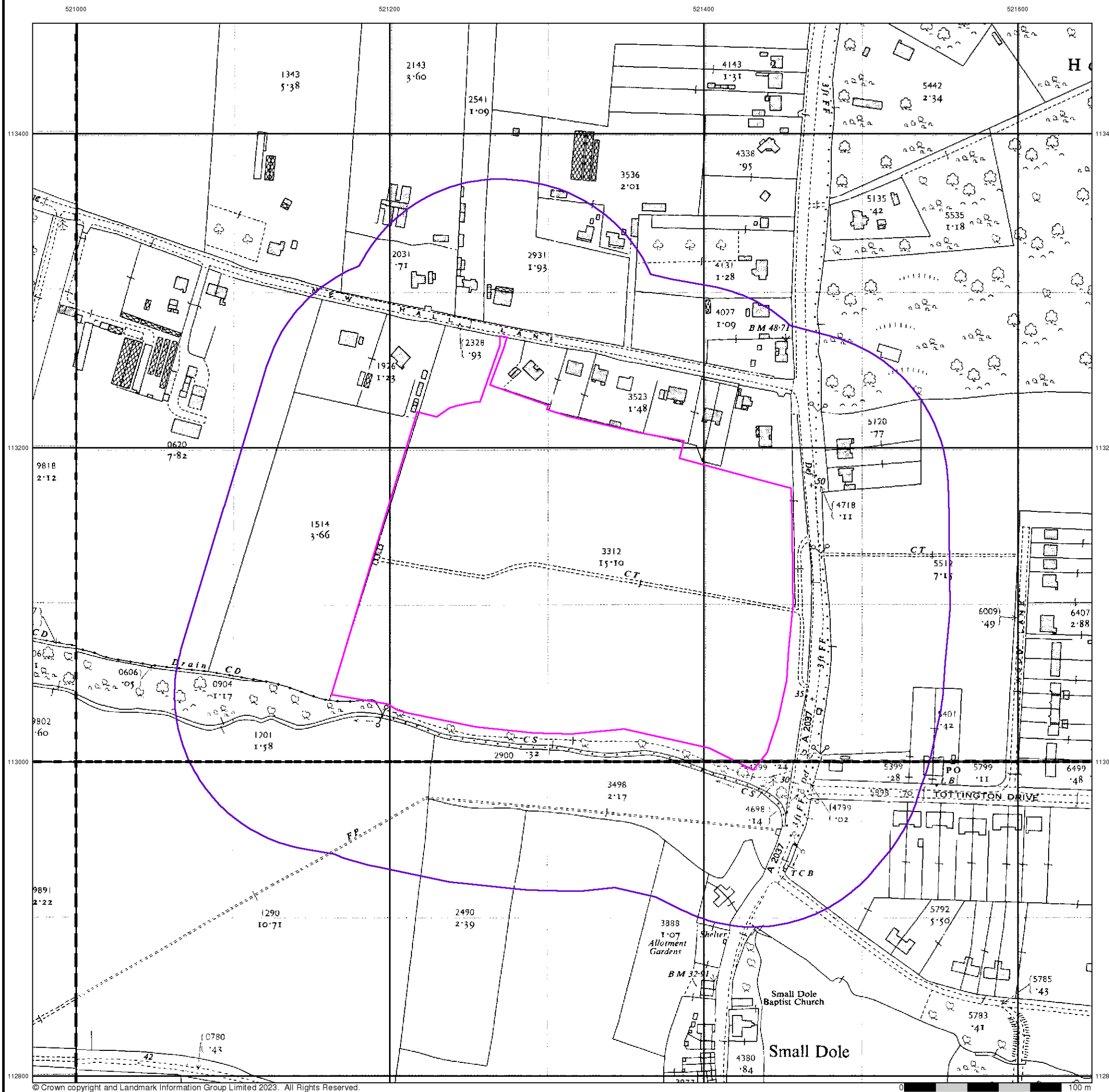

© Crown copyright and Landmark Information Group Limited 2023. All Rights Reserved.



Geo-Environmental Ordnance Survey Plan

Published 1957 - 1958

Source map scale - 1:2,500

The historical maps shown were reproduced from maps predominantly held at the scale adopted for England, Wales and Scotland in the 1840's. In 1854 the 1:2,500 scale was adopted for mapping urban areas and by 1896 it covered the whole of what were considered to be the cultivated parts of Great Britain. The published date given below is often some years later than the surveyed date. Before 1938, all OS maps were based on the Cassini Projection, with independent surveys of a single county or group of counties, giving rise to significant inaccuracies in outlying areas.

Map Name(s) and Date(s)

TQ2013 1957 1:2,500	TQ2113 1958 1:2,500
TQ2012 1957 1:2,500	TQ2112 1957 1:2,500

Historical Map - Segment A13

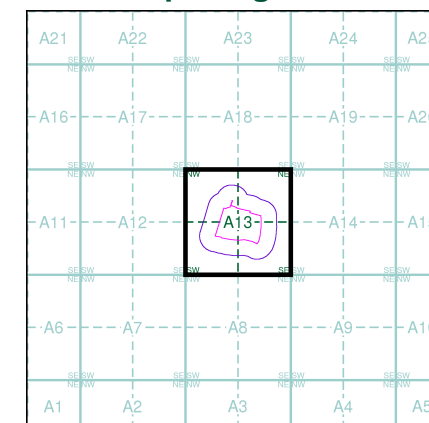

Order Details

Order Number: 321564727_1_1
Customer Ref: GE22017
National Grid Reference: 521320, 113120
Slice: A
Site Area (Ha): 5.13
Search Buffer (m): 100

Site Details

Land off, Shoreham Road, Small Dole, West Sussex

Landmark
INFORMATION GROUP

Tel: 0844 844 9952
Fax: 0844 844 9951
Web: www.envirocheck.co.uk

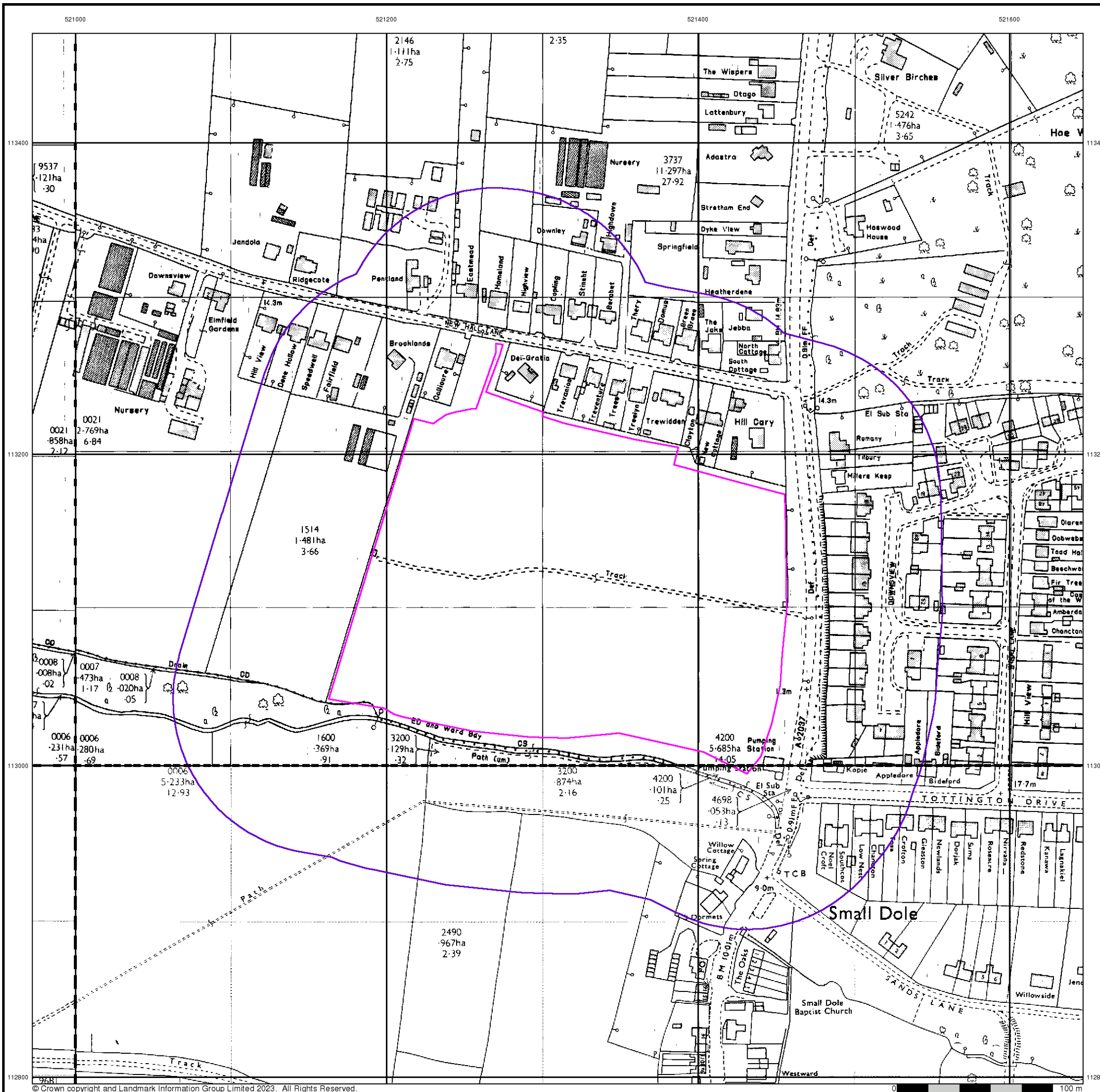

Geo-Environmental Ordnance Survey Plan

Published 1970 - 1978

Source map scale - 1:2,500

The historical maps shown were reproduced from maps predominantly held at the scale adopted for England, Wales and Scotland in the 1840's. In 1854 the 1:2,500 scale was adopted for mapping urban areas and by 1896 it covered the whole of what were considered to be the cultivated parts of Great Britain. The published date given below is often some years later than the surveyed date. Before 1938, all OS maps were based on the Cassini Projection, with independent surveys of a single county or group of counties, giving rise to significant inaccuracies in outlying areas.

Map Name(s) and Date(s)

TQ2013 1978 12,500	TQ2113 1978 12,500
TQ2012 1970 12,500	TQ2112 1970 12,500

Historical Map - Segment A13

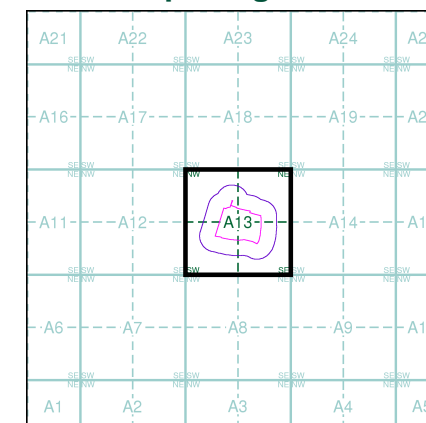

Order Details

Order Number: 321564727_1_1
Customer Ref: GE22017
National Grid Reference: 521320, 113120
Slice: A
Site Area (Ha): 5.13
Search Buffer (m): 100

Site Details

Land off, Shoreham Road, Small Dole, West Sussex

Landmark
INFORMATION GROUP

Tel: 0844 844 9952
Fax: 0844 844 9951
Web: www.envirocheck.co.uk

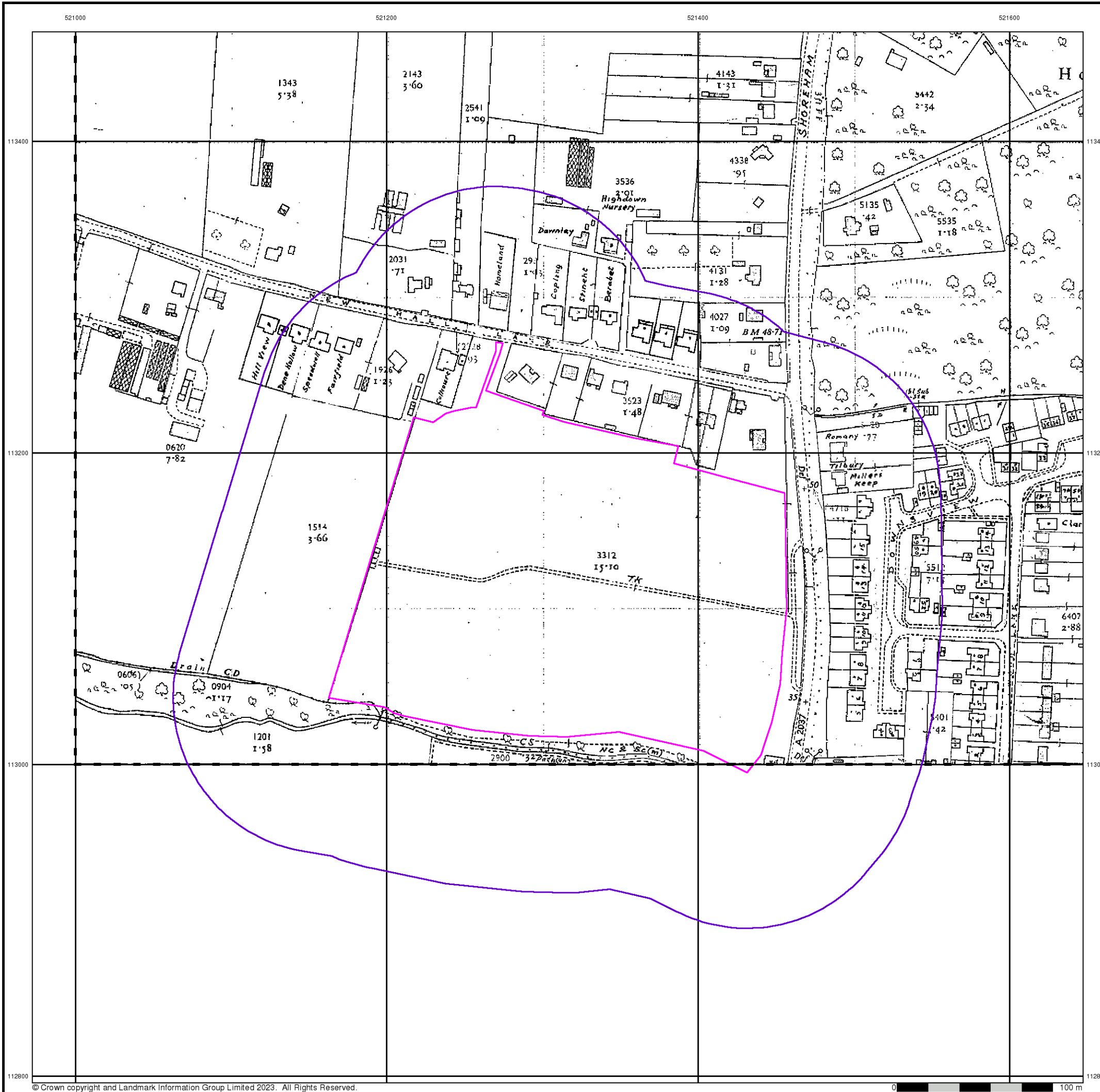

Geo-Environmental Supply of Unpublished Survey Information

Published 1976

Source map scale - 1:2,500

SUSI maps (Supply of Unpublished Survey Information) were produced between 1972 and 1977, mainly for internal use at Ordnance Survey. These were more of a 'work-in-progress' plan as they showed updates of individual areas on a map. These maps were unpublished, and they do not represent a single moment in time. They were produced at both 1:2,500 and 1:1,250 scales.

Map Name(s) and Date(s)

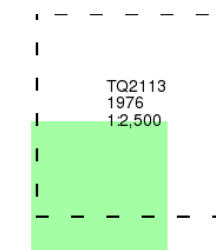

Historical Map - Segment A13

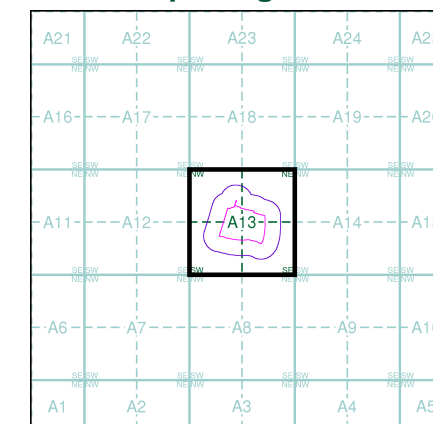

Order Details

Order Number: 321564727_1_1
Customer Ref: GE22017
National Grid Reference: 521320, 113120
Slice: A
Site Area (Ha): 5.13
Search Buffer (m): 100

Site Details

Land off, Shoreham Road, Small Dole, West Sussex

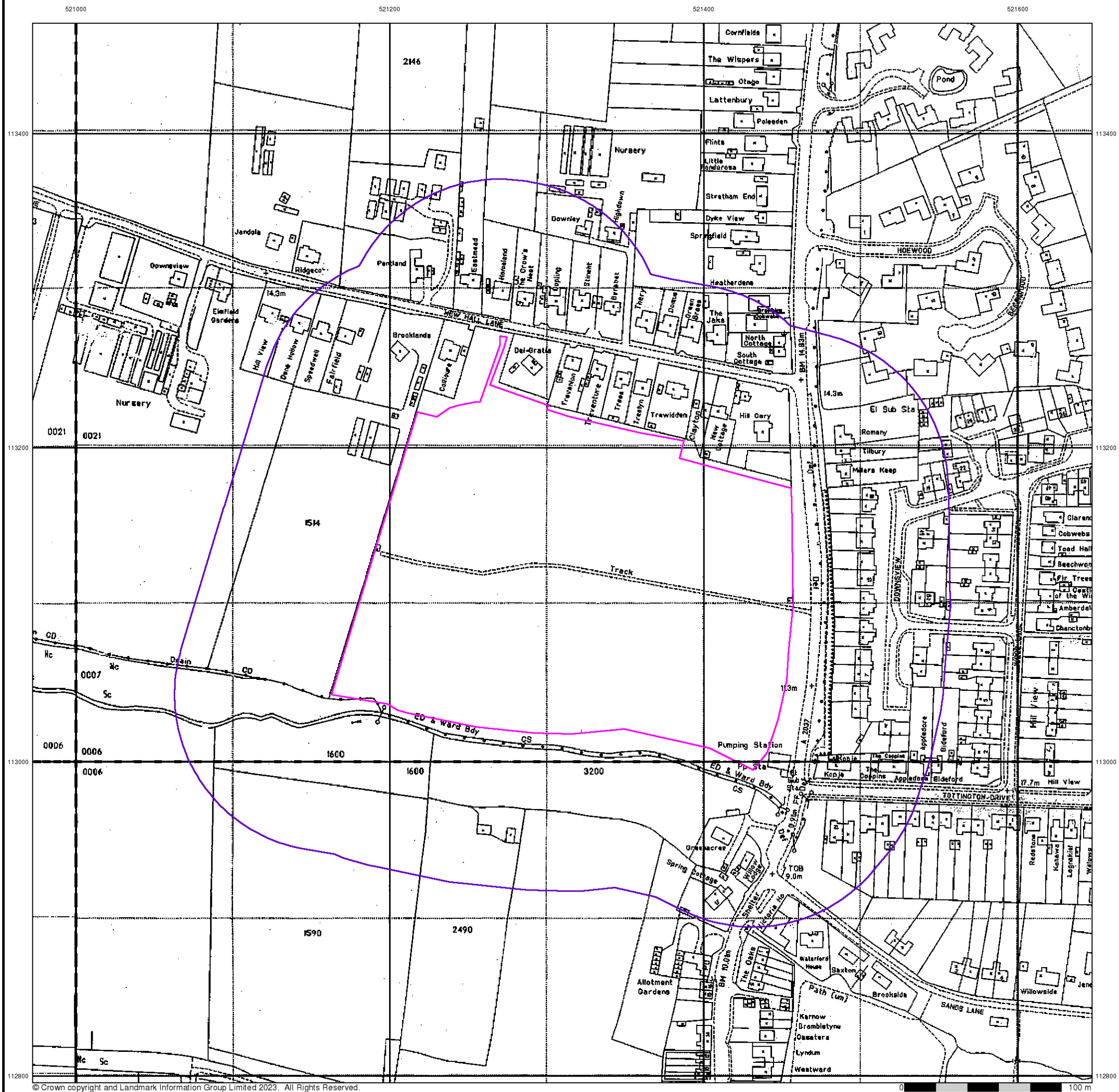

Geo-Environmental
Large-Scale National Grid Data
Published 1994
Source map scale - 1:2,500

'Large Scale National Grid Data' superseded SIM cards (Ordnance Survey's 'Survey of Information on Microfilm') in 1992, and continued to be produced until 1999. These maps were the fore-runners of digital mapping and so provide detailed information on houses and roads, but tend to show less topographic features such as vegetation. These maps were produced at both 1:2,500 and 1:1,250 scales.

Map Name(s) and Date(s)

TQ2013 1994 12,500	TQ2113 1994 12,500
TQ2012 1994 12,500	TQ2112 1994 12,500

Historical Map - Segment A13

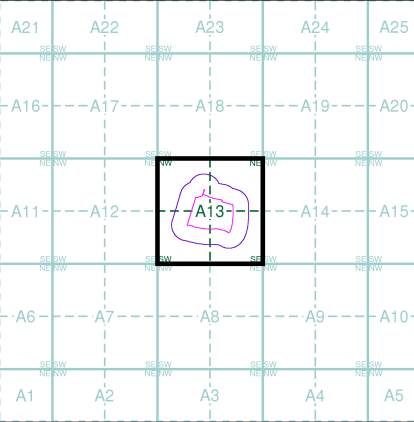

Order Details
Order Number: 321564727_1_1
Customer Ref: GE22017
National Grid Reference: 521320, 113120
Slice: A
Site Area (Ha): 5.13
Search Buffer (m): 100

Site Details
Land off, Shoreham Road, Small Dole, West Sussex

Landmark
INFORMATION GROUP
Tel: 0844 844 9952
Fax: 0844 844 9951
Web: www.envirocheck.co.uk