

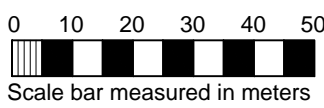

Site Location Plan - As Proposed (1:1250)



Site Location Plan - As Existing (1:1250)



Copyright: All rights have been asserted under the Design, Patents, & Copyright Act 1988. This drawing shall not be reproduced without the prior approval of 3-D Architecture Ltd

Contractor to CHECK all dimensions & report any discrepancies. All works and materials used are to fully comply with ALL standards as required by the relevant Trade Associations, British Standards, Codes of Practice, Manufacturers Specifications (BBA Certification, etc). All works to be carried out fully in accordance with any Engineer's Calculations, Details, & Instructions, as and where applicable.

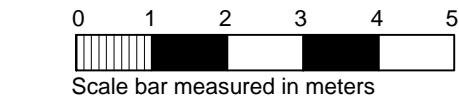

PLANNING

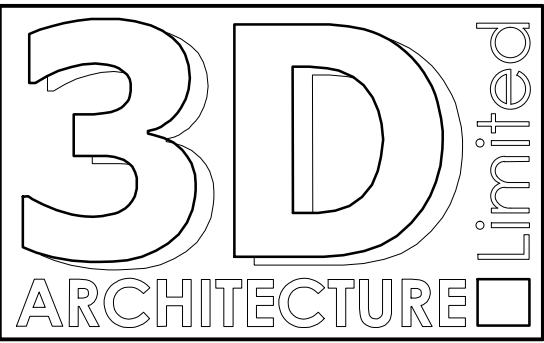

3-D Architecture Limited
15 Horsted Square, Bellbrook Industrial Estate,
Uckfield, East Sussex. TN22 1QG
Tel: 01825 764455 Fax: 01825 764455
Email: info@3d-architecture.co.uk

CLIENT
Lee Goossens

PROJECT
**Stonehouse Farm
Handcross Road, Plummer Plain,
Horsham, West Sussex
RH13 6NZ**

DRAWING TITLE
**Site Location Plans
As Existing & As Proposed**

| SCALE | DATE | DRAWN BY |
|-------------|--------------|----------|
| 1:1250 @ A1 | January 2024 | ANH |
| DRAWING NO. | REVISION | |
| 2024/PL11 | A | |