

5.6 INTERPRETATION

5.6.1 INTERPRETATION WITHIN THE LANDSCAPE PROPOSALS

At present, there are useful and well presented interpretation boards throughout the Gardens, as seen in the below images. When it comes to the history of the Leonardslee House and the Loder Family this is not described in as much detail. As part of our proposals to the front of the House we are integrating new interpretation boards within the landscape scheme to match those already existing within the Gardens, see the adjacent mock up. There will be a general signage review across the Estate to ensure the signage is improving the visitor experience.



Existing interpretation board to the Lakes and Gardens



Existing interpretation board to the Lakes and Gardens



Indicative mock up interpretation board

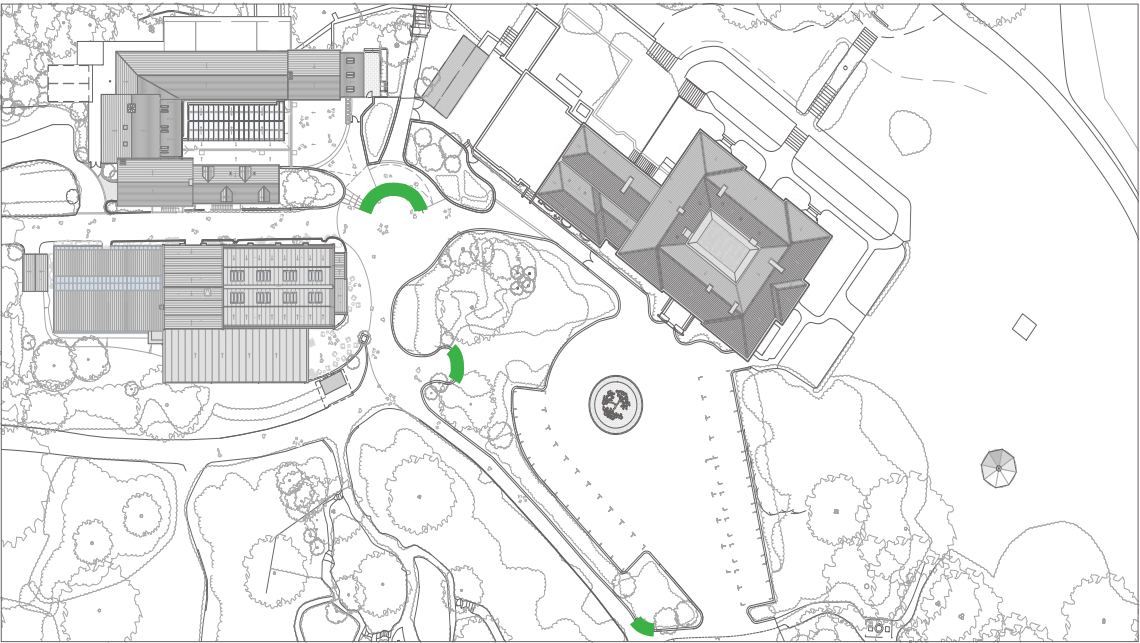

— Location of new interpretation boards



Proposed visual to the front of the Main House with location of interpretation board shown in red box



Interpretation board precedent



Interpretation board precedent



5.7 SUMMARY

5.7.1 SUMMARY

In summary, the proposals for the landscape interventions follow recommendations from the CMP for improving the appearance and planting of the forecourt and car park to Leonardslee House, the interpretation boards to include a detailed history of Leonardslee House, the Loder family, the visitor arrival and the entrance sequence. The proposals allow for an improved visitor experience for those visiting the Lakes and Gardens as well as those staying at the Hotel or visiting Restaurant Interlude.

Whilst there is a functional requirement for cars to remain on the forecourt in front of the House as established in this document, the overall number of spaces have been reduced with spaces relocated to the south to reduce the visual impact on Leonardslee House. Furthermore, deep and raised planters formed of local sussex sandstone have been introduced which will improve the overall setting whilst also screening certain views appropriately.

The proposed arrival sequence will mean visitors will experience views of Leonardslee House as those visiting in the hey-day of the Loder Family would have done, thus retaining and reinstating historic key views. The proposed interpretation boards to the front of the Main House will also help to improve the understanding of the Estate's history and the significant impact the Loder family had in making the Lakes and Gardens what they are today.

The overall proposal will offer a fresh experience and understanding of the Leonardslee Estate whilst enhancing its special historic significance.



Visual of the view from Stable Lane



Key Plan