

The Statutory Biodiversity Metric
Start page



Project details			
Planning authority:	Horsham District Council		
Project name:	Land at Greenacres, Saucelands Lane, Shipley, West Sussex, RH13 8PU		
Applicant:	Chidhurst Ltd		
Application type:	Residential		
Planning application reference:	TBC		
Completed by:	Joseph Baker BSc (Hons) - Director and Hannah Baker MSc Director and Principal Ecologist		
Date of metric completion:	29/04/2025 Rev 1, 16/12/2025 Rev 2		
Reviewer:	Hannah Baker BSc (Hons), MSc, ACIEEM - Director and Principal Ecologist		
Calculation iteration:	2		
Planning authority reviewer:	TBC		
Date of planning authority review:	TBC		
Target % net gain:	10%		
Irreplaceable habitat present at baseline:	No ✓		
Total site area - including irreplaceable habitat area (hectares):	0.78	Irreplaceable habitat site area (hectares):	0.00
Total off-site area - including irreplaceable habitat area (hectares):	N/A	Irreplaceable habitat area off-site (hectares):	N/A

Main menu

Results

View all

Reset view

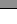
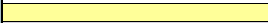
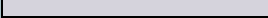
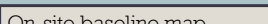
Cell style conventions	
	Attention required
	Input error/rules and principles not met
	Use of this cell is not appropriate
	Enter data
	Automatic lookup
	Result

On-site baseline map

Insert

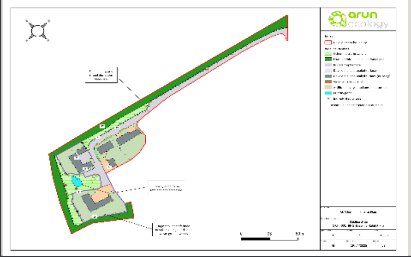

On-site baseline map reference number

II-001_BNG_Baseline Habit

Off-site baseline map

Insert



Off-site baseline map reference number

On-site post intervention map

Insert

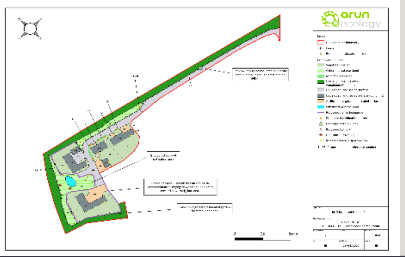

On-site post-intervention map reference number

II_BNG_Proposed Ha

Off-site post intervention map

Insert



Off-site post-intervention reference number

Land at Greenacres, Saucelands Lane, Shipley, W

Headline Results

Scroll down for final results 

Return to
results menu

On-site baseline

Habitat units	4.40
Hedgerow units	0.00
Watercourse units	0.00

On-site post-intervention

(Including habitat retention, creation & enhancement)

Habitat units	4.89
Hedgerow units	0.00
Watercourse units	0.00

On-site net change

(units & percentage)

Habitat units	0.49	11.22%
Hedgerow units	0.00	0.00%
Watercourse units	0.00	0.00%

Off-site baseline

Habitat units	0.00
Hedgerow units	0.00
Watercourse units	0.00

Off-site post-intervention

(Including habitat retention, creation & enhancement)

Habitat units	0.00
Hedgerow units	0.00
Watercourse units	0.00

Off-site net change

(units & percentage)

Habitat units	0.00	0.00%
Hedgerow units	0.00	0.00%
Watercourse units	0.00	0.00%

Combined net unit change

(Including all on-site & off-site habitat retention, creation & enhancement)

Habitat units	0.49
Hedgerow units	0.00
Watercourse units	0.00

Spatial risk multiplier (SRM) deductions

Habitat units	0.00
Hedgerow units	0.00
Watercourse units	0.00

FINAL RESULTS

Total net unit change

(Including all on-site & off-site habitat retention, creation & enhancement)

Habitat units	0.49
Hedgerow units	0.00
Watercourse units	0.00

Total net % change

(Including all on-site & off-site habitat retention, creation & enhancement)

Habitat units	11.22%
Hedgerow units	0.00%
Watercourse units	0.00%

Trading rules satisfied?

Yes 

Unit Type	Target	Baseline Units	Units Required	Unit Deficit
Habitat units	10.00%	4.40	4.84	0.00
Hedgerow units	10.00%	0.00	0.00	0.00
Watercourse units	10.00%	0.00	0.00	0.00

No additional area habitat units required to meet target 

No additional hedgerow units required to meet target 

No additional watercourse units required to meet target 

Trading
summary
watercourse

Very High Distinctiveness Summary

Very High Distinctiveness Units available to other lower distinctiveness deficit	4.00
--	------

High Distinctiveness Summary

High Distinctiveness Units available to offset lower distinctiveness deficit	3.02	✓

Medium Distinctiveness Summary

Medium Distinctiveness Broad Habitat Issues <i>see also: offsite Distinctiveness Issues</i>	0.01	A
--	------	---

Low Distinctiveness Summary	

Low cholesterol levels not change in trials	0.04	7
High cholesterol levels not change in trials	0.00	0

Area habitat summary	
Total Net Unit Change	0.49
Total Net % Change	11.88%
Trading Rules Satisfied	Yes ✓

Existing area habitats				Disturbance		Condition		Strategic significance			Required Action to Meet Targeting Time	Ecological baseline	Comments											
Ref	Broad Habitat	Habitat Type	Irreplaceable habitat	Area (hectares)	Disturbance	Score	Condition	Score	Strategic significance	Strategic significance	Strategic significance multiplier		Total habitat value	Area retained	Area enhanced	Baseline value retained	Baseline value enhanced	Area habitat lost	Value lost	Bespoke compensation agreed for losses of VEMs or Irreplaceable habitat	Other comments	Planning authority comments	Habitat reference number	
1	Grassland	Other neutral grassland	No	0.2476	Medium	4	Poor	1	Area/compensation not in local strategy no local strategy	Low Strategic Significance	1	Area/compensation not in local strategy no local strategy	0.19			0.00	0.00	0.00	0.19				1	
2	Sparsely vegetated land	Field all/Epithemum	No	0.0099	Low	2	Poor	1	Area/compensation not in local strategy no local strategy	Low Strategic Significance	1	Area/compensation not in local strategy no local strategy	0.01			0.00	0.00	0.01	0.01				3	
3	Lulula	Private (priority habitat)	No	0.0066	High	6	Medium	2	Area/compensation not in local strategy no local strategy	Low Strategic Significance	1	Same habitat required +	0.06	0.0066		0.00	0.06	0.06	0.06	Priority pond due to the presence of a European Protected Species (2002 listed pond)			3	
4	Urban	Developed land, sealed surface	No	0.2865	V.Low	0	NA - Other	0	Area/compensation not in local strategy no local strategy	Low Strategic Significance	1	Compensation Not Required	0.00			0.00	0.00	0.28	0.00				4	
5	Urban	Developed land, sealed surface	No	0.0254	V.Low	0	NA - Other	0	Area/compensation not in local strategy no local strategy	Low Strategic Significance	1	Compensation Not Required	0.00			0.00	0.00	0.02	0.00				5	
6	Urban	Developed land, sealed surface	No	0.0069	V.Low	0	NA - Other	0	Area/compensation not in local strategy no local strategy	Low Strategic Significance	1	Compensation Not Required	0.00			0.00	0.00	0.01	0.00				6	
7	Urban	Developed land, sealed surface	No	0.0101	V.Low	0	NA - Other	0	Area/compensation not in local strategy no local strategy	Low Strategic Significance	1	Compensation Not Required	0.00			0.00	0.00	0.01	0.00				7	
8	Urban	Developed land, sealed surface	No	0.0066	V.Low	0	NA - Other	0	Area/compensation not in local strategy no local strategy	Low Strategic Significance	1	Compensation Not Required	0.00			0.00	0.00	0.01	0.00				8	
9	Urban	Developed land, sealed surface	No	0.0096	V.Low	0	NA - Other	0	Area/compensation not in local strategy no local strategy	Low Strategic Significance	1	Compensation Not Required	0.00			0.00	0.00	0.01	0.00				9	
10	Urban	Developed land, sealed surface	No	0.0106	V.Low	0	NA - Other	0	Area/compensation not in local strategy no local strategy	Low Strategic Significance	1	Compensation Not Required	0.00			0.00	0.00	0.01	0.00				10	
11	Urban	Artificial unvegetated, unsealed surface	No	0.1165	V.Low	0	NA - Other	0	Area/compensation not in local strategy no local strategy	Low Strategic Significance	1	Compensation Not Required	0.00			0.00	0.00	0.11	0.00				11	
12	Woodland and forest	Lowland mixed deciduous woodland	No	0.2262	High	6	Medium	2	Location ecologically desirable but not in local strategy	Medium Strategic Significance	1.1	Same habitat required +	0.01	0.2262		0.01	0.00	0.00	0.00				12	
13	Individual trees	Rural tree	No	0.0163	Medium	4	Good	3	Area/compensation not in local strategy no local strategy	Low Strategic Significance	1	Area/compensation not in local strategy no local strategy	0.05	0.0163		0.00	0.00	0.00	0.00				13	
14	Individual trees	Rural tree	No	0.0163	Medium	4	Good	3	Area/compensation not in local strategy no local strategy	Low Strategic Significance	1	Area/compensation not in local strategy no local strategy	0.20	0.0163		0.20	0.00	0.00	0.00				14	
15	Individual trees	Rural tree	No	0.0365	Medium	4	Good	3	Area/compensation not in local strategy no local strategy	Low Strategic Significance	1	Area/compensation not in local strategy no local strategy	0.44	0.0365		0.44	0.00	0.00	0.00				15	
16	Individual trees	Rural tree	No	0.0163	Medium	4	Good	3	Area/compensation not in local strategy no local strategy	Low Strategic Significance	1	Area/compensation not in local strategy no local strategy	0.20	0.0163		0.20	0.00	0.00	0.00				16	
17	Individual trees	Rural tree	No	0.0361	Medium	4	Good	3	Area/compensation not in local strategy no local strategy	Low Strategic Significance	1	Area/compensation not in local strategy no local strategy	0.08			0.00	0.00	0.00	0.00				17	
18	Urban	Vacant or derelict land	No	0.0135	Low	2	Poor	1	Area/compensation not in local strategy no local strategy	Low Strategic Significance	1	Same disturbance not in local strategy	0.03			0.00	0.00	0.01	0.03				18	
19																								
20																								
													0.01	0.01	0.00	0.00	0.00	0.00						
													Total area lost (including area of individual trees, green walls, interstitial land structures)					0.03						
MP to facilitate conversion tool:				Retain a unit		Reallocate		MP																

Area, Baulcombe Lane, Shirley, West Sussex, BN18 8PU Map Reference: C-CH1-00
A-2 Co-Site Habitat Creation

Condense / Show Columns

Condense / Show Rows

Main Menu

Area habitat summary	
Total Net Gain Change	0.48
Total Net % Change	11.88%
Trading Rules Met	Yes ✓
Area Check	Area Acceptable ✓

Ref	Broad Habitat	Proposed habitat	Area (hectares)	Disturbances		Condition		Post intervention habitat						Temporal multiplier				Difficulty multiplier				Comments		
				Disturbances	Score	Condition	Score	Strategic significance		Strategic significance multiplier	Standard time to target condition (years)	Habitat created in advance (years)	Delay in starting habitat creation (years)	Standard or adjusted time to target condition	Final time to target condition (years)	Final time to target multiplier	Standard difficulty of creation	Applied difficulty multiplier	Final difficulty of creation	Difficulty multiplier applied	Habitat units delivered	User comments	Planning authority comments	Habitat reference number
								Strategic significance	Strategic significance															
1	Urban	Vegetated garden	0.038	Low	2	Condition Assessment N/A	1	Area/compensation not in local strategy/ no local strategy	Low Strategic Significance	1	1	0	0	Standard time to target condition applied	1	0.865	Low	Standard difficulty applied	Low	1	0.07			1
2	Urban	Vegetated garden	0.028	Low	2	Condition Assessment N/A	1	Area/compensation not in local strategy/ no local strategy	Low Strategic Significance	1	1	0	0	Standard time to target condition applied	1	0.865	Low	Standard difficulty applied	Low	1	0.05			2
3	Urban	Vegetated garden	0.0573	Low	2	Condition Assessment N/A	1	Area/compensation not in local strategy/ no local strategy	Low Strategic Significance	1	1	0	0	Standard time to target condition applied	1	0.865	Low	Standard difficulty applied	Low	1	0.13			3
4	Urban	Vegetated garden	0.035	Low	2	Condition Assessment N/A	1	Area/compensation not in local strategy/ no local strategy	Low Strategic Significance	1	1	0	0	Standard time to target condition applied	1	0.865	Low	Standard difficulty applied	Low	1	0.07			4
5	Urban	Vegetated garden	0.0036	Low	2	Condition Assessment N/A	1	Area/compensation not in local strategy/ no local strategy	Low Strategic Significance	1	1	0	0	Standard time to target condition applied	1	0.865	Low	Standard difficulty applied	Low	1	0.01			5
6	Urban	Vegetated garden	0.0033	Low	2	Condition Assessment N/A	1	Area/compensation not in local strategy/ no local strategy	Low Strategic Significance	1	1	0	0	Standard time to target condition applied	1	0.865	Low	Standard difficulty applied	Low	1	0.01			6
7	Urban	Artificial unvegetated, sealed surface	0.009	V Low	0	N/A - Other	0	Area/compensation not in local strategy/ no local strategy	Low Strategic Significance	1	0	0	0	Standard time to target condition applied	0	1.000	Low	Standard difficulty applied	Low	1	0.00			7
8	Urban	Artificial unvegetated, sealed surface	0.0044	V Low	0	N/A - Other	0	Area/compensation not in local strategy/ no local strategy	Low Strategic Significance	1	0	0	0	Standard time to target condition applied	0	1.000	Low	Standard difficulty applied	Low	1	0.00			8
9	Urban	Artificial unvegetated, sealed surface	0.0027	V Low	0	N/A - Other	0	Area/compensation not in local strategy/ no local strategy	Low Strategic Significance	1	0	0	0	Standard time to target condition applied	0	1.000	Low	Standard difficulty applied	Low	1	0.00			9
10	Urban	Vegetated garden	0.0023	Low	2	Condition Assessment N/A	1	Area/compensation not in local strategy/ no local strategy	Low Strategic Significance	1	1	0	0	Standard time to target condition applied	1	0.865	Low	Standard difficulty applied	Low	1	0.00			10
11	Urban	Artificial unvegetated, sealed surface	0.0038	V Low	0	N/A - Other	0	Area/compensation not in local strategy/ no local strategy	Low Strategic Significance	1	0	0	0	Standard time to target condition applied	0	1.000	Low	Standard difficulty applied	Low	1	0.00			11
12	Grassland	Other natural grassland	0.0472	Medium	4	Moderate	2	Area/compensation not in local strategy/ no local strategy	Low Strategic Significance	1	0	0	0	Standard time to target condition applied	0	0.807	Low	Standard difficulty applied	Low	1	0.24			12
13	Grassland	Moderate grassland	0.0186	Low	2	Poor	1	Area/compensation not in local strategy/ no local strategy	Low Strategic Significance	1	1	0	0	Standard time to target condition applied	1	0.865	Low	Standard difficulty applied	Low	1	0.04			13
14	Grassland	Moderate grassland	0.006	Low	2	Poor	1	Area/compensation not in local strategy/ no local strategy	Low Strategic Significance	1	1	0	0	Standard time to target condition applied	1	0.865	Low	Standard difficulty applied	Low	1	0.01			14
15	Grassland	Moderate grassland	0.0036	Low	2	Poor	1	Area/compensation not in local strategy/ no local strategy	Low Strategic Significance	1	1	0	0	Standard time to target condition applied	1	0.865	Low	Standard difficulty applied	Low	1	0.00			15
16	Grassland	Moderate grassland	0.0017	Low	2	Poor	1	Area/compensation not in local strategy/ no local strategy	Low Strategic Significance	1	1	0	0	Standard time to target condition applied	1	0.865	Low	Standard difficulty applied	Low	1	0.00			16
17	Grassland	Moderate grassland	0.0023	Low	2	Poor	1	Area/compensation not in local strategy/ no local strategy	Low Strategic Significance	1	1	0	0	Standard time to target condition applied	1	0.865	Low	Standard difficulty applied	Low	1	0.00			17
18	Urban	Artificial unvegetated, sealed surface	0.0103	V Low	0	N/A - Other	0	Area/compensation not in local strategy/ no local strategy	Low Strategic Significance	1	0	0	0	Standard time to target condition applied	0	1.000	Low	Standard difficulty applied	Low	1	0.00			18
19	Urban	Developed land, sealed surface	0.0041	V Low	0	N/A - Other	0	Area/compensation not in local strategy/ no local strategy	Low Strategic Significance	1	0	0	0	Standard time to target condition applied	0	1.000	Low	Standard difficulty applied	Low	1	0.00			19
20	Urban	Developed land, sealed surface	0.0080	V Low	0	N/A - Other	0	Area/compensation not in local strategy/ no local strategy	Low Strategic Significance	1	0	0	0	Standard time to target condition applied	0	1.000	Low	Standard difficulty applied	Low	1	0.00			20
21	Urban	Developed land, sealed surface	0.0102	V Low	0	N/A - Other	0	Area/compensation not in local strategy/ no local strategy	Low Strategic Significance	1	0	0	0	Standard time to target condition applied	0	1.000	Low	Standard difficulty applied	Low	1	0.00			21
22	Urban	Developed land, sealed surface	0.0038	V Low	0	N/A - Other	0	Area/compensation not in local strategy/ no local strategy	Low Strategic Significance	1	0	0	0	Standard time to target condition applied	0	1.000	Low	Standard difficulty applied	Low	1	0.00			22
23	Urban	Developed land, sealed surface	0.0046	V Low	0	N/A - Other	0	Area/compensation not in local strategy/ no local strategy	Low Strategic Significance	1	0	0	0	Standard time to target condition applied	0	1.000	Low	Standard difficulty applied	Low	1	0.00			23
24	Urban	Developed land, sealed surface	0.0179	V Low	0	N/A - Other	0	Area/compensation not in local strategy/ no local strategy	Low Strategic Significance	1	0	0	0	Standard time to target condition applied	0	1.000	Low	Standard difficulty applied	Low	1	0.00			24
25	Urban	Developed land, sealed surface	0.0014	V Low	0	N/A - Other	0	Area/compensation not in local strategy/ no local strategy	Low Strategic Significance	1	0	0	0	Standard time to target condition applied	0	1.000	Low	Standard difficulty applied	Low	1	0.00			25
26	Urban	Developed land, sealed surface	0.0148	V Low	0	N/A - Other	0	Area/compensation not in local strategy/ no local strategy	Low Strategic Significance	1	0	0	0	Standard time to target condition applied	0	1.000	Low	Standard difficulty applied	Low	1	0.00			26
27	Urban	Artificial unvegetated, sealed surface	0.0001	V Low	0	N/A - Other	0	Area/compensation not in local strategy/ no local strategy	Low Strategic Significance	1	0	0	0	Standard time to target condition applied	0	1.000	Low	Standard difficulty applied	Low	1	0.00			27
28	Urban	Artificial unvegetated, sealed surface	0.0082	V Low	0	N/A - Other	0	Area/compensation not in local strategy/ no local strategy	Low Strategic Significance	1	0	0	0	Standard time to target condition applied	0	1.000	Low	Standard difficulty applied	Low	1	0.00			28
29	Urban	Artificial unvegetated, sealed surface	0.0007	V Low	0	N/A - Other	0	Area/compensation not in local strategy/ no local strategy	Low Strategic Significance	1	0	0	0	Standard time to target condition applied	0	1.000	Low	Standard difficulty applied	Low	1	0.00			29
30	Urban	Artificial unvegetated, sealed surface	0.0041	V Low	0	N/A - Other	0	Area/compensation not in local strategy/ no local strategy	Low Strategic Significance	1	0	0	0	Standard time to target condition applied	0	1.000	Low	Standard difficulty applied	Low	1	0.00			30
31	Urban	Artificial unvegetated, sealed surface	0.0004	V Low	0	N/A - Other	0	Area/compensation not in local strategy/ no local strategy	Low Strategic Significance	1	0	0	0	Standard time to target condition applied	0	1.000	Low	Standard difficulty applied	Low	1	0.00			31
32	Urban	Artificial unvegetated, sealed surface	0.0014	V Low	0	N/A - Other	0	Area/compensation not in local strategy/ no local strategy	Low Strategic Significance	1	0	0	0	Standard time to target condition applied	0	1.000	Low	Standard difficulty applied	Low	1	0.00			32
33	Individual trees	Small tree	0.0041	Medium	4	Moderate	2	Area/compensation not in local strategy/ no local strategy	Low Strategic Significance	1	27	0	0	Standard time to target condition applied	27	0.382	Low	Standard difficulty applied	Low	1	0.01			33
34	Individual trees	Small tree	0.0041	Medium	4	Moderate	2	Area/compensation not in local strategy/ no local strategy	Low Strategic Significance	1	27	0	0	Standard time to target condition applied	27	0.382	Low	Standard difficulty applied	Low	1	0.01			34
35	Individual trees	Small tree	0.0041	Medium	4	Moderate	2	Area/compensation not in local strategy/ no local strategy	Low Strategic Significance	1	27	0	0	Standard time to target condition applied	27	0.382	Low	Standard difficulty applied	Low	1	0.01			35
36																								36
37																								37
38																								38
39																								39
40																								40
41																								41
42																								42
43																								43
44																								44
45																								45
46																								46
47																								47
48																								48
49																								49
50																								50
Total habitat area			0.88															Total Data		0.18				

Site Area (including area of individual trees, green walls, intertidal hard structures) 0.88

MP to landscape connection tool Subject & URL Structure MP

Training Index Submitted	Yes /
--------------------------	-------

Total labour cost	0.00	0.00
-------------------	------	------