



KEY	
<b>25 Affordable Dwellings (33.8%)</b>	
	<b>Affordable Rent - 19 dwellings</b>
	6no. 1-Bedroom Flat
	2no. 1-Bedroom Flat M4(3)
	4no. 2-Bedroom Flat
	<b>Shared Ownership - 6 dwellings</b>
	2no. 1-Bedroom Flats
	2no. 2-Bedroom Dwellings
	2no. 3-Bedroom Townhouse
	<b>49 Open Market Dwellings (66.2%)</b>
	2no. 1-Bedroom Flat
	2no. 1-Bedroom Flat M4(3)
	4no. 2-Bedroom Flat
	8no. 2-Bedroom Dwellings
	20no. 3-Bedroom Dwellings
	13no. 4-Bedroom Dwellings



E	24.02.26	Schedule updated	KE	AK
D	18.02.26	Shared Ownership / Affordable Rent split adjusted	KE	AK
C	13.02.26	Shared Ownership / Affordable Rent split adjusted	KE	AK
B	16.12.25	Updated Key	CV	KE
A	26.11.25	Updated Landscape	CV	KE
Rev	Date	Revision Details	Dr	Cn

**ECE Architecture**  
www.ecearchitecture.com

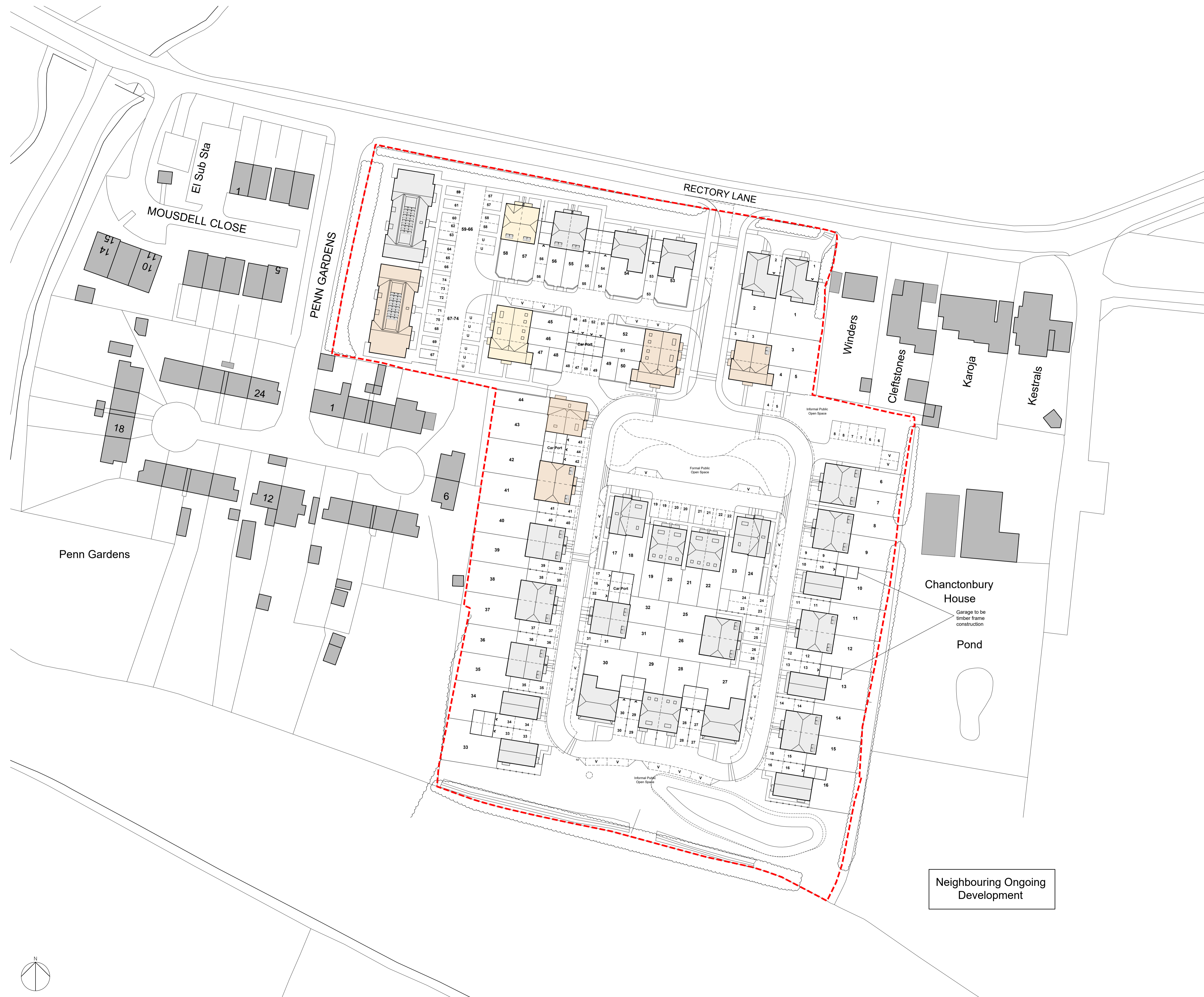
**London:** 76 Great Suffolk Street, London, SE1 0BL  
T 0207 928 2773 E london@ecearchitecture.com

**Sussex:** 64 - 68 Brighton Road, Worthing, West Sussex, BN11 2EN  
T 01903 248777 E sussex@ecearchitecture.com

**Bristol:** Westworks, Beacon Tower, Colston Street, Bristol, BS1 4XE  
T 0117 214 1101 E bristol@ecewestworks.com

Client's Name  
**Rocco Homes**

Job Title  
**Land East of Penn Gardens, Ashington, West Sussex**

Drawing Title  
**Tenure Plan**

Scale  
**1:500 @ A1 / 1:1000 @ A3**



Drawn	Checked	Date
CV	KE	07.08.25

Job No	Drawing No	Rev
7578	PL-15	E

Status  
**APPROVAL**

