

APPENDIX 15.1: ANNUAL AVERAGE DAILY TRAFFIC (AADT) AND ANNUAL AVERAGE WEEKDAY TRAFFIC (AAWT) METHODOLOGY TECHNICAL NOTE

To Homes England

From Steer

Date 11 June 2025

Project West of Ifield

Project No. 23747305

Introduction

1. This Transport Technical Note (TTN) sets out the methodology used to calculate 24 Hour Annual Average Daily Traffic (AADT) and 18 and 6 Hour Annual Average Weekday Traffic (AAWT) flows. These have been produced to support an outline planning application for the Proposed Development at West of Ifield (Wol), Crawley (the Site) and a detailed planning application for the site accesses.
2. The effects of the development on the surrounding highway network has been assessed for the weekday morning and evening peak hours for the baseline, opening and future scenarios. The assessment scenarios are as follows:
 - 2025 Baseline scenario;
 - 2029 Opening Year (without development, no Crawley Western Multi-Modal Corridor, CWMMC) + committed developments (as modelled within the CTM);
 - 2029 Opening Year (first phase development, with CWMMC) + committed developments (as modelled within the CTM);
 - 2041 Future Year (without development, no CWMMC) + committed developments (as modelled within the CTM plus GAL DCO growth); and
 - 2041 Future Year (full development, with CWMMC) + committed developments (as modelled within the CTM plus GAL DCO growth).
3. A summary is provided below of how the base 2015 and 2035 traffic data has been analysed and converted into AADT and AAWT flows for the different year scenarios.
4. This TTN is structured into the following sections:
 - Local Plan Modelling;
 - Committed Developments;
 - 2015 Baseline Traffic Data;
 - 2025 Baseline Traffic Data;
 - Opening Year 2029 (Without Development, No CWMMC) + Committed Development
 - Opening Year 2029 (Without Development, With CWMMC) + Committed Development
 - Opening Year 2029 (With First Phase Development, With CWMMC) + Committed Development
 - Future Year 2041 (Without Development, No CWMMC) + Committed Development
 - Future Year 2041 (Without Development, With CWMMC) + Committed Development
 - Future Year 2041 (With Full Completed Development, With CWMMC) + Committed Development

Local Plan Modelling

5. The Crawley Town Model (CTM), developed by Stantec supports both the HDC and CBC Local Plan review processes, the Crawley Transport Study (May 2021) and Horsham Transport Study (May 2021) respectively, has been used to undertake strategic modelling of the area.
6. This work provides an update to each respective strategic model and includes new committed developments, site allocations, neighbouring authority growth projections and proposed highway schemes

as agreed with WSCC. The West of Ifield development is considered in both transport studies 'Local Plan' scenarios.

7. Following the agreement with local authorities on the transport strategy, trip rates and accompanying travel plan for Wol which provides a comprehensive set of sustainable measures to reduce car-based travel, the modelling undertaken and presented within this ES Chapter to test the impact of the West of Ifield development has been undertaken using the mode shares presented in Chapter 8 of the Transport Assessment (i.e. Local Plan growth without West of Ifield as previously modelled by WSCC, but with our agreed West of Ifield trip generation added).
8. No reductions in background traffic have been applied as a result of the enhanced bus provision that Wol will provide within the local area (i.e. to existing results beyond Wol), nor additional traffic reduction through wider sustainable transport measures within the Crawley area. However, considering the timing of the development, current trends for travel reductions supported by enhanced technology and accelerated by COVID-19, significant change is likely to occur over the development period. This is also supported by the shared objectives of HDC, CBC, WSCC and Transport for the South East (TfSE) in reducing travel demand and private car trips over time. The Crawley Transport Strategy acknowledges that "On average, over the last 20 years people are travelling less and making fewer trips, commuter trips are down by a 5th". We therefore present the modelling as an absolute worst-case scenario in terms of highway impact.

Committed Developments

9. The traffic flows of the committed development sites have been considered as part of this assessment. The Crawley Town Model includes within the Base a comprehensive assessment of cumulative schemes. These are provided in Appendix G of the Transport Assessment.
10. In addition, Gatwick Airport Limited (GAL) are in the process of making a Development Consent Order (DCO) application for use of the emergency (second) northern runway for general use. This is proposed to be open in 2029 and ramp up in terms of usage towards 2047. Up until the second runway is operational, GAL have provided Business as Usual (BAU) demand, however the CTM already assumes a higher proportion of vehicle movements than GAL so we have used the modelled flows in the CTM for 2029 to represent worst case.
11. GAL propose additional sustainable transport measures particularly for staff, however the growth in passenger numbers expected will generate additional highway demand. To facilitate this, GAL propose highway mitigation in terms of significant improvements to the North and South terminal access junctions and Longbridge roundabout. The designs for this 'Northern Runway Project highway scheme' are provided in Appendix xx and have been coded into the model for the 2041 scenarios as they will be operational from 2032.
12. Although GAL have their own assignment model which assigns a significant volume of traffic towards the M23, we have used the assignment as modelled within the CTM to provide a robust assessment for the area to the west of Gatwick Airport.
13. For clarity and as set out in the Gatwick Modelling Note (May 2023) in Appendix I of the Transport Assessment, Gatwick growth has been included in the modelling as below:
 - 2025 – Gatwick existing operations as per modelled in the CTM
 - 2029 – Gatwick flows as modelled in the CTM
 - 2035 – Gatwick DCO growth added to the CTM (the second runway is to become operational in 2029 with their junction mitigation in place by 2032).
14. For clarity, in 2025 base model, existing Gatwick flows have been included within the CTM, for 2029 Development Opening Year Gatwick flows have been included (as modelled within the CTM) and for 2041 the Gatwick DCO "with project" flows have been added to the CTM.

2015 Baseline Traffic Data

15. The CTM has been established for 08:00-09:00 in the AM peak and 17:00-18:00 in the PM peak. 2015 baseline flows have been extracted from the CTM for the road links that are being assessed. A summary of the road links assessed is shown in Appendix B of the Transport ES Chapter.
16. All Vehicle and HGV flows were extracted from the CTM model for each of outlined highway links.
17. The Department for Transport (DfT) database for motor vehicle traffic distribution by time of day and day of the week on all roads in Great Britain (2015), has been extracted to obtain suitable 24 hour AADT to 18 and 6 hour AAWT conversion factors for the highway links. The database can be accessed from the following link: Traffic (www.gov.uk/government/organisations/department-for-transport/series/road-traffic-statistics)
18. All highway links have had the following AADT to AAWT conversion factor applied:
 - AM+PM peak hours to 24hr AADT: 7.18;
 - 24hr AADT to 18hr AAWT: 1.01
 - 24hr AADT to 6hr AAWT: 0.05

2025 Baseline Traffic Data

19. A 2015 to 2025 AADT and AAWT growth rate has been calculated from TEMPRO software (v7.3c) and are based on the different MSOA areas that all the highway links are located within. This has then been applied to the 2015 AADT and AAWT data to obtain the following:
 - 2025 Baseline 24hr AADT;
 - 2025 Baseline 18hr AAWT; and
 - 2025 Baseline 6hr AAWT.

Opening Year 2029 (Without Development, No CWMMC) + Committed Development

20. The 2035 CTM model output flows including the Gatwick Business as Usual (BAU) demand has been produced for 08:00-09:00 in the AM peak and 17:00-18:00 in the PM peak, for a scenario that does not include Wol development and no CWMMC. All Vehicle and HGV flows were extracted from the CTM model for each of outlined highway links.
21. The Department for Transport (DfT) database for motor vehicle traffic distribution by time of day and day of the week on all roads in Great Britain (2025), has been extracted to obtain suitable 24 hour AADT to 18 and 6 hour AAWT conversion factors for the highway links. The database can be accessed from the following link: Traffic (www.gov.uk/government/organisations/department-for-transport/series/road-traffic-statistics). The 2025 data has been used as it replicates the most representative pre-covid baseline.
22. All highway links have had the following AADT to AAWT conversion factor applied:
 - AM+PM peak hours to 24hr AADT: 6.80;
 - 24hr AADT to 18hr AAWT: 1.03
 - 24hr AADT to 6hr AAWT: 0.04
23. No growth rate has been applied to the 2035 data, and it has been assumed that this would replicate the Opening Year 2029 as a worst case assessment.

Opening Year 2029 (Without Development, With CWMMC) + Committed Development

24. The 2035 CTM model output flows including the Gatwick Business as Usual (BAU) demand has been produced for 08:00-09:00 in the AM peak and 17:00-18:00 in the PM peak, for a scenario that does not

include Wol development and includes CWMMC. All Vehicle and HGV flows were extracted from the CTM model for each of outlined highway links.

25. The Department for Transport (DfT) database for motor vehicle traffic distribution by time of day and day of the week on all roads in Great Britain (2025), has been extracted to obtain suitable 24 hour AADT to 18 and 6 hour AAWT conversion factors for the highway links. The database can be accessed from the following link: Traffic (www.gov.uk/government/organisations/department-for-transport/series/road-traffic-statistics). The 2025 data has been used as it replicates the most representative pre-covid baseline.
26. All highway links have had the following AADT to AAWT conversion factor applied:
 - AM+PM peak hours to 24hr AADT: 6.80;
 - 24hr AADT to 18hr AAWT: 1.03
 - 24hr AADT to 6hr AAWT: 0.04
27. No growth rate has been applied to the 2035 data, and it has been assumed that this would replicate the Opening Year 2029 as a worst case assessment.

Opening Year 2029 (With Development, With CWMMC) + Committed Development

28. The 2035 CTM model output flows including the Gatwick Business as Usual (BAU) demand has been produced for 08:00-09:00 in the AM peak and 17:00-18:00 in the PM peak, for a scenario that includes the Wol development in the year 2029 and includes CWMMC. All Vehicle and HGV flows were extracted from the CTM model for each of outlined highway links.
29. Note that the first phase of development referenced in the 2029 Opening Year development constitutes the following development uses being built out in addition to the construction of the Crawley West Link being completed:
 - Secondary School – Year 7 (as the school will fill by filling year 7 in year one, year 7 and 8 in year two and so on); and
 - Residential – 30 Dwellings.
30. The Department for Transport (DfT) database for motor vehicle traffic distribution by time of day and day of the week on all roads in Great Britain (2025), has been extracted to obtain suitable 24 hour AADT to 18 and 6 hour AAWT conversion factors for the highway links. The database can be accessed from the following link: Traffic (www.gov.uk/government/organisations/department-for-transport/series/road-traffic-statistics). The 2025 data has been used as it replicates the most representative pre-covid baseline.
31. All highway links have had the following AADT to AAWT conversion factor applied:
 - AM+PM peak hours to 24hr AADT: 6.80;
 - 24hr AADT to 18hr AAWT: 1.03
 - 24hr AADT to 6hr AAWT: 0.04
32. No growth rate has been applied to the 2035 data, and it has been assumed that this would replicate the Opening Year 2029 as a worst case assessment.
33. A further calculation has been performed by the following:
(Opening Year 2029 With First Phase Development, With CWL, and Committed Development)
– (Opening Year 2029 Without Development, With CWL and Committed Development)
34. This calculates a pure first phase development flow. This has then been added for each road link in the Opening Year 2029 (Without Development, With CWMMC) + Committed Development scenario to produce the overall Opening Year 2029 (With First Phase Development, With CWMMC) + Committed Development scenario.

Future Year 2041 (Without Development, No CWMMC) + Committed Development

35. The 2035 CTM model output flows including the Gatwick 2047 Development Consent Order (DCO) demand has been produced for 08:00-09:00 in the AM peak and 17:00-18:00 in the PM peak, for a scenario that does not include Wol development and no CWMMC. All Vehicle and HGV flows were extracted from the CTM model for each of outlined highway links.
36. The Department for Transport (DfT) database for motor vehicle traffic distribution by time of day and day of the week on all roads in Great Britain (2025), has been extracted to obtain suitable 24 hour AADT to 18 and 6 hour AAWT conversion factors for the highway links. The database can be accessed from the following link: Traffic (www.gov.uk/government/organisations/department-for-transport/series/road-traffic-statistics). The 2025 data has been used as it replicates the most representative pre-covid baseline.
37. All highway links have had the following AADT to AAWT conversion factor applied:
 - AM+PM peak hours to 24hr AADT: 6.80;
 - 24hr AADT to 18hr AAWT: 1.03
 - 24hr AADT to 6hr AAWT: 0.04
38. A 2035 to 2041 AADT and AAWT growth rate has been calculated from TEMPRO software (v7.3c) and are based on the different MSOA areas that all the highway links are located within. This has then been applied to the 2035 AADT and AAWT data to obtain the following:
 - 2041 Future Year 2041 (Without Development, No CWMMC) + Committed Development - 24hr AADT;
 - 2041 Future Year 2041 (Without Development, No CWMMC) + Committed Development - 18hr AAWT; and
 - 2041 Future Year 2041 (Without Development, No CWMMC) + Committed Development – 6hr AAWT.

Future Year 2041 (Without Development, With CWMMC) + Committed Development

39. The 2035 CTM model output flows including the Gatwick 2047 Development Consent Order (DCO) demand has been produced for 08:00-09:00 in the AM peak and 17:00-18:00 in the PM peak, for a scenario that does not include Wol development and includes CWMMC. All Vehicle and HGV flows were extracted from the CTM model for each of outlined highway links.
40. The Department for Transport (DfT) database for motor vehicle traffic distribution by time of day and day of the week on all roads in Great Britain (2025), has been extracted to obtain suitable 24 hour AADT to 18 and 6 hour AAWT conversion factors for the highway links. The database can be accessed from the following link: Traffic (www.gov.uk/government/organisations/department-for-transport/series/road-traffic-statistics). The 2025 data has been used as it replicates the most representative pre-covid baseline.
41. All highway links have had the following AADT to AAWT conversion factor applied:
 - AM+PM peak hours to 24hr AADT: 6.80;
 - 24hr AADT to 18hr AAWT: 1.03
 - 24hr AADT to 6hr AAWT: 0.04
42. A 2035 to 2041 AADT and AAWT growth rate has been calculated from TEMPRO software (v7.3c) and are based on the different MSOA areas that all the highway links are located within. This has then been applied to the 2035 AADT and AAWT data to obtain the following:
 - 2041 Future Year 2041 (Without Development, With CWMMC) + Committed Development - 24hr AADT;
 - 2041 Future Year 2041 (Without Development, With CWMMC) + Committed Development - 18hr AAWT; and
 - 2041 Future Year 2041 (Without Development, With CWMMC) + Committed Development – 6hr AAWT.

Future Year 2041 (With Full Development, With CWMMC) + Committed Development

43. The 2035 CTM model output flows including the Gatwick 2047 Development Consent Order (DCO) demand has been produced for 08:00-09:00 in the AM peak and 17:00-18:00 in the PM peak, for a scenario that does include the full completed WoI development and includes CWMMC. All Vehicle and HGV flows were extracted from the CTM model for each of outlined highway links.
44. The Department for Transport (DfT) database for motor vehicle traffic distribution by time of day and day of the week on all roads in Great Britain (2025), has been extracted to obtain suitable 24 hour AADT to 18 and 6 hour AAWT conversion factors for the highway links. The database can be accessed from the following link: Traffic (www.gov.uk/government/organisations/department-for-transport/series/road-traffic-statistics). The 2025 data has been used as it replicates the most representative pre-covid baseline.
45. All highway links have had the following AADT to AAWT conversion factor applied:
- AM+PM peak hours to 24hr AADT: 6.80;
 - 24hr AADT to 18hr AAWT: 1.03
 - 24hr AADT to 6hr AAWT: 0.04
46. A further calculation has been performed by the following:
- $$\begin{aligned} & \text{(Future Year 2041 With Full Development, With CWL, and Committed Development)} \\ & - \text{(Future Year 2041 Without Development, With CWL and Committed Development)} \end{aligned}$$
47. This calculates a pure full completed development flow. This has then been added for each road link in the Future Year (Without Development, With CWMMC) + Committed Development scenario, which has already had a growth rate applied from 2035 to 2041, to produce the overall Future Year (With Full Development, With CWMMC) + Committed Development scenario. This effectively allows the full development flows to be added without being artificially increased by growth factors.

APPENDIX 15.2: FULL LIST OF AADT AND AAWT DATA

Available on request

APPENDIX 15.3: LIST OF COMMITTED DEVELOPMENTS INCLUDED IN CRAWLEY TOWN MODEL (CTM)

Item No.	District	Development Location/Name	Allocated Zone	Donor Zone	Quanta	Units (Gross Floor Area (GFA) in Square metres -SQM for employment)	Type
1	Crawley	Forge Wood, Pound Hill	121	121	1,900	Dwellings	C3, Suburban
2	Crawley	Ifield Community College	100	100	193	Dwellings	C3, Suburban
3	Crawley	Southern Counties, West Green	27	27	218	Dwellings	C3, Town Centre
4	Crawley	Thomas Bennett/Land adjacent to Desmond Anderson, Tilgate	70	70	0	Dwellings	C3, Suburban
5	Crawley	Fairfield House, West Green	30	30	93	Dwellings	C3, Suburban
6	Crawley	Breezehurst Drive	88	88	112	Dwellings	C3, Suburban
7	Crawley	Town Centre North/Land North of Boulevard	293	8	276	Dwellings	C3, Town Centre
8	Crawley	Telford Place, Three Bridges	294	24	0	Dwellings	C3, Town Centre
9	Crawley	North East Sector Residual Land, Pound Hill/Land to southeast Healthy Farm, Balcombe Road	300	121	0	Dwellings	C3, Suburban
10	Crawley	North East Sector Residual Land, Pound Hill/Steers Lane	121	121	185	Dwellings	C3, Suburban
11	Crawley	Kilnwood Vale	302	76	1,340	Dwellings	C3, Suburban
12	Crawley	Three Bridges Housing Site, Tinsley Lane	120	120	0	Dwellings	C3, Suburban
13	Crawley	Southgate Housing Site, Goffs Park	44	44	44	Dwellings	C3, Suburban
14	Crawley	Bewbush, Breezehurst Drive	88	88	0	Dwellings	C3, Suburban
15	Crawley	15-29 Broadway Upper Floors	16	16	57	Dwellings	C3, Town Centre
16	Crawley	Kilnmead Car Park, Northgate	45	45	40	Dwellings	C3, Town Centre
17	Crawley	Zurich House, East Park, Southgate	39	39	59	Dwellings	C3, Town Centre
18	Crawley	Former TSB Site, Russell Way, Three Bridges	58	58	0	Dwellings	C3, Suburban
19	Crawley	Land adjacent Langley Green Primary School, Langley Green	106	106	30	Dwellings	C3, Suburban
20	Crawley	5-7 Brighton Road, Southgate	39	39	48	Dwellings	C3, Town Centre
21	Crawley	Longley Building	39	39	0	Dwellings	C3, Town Centre
22	Crawley	Crawley Station Car Park	23	23	308	Dwellings	C3, Town Centre
23	Crawley	County Buildings	7	7	0	Dwellings	C3, Town Centre
24	Crawley	Henty Close, Bewbush Housing and Open Space Sites	89	89	0	Dwellings	C3, Suburban
25	Crawley	Land S/O & R/O 24 Brighton Road	39	39	14	Dwellings	C3, Town Centre
26	Crawley	Belgrave House, Station Way	19	19	28	Dwellings	C3, Town Centre
27	Crawley	Pacific House, Hazelwick Avenue	53	53	20	Dwellings	C3, Suburban
28	Crawley	Energy House, Hazelwick Avenue	53	53	40	Dwellings	C3, Suburban
29	Crawley	International Business Centre, Spindle Way	50	50	10	Dwellings	C3, Suburban
30	Crawley	Ambulance Station, Ifield Avenue	34	34	0	Dwellings	C3, Suburban
31	Crawley	2-12 Friston Walk	100	100	0	Dwellings	C3, Suburban
32	Crawley	Rear Gardens, Dingle Close/Ifield Road	32	32	0	Dwellings	C3, Suburban
33	Crawley	Rear Gardens, Snell Hatchfield Road	32	32	0	Dwellings	C3, Suburban
34	Crawley	96-102 North Road	52	52	0	Dwellings	C3, Suburban
35	Crawley	46-48 Goffs Park Road	44	44	0	Dwellings	C3, Suburban
36	Crawley	Land at Peterborough Road	68	68	0	Dwellings	C3, Suburban
37	Crawley	Furnace Green Community Centre	62	62	0	Dwellings	C3, Suburban
38	Crawley	Land at Gales Place and West Way	52	52	0	Dwellings	C3, Suburban
39	Crawley	42 & 44 Brighton Road	39	39	0	Dwellings	C3, Town Centre
40	Crawley	Land East Balcombe Road/Street Hill, Pound Hill Housing, Biodiversity and Heritage Site	121	121	0	Dwellings	C3, Suburban
41	Crawley	Oakhurst Grange Housing for Older People	44	44	55	Dwellings	C3, Suburban
42	Crawley	Town Centre Broad Location	16	16	0	Dwellings	C3, Town Centre
43	Crawley	Land East of London Road, Northgate Broad Location	45	45	0	Dwellings	C3, Town Centre
44	Crawley	Upper Floors, 7 – 13 The Broadway & 1 – 3 Queens Square, Northgate	12	12	0	Dwellings	C3, Town Centre
45	Crawley	Stoner House, Kilnmead, Northgate	45	45	138	Dwellings	C3, Town Centre
46	Crawley	Sutherland House, Russell Way, Three Bridges	58	58	136	Dwellings	C3, Suburban
47	Crawley	EDF Building, Russell Way, Three Bridges	58	58	42	Dwellings	C3, Suburban
48	Crawley	Shaw House, Pegler Way, West Green	26	26	33	Dwellings	C3, Town Centre
49	Crawley	The Imperial, Broadfield Barton	81	81	19	Dwellings	C3, Suburban
50	Crawley	Central Sussex College (East of Tower)	50	50	98	Dwellings	C3, Suburban
51	Crawley	Crawley College outstanding	295	51	0	Dwellings	C3, Suburban
52	Crawley	Cross Keys	17	17	0	Dwellings	C3, Town Centre
53	Crawley	MOKA	22	22	152	Dwellings	C3, Town Centre
54	Crawley	Rushetts Road Play Area, Langley Green	104	104	0	Dwellings	C3, Suburban
55	Crawley	St. Catherine's Hospice, Southgate	39	39	0	Dwellings	C3, Town Centre
56	Crawley	West of Ifield	305	96	0	Dwellings	C3, Suburban
57	Crawley	Cophthorne	167	167	500	Dwellings	C3, Suburban
58	Crawley	Pease Pottage	296	175	746	Dwellings	C3, Suburban
59	Crawley	Rusper Road	96	96	131	Dwellings	C3, Suburban
60	Crawley		11	12	0	Dwellings	C3, Town Centre
61	Crawley		12	12	0	Dwellings	C3, Town Centre
62	Crawley		13	12	0	Dwellings	C3, Town Centre
63	Crawley		14	12	0	Dwellings	C3, Town Centre
64	Crawley		15	12	0	Dwellings	C3, Town Centre
65	Crawley	Windfalls- Town Centre (assume 60% of total windfall amount of 2000 dwells)	16	12	0	Dwellings	C3, Town Centre
66	Crawley		17	12	0	Dwellings	C3, Town Centre
67	Crawley		18	12	0	Dwellings	C3, Town Centre
68	Crawley		19	12	0	Dwellings	C3, Town Centre
69	Crawley		20	12	0	Dwellings	C3, Town Centre
70	Crawley		21	12	0	Dwellings	C3, Town Centre
71	Crawley		33	33	0	Dwellings	C3, Suburban
72	Crawley		46	33	0	Dwellings	C3, Suburban
73	Crawley	Windfalls- Rest of Borough (assume 40% of total windfall amount of 2000 dwells)	131	33	0	Dwellings	C3, Suburban
74	Crawley		68	33	0	Dwellings	C3, Suburban
75	Crawley	Manor Royal Opportunity Area, Welland Medical Site	297	113	8,782	Employment	B1c, Light Industry
76	Crawley	SECAMB, Faraday Road, Manor Royal	115	115	2,661	Employment	B1a, Offices Suburban
77	Crawley	E2 Crawley Business Quarter	298	117	11,525	Employment	B1a, Offices Suburban
78	Crawley	29a-35 High Street (St John's House)	17	17	1,022	Employment	B1a, Offices Town Centre
79	Crawley	5 Rutherford Way	299	114	5,232	Employment	B1c, Light Industry
80	Crawley	Dualit Limited, County Oak Way (Side Extension)	111	111	872	Employment	B8, Warehousing Commercial
81	Crawley	Café Express Carwash, Gales Place	52	52	500	Employment	B8, Warehousing Commercial
82	Crawley	Unit 3 The Drive (Ezehaul)	119	119	1,364	Employment	B8, Warehousing Commercial
83	Crawley	Astral Towers/The White House, Betts Way (marketed as Nova)	306	111	8,401	Employment	B8, Warehousing Commercial
84	Crawley	Astral Towers/The White House, Betts Way (marketed as Nova)	111	111	2,961	Employment	B8, Warehousing Commercial
85	Crawley	Premiere House, Betts Way	307	111	7,077	Employment	B8, Warehousing Commercial
86	Crawley	Premiere House, Betts Way	111	111	2,481	Employment	A1, non-food
87	Crawley	Southways (planning permission)	112	112	3,241	Employment	B1a, Offices Suburban
88	Crawley	Tilgate Forest Business Centre Vacant Plots	72	72	4,630	Employment	B1a, Offices Suburban
89	Crawley	Forge Wood, North East Sector, Employment Land	301	121	1,667	Employment	B1a, Offices Suburban
90	Crawley	Forge Wood, North East Sector, Employment Land	301	121	1,667	Employment	B1c, Light Industry
91	Crawley	Forge Wood, North East Sector, Employment Land	301	121	1,667	Employment	B8, Warehousing Commercial
92	Crawley	Forge Wood, North East Sector, Neighbourhood Centre	301	121	2,500	Employment	A1, non-food
93	Crawley	Employment commitments in Horsham (Kilnwood Vale)	302	76	9,300	Employment	B1a, Offices Suburban
94	Crawley	Town Centre North A1 retail	308	8	0	Employment	B1a, Offices Town Centre
95	Crawley	Town Centre North A1 retail	8	8	0	Employment	A1, non-food
96	Crawley	Town Centre North A1 retail	8	8	0	Employment	A2, Financial/Professional Services
97	Crawley	Town Centre North A1 retail	8	8	0	Employment	A3, Restaurants
98	Crawley	GlaxoSmithKline B1 business	309	48	25,317	Employment	B8, Warehousing Commercial
99	Crawley	GlaxoSmithKline B1 business	310	48	13,431	Employment	B8, Warehousing Commercial
100	Crawley	GlaxoSmithKline B1 business	48	48	1,521	Employment	B1a, Offices Suburban
101	Crawley	GlaxoSmithKline B1 business	311	48	19,391	Employment	B8, Warehousing Commercial
102	Crawley	GlaxoSmithKline B1 business	48	48	1,433	Employment	B1a, Offices Suburban
103	Crawley	Segro West, London Road B1 business	312	112	16,173	Employment	B1a, Offices Suburban
104	Crawley	Thales, Gatwick Road B1 business	116	116	4,282	Employment	B1a, Offices Suburban
105	Crawley	Thales, Gatwick Road B1 business	116	116	2,785	Employment	B1c, Light Industry
106	Crawley	Thales, Gatwick Road B1 business	116	116	1,011	Employment	B8, Warehousing Commercial
107	Crawley	Thales, Gatwick Road B1 business	116	116	3,279	Employment	D1, College
108	Crawley	Thales, Gatwick Road B1 business	116	116	2,945	Employment	B1a, Offices Suburban
109	Crawley	Thales, Gatwick Road B1 business	116	116	3,360	Employment	B1a, Offices Suburban
110	Crawley	Thales, Gatwick Road B1 business	116	116	3,361	Employment	B1a, Offices Suburban
111	Crawley	Thales, Gatwick Road B1 business	116	116	256	Employment	B1a, Offices Suburban
112	Crawley	Thales, Gatwick Road B1 business	116	116	256	Employment	A1, non-food
113	Crawley	Thales, Gatwick Road B1 business	116	116	256	Employment	A3, Restaurants
114	Crawley	Thales, Gatwick Road B1 business	116	116	256	Employment	A3, Restaurants
115	Crawley	BOC Edwards B1 business	115	115	1,467	Employment	B1c, Light Industry
116	Crawley	BOC Edwards B1 business	313	115	4,051	Employment	B1a, Offices Suburban
117	Crawley	BOC Edwards B1 business	314	115	7,568	Employment	B8, Warehousing Commercial
118	Crawley	BOC Edwards B1 business	115	115	3,741	Employment	B1a, Offices Suburban
119	Crawley	Betts Way	111	111	3,722	Employment	A1, non-food
120	Crawley	Former Pasta Reale Site	113	113	3,171	Employment	B1a, Offices Suburban
121	Crawley	Harwoods Jaguar and Land Rover, Crawley	48	48	1,206	Employment	B1a, Offices Suburban
122	Crawley	Wingspan Club Residual Land	111	111	2,787	Employment	B8, Warehousing Commercial
123	Crawley	Gatwick Park G1	315	120	0	Employment	B1a, Offices Suburban
124	Crawley	Gatwick Park G2	316	120	0	Employment	B1a, Offices Suburban

125	Crawley	County Buildings	317	7	0	Employment	B1a, Offices Town Centre
126	Crawley	2-14 Compton Way Complete	47	47	4,920	Employment	B8, Warehousing Commercial
127	Crawley	Land at Jersey Farm (Site A)	111	111	0	Employment	B8, Warehousing Commercial
128	Crawley	Units XA1 and XA2, Sussex Manor Business Park	318	116	0	Employment	B1c, Light Industry
129	Crawley	MOKA	22	22	0	Employment	B1a, Offices Town Centre
130	Crawley	MOKA	22	22	0	Employment	A1, non-food
131	Crawley	MOKA	22	22	0	Employment	A3, Restaurants
132	Crawley	MOKA	22	22	0	Employment	A3, Restaurants
133	Crawley	MOKA	22	22	0	Employment	D1, College
134	Crawley	Land at Station Hill, Pound Hill	128	128	0	Employment	B1a, Offices Suburban
135	Crawley	Units 3B/C, 3D and 4B, County Oak	111	111	0	Employment	A1, non-food
136	Crawley	Gatwick Green	319	H2	0	Employment	B8, Parcel Distribution Centre
137	Crawley	Gatwick Green	320	H2	0	Employment	B8, Warehousing Commercial
138	Crawley	Gatwick Green	321	H2	0	Employment	B2, Industrial Estate
139	Reigate&Banstead (RBBC)	Horley Strategic Business Park (RBBC)	304	H2	66,667	Employment	B1a, Offices Suburban
140	Reigate&Banstead (RBBC)	Horley Strategic Business Park (RBBC)	304	H2	66,667	Employment	B1b, Business Park
141	Reigate&Banstead (RBBC)	Horley Strategic Business Park (RBBC)	304	H2	66,667	Employment	B1c, Light Industry
142	Reigate&Banstead (RBBC)	Horley Strategic Business Park (RBBC)	303	H1	2,625	Employment	A1, non-food
143	Reigate&Banstead (RBBC)	Horley Strategic Business Park (RBBC)	303	H1	2,625	Employment	A3, Restaurants
144	Reigate&Banstead (RBBC)	Horley Strategic Business Park (RBBC)	303	H1	2,625	Employment	D1, College
145	Reigate&Banstead (RBBC)	Horley Strategic Business Park (RBBC)	303	H1	2,625	Employment	D2, Leisure Centre
146	Crawley	Crawley Town Centre (50%)	16	16	0	Employment	A1, Convenience Store
147	Crawley	Rest of Borough (50%)	32	32	0	Employment	A1, Convenience Store
148	Crawley	Crawley Town Centre (50%)	16	16	0	Employment	A1, Comparison Store
149	Crawley	Rest of Borough (50%)	32	32	0	Employment	A1, Comparison Store
150	Horsham	Neighbourhood Centre for West of Ifield	100	100	0	Employment	B1a, Offices Suburban
151	Horsham	Neighbourhood Centre for West of Ifield	100	100	0	Employment	B1c, Light Industry
152	Horsham	Neighbourhood Centre for West of Ifield	100	100	0	Employment	B8, Warehousing Commercial
153	Horsham	Business Park West of Kilnwood Vale	302	76	0	Employment	B1a, Offices Suburban
154	Horsham	Business Park West of Kilnwood Vale	302	76	0	Employment	B1c, Light Industry
155	Horsham	Business Park West of Kilnwood Vale	302	76	0	Employment	B8, Warehousing Commercial
156	Crawley	First Choice House London Road Langley Green Crawley	113	113	91	Dwellings	C3, Suburban
157	Crawley	Ashburn House, Broadfield Park, Brighton Road, RH11 9RT	74	74	92	Dwellings	C3, Suburban
158	Crawley	Maplehurst House Broadfield Park, Brighton Road, Broadfield, Crawley	74	74	69	Dwellings	C3, Suburban
159	Mid Sussex	Land Off Kings Way Burgess Hill	241	241	64	Dwellings	C3, Suburban
160	Mid Sussex	Adj Ashplatts House Holytte Road East Grinstead	192	192	117	Dwellings	C3, Suburban
161	Mid Sussex	Gamblemead Haywards Heath	200	200	151	Dwellings	C3, Suburban
162	Mid Sussex	Keymer Tile Phase 1 Burgess Hill	241	241	125	Dwellings	C3, Suburban
163	Mid Sussex	Keymer Tile Works Nye Road Burgess Hill Phase 2	241	241	170	Dwellings	C3, Suburban
164	Mid Sussex	South of the Old Convent and St Margarets Adj to Moatfield	241	241	74	Dwellings	C3, Suburban
165	Mid Sussex	East of Hospital playing field Parcel Y	199	199	132	Dwellings	C3, Suburban
166	Mid Sussex	Bolnore Village Phase 5b	199	199	69	Dwellings	C3, Suburban
167	Mid Sussex	Bolnore Village Phases 4b & 5	199	199	135	Dwellings	C3, Suburban
168	Mid Sussex	Bolnore Phase 4b and 5 Haywards Heath	200	200	181	Dwellings	C3, Suburban
169	Mid Sussex	Bolnore Phase 4a Haywards Heath	241	241	192	Dwellings	C3, Suburban
170	Mid Sussex	Phases 1a 1b 1c Land east of Kingsway Burgess Hill	241	241	78	Dwellings	C3, Suburban
171	Mid Sussex	Phase 2 onwards Land east of Kingsway Burgess Hill	241	241	95	Dwellings	C3, Suburban
172	Mid Sussex	Little Park Farm Hurstpierpoint	248	248	140	Dwellings	C3, Suburban
173	Mid Sussex	Rocky Lane Phase 1 Haywards Heath	200	200	96	Dwellings	C3, Suburban
174	Mid Sussex	Land South of Rocky Lane Haywards Heath Phase 2	200	200	134	Dwellings	C3, Suburban
175	Mid Sussex	Penland Farm Haywards Heath	200	200	210	Dwellings	C3, Suburban
176	Mid Sussex	Land south of Chalkers Lane Hurstpierpoint	248	248	61	Dwellings	C3, Suburban
177	Mid Sussex	Land South of Rocky Lane Haywards Heath Phase 2	200	200	134	Dwellings	C3, Suburban
178	Mid Sussex	Phase 1 Barratt and David Wilson Homes Gravelye Lane	197	197	82	Dwellings	C3, Suburban
179	Mid Sussex	Phase 2 Barratt and David Wilson Homes Gravelye Lane	197	197	148	Dwellings	C3, Suburban
180	Mid Sussex	Land south west of Handcross Primary School Handcross	175	175	102	Dwellings	C3, Suburban
181	Mid Sussex	R/O 88 Folders Lane Burgess Hill	244	244	73	Dwellings	C3, Suburban
182	Mid Sussex	Golf Course Horsham Road Pease Pottage	175	175	95	Dwellings	C3, Suburban
183	Mid Sussex	Phase 2 Land off Woodlands Close Crawley Down	173	173	51	Dwellings	C3, Suburban
184	Mid Sussex	Barn Cottage Lewes Road Scaynes Hill Haywards Heath West Sussex RH17 7NE	194	194	51	Dwellings	C3, Suburban
185	Mid Sussex	Martells Department Store East Grinstead	192	192	129	Dwellings	C3, Suburban
186	Mid Sussex	Land at Hammonds Ridge	244	244	51	Dwellings	C3, Suburban
187	Mid Sussex	Northern Arc Burgess Hill	200	200	2,327	Dwellings	C3, Suburban
188	Mid Sussex	Hardriding Farm Brighton Road Pease Pottage	175	175	558	Dwellings	C3, Suburban
189	Mid Sussex	Land north of the A264 at Junction 10 of M23	167	167	500	Dwellings	C3, Suburban
190	Mid Sussex	Land to the north of Clayton Mills Mackie Avenue Hassocks	245	245	500	Dwellings	C3, Suburban
191	Mid Sussex	Land west of Freeks Lane Burgess Hill	200	200	460	Dwellings	C3, Suburban
192	Mid Sussex	Hurst Farm Hurstwood Lane Haywards Heath	200	200	350	Dwellings	C3, Suburban
193	Mid Sussex	Former Sewage Works Fairbridge Way Burgess Hill	242	242	325	Dwellings	C3, Suburban
194	Mid Sussex	Land east of Kings Way Burgess Hill	241	241	308	Dwellings	C3, Suburban
195	Mid Sussex	Land south of Rocky Lane & to the west of Weald Rise and Fox Hill Village Haywards Heath	200	200	241	Dwellings	C3, Suburban
196	Mid Sussex	Keymer Tile Works Nye Road Burgess Hill	241	241	223	Dwellings	C3, Suburban
197	Mid Sussex	Imberhorne Lower School Windmill Lane East Grinstead	192	192	200	Dwellings	C3, Suburban
198	Mid Sussex	Land South of Scamps Hill Lindfield	197	197	200	Dwellings	C3, Suburban
199	Mid Sussex	Land at Hill Place Farm to the south west of East Grinstead west and east of the Bluebell Railway Line	193	193	200	Dwellings	C3, Suburban
200	Mid Sussex	Hassocks Golf Club London Road Hassocks	245	245	165	Dwellings	C3, Suburban
201	Mid Sussex	Burgess Hill Station yard/car park Burgess Hill	242	242	150	Dwellings	C3, Suburban
202	Mid Sussex	37-39 Perrymount Road Haywards Heath	199	199	145	Dwellings	C3, Suburban
203	Mid Sussex	Land at Burgess Hill Town Centre multiple sites	248	248	142	Dwellings	C3, Suburban
204	Mid Sussex	Land to the north of Shepherds Walk Friars Oak Hassocks	245	245	130	Dwellings	C3, Suburban
205	Mid Sussex	Penland Farm Haywards Heath	200	200	129	Dwellings	C3, Suburban
206	Mid Sussex	Land north of Kingsland Laines Sayers Common	248	248	119	Dwellings	C3, Suburban
207	Mid Sussex	Martells Store 1-4 Normans Gardens and 38A Queens Road East Grinstead	192	192	107	Dwellings	C3, Suburban
208	Mid Sussex	Land at the Brow Burgess Hill	242	242	100	Dwellings	C3, Suburban
209	Mid Sussex	Land at Gravelye Lane and Scamps Hill Lindfield	197	197	98	Dwellings	C3, Suburban
210	Mid Sussex	Western side of Victoria Road Burgess Hill	243	243	68	Dwellings	C3, Suburban
211	Mid Sussex	Land at the Ham Hassocks	245	245	66	Dwellings	C3, Suburban
212	Mid Sussex	Land rear of 88 Folders Lane Burgess Hill	244	244	65	Dwellings	C3, Suburban
213	Mid Sussex	Land rear of 15 and 39 Crawley Down Road Felbridge	193	193	62	Dwellings	C3, Suburban
214	Mid Sussex	Land south of Hazel Close Crawley Down	173	173	60	Dwellings	C3, Suburban
215	Mid Sussex	Land at Foxhill Gamblemead Lane Foxhill Haywards Heath	200	200	57	Dwellings	C3, Suburban
216	Mid Sussex	Station Goods Yard Hassocks	245	245	54	Dwellings	C3, Suburban
217	Mid Sussex	Land south of Rocky Lane Phase 2 Haywards Heath	200	200	54	Dwellings	C3, Suburban
218	Mid Sussex	Wealden House Lewes Road Ashurst Wood	191	191	50	Dwellings	C3, Suburban
219	Mid Sussex	Land adjacent to Barn Cottage Lewes Road Scaynes Hill	194	194	46	Dwellings	C3, Suburban
220	Mid Sussex	Land to the west of The Pheasantry Turners Hill Road Crawley Down part of site previously assessed as of site 688	168	168	44	Dwellings	C3, Suburban
221	Mid Sussex	Old Vicarage Field Church Road Turners Hill	174	174	44	Dwellings	C3, Suburban
222	Mid Sussex	Land east of Portsmouth Wood Close Lindfield	194	194	43	Dwellings	C3, Suburban
223	Mid Sussex	Farringdon House Wood Street East Grinstead	192	192	42	Dwellings	C3, Suburban
224	Mid Sussex	Stonequarry Woods East Grinstead	192	192	40	Dwellings	C3, Suburban
225	Mid Sussex	NCP Car Park Harlands Road Haywards Heath	199	199	40	Dwellings	C3, Suburban
226	Mid Sussex	Land at Bridge Hall Cuckfield Road Burgess Hill	200	200	39	Dwellings	C3, Suburban
227	Mid Sussex	Land at Little Park Farm north of Hurstpierpoint	248	248	35	Dwellings	C3, Suburban
228	Mid Sussex	1 -25 Bell Hammer East Grinstead	192	192	35	Dwellings	C3, Suburban
229	Mid Sussex	Land at Holly Farm Copthorne Way Copthorne	172	172	33	Dwellings	C3, Suburban
230	Mid Sussex	Land rear of 11A Crawley Down Road Felbridge	193	193	31	Dwellings	C3, Suburban
231	Mid Sussex	Land opposite Former Queens Head west of London Road Bolney	248	248	30	Dwellings	C3, Suburban
232	Mid Sussex	Land at St Martins Close East Handcross	201	201	30	Dwellings	C3, Suburban
233	Mid Sussex	Ashplats House Holtye Road East Grinstead	191	191	29	Dwellings	C3, Suburban
234	Mid Sussex	Open air market Cyprus Road Burgess Hill	242	242	25	Dwellings	C3, Suburban
235	Mid Sussex	Land at rear of and including 17 Copthorne Road Felbridge	193	193	25	Dwellings	C3, Suburban
236	Mid Sussex	LIC Wealden House Lewes Road Ashurst Wood	191	191	25	Dwellings	C3, Suburban
237	Mid Sussex	Land north of Top Road Sharpthorne	194	194	24	Dwellings	C3, Suburban
238	Mid Sussex	Land north of 99 Reed Pond Walk Franklands Village Haywards Heath	200	200	24	Dwellings	C3, Suburban
239	Mid Sussex	Land north of Faulkners Way Burgess Hill	242	242	20	Dwellings	C3, Suburban
240	Mid Sussex	Land at Bolney Road Ansty	200	200	20	Dwellings	C3, Suburban
241	Mid Sussex	Downlands Park Isaacs Lane Haywards Heath	199	199	20	Dwellings	C3, Suburban
242	Mid Sussex	Imberhorne Lane car park Imberhorne Lane East Grinstead	193	193	18	Dwellings	C3, Suburban
243	Mid Sussex	Zenith House Market Place Haywards Heath	199	199	17	Dwellings	C3, Suburban
244	Mid Sussex	30 - 34 London Road East Grinstead	193	193	17	Dwellings	C3, Suburban
245	Mid Sussex	Land adjacent to Station Goods Yard Keymer Road Hassocks	245	245	16	Dwellings	C3, Suburban
246	Mid Sussex	Land to the north and rear of Barnfield Cottages Haywards Heath Road Balcombe.	195	195	16	Dwellings	C3, Suburban
247	Mid Sussex	Land adjacent to Cookhams south of Top Road Sharpthorne	194	194	16	Dwellings	C3, Suburban
248	Mid Sussex	Slaugham Manor Slaugham Place Slaugham.	201	201	16	Dwellings	C3, Suburban

249	Mid Sussex	Dart Court Quarry Rise East Grinstead	192	192	16	Dwellings	C3, Suburban
250	Mid Sussex	Beech Hurst Depot Bolnore Road Haywards Heath	199	199	15	Dwellings	C3, Suburban
251	Mid Sussex	Clockfield North Street Turners Hill	174	174	14	Dwellings	C3, Suburban
252	Mid Sussex	Land to the west of the Rectory Haywards Heath Road Balcombe	195	195	14	Dwellings	C3, Suburban
253	Mid Sussex	Land opposite Newlands Spring Field Shaw London Road Balcombe	195	195	14	Dwellings	C3, Suburban
254	Mid Sussex	Pease Pottage Golf House Horsham Road Pease Pottage	175	175	14	Dwellings	C3, Suburban
255	Mid Sussex	49 Queens Road East Grinstead	192	192	14	Dwellings	C3, Suburban
256	Mid Sussex	Packer Close Quarry Rise East Grinstead	192	192	14	Dwellings	C3, Suburban
257	Mid Sussex	23 and 25 Bolnore Road Haywards Heath	192	192	14	Dwellings	C3, Suburban
258	Mid Sussex	Jubilee House Cyprus Road Burgess Hill	242	242	14	Dwellings	C3, Suburban
259	Mid Sussex	Land to rear of Dunnings Mill Sports Club Dunnings Rd East Grinstead	193	193	12	Dwellings	C3, Suburban
260	Mid Sussex	The Oaks Centre Junction Road Burgess Hill	241	241	12	Dwellings	C3, Suburban
261	Mid Sussex	East Grinstead Delivery Office 76 London Road East Grinstead	192	192	12	Dwellings	C3, Suburban
262	Mid Sussex	Land south of Phoenix House Cantelupe Road East Grinstead	192	192	12	Dwellings	C3, Suburban
263	Mid Sussex	Aventis House Market Place Haywards Heath Heath	199	199	12	Dwellings	C3, Suburban
264	Mid Sussex	The Priory Syresham Gardens Haywards Heath	198	198	11	Dwellings	C3, Suburban
265	Mid Sussex	Superdrug 78 London Road East Grinstead	192	192	11	Dwellings	C3, Suburban
266	Mid Sussex	Motorcycle Workshop former G&W Motors London Road Bolney	248	248	10	Dwellings	C3, Suburban
267	Mid Sussex	Courtmeadow School Hanlye Lane Cuckfield	200	200	10	Dwellings	C3, Suburban
268	Mid Sussex	Hassocks Delivery Office 36 Keymer Road Hassocks	245	245	10	Dwellings	C3, Suburban
269	Mid Sussex	Land rear of Devon Villas Western Road Haywards Heath	198	198	10	Dwellings	C3, Suburban
270	Mid Sussex	53-59 Lingfield Road East Grinstead	192	192	9	Dwellings	C3, Suburban
271	Mid Sussex	The Emperor Restaurant Cyprus Road Burgess Hill	242	242	9	Dwellings	C3, Suburban
272	Mid Sussex	Sopers Ride Selsfield Road Turners Hill	174	174	9	Dwellings	C3, Suburban
273	Mid Sussex	Sussex House London Road East Grinstead	192	192	8	Dwellings	C3, Suburban
274	Mid Sussex	Palmers Autocare Centre Turners Hill Road Crawley Down	168	168	8	Dwellings	C3, Suburban
275	Mid Sussex	Bluebell Woodland Sharpthorne	194	194	8	Dwellings	C3, Suburban
276	Mid Sussex	Day Centre Royal George Road Burgess Hill	243	243	8	Dwellings	C3, Suburban
277	Mid Sussex	Seaspace House Brighton Road Handcross	175	175	7	Dwellings	C3, Suburban
278	Mid Sussex	Wallis Centre De La Warr Road East Grinstead	192	192	7	Dwellings	C3, Suburban
279	Mid Sussex	Beckford Lewes Road East Grinstead	192	192	6	Dwellings	C3, Suburban
280	Mid Sussex	Twineham Grange Farm Bob Lane Twineham	248	248	6	Dwellings	C3, Suburban
281	Mid Sussex	87 Junction Road Burgess Hill	241	241	6	Dwellings	C3, Suburban
282	Mid Sussex	118 High Street Hurstpierpoint	248	248	6	Dwellings	C3, Suburban
283	Mid Sussex	Oakhurst Maypole Road East Grinstead	193	193	6	Dwellings	C3, Suburban
284	Reigate&Banstead	L/A Holmethorpe Quarry, Mere Park, Trowers Way (as amended by 06/02292, 07/00943, 07/00945, 07/00955, 09/00671, 10/00192)	184	184	550	Dwellings	C3, Suburban
285	Reigate&Banstead	Knowles House, 35-48 High Street, Redhill, Surrey	182	182	64	Dwellings	C3, Suburban
286	Reigate&Banstead	L/A Langshott & Lake Lane (Horley NE Sector) multiple applicaitons	158	158	718	Dwellings	C3, Suburban
287	Reigate&Banstead	Newman House, Victoria Road, Horley	156	156	90	Dwellings	C3, Suburban
288	Reigate&Banstead	Land Parcel at Inholms, Haroldslea Drive, Horley	161	161	50	Dwellings	C3, Suburban
289	Reigate&Banstead	Land Parcel at 71 Victoria Road, Horley, Surrey	156	156	62	Dwellings	C3, Suburban
290	Reigate&Banstead	50-54 West Street, Reigate, Surrey, RH2 9DB	179	179	87	Dwellings	C3, Suburban
291	Reigate&Banstead	Woodlands Court, 23 Woodlands Road	183	183	14	Dwellings	C3, Suburban
292	Reigate&Banstead	Colne House, Linkfield Lane, Redhill, RH1 1DZ	182	182	19	Dwellings	C3, Suburban
293	Reigate&Banstead	The Frenches Club, The Frenches, Redhill, RH1 2HF	184	184	11	Dwellings	C3, Suburban
294	Reigate&Banstead	Land Parcel One, Purbeck Close, Merstham	185	185	6	Dwellings	C3, Suburban
295	Reigate&Banstead	Dept. Work & Pensions, Crown Buildings, 73-75 London Road, Redhill, RH1 1LP	182	182	14	Dwellings	C3, Suburban
296	Reigate&Banstead	19-23 Woodhatch Road, Redhill, RH1 5HQ	183	183	16	Dwellings	C3, Suburban
297	Reigate&Banstead	Darby House, 162 Bletchingley Road, Merstham, RH1 3HY	185	185	20	Dwellings	C3, Suburban
298	Reigate&Banstead	26-28 Station Road, Redhill, RH1 1PD	184	184	14	Dwellings	C3, Suburban
299	Reigate&Banstead	Site of Former Iron House Public House, 27a Bletchingley Road, Merstham	185	185	10	Dwellings	C3, Suburban
300	Reigate&Banstead	The Cadet Association, 2 Hooley Lane	184	184	11	Dwellings	C3, Suburban
301	Reigate&Banstead	Fintrax House, 13 Station Road North, Merstham, Surrey, RH1 3ED	179	179	11	Dwellings	C3, Suburban
302	Reigate&Banstead	Elgar Works, Nutfield Road, Merstham, Surrey, RH1 3EP	185	185	14	Dwellings	C3, Suburban
303	Reigate&Banstead	The Limes Public House, 58 Albury Road, Merstham, Surrey, RH1 3LL	185	185	9	Dwellings	C3, Suburban
304	Reigate&Banstead	9 Dovers Green Road, Reigate, RH2 8BU	178	178	12	Dwellings	C3, Suburban
305	Reigate&Banstead	Reigate Business Mews, 38 Albert Road North, Reigate, RH2 9EG	179	179	14	Dwellings	C3, Suburban
306	Reigate&Banstead	Surrey Mirror, Trinity House, 51 London Road	179	179	18	Dwellings	C3, Suburban
307	Reigate&Banstead	Chatham Court, Lesbourne Road, Reigate, RH2 7LD	181	181	38	Dwellings	C3, Suburban
308	Reigate&Banstead	Liberty House, Bell Street, Reigate, Surrey, RH2 7JB	181	181	24	Dwellings	C3, Suburban
309	Reigate&Banstead	Rosemary Court, Court Lodge Road, Horley	152	152	20	Dwellings	C3, Suburban
310	Reigate&Banstead	High Trees Nursing Home, Horsehill, Norwood Hill	178	178	14	Dwellings	C3, Suburban
311	Reigate&Banstead	Langwood, 121 Smallfield Road, Horley	160	160	35	Dwellings	C3, Suburban
312	Reigate&Banstead	Landens Buildings, Meath Green Lane, Horley, Surrey, RH6 8HZ	153	153	38	Dwellings	C3, Suburban
313	Reigate&Banstead	Beulah Court, 15 - 19 Albert Road, Horley, RH6 7HP "Beulah Court, 15 - 19 Albert Road, Horley, RH6 7HP	156	156	33	Dwellings	C3, Suburban
314	Reigate&Banstead	Consort House, Consort Way, Horley, RH6 7AF	156	156	38	Dwellings	C3, Suburban
315	Reigate&Banstead	First Floor, 100 Victoria Road, Horley, Surrey, RH6 7AB	156	156	14	Dwellings	C3, Suburban
316	Reigate&Banstead	Amherst House, 287 Court Lodge Road, Horley, Surrey, RH6 8RG	155	155	19	Dwellings	C3, Suburban
317	Reigate&Banstead	Oakfield Court, Consort Way, Horley, Surrey, RH6 7AF	156	156	20	Dwellings	C3, Suburban
318	Reigate&Banstead	Chichester Caravans, 18 Brighton Road, Salfords, Surrey	178	178	20	Dwellings	C3, Suburban
319	Reigate&Banstead	Imperial Buildings, 68-70 Victoria Road, Victoria Road, Horley, Surrey, RH6 7PZ	156	156	15	Dwellings	C3, Suburban
320	Reigate&Banstead	Quadrant House, Princess Way, Redhill, Surrey, RH1 1QA	184	184	125	Dwellings	C3, Suburban
321	Reigate&Banstead	Portland Drive, Merstham, RH1 3HY	185	185	8	Dwellings	C3, Suburban
322	Reigate&Banstead	Furness House, 53 Brighton Road, Redhill, Surrey	184	184	71	Dwellings	C3, Suburban
323	Reigate&Banstead	Redhill Youth Association Hall, Marketfield Road, Redhill, Surrey	184	184	50	Dwellings	C3, Suburban
324	Reigate&Banstead	Marketfield Public Car Park, Marketfield Road, Redhill, Surrey, RH1 1RH	184	184	153	Dwellings	C3, Suburban
325	Reigate&Banstead	Former Liquid And Envy, Station Road, Redhill, Surrey	184	184	133	Dwellings	C3, Suburban
326	Reigate&Banstead	RNIB Soundscape, Philanthropic Road, Redhill	184	184	66	Dwellings	C3, Suburban
327	Reigate&Banstead	Hockley Industrial Centre, Hooley Lane, Redhill, Surrey, RH1 6ET	183	183	60	Dwellings	C3, Suburban
328	Reigate&Banstead	Warwick House, 67 Station Road, Redhill, Surrey, RH1 1QU	182	182	56	Dwellings	C3, Suburban
329	Reigate&Banstead	Brook Road Garages, Brook Road, Redhill, Surrey, RH1 6DL	184	184	57	Dwellings	C3, Suburban
330	Reigate&Banstead	Horley NW Sector, Meath Green Lane, Horley	153	153	1,510	Dwellings	C3, Suburban
331	Reigate&Banstead	Site Of Former De Burgh School, Chetwode Road, Tadworth, Surrey	225	225	229	Dwellings	C3, Suburban
332	Reigate&Banstead	Lilliput Childrens Centre, Lilliput Nursery, West Avenue, Salfords, Surrey, RH1 5BA	183	183	76	Dwellings	C3, Suburban
333	Reigate&Banstead	Bellway House, 241 London Road North, Merstham, Surrey, RH1 3YU	179	179	33	Dwellings	C3, Suburban
334	Reigate&Banstead	Former Shaftesbury House, 14 School Hill, Merstham, Surrey	179	179	13	Dwellings	C3, Suburban
335	Reigate&Banstead	16-46 Cromwell Road, Redhill, Surrey, RH1 1HS	182	182	24	Dwellings	C3, Suburban
336	Reigate&Banstead	Redstone Hall, 10 Redstone Hill, Redhill, Surrey, RH1 4BP	179	179	13	Dwellings	C3, Suburban
337	Reigate&Banstead	The Oakley Outdoor Centre, Radstock Way, Merstham, Surrey, RH1 3NT	179	179	22	Dwellings	C3, Suburban
338	Reigate&Banstead	Patteson Court, Nutfield Road, Redhill, Surrey, RH1 4ED	182	182	22	Dwellings	C3, Suburban
339	Reigate&Banstead	The Abbot Public House, 14 Station Road, Redhill, Surrey, RH1 1NZ	184	184	9	Dwellings	C3, Suburban
340	Reigate&Banstead	32 - 42 Prices Lane, Reigate, Surrey, RH2 8AX	185	185	25	Dwellings	C3, Suburban
341	Reigate&Banstead	Reigate Garden Centre, 143 Sandcross Lane, Reigate, Surrey, RH2 8HH	184	184	17	Dwellings	C3, Suburban
342	Reigate&Banstead	St Johns Court, 51 St Johns Road, Redhill, Surrey, RH1 6DS	184	184	18	Dwellings	C3, Suburban
343	Reigate&Banstead	41 And 43 Doods Park Road, Reigate, Surrey, RH2 0PU	180	180	10	Dwellings	C3, Suburban
344	Reigate&Banstead	5A, 7a, 9a, 11a, 13A West Street, Reigate, Surrey, RH2 9BL	180	180	12	Dwellings	C3, Suburban
345	Reigate&Banstead	Millenium House, 99 Bell Street, Reigate, Surrey, RH2 7AN	183	183	15	Dwellings	C3, Suburban
346	Reigate&Banstead	Vale House, Roebuck Close, Reigate, Surrey, RH2 7RU	181	181	24	Dwellings	C3, Suburban
347	Reigate&Banstead	Saxley Court, 121-129 Victoria Road, Horley, RH6 7AS	181	181	43	Dwellings	C3, Suburban
348	Reigate&Banstead	The Gables, 17 Massetts Road, Horley, Surrey, RH6 7TG	181	181	22	Dwellings	C3, Suburban
349	Reigate&Banstead	96-100 Victoria Road, Horley, Surrey, RH6 7AB	181	181	19	Dwellings	C3, Suburban
350	Reigate&Banstead	Nutley Dean Business Park, Smalls Hill Road, Horley, Surrey, RH6 0HR	156	156	14	Dwellings	C3, Suburban
351	Reigate&Banstead	Gloucester Road, Redhill	182	182	50	Dwellings	C3, Suburban
352	Reigate&Banstead	Colebrook, Redhill	184	184	110	Dwellings	C3, Suburban
353	Reigate&Banstead	Quarryside Business Park, Thornton Way, Redhill	184	184	80	Dwellings	C3, Suburban
354	Reigate&Banstead	Reading Arch Road/ Brighton Road North, Redhill	184	184	150	Dwellings	C3, Suburban
355	Reigate&Banstead	Land at Hillsbrow	184	184	145	Dwellings	C3, Suburban
356	Reigate&Banstead	Copyhold	184	184	230	Dwellings	C3, Suburban
357	Reigate&Banstead	Oakley Farm	185	185	130	Dwellings	C3, Suburban
358	Reigate&Banstead	164 Bletchingley Road	186	186	30	Dwellings	C3, Suburban
359	Reigate&Banstead	Land south of Bletchingley Road	186	186	30	Dwellings	C3, Suburban
360	Reigate&Banstead	Land at Sandcross Lane	180	180	290	Dwellings	C3, Suburban
361	Reigate&Banstead	Land at Dovers Farm	178	178	120	Dwellings	C3, Suburban
362	Reigate&Banstead	Land off The Close and Haroldslea Drive	161	161	75	Dwellings	C3, Suburban
363	Reigate&Banstead	Land at Meath Green Lane	153	153	75	Dwellings	C3, Suburban
364	Reigate&Banstead	Land at Bonehurst Lane	154	154	40	Dwellings	C3, Suburban
365	Reigate&Banstead	Former Longmead Centre, Holland Road, Redhill	182	182	20	Dwellings	C3, Suburban
366	Reigate&Banstead	Church of the Epiphany, Mansfield Road, Merstham	185	185	10	Dwellings	C3, Suburban
367	Reigate&Banstead	Merstham Library, Weldon Way, Merstham	185	185	10	Dwellings	C3, Suburban
368	Reigate&Banstead	Former Oakley Centre, Merstham	185	185	30	Dwellings	C3, Suburban
369	Reigate&Banstead	Land adjacent to Town Hall, Reigate	181	181	30	Dwellings	C3, Suburban
370	Reigate&Banstead	Land West of Castle Drive	178	178	10	Dwellings	C3, Suburban
371	Reigate&Banstead	Hartswood Nursery	178	178	25	Dwellings	C3, Suburban
372	Reigate&Banstead	High Street Carpark, Horley	156	156	40	Dwellings	C3, Suburban
373	Reigate&Banstead	Horley Police Station	148	148	20	Dwellings	C3, Suburban
374	Reigate&Banstead	Horley Library	156	156	40	Dwellings	C3, Suburban
375	Reigate&Banstead	59-61 Brighton Road, Horley	151	151	20	Dwellings	C3, Suburban

376	Reigate&Banstead	Land at Bonehurst Lane	154	154	40	Dwellings	C3, Suburban
377	Reigate&Banstead	Land Parcel between Trowers Way and Holmethorpe Avenue, Redhill	184	184	2,968	Employment	B8, Warehousing Commercial
378	Reigate&Banstead	Dept. Works & Pensions, Crown Buildings, 73-75 London Road, Redhill, RH1 1LP	182	182	5,340	Employment	B1a, Offices Suburban
379	Reigate&Banstead	Land Parcel North End & Granville House, Wells Place, Mertsam	179	179	1,172	Employment	B1b, Business Park
380	Reigate&Banstead	Land Adjacent To The Grove, Wells Place, Merstham, Surrey	179	179	3,432	Employment	B8, Warehousing Commercial
381	Reigate&Banstead	Former Phillips Research Laboratories South Site, Crossoak Lane, Salfords, Surrey, RH1 5HA	178	178	15,831	Employment	B8, Warehousing Commercial
382	Reigate&Banstead	Horley Gas Holder Station, Balcombe Road, Horley, Surrey, RH6 9GA	158	158	4,850	Employment	B1a, Offices Suburban
383	Reigate&Banstead	Gloucester Road Carpark	182	182	4,000	Employment	B1a, Offices Suburban
384	Reigate&Banstead	Land adjacent to the Town Hall, Castlefield Road, Reigate	181	181	1,500	Employment	B1a, Offices Suburban
385	Tandridge DC	Oaklands, Coulsdon Road, Caterham	232	232	161	Dwellings	C3, Suburban
386	Tandridge DC	Oaklands, Coulsdon Road, Caterham	232	232	161	Dwellings	C3, Suburban
387	Tandridge DC	Land at Fairview Industrial Estate, Holland Road, Hurst Green, Oxted, RH8 9AX	189	189	172	Dwellings	C3, Suburban
388	Tandridge DC	Charters Towers, Felcourt Road, Baldwins Hill, RH19 2JG	190	190	76	Dwellings	C3, Suburban
389	Tandridge DC	Oaklands, Coulsdon Road, Caterham	232	232	161	Dwellings	C3, Suburban
390	Tandridge DC	Oaklands, Coulsdon Road, Caterham	232	232	161	Dwellings	C3, Suburban
391	Tandridge DC	Oaklands, Coulsdon Road, Caterham	232	232	161	Dwellings	C3, Suburban
392	Tandridge DC	Oaklands, Coulsdon Road, Caterham	232	232	161	Dwellings	C3, Suburban
393	Tandridge DC	Oaklands, Coulsdon Road, Caterham	232	232	161	Dwellings	C3, Suburban
394	Tandridge DC	Land at Fairview Industrial Estate, Holland Road, Hurst Green, Oxted, RH8 9AX	189	189	172	Dwellings	C3, Suburban
395	Tandridge DC	Land at Fairview Industrial Estate, Holland Road, Hurst Green, Oxted, RH8 9AX	189	189	172	Dwellings	C3, Suburban
396	Tandridge DC	Land at Fairview Industrial Estate, Holland Road, Hurst Green, Oxted, RH8 9AX	189	189	172	Dwellings	C3, Suburban
397	Tandridge DC	Land at Fairview Industrial Estate, Holland Road, Hurst Green, Oxted, RH8 9AX	189	189	172	Dwellings	C3, Suburban
398	Tandridge DC	Land at Fairview Industrial Estate, Holland Road, Hurst Green, Oxted, RH8 9AX	189	189	172	Dwellings	C3, Suburban
399	Tandridge DC	Land at Fairview Industrial Estate, Holland Road, Hurst Green, Oxted, RH8 9AX	189	189	172	Dwellings	C3, Suburban
400	Tandridge DC	Land at Fairview Industrial Estate, Holland Road, Hurst Green, Oxted, RH8 9AX	189	189	172	Dwellings	C3, Suburban
401	Tandridge DC	Land at Fairview Industrial Estate, Holland Road, Hurst Green, Oxted, RH8 9AX	189	189	172	Dwellings	C3, Suburban
402	Tandridge DC	Land at Fairview Industrial Estate, Holland Road, Hurst Green, Oxted, RH8 9AX	189	189	172	Dwellings	C3, Suburban
403	Tandridge DC	Land at Fairview Industrial Estate, Holland Road, Hurst Green, Oxted, RH8 9AX	189	189	172	Dwellings	C3, Suburban
404	Tandridge DC	Land at Fairview Industrial Estate, Holland Road, Hurst Green, Oxted, RH8 9AX	189	189	172	Dwellings	C3, Suburban
405	Tandridge DC	Land at Fairview Industrial Estate, Holland Road, Hurst Green, Oxted, RH8 9AX	189	189	172	Dwellings	C3, Suburban
406	Tandridge DC	Land at Fairview Industrial Estate, Holland Road, Hurst Green, Oxted, RH8 9AX	189	189	172	Dwellings	C3, Suburban
407	Tandridge DC	Land at Fairview Industrial Estate, Holland Road, Hurst Green, Oxted, RH8 9AX	189	189	172	Dwellings	C3, Suburban
408	Tandridge DC	Land at Fairview Industrial Estate, Holland Road, Hurst Green, Oxted, RH8 9AX	189	189	172	Dwellings	C3, Suburban
409	Tandridge DC	Land at Fairview Industrial Estate, Holland Road, Hurst Green, Oxted, RH8 9AX	189	189	172	Dwellings	C3, Suburban
410	Tandridge DC	Land at Fairview Industrial Estate, Holland Road, Hurst Green, Oxted, RH8 9AX	189	189	172	Dwellings	C3, Suburban
411	Tandridge DC	Land at Fairview Industrial Estate, Holland Road, Hurst Green, Oxted, RH8 9AX	189	189	172	Dwellings	C3, Suburban
412	Tandridge DC	Land at Fairview Industrial Estate, Holland Road, Hurst Green, Oxted, RH8 9AX	189	189	172	Dwellings	C3, Suburban
413	Tandridge DC	Land at Fairview Industrial Estate, Holland Road, Hurst Green, Oxted, RH8 9AX	189	189	172	Dwellings	C3, Suburban
414	Tandridge DC	Land at Fairview Industrial Estate, Holland Road, Hurst Green, Oxted, RH8 9AX	189	189	172	Dwellings	C3, Suburban
415	Tandridge DC	Land at Fairview Industrial Estate, Holland Road, Hurst Green, Oxted, RH8 9AX	189	189	172	Dwellings	C3, Suburban
416	Tandridge DC	Land at Fairview Industrial Estate, Holland Road, Hurst Green, Oxted, RH8 9AX	189	189	172	Dwellings	C3, Suburban
417	Tandridge DC	Land at Fairview Industrial Estate, Holland Road, Hurst Green, Oxted, RH8 9AX	189	189	172	Dwellings	C3, Suburban
418	Tandridge DC	Land at Fairview Industrial Estate, Holland Road, Hurst Green, Oxted, RH8 9AX	189	189	172	Dwellings	C3, Suburban
419	Tandridge DC	Land at Fairview Industrial Estate, Holland Road, Hurst Green, Oxted, RH8 9AX	189	189	172	Dwellings	C3, Suburban
420	Tandridge DC	Land at Fairview Industrial Estate, Holland Road, Hurst Green, Oxted, RH8 9AX	189	189	172	Dwellings	C3, Suburban
421	Tandridge DC	Land at Fairview Industrial Estate, Holland Road, Hurst Green, Oxted, RH8 9AX	189	189	172	Dwellings	C3, Suburban
422	Tandridge DC	Land at Fairview Industrial Estate, Holland Road, Hurst Green, Oxted, RH8 9AX	189	189	172	Dwellings	C3, Suburban
423	Tandridge DC	Gadoline House and former Old Barn petrol filling station, Godstone Road, Whyteleafe	233	233	126	Dwellings	C3, Suburban
424	Tandridge DC	Gadoline House and former Old Barn petrol filling station, Godstone Road, Whyteleafe	233	233	126	Dwellings	C3, Suburban
425	Tandridge DC	Gadoline House and former Old Barn petrol filling station, Godstone Road, Whyteleafe	233	233	126	Dwellings	C3, Suburban
426	Tandridge DC	Gadoline House and former Old Barn petrol filling station, Godstone Road, Whyteleafe	233	233	126	Dwellings	C3, Suburban
427	Tandridge DC	Gadoline House and former Old Barn petrol filling station, Godstone Road, Whyteleafe	233	233	126	Dwellings	C3, Suburban
428	Tandridge DC	Former Oxted Gasholder Site & Johnsdale Carpark, Station Road East, Oxted	188	188	111	Dwellings	C3, Suburban
429	Tandridge DC	Former East Wing, Whyteleafe House, 439 to 445 Godstone Road, Whyteleafe, Surrey CR3 0BL	233	233	167	Dwellings	C3, Suburban
430	Tandridge DC	Land West Of, Grasslands, Cooper Close, Smallfield.	162	162	51	Dwellings	C3, Suburban
431	Tandridge DC	Land off Redehall Road	164	164	114	Dwellings	C3, Suburban
432	Tandridge DC	Land at Plough Road, Smallfield	164	164	40	Dwellings	C3, Suburban
433	Tandridge DC	51 Redehall Road, Smallfield	164	164	10	Dwellings	C3, Suburban
434	Tandridge DC	Land North of Plough Road, Smallfield	164	164	120	Dwellings	C3, Suburban
435	Tandridge DC	Land off Salmons Lane West, Caterham	232	232	75	Dwellings	C3, Suburban
436	Tandridge DC	156-180 Whyteleafe Road, Caterham	232	232	59	Dwellings	C3, Suburban
437	Tandridge DC	Land to the west of Godstone	187	187	150	Dwellings	C3, Suburban
438	Tandridge DC	Land at the Old Cottage, Station Road, Lingfield	190	190	30	Dwellings	C3, Suburban
439	Tandridge DC	Land North of Hobbs End, Church Road, Lingfield	190	190	31	Dwellings	C3, Suburban
440	Tandridge DC	Land west of Red Lane, Hurst Green, Oxted	189	189	62	Dwellings	C3, Suburban
441	Tandridge DC	Warren Lane Depot, Oxted	189	189	50	Dwellings	C3, Suburban
442	Tandridge DC	282 Limpsfield Road, Warlingham	233	233	90	Dwellings	C3, Suburban
443	Tandridge DC	Land to the west of Limpsfield Road, Warlingham	233	233	100	Dwellings	C3, Suburban
444	Tandridge DC	Green Hill Lane, Warlingham	235	235	25	Dwellings	C3, Suburban
445	Tandridge DC	Land at Alexandra Avenue	235	235	25	Dwellings	C3, Suburban
446	Tandridge DC	Land at Farleigh Road	235	235	50	Dwellings	C3, Suburban
447	Tandridge DC	Former Shelton Sports Club, Warlingham	233	233	110	Dwellings	C3, Suburban
448	Tandridge DC	One Public Estate	231	231	82	Dwellings	C3, Suburban
449	Tandridge DC	Church Walk, Caterham	234	234	150	Dwellings	C3, Suburban
450	Tandridge DC	43 East Hill, Oxted	188	188	50	Dwellings	C3, Suburban
451	Tandridge DC	South Godstone Garden Community	187	187	4,000	Dwellings	C3, Suburban
452	Tandridge DC	Stone House Farm, Prince of Wales Road, Outwood RH1 5QU	162	162	157.4	Employment	B1a, Offices Suburban
453	Tandridge DC	Unit 37, Hobbs Industrial Estate, Newchapel RH7 6HN	166	166	809	Employment	B8, Warehousing Commercial
454	Tandridge DC	Diamond Farm, Holland Road, Hurst Green, Oxted RH8 9BQ	189	189	329	Employment	B1a, Offices Suburban
455	Tandridge DC	Sheldon House, 104 Station Road East, Oxted, Surrey RH8 0QB	188	188	61	Employment	B1a, Offices Suburban
456	Tandridge DC	2 Saxbys Lane, Lingfield, RH7 6DN	190	190	91	Employment	B1a, Offices Suburban
457	Tandridge DC	Bilbos Trading Company, Eastbourne Road, South Godstone	187	187	395	Employment	B1a, Offices Suburban
458	Tandridge DC	Haysbridge Business Centre, Brickhouse Lane, South Godstone RH9 8JW	187	187	60	Employment	B1c, Light Industry
459	Tandridge DC	Land At, Priory Farm, Sandy Lane, Nutfield, RH1 4ej	186	186	96	Employment	B1a, Offices Suburban
460	Tandridge DC	Hoopers Farm, Moor Lane, Marsh Green TN8 5QU	190	190	155.48	Employment	B1c, Light Industry
461	Tandridge DC	Flint Barn, Posterngate Farm, Eastbourne Road, South Godstone RH9 8EL	187	187	214	Employment	B1a, Offices Suburban
462	Tandridge DC	Cottage, Centenary Hall, Coopers Hill Road, Nutfield RH1 4HY	186	186	461	Employment	B1a, Offices Suburban
463	Tandridge DC	Delta House, 116 to 118 Station Road East, Oxted RH8 0QA	188	188	360	Employment	B1a, Offices Suburban
464	Tandridge DC	27 Stuart Road, Warlingham CR6 9JH	233	233	0	Employment	B1a, Offices Suburban
465	Tandridge DC	15 to 17 High Street, Caterham CR3 5UE	231	231	349	Employment	B1a, Offices Suburban
466	Tandridge DC	Southern Water Compound, Copthorne Road, Felbridge RH19 2QG	166	166	352	Employment	B8, Warehousing Commercial
467	Tandridge DC	Former Tipping Site, Lambs Business Park, 0 Terracotta Road, South Godstone h9 8lj	187	187	0	Employment	B1a, Offices Suburban
468	Tandridge DC	Cotters Hill Farm, Bug Hill, Woldingham CR3 7LB	233	233	111	Employment	B1a, Offices Suburban
469	Tandridge DC	Dalma House, Kings Mill Lane, South Nutfield RH1 5NB	186	186	2784	Employment	B1c, Light Industry
470	Tandridge DC	Rooks Nest Farm, Rooks Nest, Godstone, RH9 8BY	187	187	434	Employment	B1a, Offices Suburban
471	Tandridge DC	Maple Farm, Clay Lane, South Nutfield RH1 4EG	186	186	171	Employment	B1c, Light Industry
472	Tandridge DC	15 Raglan Precinct, Town End, Caterham CR3 5UG	231	231	163	Employment	B1a, Offices Suburban
473	Tandridge DC	Godstone Farm, Tilburstow Hill Road, Godstone RH9 8LX	187	187	72	Employment	B8, Warehousing Commercial
474	Tandridge DC	Comforts Place Farm, Tandridge Lane, Lingfield RH7 6LW	187	187	1569	Employment	B8, Warehousing Commercial
475	Tandridge DC	Block 26, Redhill Aerodrome, Kings Mill Lane, South Nutfield RH1 5JY	186	186	1256	Employment	B1a, Offices Suburban
476	Tandridge DC	Unit 10, Starborough Farm, Starborough Road, Marsh Green, TN8 5RB	190	190	215	Employment	B1a, Offices Suburban
477	Tandridge DC	Ellerton Yard, Peaks Brook Lane, Burstow RH6 9ST	165	165	4985	Employment	B8, Warehousing Commercial
478	Tandridge DC	Bourne House, 475 Godstone Road, Whyteleafe CR3 0BL	233	233	0	Employment	B1a, Offices Suburban
479	Tandridge DC	Hillcrest Farm, Scotts Hill, Outwood RH1 5PR	162	162	270	Employment	B1c, Light Industry
480	Tandridge DC	409 to 411 Croydon Road, Caterham CR3 6PP	234	234	161	Employment	B1a, Offices Suburban
481	Tandridge DC	Unit 57, Hobbs Industrial Estate, Newchapel RH7 6HN	166	166	0	Employment	B8, Warehousing Commercial
482	Tandridge DC	The Green Barn, Antlands Lane, Shipley Bridge RH6 9TE	165	165	546.1	Employment	B1c, Light Industry
483	Tandridge DC	The Laurels, Blackberry Lane, Lingfield RH7 6NG	190	190	335.1	Employment	B1a, Offices Suburban
484	Tandridge DC	170A Godstone Road, Whyteleafe CR3 0ED	233	233	660	Employment	B1c, Light Industry
485	Tandridge DC	26 Station Road, Whyteleafe CR3 0EP	233	233	109	Employment	B1a, Offices Suburban
486	Tandridge DC	Vantage House, 1A Mid Street, South Nutfield RH1 4JY	186	186	552	Employment	B1a, Offices Suburban
487	Tandridge DC	159A Godstone Road, Whyteleafe CR3 0EH	233	233	99.8	Employment	B1a, Offices Suburban
488	Tandridge DC	Former, 70 to 74 Godstone Road, Whyteleafe CR3 0EA	233	233	121.8	Employment	B1a, Offices Suburban
489	Tandridge DC	Securit House, Lagham Road, South Godstone RH9 8YZ	187	187	293.4	Employment	B1a, Offices Suburban
490	Tandridge DC	Land Rear of 18 and 20 High Street, Lingfield RH7 6AA	190	190	0	Employment	B1c, Light Industry
491	Tandridge DC	Coppard House Ivy Mill Lane, Godstone RH9 8NE	186	186	3824	Employment	B1c, Light Industry
492	Tandridge DC	Unit 4, Priory Farm, Sandy Lane, South Nutfield RH1 4EJ	186	186	92	Employment	B1a, Offices Suburban
493	Tandridge DC	Haysbridge Farm, Brickhouse Lane, South Godstone RH9 8JW	187	187	1049	Employment	B8, Warehousing Commercial
494	Tandridge DC	407 Croydon Road, Caterham CR3 6PP	234	234	74	Employment	B1a, Offices Suburban
495	Tandridge DC	The Terning Wheel, Effingham Road, Copthorne RH10 3HZ	165	165	1330	Employment	B1c, Light Industry
496	Tandridge DC	Woodgates Farm Buildings, Woodgates Farm, Dormansland RH7 6NZ	190	190	379.25	Employment	B1a, Offices Suburban
497	Tandridge DC	Former agricultural buildings on land north of Starline Farm, Starborough Road, Marsh Green	190	190	95	Employment	B1a, Offices Suburban
498	Tandridge DC	Rough Beech Farm and 3 & 4 Dowlands Cottages, Dowlands Lane, Smallfield RH6 9SD	164	164	218	Employment	B1a, Offices Suburban
499	Tandridge DC	66 Rook Lane, Chaldon CR3 5AD	231	231	180	Employment	B1c, Light Industry
500	Tandridge DC	Maple Farm, Clay Lane, South Nutfield RH1 4EG	186	186	225	Employment	B1c, Light Industry
501	Tandridge DC	77 Croydon Road, Caterham CR3 6PD	234	234	64.5	Employment	B1a, Offices Suburban
502	Tandridge DC	Haysbridge Farm, Brickhouse Lane, South Godstone RH9 8JW	187	187	196	Employment	B8, Warehousing Commercial
503	Tandridge DC	Former agricultural buildings on land at Starborough Road, Marsh Green TN8 5RB	190	190	150	Employment	B8, Warehousing Commercial

504	Tandridge DC	Scandia Hus Business Park, Felcourt Road, Felcourt RH19 2LP	190	190	740	Employment	B1a, Offices Suburban
505	Tandridge DC	Builders Yard, Merle Common Road, Oxted RH8 0RP	189	189	184	Employment	B1a, Offices Suburban
506	Tandridge DC	Cherry Tree Farm, West Park Road, Newchapel RH7 6HP	164	164	388	Employment	B1a, Offices Suburban
507	Tandridge DC	Hunters Moon Farm, Woolborough Lane, Outwood RH1 5QR	186	186	528	Employment	B8, Warehousing Commercial
508	Tandridge DC	Hayes Estate, Godstone Road, Caterham CR3 6SF	234	234	1260	Employment	B8, Warehousing Commercial
509	Tandridge DC	Godstone Road Business Centre, Whyteleafe	233	233	0	Employment	B1b, Business Park
510	Tandridge DC	Hobbs Industrial Estate, Felbridge	166	166	12,804	Employment	B1a, Offices Suburban
511	Tandridge DC	Lambs Business Park, South Godstone	187	187	26,400	Employment	B1b, Business Park
512	Tandridge DC	Westerham Road Industrial Estate, Tatsfield	235	235	9,372	Employment	B1b, Business Park
513	Tandridge DC	Snowhill Business Centre, Copthorne	166	166	99	Employment	B1a, Offices Suburban
514	Tandridge DC	Brewer Street, Bletchingley	186	186	4,026	Employment	B1a, Offices Suburban
515	Tandridge DC	Cophall Farm, Copthorne	165	165	13,695	Employment	B1a, Offices Suburban
516	Tandridge DC	Systems House, Blindley Heath	187	187	0	Employment	B1a, Offices Suburban
517	Tandridge DC	Redhill Aerodrome Industrial Area, South Nutfield	186	186	1,419	Employment	B1a, Offices Suburban
518	Tandridge DC	Paddock Barn Farm, Godstone Road, Caterham	234	234	1,452	Employment	B1a, Offices Suburban
519	Tandridge DC	Priory Farm, South Nutfield	186	186	0	Employment	B1a, Offices Suburban
520	Tandridge DC	South Godstone Garden Community	187	187	0	Employment	B1a, Offices Suburban
521	Horsham	Windacres Farm Rudgwick	259	259	55	Dwellings	C3, Suburban
522	Horsham	West of Horsham (EAST)	208	208	208	Dwellings	C3, Suburban
523	Horsham	Land West of Southwater	258	258	388	Dwellings	C3, Suburban
524	Horsham	Development of Land South of Marringdean Acres	257	257	51	Dwellings	C3, Suburban
525	Horsham	Kingslea Farm Marringdean Road Billingshurst	257	257	87	Dwellings	C3, Suburban
526	Horsham	Abingworth Farm & Nursery Storrington Road	254	254	61	Dwellings	C3, Suburban
527	Horsham	Bishops Weald House, Albion Way, Horsham (Lifestyle Ford)	208	208	53	Dwellings	C3, Suburban
528	Horsham	East of Billingshurst	257	257	475	Dwellings	C3, Suburban
529	Horsham	Land at Millstraight Southwater	257	257	193	Dwellings	C3, Suburban
530	Horsham	Land East of Emmanuel Cottage, Rusper Road, Ifield	96	96	95	Dwellings	C3, Town Centre
531	Horsham	Land North of Heath Barn Farm at Broadbridge Heath	254	254	49	Dwellings	C3, Suburban
532	Horsham	Land North of Highfield, Stane Street, Codmore Hill	255	255	119	Dwellings	C3, Suburban
533	Horsham	Land to the South of Billingshurst Surgery, Roman Way, Billinghamurst	257	257	45	Dwellings	C3, Suburban
534	Horsham	Norfolk House 32-40 North Street Horsham	207	207	20	Dwellings	C3, Suburban
535	Horsham	Old Goods Yard Christs Hospital	202	202	40	Dwellings	C3, Suburban
536	Horsham	Land North of Old Guildford Road, Broadbridge Heath	210	210	165	Dwellings	C3, Suburban
537	Horsham	Paula Rosa Kitchens, Robell Way, Storrington	254	254	24	Dwellings	C3, Suburban
538	Horsham	Century House, 100 Station Road, Horsham	206	206	49	Dwellings	C3, Suburban
539	Horsham	Bellway Homes Development Site Old Guildford Road Broadbridge Heath	210	210	22	Dwellings	C3, Suburban
540	Horsham	The Holbrook Club North Heath Lane Horsham	209	209	58	Dwellings	C3, Suburban
541	Horsham	Land Adjacent Railway Cottages and Pulborough Railway Station Stopham Road Pulborough	255	255	28	Dwellings	C3, Suburban
542	Horsham	St Marks Court Chart Way Horsham	207	207	203	Dwellings	C3, Suburban
543	Horsham	Land at Pelham and Waverley Courts Bishopric Horsham	207	207	21	Dwellings	C3, Suburban
544	Horsham	East of Hayes Lane	259	259	50	Dwellings	C3, Suburban
545	Horsham	Windacres Farm Rudgwick	259	259	2,787	Employment	B1a, Offices Suburban
546	Horsham	Billingshurst Road	208	208	2,806	Employment	A1, non-food
547	Horsham	Swan Walk Shopping Centre	207	207	2,176	Employment	D2, Leisure Centre
548	Horsham	Unit 10	207	207	1,348	Employment	D2, Leisure Centre
549	Horsham	Piries Place	207	207	3,426	Employment	A1, non-food
550	Horsham	Bishops Weald House	207	207	4,488	Employment	A1, non-food
551	Horsham	Broomers Hill Park	256	256	1,650	Employment	B1c, Light Industry
552	Horsham	Dial Post Park	176	176	1,175	Employment	B1a, Offices Suburban
553	Horsham	Nowhurst Business Park	259	259	26,942	Employment	B1a, Offices Suburban
554	Horsham	Stane Street	259	259	70	Employment	C1, Bed
555	Horsham	Ex Arun Feed Mills	257	257	1,235	Employment	B1c, Light Industry
556	Horsham	Land To The North of Thornhill Court	210	210	33,015	Employment	D2, Leisure Centre
557	Horsham	Abingworth Nurseries	254	254	957	Employment	B1c, Light Industry
558	Horsham	Brinsbury Fields	256	256	14,068	Employment	B1a, Offices Suburban
559	Horsham	Land at Brinsbury Fields	259	259	3,710	Employment	B1c, Light Industry
560	Horsham	Dawes Farm	250	250	1,930	Employment	B1c, Light Industry
561	Horsham	Parsonage Way (part of Parsonage farm , North Horsham	206	206	8,800	Employment	B1c, Light Industry
562	Horsham	Kilnwood Vale , West of Bewbush, Colgate	89	89	8,000	Employment	B1a, Offices Town Centre
563	Horsham	Strategic location , West of Horsham	176	176	2,878	Employment	B1a, Offices Suburban
564	Horsham	Wealden Brickworks , Langhurstwood Road	209	209	6,695	Employment	B1c, Light Industry
565	Horsham	Wealden Brickworks (units 1-5) , Langhurstwood Road North Horsham	209	209	11,788	Employment	B1c, Light Industry
566	Horsham	Wealden Brickworks , Langhurstwood Road, North Horsham	209	209	8,185	Employment	B8, Warehousing Commercial
567	Horsham	Land North of Horsham	209	209	46,450	Employment	B1a, Offices Suburban
568	Horsham	Land North of Horsham	208	208	2,750	Dwellings	C3, Suburban

APPENDIX 15.4: PROPOSED PEDESTRIAN AND CYCLE ROUTES



Grass Swales & Attenuation Ponds	
EM8 Meadow Mixture for Wetlands (Emorsgate or acceptable equivalent)	EM8
Seeding Rate (g/m ²)	10
Species	%
Wild Flowers	20
Achillea millefolium (Yarrow)	2.00
Agrimonia eupatoria (Agrimony)	0.60
Centaurea nigra (Common Knapweed)	3.60
Filipendula ularia (Meadowsweet)	1.00
Galium verum (Lady's Bedstraw)	2.00
Geum rivale (Water Awns)	0.20
Lathyrus pratensis (Meadow Vetchling)	0.50
Leontodon hispidus (Rough Hawkbit)	0.10
Leucanthemum vulgare (Oxeye Daisy (Moon Daisy))	1.20
Lotus corniculatus (Birdsfoot Trefoil)	0.10
Lotus pedunculatus (Greater Birdsfoot Trefoil)	0.40
Plantago lanceolata (Ribwort Plantain)	3.20
Primula veris (Cowslip)	0.20
Prunella vulgaris (Selfheal)	0.10
Ranunculus acris (Meadow Buttercup)	0.40
Rhinanthus minor (Yellow Rattle)	1.40
Rumex acetosa (Common Sorrel)	1.20
Sanguisorba officinalis (Great Burnet)	1.00
Silene flos-cuculi (Ragged Robin)	0.30
Succisa pratensis (Devil's-bit Scabious)	0.10
Vicia cracca (Tufted Vetch)	0.40
Grasses	80
Agrostis capillaris (Common Bent)	4.00
Anthoxanthum odoratum (Sweet Vernal-grass)	4.00
Carex diuila subsp. diuila (Grey Sedge)	1.60
Cynosurus cristatus (Crested Dogtail)	34.4
Deschampsia cespitosa (Tufted Hair-grass)	1.60
Festuca rubra (Red Fescue)	20.0
Hordeum secalinum (Meadow Barley)	4.00
Poa trivialis (Rough-stalked Meadow-grass)	8.00
Schedonorus arundinaceus (Tall Fescue)	2.40

Species (Latin)	Common Name	%
Achillea millefolium	Yarrow	2
Achillea 'Walther Funcke'	Yarrow	2
Betonica officinalis 'Hummelo'	Betony	2
Carex oshimensis 'Everest'	Japanese Sedge	20
Carex oshimensis 'Everillo'	Japanese Sedge	10
Sedum herbstiuede (Hylotelephium spectabile)	Stoncrop	2
Monarda didyma 'Bee Lieve'	Bergamot	2
Hakonechloa macra 'Aureola'	Golden Hakonechloa	20
Kniphofia 'Little Maid'	Red Hot Poker	5
Kniphofia 'Poco Red'	Red Hot Poker	5
Imperata cylindrica 'Rubra'	Japanese Blood Grasses	8
Geranium 'Light Dilsy'	Cranebill	2
Geranium 'Rozanne'	Cranebill	2
Festuca glauca 'Blaufruchs'	Blue Fescue	8
Nepeta x faassenii	Cat Mint	5
Carex buchananii 'Red Rooster'	Sedge	5

[illegible]

Native Hedgerow					
Hedgerow Habitat Planting - Regular Low Inc. Trees					
Hedge Species	Height (cm)	Age	Root		
<i>Acer campestre</i> (Field maple)	60-80	1+1	B		
<i>Crataegus monogyna</i> (Hawthorn)	60-80	1+1	B		
<i>Prunus spinosa</i> (Blackthorn)	60-80	1+1	B		
<i>Fagus sylvatica</i> (Beech)	60-80	1+1	B		
<i>Ilex aquifolium</i> (Holly)	60-80	1+1	B		
Maintenance - Trimmed at 1.6 high					
Tree Species (Within Hedgerow)	Code	Girth (cm)	Height (cm)	Clear stem (cm)	Root
<i>Acer campestre</i> (Field Maple)	Ac	10 to 12	200-250	180 min	B
<i>Prunus avium</i> (Wild Cherry)	Pa	10 to 12	200-250	180 min	B
<i>Sorbus aucuparia</i> (Rowan)	Sa	12 to 14	250-300	200 min	B
<i>Quercus robur</i> (English Oak)	Qr	12 to 14	250-300	200 min	B

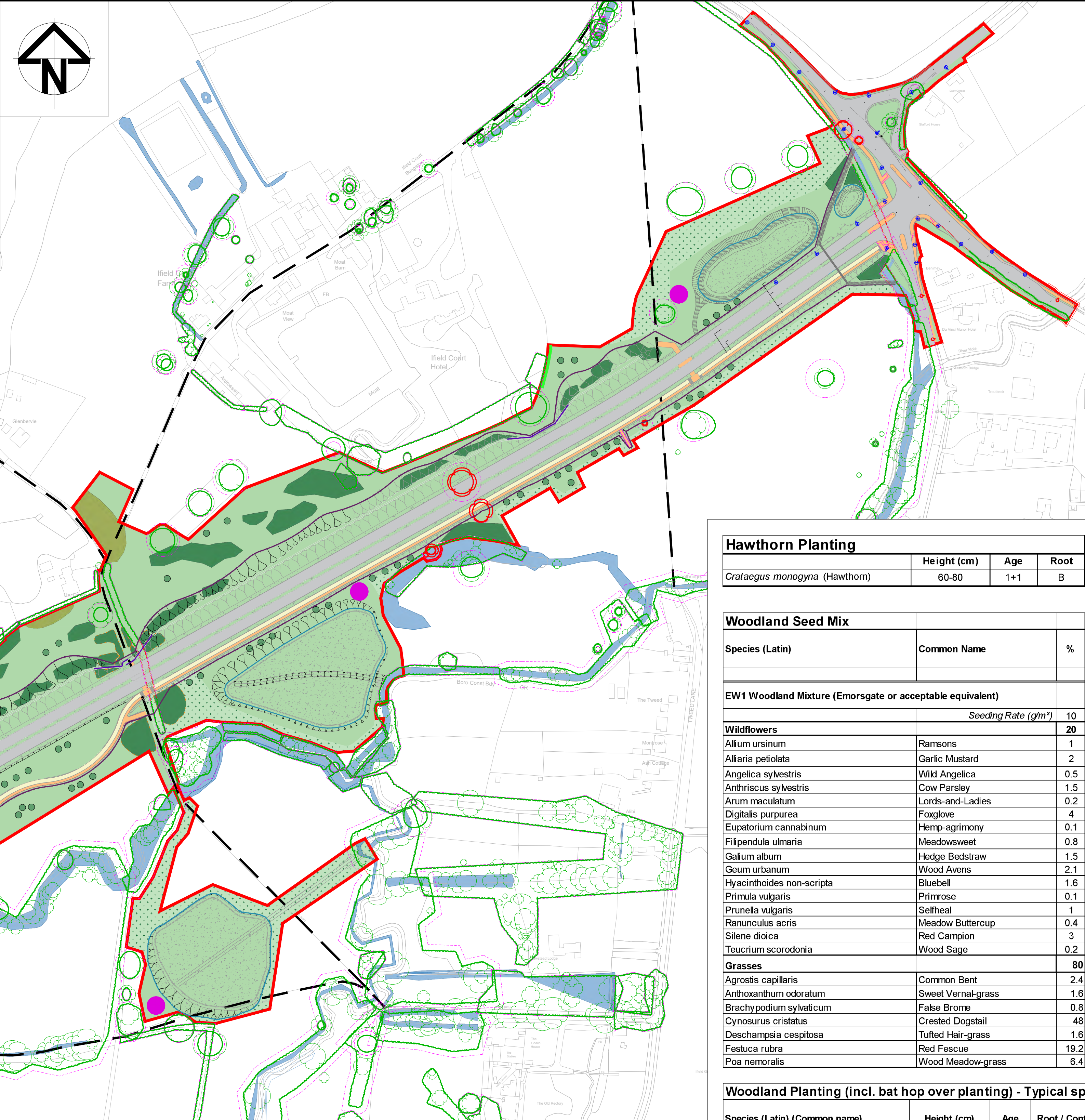

Hawthorn Planting			
	Height (cm)	Age	Root
<i>Crataegus monogyna</i> (Hawthorn)	60-80	1+1	B

Woodland Seed Mix		
Species (Latin)	Common Name	%

EW1 Woodland Mixture (Emorsgate or acceptable equivalent)		
Seeding Rate (g/m²)		10
Wildflowers		
		20
<i>Allium ursinum</i>	Ramsons	1
<i>Alliaria petiolata</i>	Garlic Mustard	2
<i>Angelica sylvestris</i>	Wild Angelica	0.5
<i>Anthriscus sylvestris</i>	Cow Parsley	1.5
<i>Arum maculatum</i>	Lords-and-Ladies	0.2
<i>Digitalis purpurea</i>	Foxglove	4
<i>Eupatorium cannabinum</i>	Hemp-agrimony	0.1
<i>Filipendula ulmaria</i>	Meadowsweet	0.8
<i>Galium album</i>	Hedge Bedstraw	1.5
<i>Geum urbanum</i>	Wood Avens	2.1
<i>Hyacinthoides non-scripta</i>	Bluebell	1.6
<i>Primula vulgaris</i>	Primrose	0.1
<i>Prunella vulgaris</i>	Selfheal	1
<i>Ranunculus acris</i>	Meadow Buttercup	0.4
<i>Silene dioica</i>	Red Campion	3
<i>Teucrium scorodonia</i>	Wood Sage	0.2
Grasses		
		80
<i>Agrostis capillaris</i>	Common Bent	2.4
<i>Anthoxanthum odoratum</i>	Sweet Vernal-grass	1.6
<i>Brachypodium sylvaticum</i>	False Brome	0.8
<i>Cynosurus cristatus</i>	Crested Dogtail	48
<i>Deschampsia cespitosa</i>	Tufted Hair-grass	1.6
<i>Festuca rubra</i>	Red Fescue	19.2
<i>Poa nemoralis</i>	Wood Meadow-grass	6.4

Woodland Planting (incl. bat hop over planting) - Typical species

Species (Latin) (Common name)	Height (cm)	Age	Root / Container / Cell	%	Notes	Group size range (Number of plants)	Species Density (Plants/m²)
Trees - Feathers - 20%							
				20			
<i>Quercus robur</i> (Pendunculate Oak)	80 - 100	2x	B	9	-	3-7	0.25
<i>Fagus sylvatica</i> (Beech)	80 - 100	2x	B	8	-	3-7	0.25
<i>Tilia x europaea</i> (Lime)	80 - 100	2x	B	3	-	3-7	0.25
Trees - Whips - 30%							
				30			
<i>Betula pendula</i> (Birch)	60 - 80	1+2	B	12	-	3-7	0.25
<i>Fagus sylvatica</i> (Beech)	60 - 80	1+2	B	12	-	3-7	0.25
<i>Tilia x europaea</i> (Lime)	60 - 80	1+2	B	6	-	3-7	0.25
Trees - Transplants - 25%							
				25			
<i>Quercus robur</i> (Pendunculate Oak)	60 - 80	1+1	B	11	-	5-9	0.25
<i>Fagus sylvatica</i> (Beech)	60 - 80	1+1	B	9	-	5-9	0.25
<i>Tilia x europaea</i> (Lime)	60 - 80	1+1	B	5	-	8-12	0.25
Shrubs - 25%							
				25			
<i>Crataegus monogyna</i> (Hawthorn)	40-60	1+1	B	2	-	3-5	1
<i>Ligustrum vulgare</i> (Privet)	40-60	1+1	B	3	-	3-5	1
<i>Rubus fruticosus</i> (Blackberry)	40-60	1+1	B	2	-	3-5	1
<i>Rosa arvensis</i> (Field Rose)	40-60	1+1	B	2	-	3-5	1
<i>Corylus avellana</i> (Hazel)	40-60	1+1	B	4	-	3-5	1
<i>Cornus sanguinea</i> (Dogwood)	40-60	1+1	B	3	-	3-5	1
<i>Viburnum opulus</i> (Guelder Rose)	40-60	1+1	B	2	-	3-5	1
<i>Prunus spinosa</i> (Blackthorn)	40-60	1+1	B	5	-	3-5	1
<i>Prunus insititia</i> (Bullace)	40-60	1+1	B	2	-	3-5	1
				100			

Grass Swales & Attenuation Ponds	
EM8 Meadow Mixture for Wetlands (Emorsgate or acceptable equivalent)	EM8
Seeding Rate (g/m²)	10
Species	%
Wild Flowers	
	20
<i>Achillea millefolium</i> (Yarrow)	2.00
<i>Agrimonia eupatoria</i> (Agrimony)	0.60
<i>Centaurea nigra</i> (Common Knapweed)	3.60
<i>Filipendula ularia</i> (Meadowsweet)	1.00
<i>Galium verum</i> (Lady's Bedstraw)	2.00
<i>Geum rivale</i> (Water Avens)	0.20
<i>Lathyrus pratensis</i> (Meadow Vetchling)	0.50
<i>Leontodon hispidus</i> (Rough Hawkbit)	0.10
<i>Leucanthemum vulgare</i> (Oxeye Daisy (Moon Daisy))	1.20
<i>Lotus corniculatus</i> (Birdsfoot Trefoil)	0.10
<i>Lotus pedunculatus</i> (Greater Birdsfoot Trefoil)	0.40
<i>Plantago lanceolata</i> (Ribwort Plantain)	3.20
<i>Primula veris</i> (Covslip)	0.20
<i>Prunella vulgaris</i> (Selfheal)	0.10
<i>Ranunculus acris</i> (Meadow Buttercup)	0.40
<i>Rhinanthus minor</i> (Yellow Rattle)	1.40
<i>Rumex acetosa</i> (Common Sorrel)	1.20
<i>Sanguisorba officinalis</i> (Great Burnet)	1.00
<i>Silene flos-cuculi</i> (Ragged Robin)	0.30
<i>Succisa pratensis</i> (Devil's-bit Scabious)	0.10
<i>Vicia cracca</i> (Tufted Vetch)	0.40
Grasses	
	80
<i>Agrostis capillaris</i> (Common Bent)	4.00
<i>Anthoxanthum odoratum</i> (Sweet Vernal-grass)	4.00
<i>Carex divulsa</i> subsp. <i>divulsa</i> (Grey Sedge)	1.60
<i>Cynosurus cristatus</i> (Crested Dogtail)	34.4
<i>Deschampsia cespitosa</i> (Tufted Hair-grass)	1.60
<i>Festuca rubra</i> (Red Fescue)	20.0
<i>Hordeum secalinum</i> (Meadow Barley)	4.00
<i>Poa trivialis</i> (Rough-stalked Meadow-grass)	8.00
<i>Schedonorus arundinaceus</i> (Tall Fescue)	2.40

Grass Seeding	
EM10 Tussock Meadow Mixture (Emorsgate or acceptable equivalent)	EM10
Seeding Rate (g/m²)	10
Species	%
Wild Flowers	
	20
<i>Achillea millefolium</i> (Yarrow)	0.8
<i>Agrimonia eupatoria</i> (Agrimony)	0.4
<i>Arctium minus</i> (Lesser Burdock)	0.1
<i>Centaurea nigra</i> (Common Knapweed)	1.4
<i>Centaurea scabiosa</i> (Greater Knapweed)	1.0
<i>Chaerophyllum temulum</i> (Rough Chervil)	0.8
<i>Cruciatia laevipes</i> (Crosswort)	0.5
<i>Daucus carota</i> (Wild Carrot)	1.0
<i>Dipsacus fullonum</i> (Wild Teasel)	1.6
<i>Filipendula ulmaria</i> (Meadowsweet)	0.8
<i>Galium album</i> (Hedge Bedstraw)	1.8
<i>Knautia arvensis</i> (Field Scabious)	0.8
<i>Leucanthemum vulgare</i> (Oxeye Daisy)	1.6
<i>Lotus corniculatus</i> (Birdsfoot Trefoil)	0.4
<i>Malva moschata</i> (Musk Mallow)	1.6
<i>Plantago lanceolata</i> (Ribwort Plantain)	1.8
<i>Poterium sanguisorba</i> (Salad Burnet)	1.6
<i>Silene dioica</i> (Red Campion)	1.0
<i>Vicia cracca</i> (Tufted Vetch)	0.4
Tussock grasses	
	80
<i>Alopecurus pratensis</i> (Meadow Foxtail)	4.0
<i>Cynosurus cristatus</i> (Crested Dogtail)	20.0
<i>Dactylis glomerata</i> (Cocksfoot)	16.0
<i>Festuca rubra ssp nuba</i> (Strong-creeping Red Fescue)	12.0
<i>Holcus lanatus</i> (Yorkshire Fog)	8.0
<i>Lolium perenne</i> (Perennial Ryegrass)	4.0
<i>Poa pratensis</i> (Smooth-stalked Meadow-grass)	6.4
<i>Schedonorus arundinaceus</i> (Tall Fescue)	9.6

LANDSCAPE KEY

- Red Line Boundary
- Existing Landscape Features
 - Public Right of Way
 - Retained existing trees
 - Other retained existing woody vegetation (incl. tree, shrubs, hedgerows)
 - Removed existing trees
 - Removed existing woody vegetation (incl. tree, shrubs, hedgerows)
 - Root Protection Area
 - Existing vegetation retained or reinstated
 - Watercourse / Body
- Proposed Engineering Features (Refer to Engineers' Proposals for details)
 - Carriageway
 - Footway / Handstanding
 - Cycleway
 - Embankments
 - Attenuation basin
 - Proposed lighting column
 - Existing lighting column retained
 - Proposed fencing
 - Culvert structure
 - Bridge structure
- Proposed landscape features
 - Specimen tree planting
 - Grass seeding
 - Grass swales and attenuation ponds
 - Temporary seeding of embankments
 - Woodland planting
 - Hawthorn planting
 - Bat Hop Over Areas
 - Native Hedgerow
 - Hibernaculum

Rev	Date	Description	Prod	Chk	Rev	App
P6	15.08.24	For Planning	IDG	AS	MH	BH
P5	05.08.24	Layout update	IDG	AS	MH	MH
P4	20.03.24	Updated Retained & Removed Vegetation	TW	AS	MH	MH
P3	13.03.24	Preliminary	IDG	AS	MH	MH
P2	14.12.23	Preliminary	IDG	AS	BH	BH
P1	26.10.23	Preliminary	IDG	AS	BH	BH

Project:		Client:	
West of Ifield		Homes England	
Ifield, Crawley		Arpley House, 110 Birchwood Boulevard	
West Sussex		Birchwood, Warrington	
		WA3 7QH	



Registered office: 80 Fenchurch Street, London EC3M 4BY
Coordinating office: 80 Fenchurch Street, London EC3M 4BY
Tel: 44 (0)20 7812 2000
www.arcadis.com © Copyright reserved

Phase 1B
Landscape Typologies Plan
Sheet 1 of 2

Designed: IDG	Signed: Digitally Signed	Date: 15.08.24
Reviewed: AS	Signed: Digitally Signed	Date: 15.08.24
Checked: AS	Signed: Digitally Signed	Date: 15.08.24
Reviewed: MH	Signed: Digitally Signed	Date: 15.08.24
Approved: MH	Signed: Digitally Signed	Date: 15.08.24

Design Stage: Detailed Design	Original Size: A1	Grid: OS	Datum: AOD
Stability Code: S2	Scale: 1:2000	Project Number: 10051123	
Stability Description			

Suitable for Information

Drawing Number: 10051123 - ARC - 300 - 1B - DR - LA - 00001	Revision: P6
---	--------------

